

PowerGard universal receptacles and back boxes

Cl. I, Groups B, C, D
Cl. II, Groups F, G
Cl. III
NEMA 3, 3R, 3RX

Explosionproof
Dust-ignitionproof
Raintight
Wet Locations

10P

Whether you are powering lighting fixtures or portable equipment, you need a receptacle solution that stands up to the harsh environmental and physical demands of land-based drilling applications.

PowerGard™ receptacles and back boxes meet and exceed your power needs with an easy install, universal footprint suitable for rig maintenance, retrofits and new builds.

Applications:

- Used to supply power to lighting systems and lighting panels on land-based drilling rigs

Features:

- Classified for use with Appleton U-Line series
- Easy to wire saddle clamp terminals reduce installation time and effort
- Molded-in-place phase/ground markings reduce installation errors
- Can handle temperature extremes ranging from -50°C to +55°C where comparable products are not certified to operate
- Epoxy powder coat finish, integral gasket design and stainless steel hardware for NEMA 3RX applications
- Vibration tested at 1G to ensure continuity in high vibration areas
- Rugged Krydon faceplate stands up to abuse in the field without cracking
- Positive on/off position identifies when unit has been engaged and disengaged
- Clearly marked operating instructions to eliminate risk of improper operation

Certifications and compliances:

NEC/CEC:

- Class I, Groups B^A, C, D
- Class II, Groups F, G
- Class III

UL standard:

- UL1203 – Explosionproof and Dust-ignitionproof Electrical Equipment for use in Hazardous (Classified) Locations

CSA standards:

- CSA 22.2 No. 30 – Explosionproof Enclosures for use in Class I Hazardous Locations
- CSA 22.2 No. 159 – Attachment Plugs, Receptacles and Similar Wiring Devices for use in Hazardous Locations: Class I, Groups A, B, C, D; Class II, Group G, in Coal or Coke Dust, and in Gaseous Mines
- cULus File No. 10289

Environmental ratings:

- NEMA 3, 3R, 3RX

Standard materials:

- Housing, covers and back boxes – copper-free aluminum with Corro-free epoxy powder coat
- Insulator and faceplate – Krydon fiberglass-reinforced polyester
- External hardware – stainless steel



Electrical ratings:

- 15 amperes, 125 VAC
- 20 amperes, 125 or 250 VAC

Ambient temperature ratings:

- ULus, Groups C, D: -50°C to +55°C
- cUL, Groups C, D: -50°C to +40°C
- ULus, Groups B, C, D: -25°C to +55°C
- cUL, Groups B, C, D: -25°C to +40°C

Dimensions:

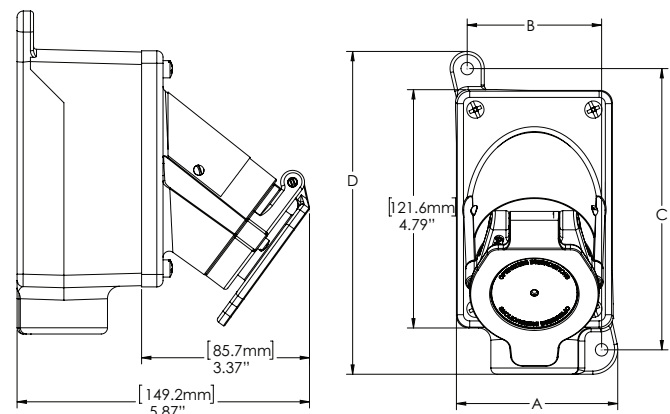

Style	A	B	C	D
Single-gang	3.24" (82.3)	2.70" (68.6)	5.65" (143.5)	6.48" (164.7)
Two-gang	6.38" (162.2)	5.50" (139.7)	5.69" (144.4)	6.55" (166.5)

^A Group B certification not applicable for two-gang assemblies. See Ordering information section for full details.

PowerGard universal receptacles and back boxes

Cl. I, Groups B, C, D
Cl. II, Groups F, G
Cl. III
NEMA 3, 3R, 3RX

Explosionproof
Dust-ignitionproof
Raintight
Wet Locations

10P

UNIVERSAL FOOTPRINT

- Provides field flexibility for retrofits or installation in tight places
- UL classified for use with Appleton U-Line series

SUPERIOR HARDWARE

- Stainless steel external hardware eliminates corrosion on critical components and extends product life
- Hex head screws allow for easy achievement of specified torque values

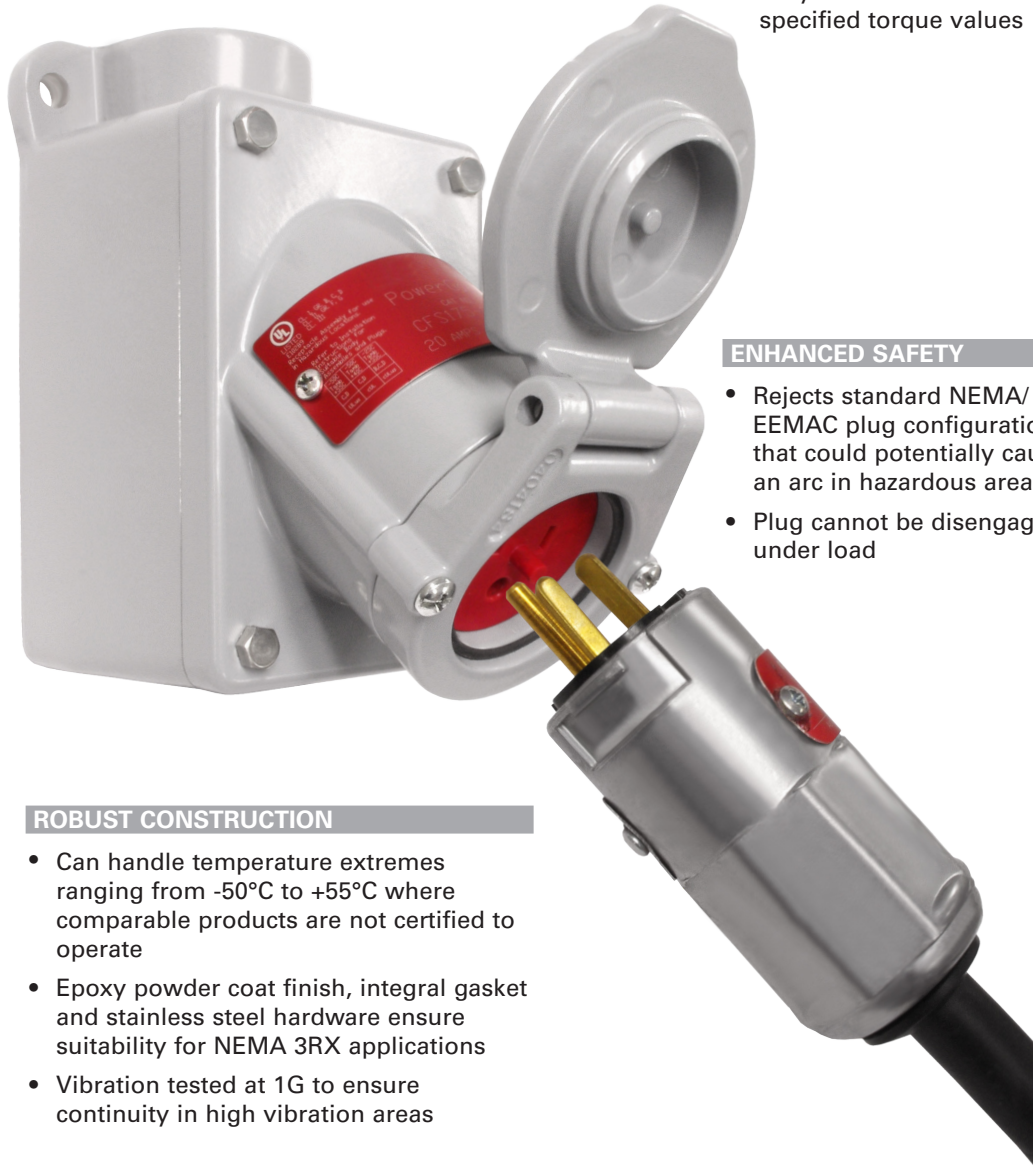

ENHANCED SAFETY

- Rejects standard NEMA/EEMAC plug configurations that could potentially cause an arc in hazardous areas
- Plug cannot be disengaged under load

ROBUST CONSTRUCTION

- Can handle temperature extremes ranging from -50°C to +55°C where comparable products are not certified to operate
- Epoxy powder coat finish, integral gasket and stainless steel hardware ensure suitability for NEMA 3RX applications
- Vibration tested at 1G to ensure continuity in high vibration areas

10P

PowerGard universal receptacles and back boxes

Cl. I, Groups B, C, D
Cl. II, Groups F, G
Cl. III
NEMA 3, 3R, 3RX

Explosionproof
Dust-ignitionproof
Raintight
Wet Locations

10P



SAFESPRING FACEPLATE

- Spring loaded faceplate design prevents receptacle from being energized without use of UL certified hazardous location plug
- Rugged Krydon faceplate won't crack after continued use in the field

EASY INSTALL TERMINALS

- Molded-in-place phase and ground markings reduce installation errors
- Easy to wire saddle clamp terminals reduce installation time and effort
- Receptacle suitable for tough feed/loop wiring; no additional wire nuts or terminators needed

Wire sizes

Solid	16-10 AWG
Stranded	16-12 AWG

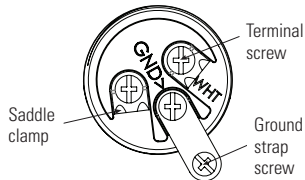

BEST-IN-CLASS COVER

- Combo head, stainless steel screws make replacement easy
- Clearly marked operating instructions ensure proper operation and safety when plugging and unplugging
- Threaded cover option available for exceptional watertight integrity



10P

PowerGard universal receptacles and back boxes

Cl. I, Groups B, C, D
Cl. II, Groups F, G
Cl. III
NEMA 3, 3R, 3RX

Explosionproof
Dust-ignitionproof
Raintight
Wet Locations



10P

Ordering information:



Receptacles and mounting boxes

Type	Style	Configuration	Hub size	Cat. # 20A, 125 VAC	Cat. # 20A, 250 VAC	Cat. # 15A, 125 VAC
Single-gang assembly [ⓑ]	Dead end	2-wire, 3-pole	1/2"	CFS150-2023-M15	CFS150-20232-M15	CFS150-1523-M15
			3/4"	CFS175-2023-M15	CFS175-20232-M15	CFS175-1523-M15
			1"	CFS110-2023-M15	CFS110-20232-M15	CFS110-1523-M15
	Through feed	2-wire, 3-pole	1/2"	CFSC150-2023-M15	CFSC150-20232-M15	CFSC150-1523-M15
			3/4"	CFSC175-2023-M15	CFSC175-20232-M15	CFSC175-1523-M15
			1"	CFSC110-2023-M15	CFSC110-20232-M15	CFSC110-1523-M15
Two-gang assembly [Ⓒ]	Dead end	2-wire, 3-pole	1/2"	CFS250-2023-M15	CFS250-20232-M15	CFS250-1523-M15
			3/4"	CFS275-2023-M15	CFS275-20232-M15	CFS275-1523-M15
			1"	CFS210-2023-M15	CFS210-20232-M15	CFS210-1523-M15
	Through feed	2-wire, 3-pole	1/2"	CFSC250-2023-M15	CFSC250-20232-M15	CFSC250-1523-M15
			3/4"	CFSC275-2023-M15	CFSC275-20232-M15	CFSC275-1523-M15
			1"	CFSC210-2023-M15	CFSC210-20232-M15	CFSC210-1523-M15

Replacement receptacles

Type	Configuration	Cat. # 20A, 125 VAC [Ⓓ]	Cat. # 20A, 250 VAC [Ⓓ]	Cat. # 15A, 125 VAC [Ⓓ]
Replacement receptacle [Ⓓ]	2-wire, 3-pole	 CFSR-2023-M15 [Ⓓ]	 CFSR-20232-M15	 CFSR-1523-M15 [Ⓓ]

Ark-Gard ENP plug

Type	Configuration	Cat. # 20A, 125 VAC	Cat. # 20A, 250 VAC	Cat. # 15A, 125 VAC
ENP standard plug	2-wire, 3-pole	 ENP5201	 ENP6202	 ENP5151

Back boxes

Type	Style	Hub size	Cat. #	Type	Style	Hub size	Cat. #
Single-gang	Dead end	1/2"	CFD150	Two-gang	Dead end	1/2"	CFD250
		3/4"	CFD175			3/4"	CFD275
		1"	CFD110			1"	CFD210
	Through feed	1/2"	CFDC150		1/2"	CFDC250	
		3/4"	CFDC175		3/4"	CFDC275	
		1"	CFDC110		1"	CFDC210	

Replacement parts

Type	Cat. #	Type	Cat. #	Type	Cat. #
 Spring cover replacement	PGSCA	 Threaded cover replacement	PGTCA	 Back box hex bolt replacement	PG SCREW PACK
				 Back box hex bolt replacement	PG SCREW PACK SLOT

[ⓑ] Single-gang assembly listed for Class I, Division 1, Groups B, C, D for -25°C ambient and Class I, Division 1, Groups C, D for -50°C ambient.

[Ⓒ] Two-gang assembly listed for Class I, Division 1, Groups C, D and Class I, Division 2, Groups B, C, D. Manufacturer self-certification of Class I, Division 1, Group B available.

[Ⓓ] In order to be certified for Class I, Division 1, Group B applications, receptacles must be used on a single-gang back box (catalog number CFD1XX or CFDC1XX).

[Ⓔ] Both 15A, 125 VAC and 20A, 125 VAC PowerGard receptacles can accept either a 15A, 125 VAC or 20A, 125 VAC ENP plug.