

Directional Valves



Wet Armature Spring Offset Directional Valve

(F3)DG4S4-01*F-W3-*-50(LH)

NOTE
Right hand assembly shown. For left hand assembly, all parts are reversed except body.

Model	Spool	Spool Kit
-012F-	463426	926552
-016F-	572288	926553

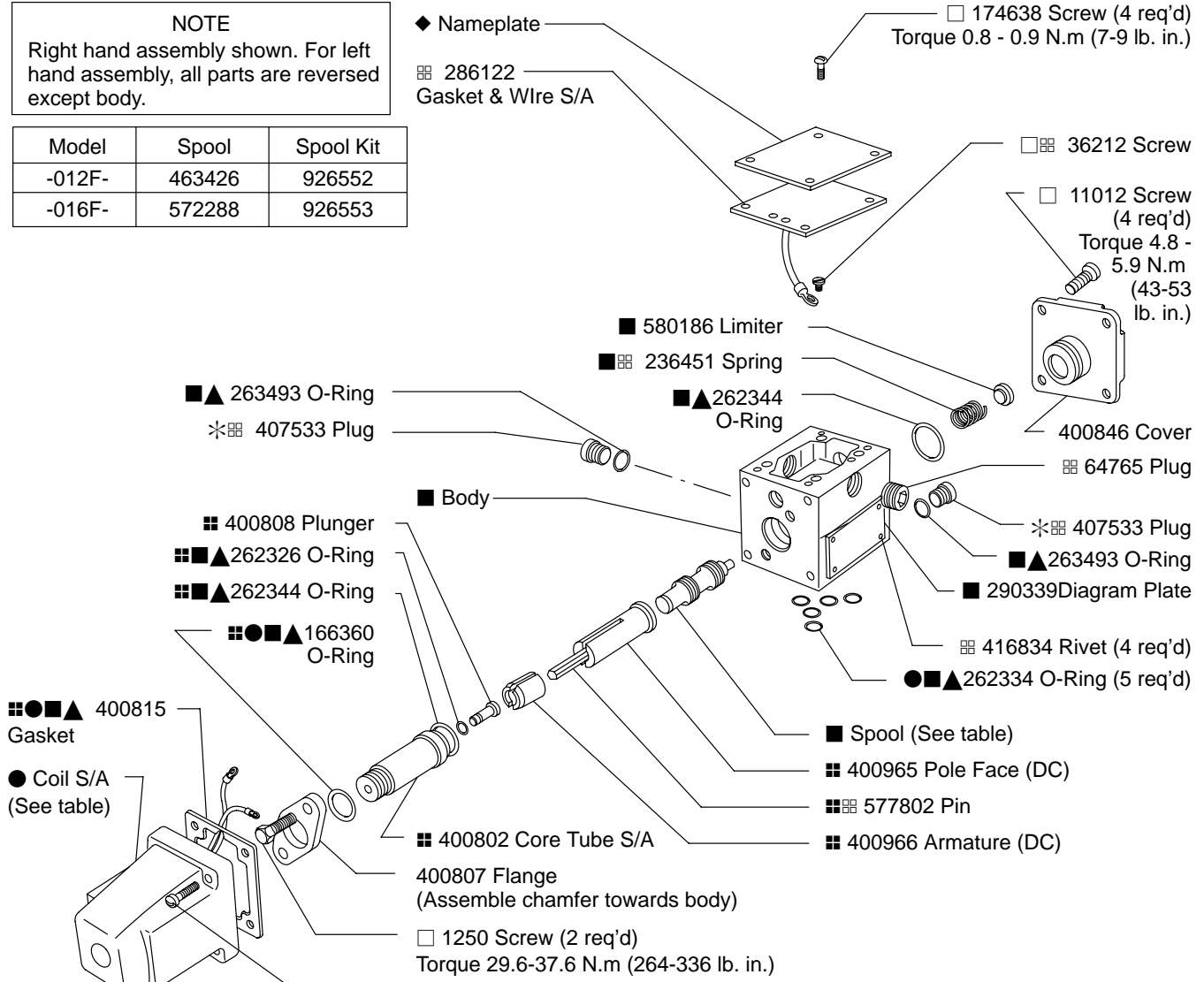

●□ 577726 Screw (2 req'd)
 Torque 1.4 - 1.8 N.m (12-16 lb. in.)

▲ Included in F3 Seal Kit 920109

□ Included in Fastener Kit 942465

■ Included in Spool Kit

● Included in Coil Kit

■ Included in Serviceable 'DC' Core Tube S/A Kit 926551
 Non-serviceable 'AC' Core Tube S/A 587259

◆ Not Available for Sale

■ Available only in Kits of 25 each

*Torque 12.1 -12.4 N.m (107-110 lb. in.)

Coil S/A	Coil Kit	AC Volt /Hz	DC Volt	Coil Code
400823	942466	110/50, 115/60, 120/60		B
400824	942467	220/50, 230/60		D
400825	942468	440/50, 460/60		M
400826	942469		12	G
400827	942470		24	H
435755	941017	127/50		EG
582214	941109		250	X
730273	926461		48	J

CAUTION
 Correct Core Tube S/A must be used for AC and DC operation

Model Code

(F3) - DG4S 4 * - 01 * F - W3 - * - 50 - (LH)

┌───┐
┌───┐
┌┐
┌┐
┌┐
┌┐
┌┐
┌┐
┌┐
┌┐
┌┐

└─┘
└─┘
└┘└
└┘└
└┘└
└┘└
└┘└
└┘└
└┘└
└┘└
└┘└

1
2
3
4
5
6
7
8
9
10
11

1 Seal Material

F3 - Seals for mineral oil and fire resistant fluids

2 Model Series

DG4S4 - Directional valve, manifold or subplate mounted, solenoid operated, sliding spool

3 Flow Direction

4 - 4 way

4 Solenoid Indicator Lights

L - Light
(Omitted - None)

5 Series

6 Spool Type

7 Spring Offset to Cyl. "A"
Spool Travel to Center

8 Wet Armature Type Solenoid

W - Non-Serviceable Core Tube S/A
W3 - Serviceable Core Tube S/A

9 Coil Identification Letter

10 Design

11 Left Hand Built
(Omit for Std. R.H. Models)

For Models with Solenoid Indicator Lights

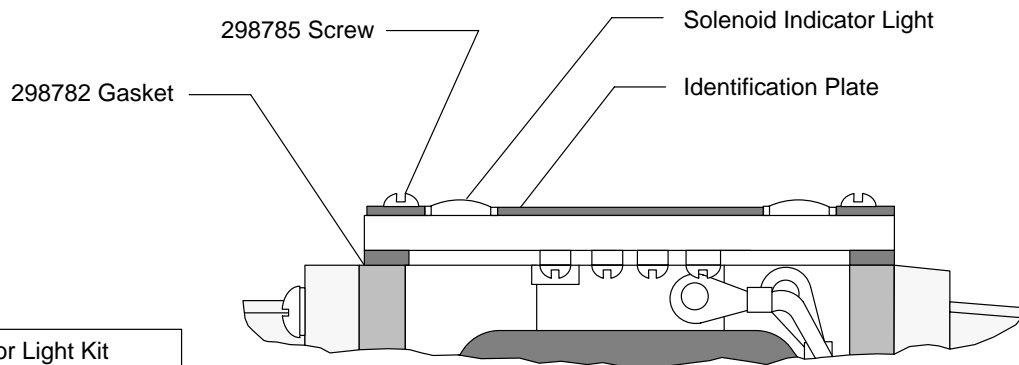

Solenoid Indicator Light Kit (Includes all parts identified)	
Voltage Range	Kit
100 thru 127	941615
192 thru 233	941617

NOTE

Refer to Parts Drawing I-3487-S for models with plug-in feature.

For satisfactory service life of these components, use full flow filtration to provide fluid which meets ISO cleanliness code 20/18/15 or cleaner. Selections from Eaton OFP, OFR and OFRS filter series are recommended.

Printed in U.S.A.