

Directional Valves



Spring Centered Solenoid Controlled Directional Valves

DG4S4(L)-01*C-H-(**AC**-)-50

Voltage	Solenoid S/A
24 AC 60	251505
110 AC 60	232960
115 AC 60	195053
120 AC 60	240996
215 AC 60	323163
230 AC 60	195054
115 AC 50	205687
120 AC 50	290899
220 AC 50	248640
230 AC 50	205688
240 AC 50	279926
415 AC 50	237544
460 AC 50	205689
110 AC 25	231583

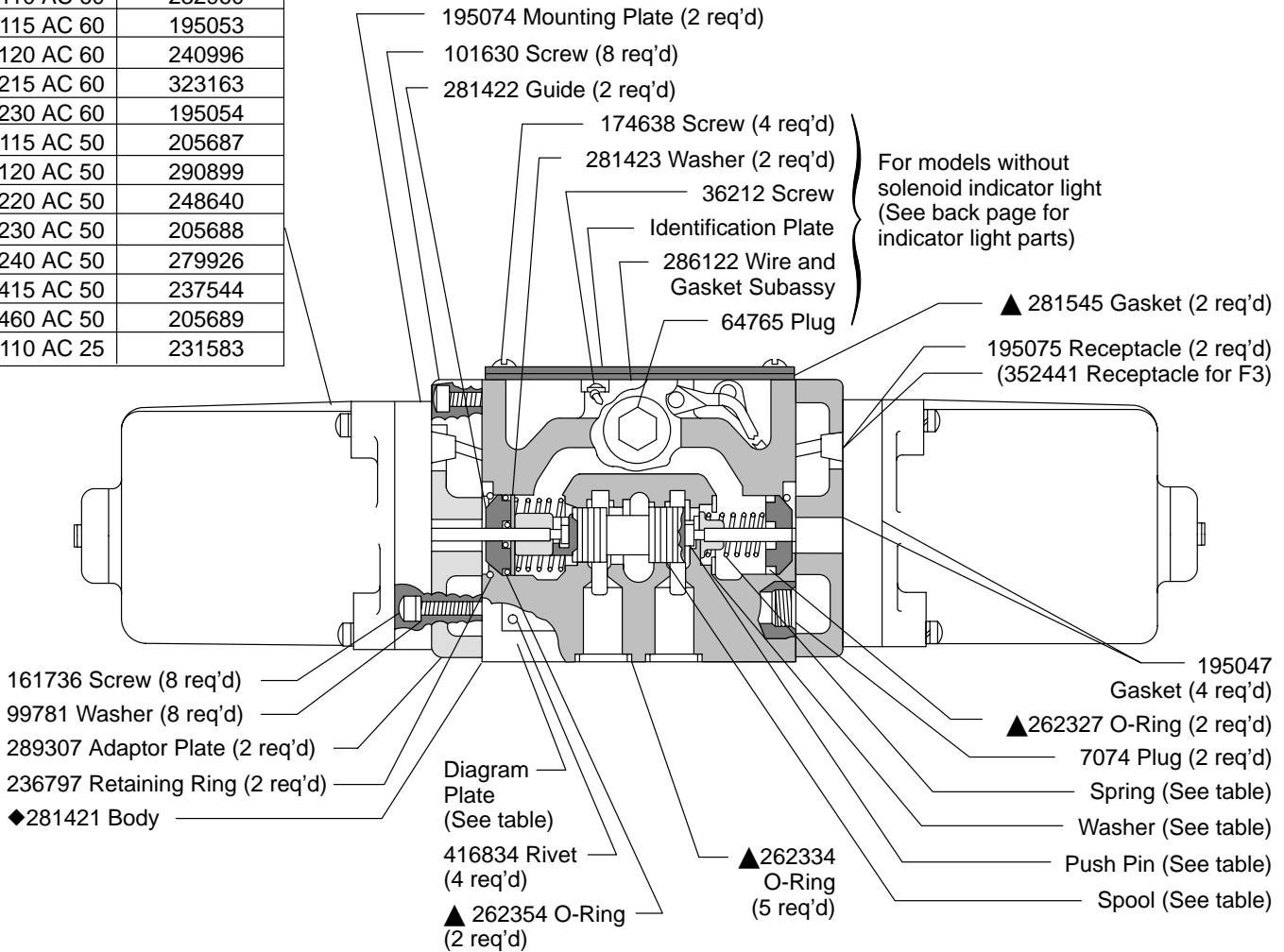

◆ Not Available for Sale

▲ Included in F3 Seal Kit 919359

Model	Diagram Plate	Spool	Washer (2 req'd)	Spring (2 req'd)	Push Pin (2 req'd)
DG4S4-010C-H-(*)-50	290341	213230	211846	290072	289340
DG4S4-012C-H-(*)-50	290343	213231			
DG4S4-013C-H-(*)-50	290344	239903			
DG4S4-016C-H-(*)-50	290345	213232			
DG4S4-017C-H-(*)-50	290346	236624			
DG4S4-018C-H-(*)-50	290340	235637	283637*	217323	290320
DG4S4-0133C-H-(*)-50	577484	236615	211846	290072	289340

* Assemble on Spool with sharp break edge of Washer toward Spring

Solenoid Indicator Light Kit (Includes All Parts Identified)	
Voltage Range	Kit
100 thru 125	941615

Note
Refer to parts drawing
I-3487-S for models with
plug-in feature.

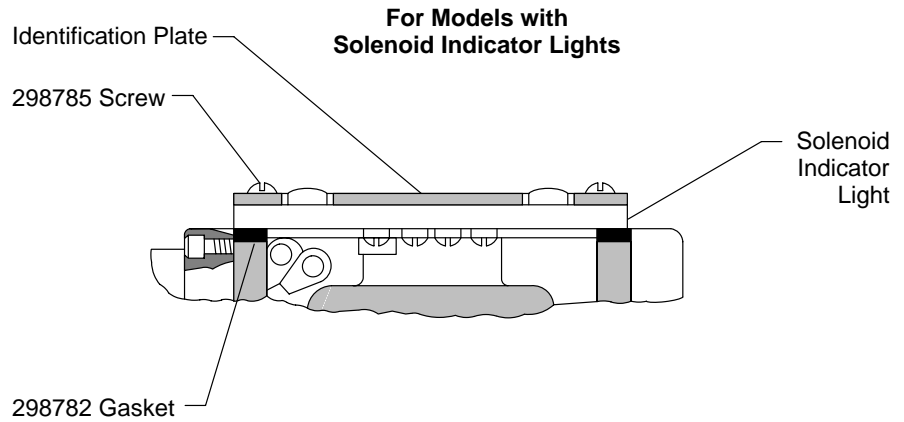

Model Code

(F3) - DG4S * (L) - 01 * C - H - (AC**) - 50**

└─┬─┘
└─┬─┘
└─┘
└─┘
└─┘
└─┘
└─┘
└─┬─┘
└─┘

1
2
3
4
5
6
7
8
9
10

1 Seal Material

F3 - Seals for mineral oil and fire resistant fluids

2 Model Series

DG4S - Directional valve, subplate mounted, solenoid operated, sliding spool

3 Flow Directions

2 - 2 way
4 - 4 way

4 L-Solenoid Indicator Light

Omitted - None

5 Series

6 Spool Type

7 Spring Offset

8 Oil Imersed Solenoid

9 Solenoid Voltage and Frequency
Omitted-115AC60
Standard

10 Design

For satisfactory service life of these components, use full flow filtration to provide fluid which meets ISO cleanliness code 20/18/15 or cleaner. Selections from Eaton OFP, OFR, and OFRS series are recommended.