

Service Data

Vickers®

# Directional Controls

---



## Air Operated Directional Valves

DG18S-8-\*A/C-10-(LH)

DG18S-8-\* -10

Model	Spool	ID Plate with Circuit Diagram			
		No-Spring Detent (N)	Spring Cent. (C)	Offset (A)	
				L.H.	R.H.
DG18S-8-0*-10	363495	434313	431907	434312	431557
DG18S-8-1*-10	*276623	—	431908	—	—
DG18S-8-2*-10	363496	—	431555	—	—
DG18S-8-2A-10	276624	434313	—	434312	431557
DG18S-8-3*-10	*276625	—	431909	—	—
DG18S-8-4*-10	276626	—	431556	—	—
DG18S-8-6*-10	363498	434313	431910	434312	431557
DG18S-8-8*-10	363499	—	431556	—	—
DG18S-8-9*-10	363500	—	431907	—	—
DG18S-8-33*-10	363501	434313	431910	434312	431557

RH assembly shown. For LH assembly, Air Operated end parts & Spring Offset parts are interchanged. Also, the RH plate is removed and replaced by the LH I.D. plate.

■ Plug Torques (Oiled)		
Plug	N.m	lb. in.
343740	10.0-11.8	90-105
398071	3.4-4.0	30-35
407533	3.4-4.0	30-35

**\*Note**  
Assemble Type "1" & "3" spools with narrow center land toward "A" end of valve. "A" end of valve is defined as being closest to cylinder port "A".

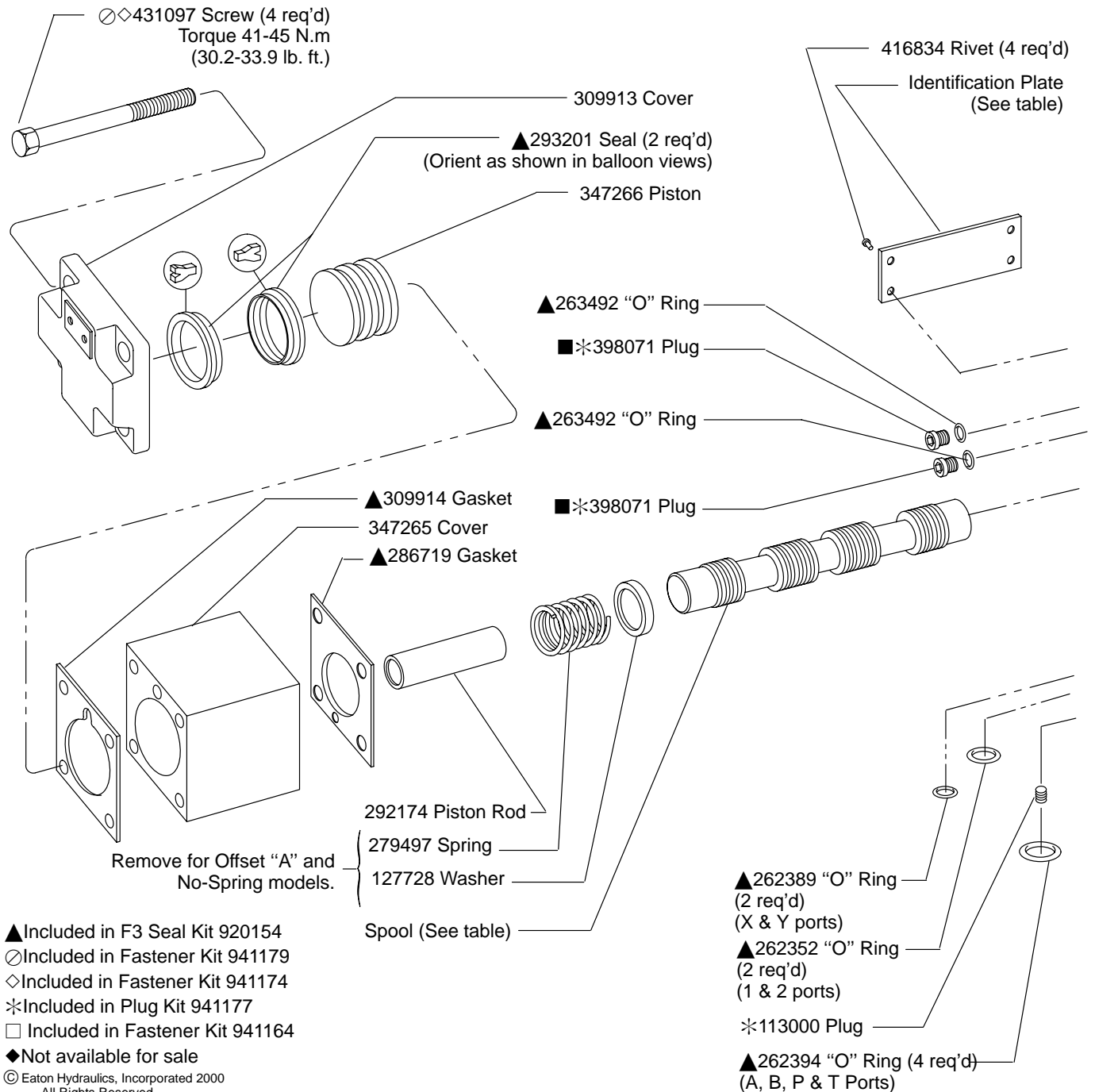

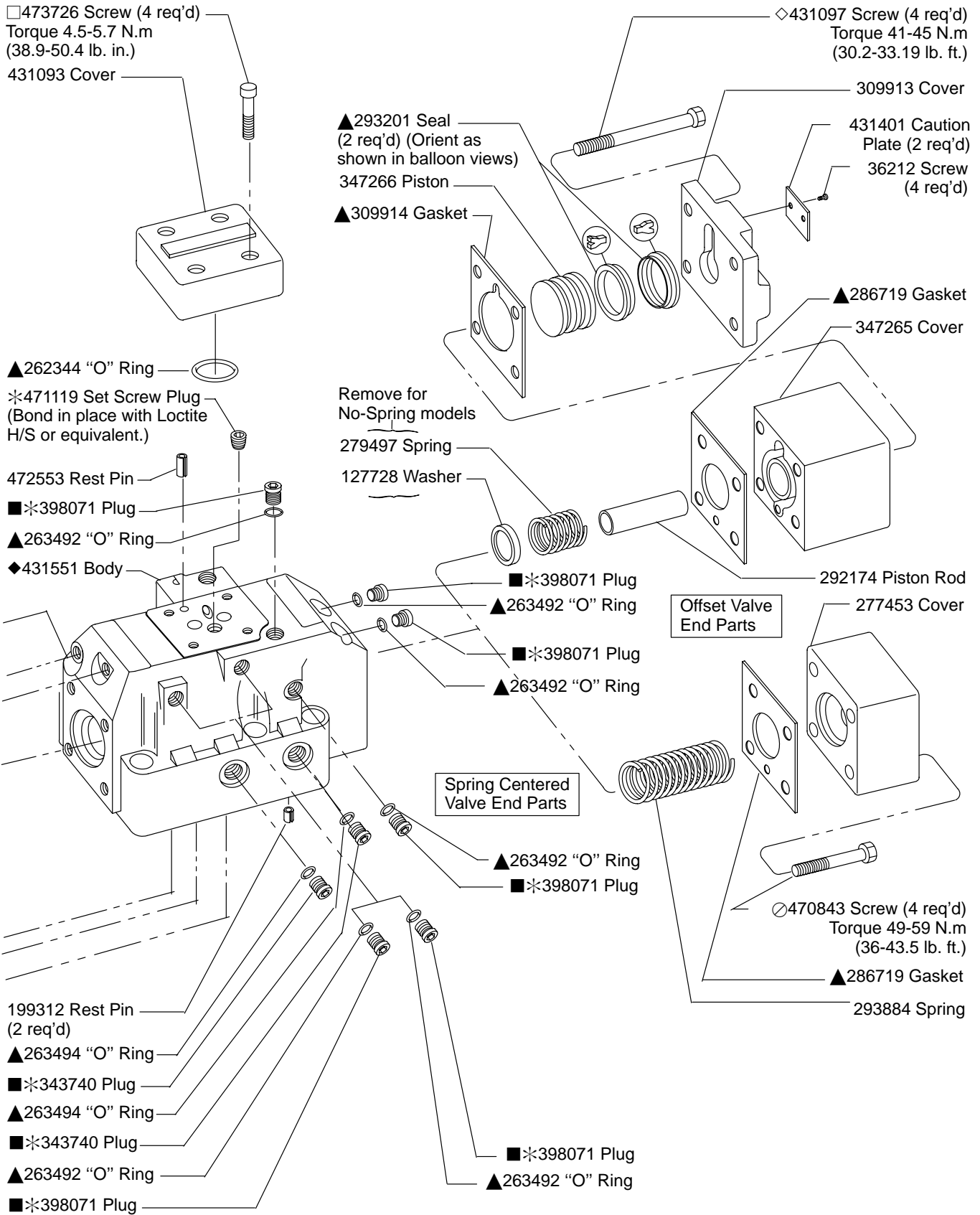

**Note**

- Parts included in service kits will not be sold separately.
- All threaded fasteners are metric.
- End cover screws are metric grade 12, 9.

# Model Code

**(F3) DG18S - 8 - \* \* - 10 (LH)**

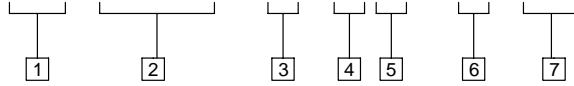

---

**1 Seal Material**

**F3** - Special seals (Omit for standard models.)

---

**2 Model Series**

**DG18S** - Directional control valve, subplate mounted, air operated, rated pressure 210 bar (3000 psi)

---

**3 Interface**

**8** - CETOP 8

---

**4 Spool Type**

---

**5 Valve Type**

**A** - Spring Offset  
**C** - Spring Centered  
**Omit** - No-Spring

---

**6 Design**

---

**7 Spring Offset Models**

**LH** - Left hand assembly

For satisfactory service life of these components in industrial applications, use full flow filtration to provide fluid which meets ISO cleanliness code 18/15 or cleaner. Selections from Eaton OFP, OFR, and OFRS series are recommended.