

FS(O) 5206

Type	FS 5206 A	FS 5206B	FSO 5206B
Max. Input Torque [Nm]	700	750	825
Mass [kg]	117*/134		
Oil Quantity [l]	6.5		
Clutch Housing	SAE 2		
GCW [T]	28 (for trucks and bus application)		

*Without Clutch Housing

General view:

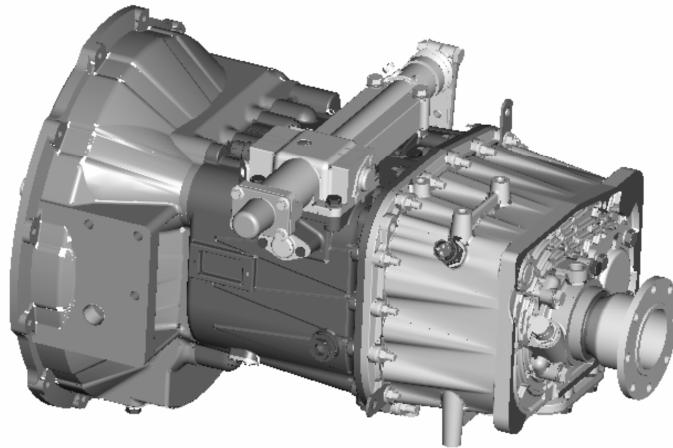
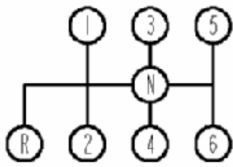

Gear ratios:

TYPE \ GEAR	1st	2nd	3rd	4th	5th	6th	Rev
FS 5206A	9.03	5.25	3.10	2.00	1.38	1.00	8.07
FS 5206B	7.54	4.38	2.80	1.87	1.30	1.00	6.74
FSO 5206B	6.08	3.53	2.09	1.35	1.00	0.79	5.43

FS(O) 5206

Basic dimensions (horizontal version):

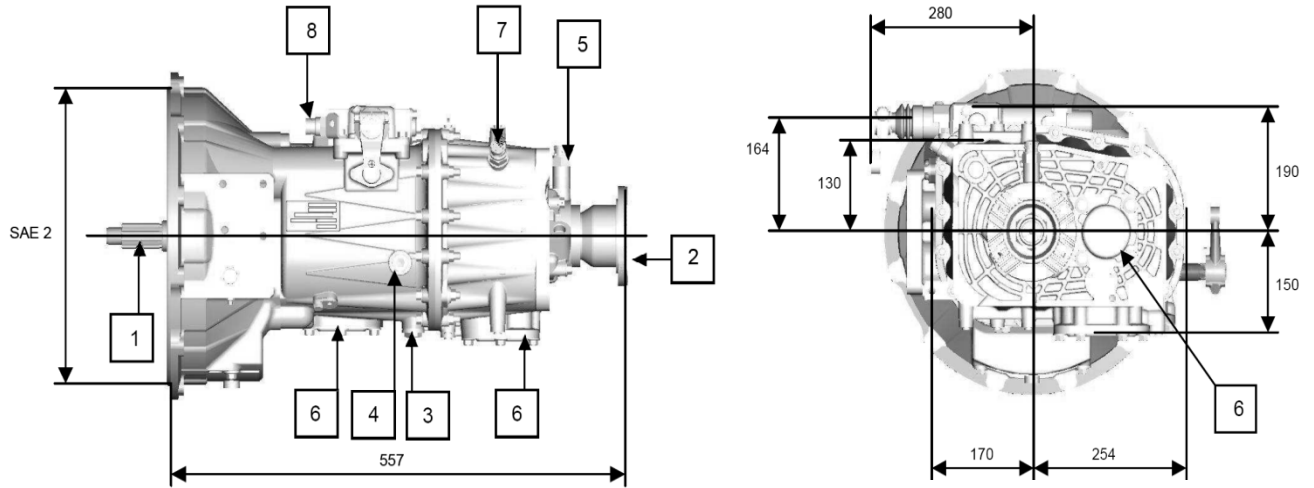

- | | |
|-------------------|-------------------------|
| 1. Input shaft | 5. Tachometer sensor |
| 2. Output flange | 6. PTO opening |
| 3. Oil strainer | 7. Reverse light switch |
| 4. Oil level plug | 8. Neutral light switch |

On a base of agreement with customer gearbox can be additionally fitted with:

- PTO opening (rear or side)
- PPA
- Clutch release mechanism
- Right hand & Left hand drive
- Mechanical and electrical speedometer
- Output flange DIN or „yoke” type
- Direct Control option
- Retarder and Magnetarder possibility