

RELEASE STATUS
Production

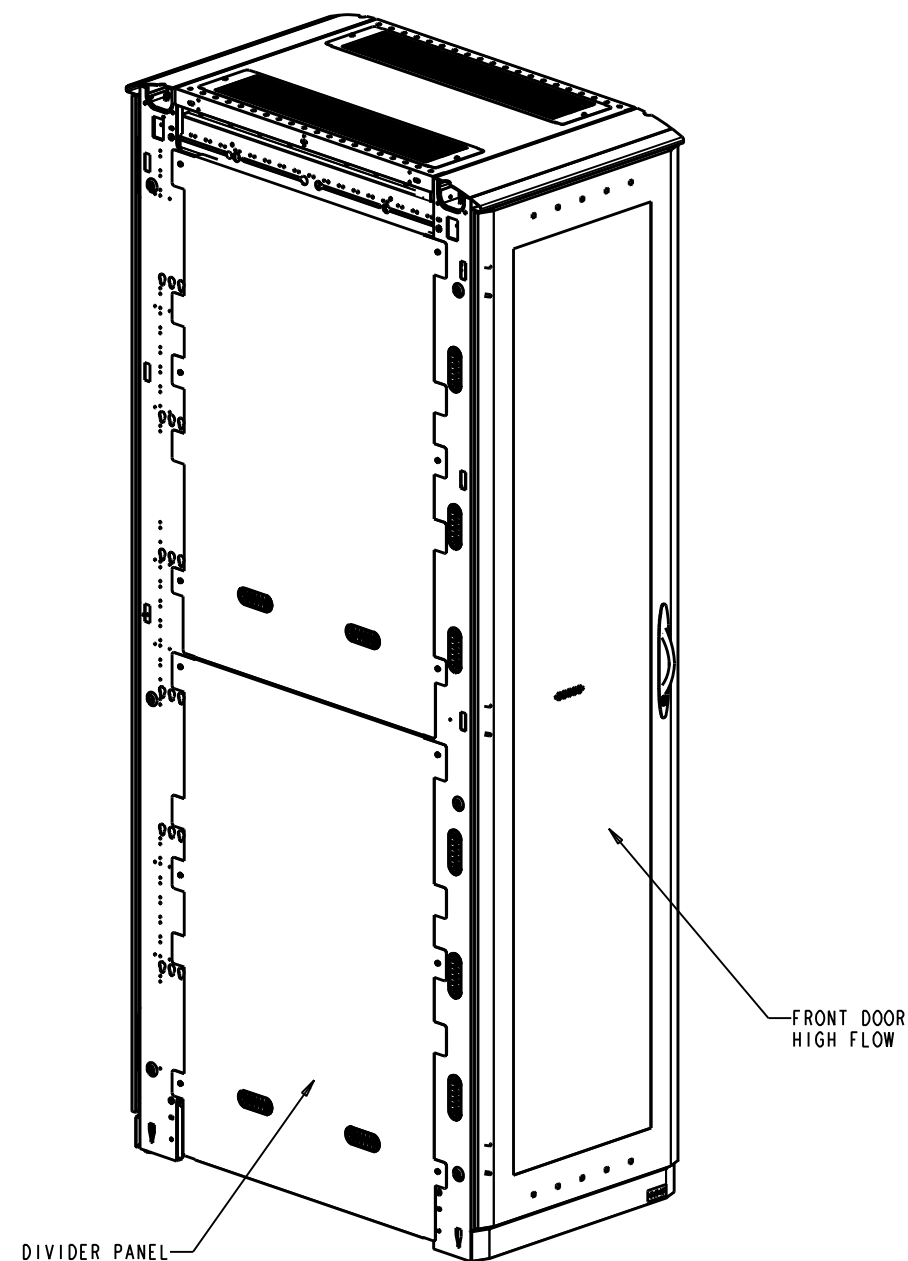

FRONT ISO

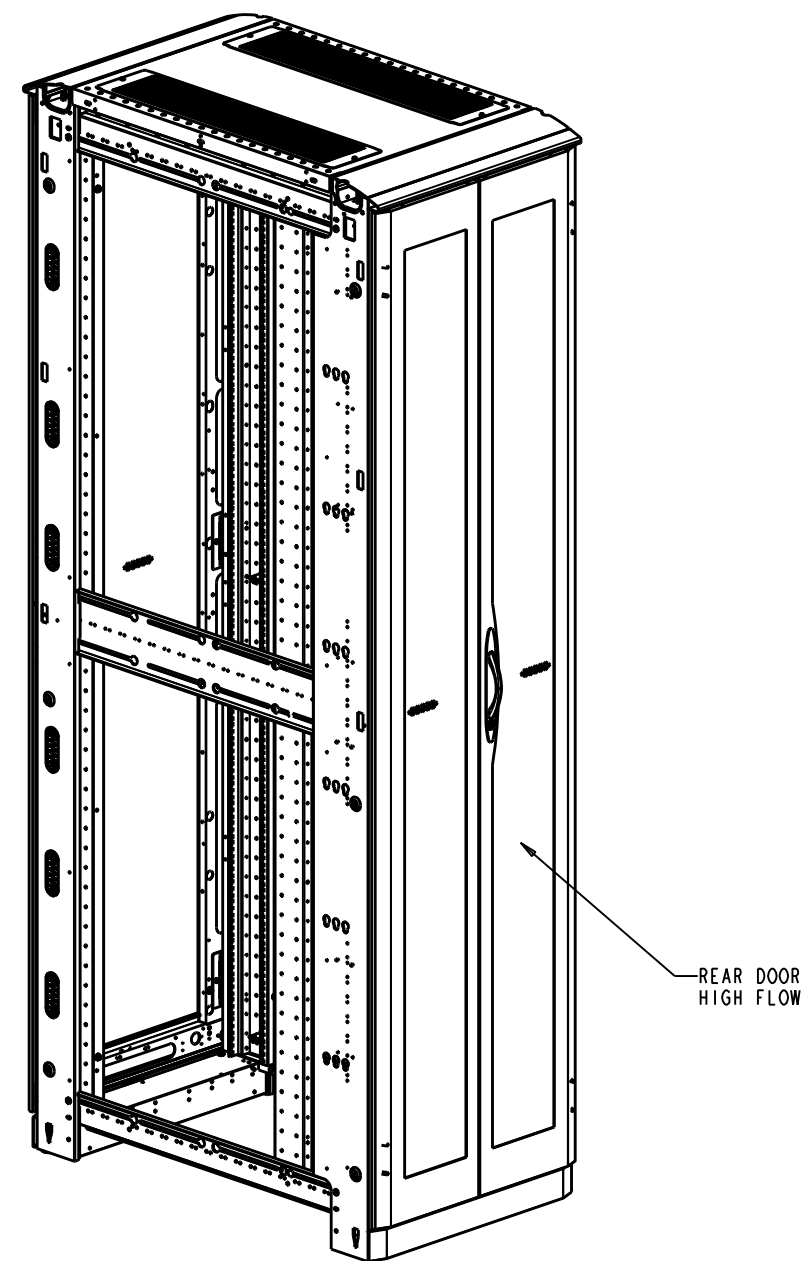

REAR ISO

SHIPPING WEIGHT: 400 LBS

REV	REV. DATE	REV'D BY	PRODUCTION RELEASE	ECN OR EPR NUMBER
-	-	-	PRODUCTION RELEASE	EPR113222
-	-	-	CURRENT REVISION DESCRIPTION	-

THIS DRAWING CONTAINS PROPRIETARY INFORMATION AND IS LOANED SUBJECT TO RETURN UPON DEMAND AND UPON THE EXPRESS CONDITION THAT IT WILL NOT BE USED IN ANY WAY DETRIMENTAL TO THE INTEREST OF EATON CORPORATION

DRAWN IN THIRD ANGLE PROJECTION

TOLERANCE UNLESS SPEC'D
 .XX ± .02
 .XXX ± .005
 < ± .1
 ALL DIMENSIONS IN INCHES

CAGE NUMBER: 81824	CUSTOMER: EATON DIR FLD SALES
DESIGN MGMT SITE: Worcester	DES. BY D Nelson 09/13/11
MATERIAL:	DRWN. BY D Nelson 09/13/11
MATERIAL FINISH:	PROD. GRP 50 - Paramount
SPEC #:	COLOR: -
	CRS GA: N/A
	OTHER: -

EATON	
CONFIG - 51U X 24W X 42D PARAMOUNT, RACK HYGIENE, 2 EPDU	
SHEET: 1 OF 8	REV DATE: -
D PMT512442H	REV -

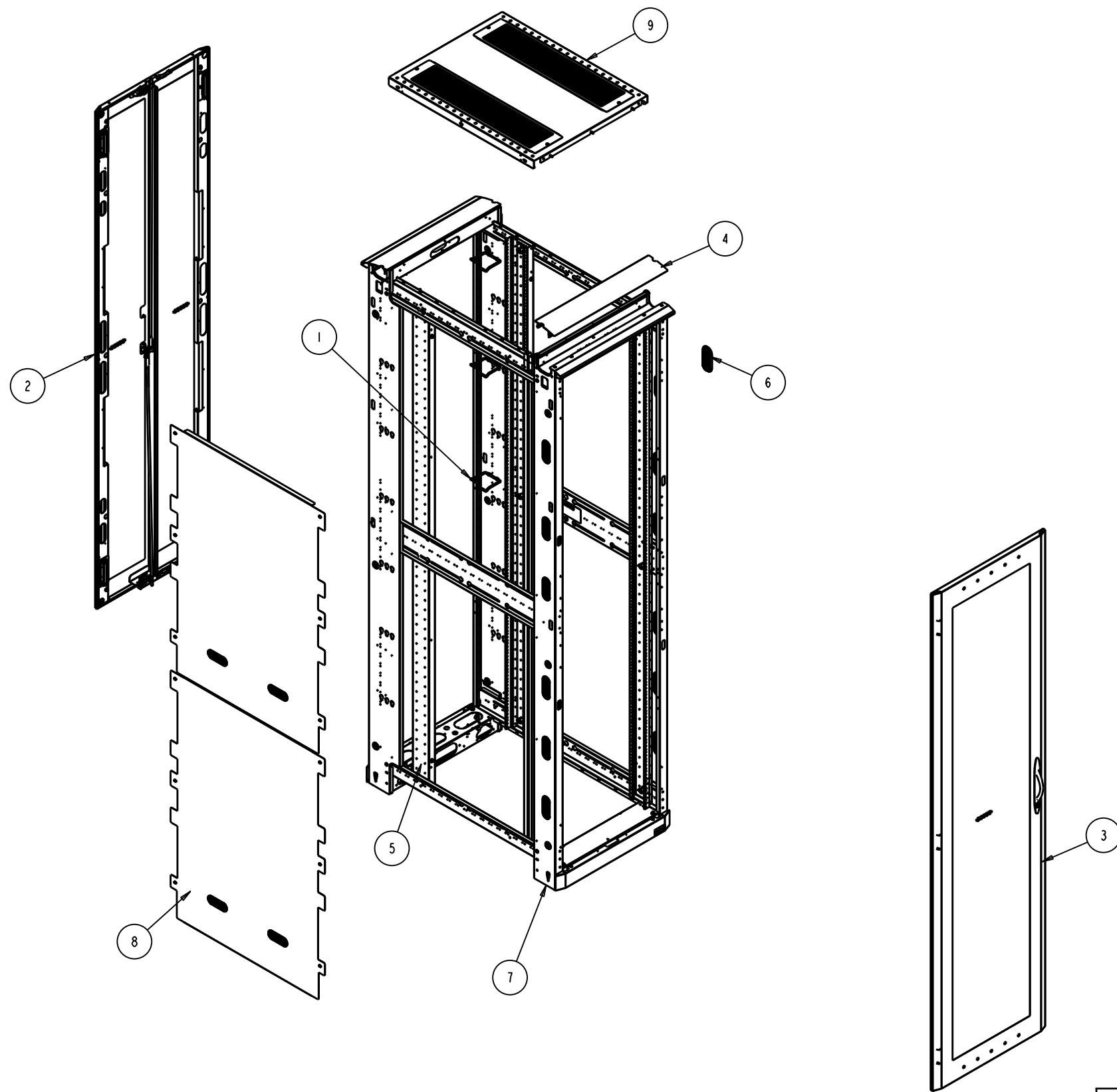

ASSEMBLY WIRING NOTE:

- 1. GROUND ALL DOORS, RAILS, TOP AND DIVIDER PANELS.
USE GROUNDING LANYARDS FROM KIT P/N GRNDPMT.
USE STANDARD W/L GROUND POINTS FOR ATTACHMENT AREAS.

ITEM	TYPE	DOCUMENT #	REV	DESCRIPTION	QTY
10	SA	GRNDPMT	-	GROUND KIT - PARAMOUNT	1
9	MA	PMTNWP2442	-	ASSEMBLY - TOP PANEL, 24W X 40D	1
8	MA	PMTJVD5142S	-	DIVIDER PANEL ASY - 51U X 40D	1
7	MA	PMTFRM512440	-	WLD - FRAME, 51U X 24W X 40D	1
6	MA	JWOVLGROM	A	GROMMET - OVAL 1.5WX4L	12
5	MA	JRM10006	B	RACK MOUNT RAILS - 51U	1
4	MA	JFTK24_	B	FRAME TRIM KIT - 24"W	1
3	MA	JDDHF9624L	-	DOOR, HIGH FLOW	1
2	MA	JDDHF9624	-	ASSEMBLY - SPLIT DOOR, HIGH FLOW	1
1	MA	CMDRNR032U_	-	D-RING KIT, 2U	1

THIS DRAWING CONTAINS PROPRIETARY INFORMATION AND IS LOANED SUBJECT TO RETURN UPON DEMAND AND UPON THE EXPRESS CONDITION THAT IT WILL NOT BE USED IN ANY WAY DETRIMENTAL TO THE INTEREST OF EATON CORPORATION

DRAWN IN THIRD ANGLE PROJECTION

TOLERANCE UNLESS SPEC'D
 .XX ± .02
 .XXX ± .005
 < ± .1"

ALL DIMENSIONS IN INCHES

CAGE NUMBER: 81824
 CUSTOMER: EATON DIR FLD SALES
 DES. BY: DNeison 09/13/11
 DRWN. BY: DNeison 09/13/11
 DESIGN MGMT SITE: Worcester
 PROD. GRP: 50 - Paramount
 COLOR: -
 CRS GA: N/A
 OTHER: -
 MATERIAL: -
 MATERIAL FINISH: -
 SPEC #: -



CONFIG - 51U X 24W X 42D
PARAMOUNT, RACK HYGIENE, 2 EPDU

SHEET: 2 OF 8 REV DATE: -

D PMT512442H REV -

REV	REV. DATE	REV'D BY	PRODUCTION RELEASE	ECN OR EPR NUMBER
-	-	-	PRODUCTION RELEASE	EPRI13222
-	-	-	CURRENT REVISION DESCRIPTION	-

RELEASE STATUS
Production

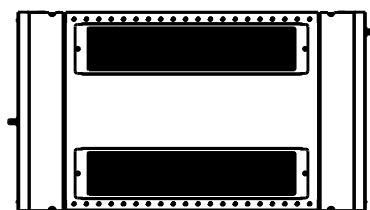

TOP

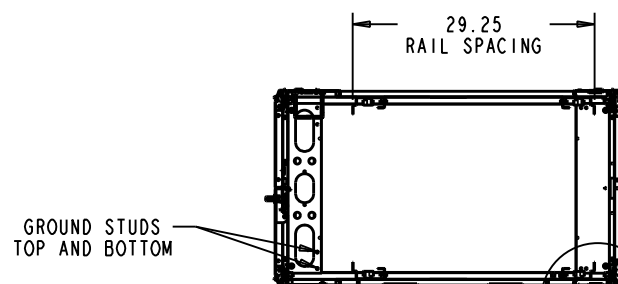

29.25
RAIL SPACING

GROUND STUDS
TOP AND BOTTOM

SECTION B-B

DETAIL D
SCALE 0.200



2.00 FROM FRONT
OF RAIL TO FRONT
OF CORNER POST

SEE DETAIL D

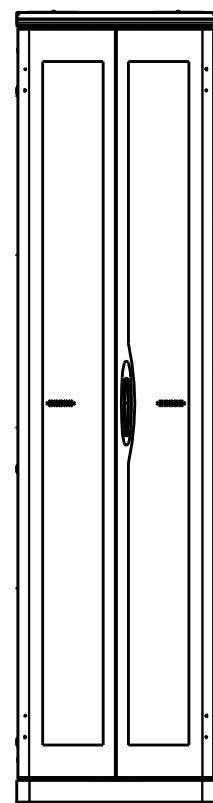

REAR

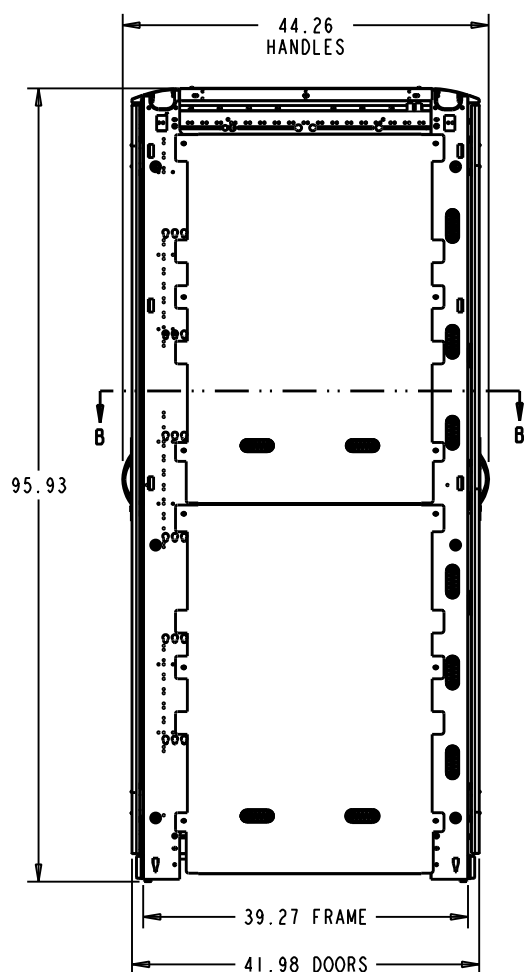

LEFT SIDE

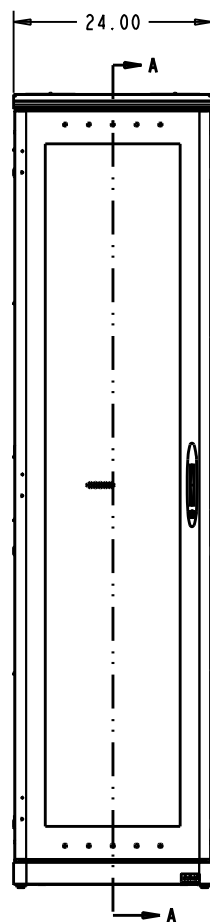

FRONT

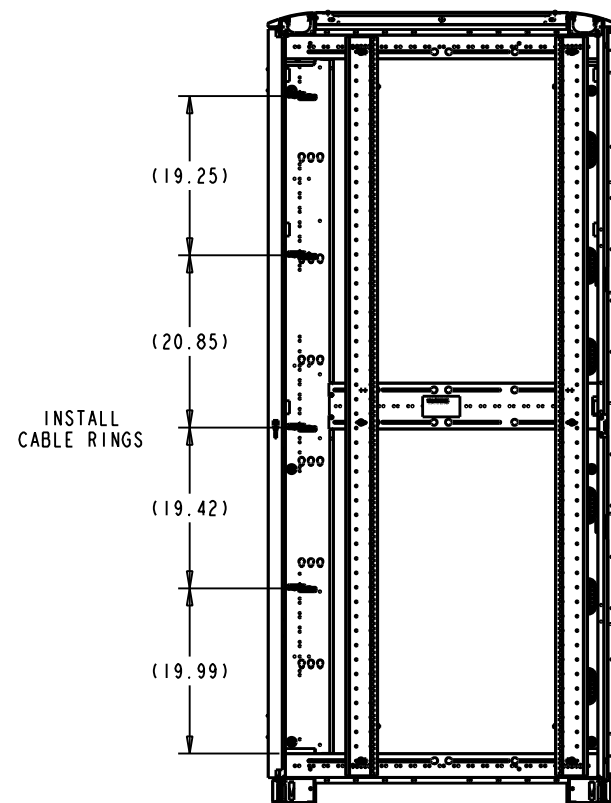

INSTALL
CABLE RINGS

SECTION A-A

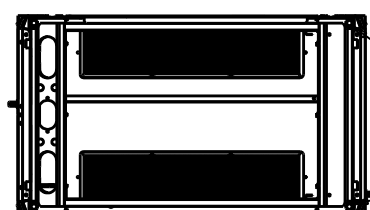
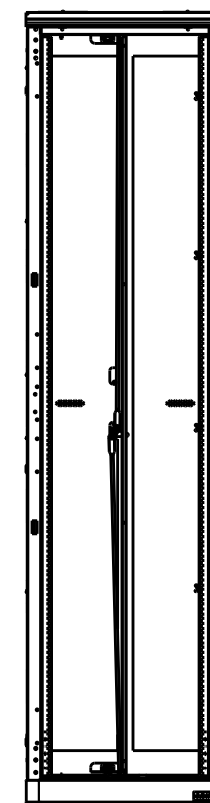

LEVELING FEET

BOTTOM

REV	REV. DATE	REV'D BY	PRODUCTION RELEASE	ECN OR EPR NUMBER
-	-	-	PRODUCTION RELEASE	EPR113222
-	-	-	CURRENT REVISION DESCRIPTION	-

THIS DRAWING CONTAINS PROPRIETARY INFORMATION AND IS LOANED SUBJECT TO RETURN UPON DEMAND AND UPON THE EXPRESS CONDITION THAT IT WILL NOT BE USED IN ANY WAY DETRIMENTAL TO THE INTEREST OF EATON CORPORATION

DRAWN IN THIRD ANGLE PROJECTION

TOLERANCE UNLESS SPEC'D
XXX ± .02
.XXX ± .005
< ± 1"

ALL DIMENSIONS IN INCHES

CAGE NUMBER: 81824	CUSTOMER: EATON DIR FLD SALES
DESIGN MGMT SITE: Worcester	DES. BY D Nelson 09/13/11
MATERIAL:	DRWN. BY D Nelson 09/13/11
MATERIAL FINISH:	PROD. GRP 50 - Paramount
SPEC #:	COLOR: -
	CRS GA: N/A
	OTHER: -

EATON	
CONFIG - 5IU X 24W X 42D PARAMOUNT, RACK HYGIENE, 2 EPDU	
SHEET: 3 OF 8	REV DATE: -
D PMT512442H	REV -