

RELEASE STATUS
Production

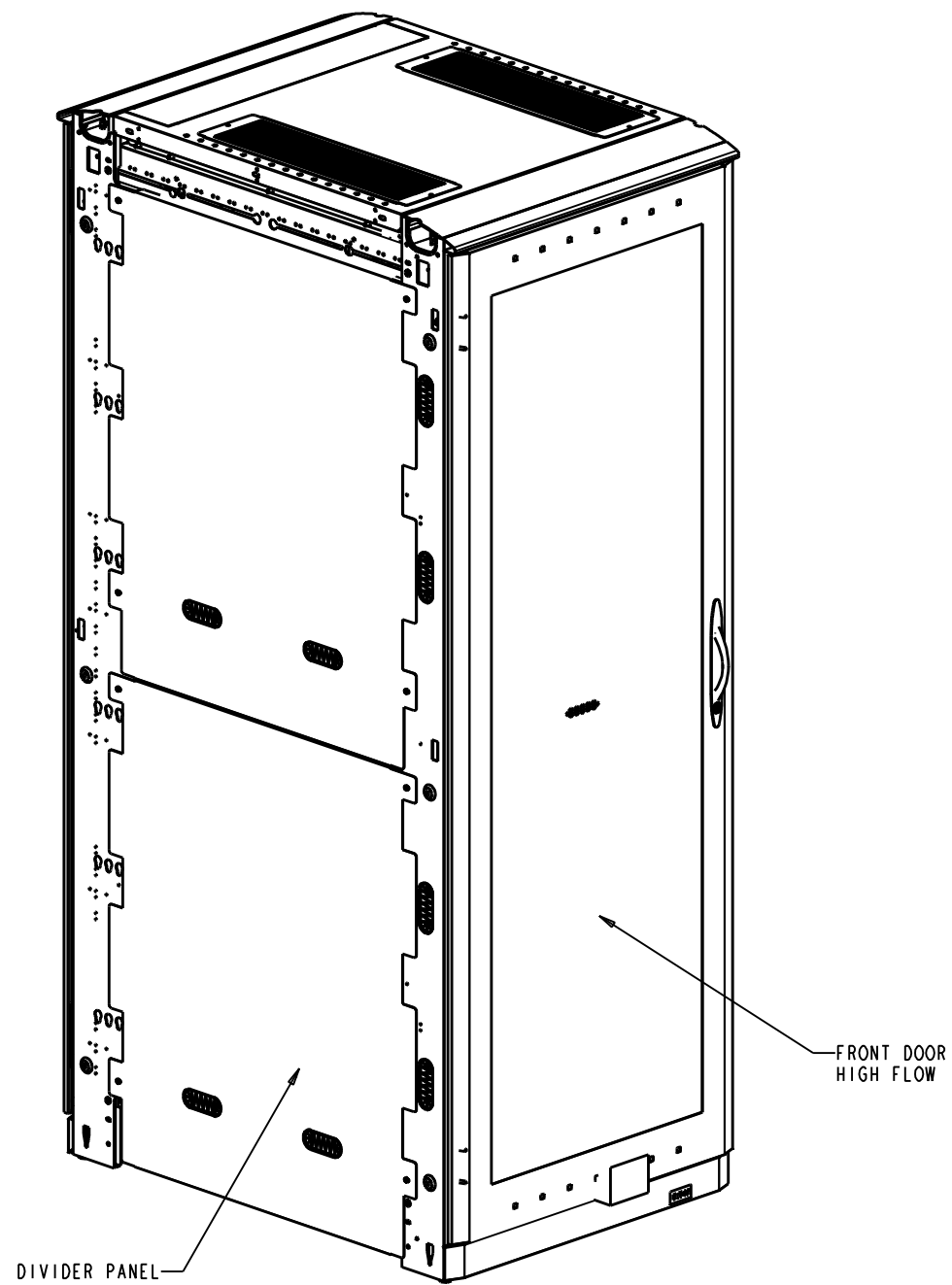

FRONT ISO

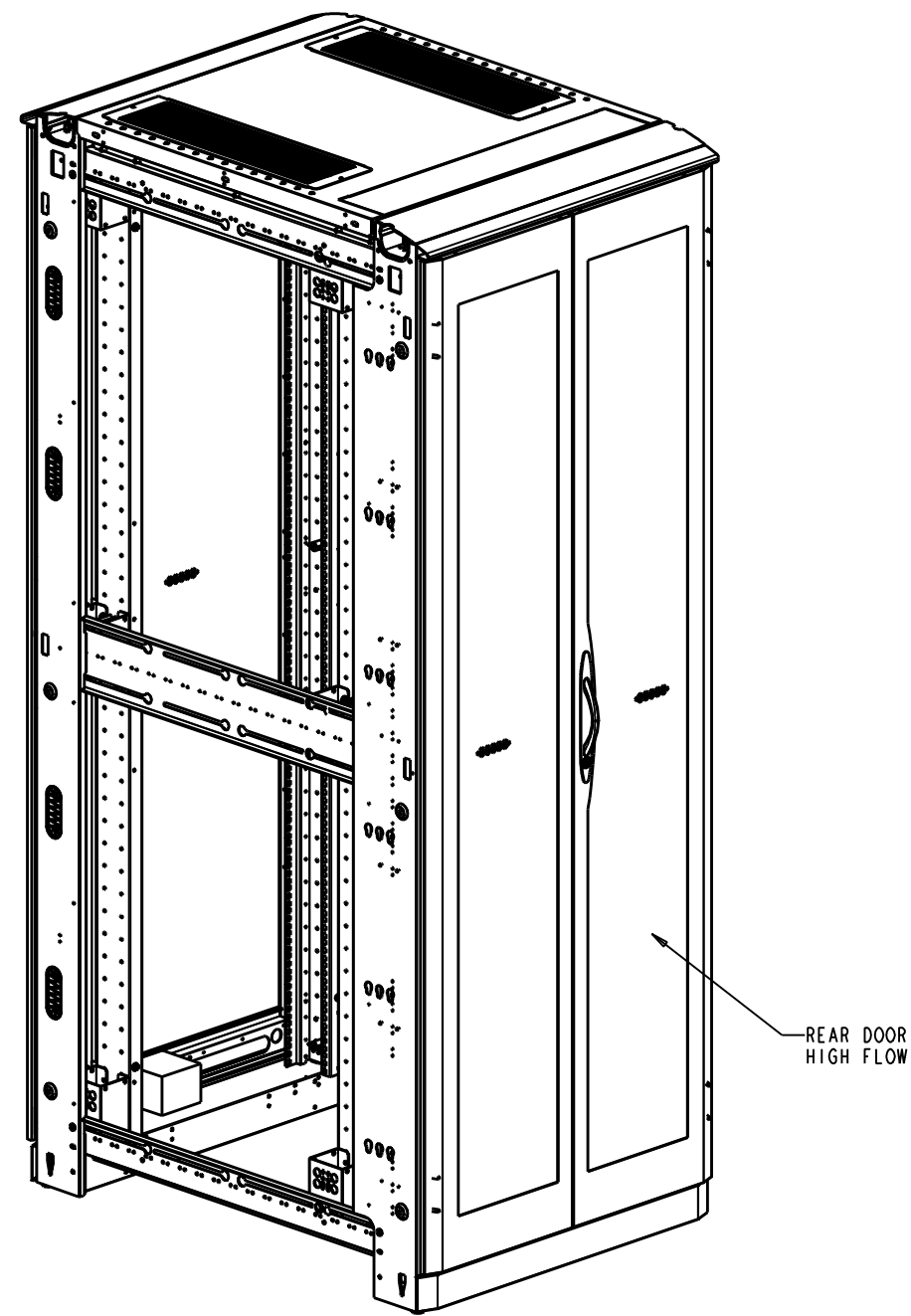

REAR ISO

SHIPPING WEIGHT: 465 LBS

REV	REV. DATE	REV'D BY	CURRENT REVISION DESCRIPTION	ECN OR EPR NUMBER
-	11/28/11	MQuaglia	PRODUCTION RELEASE	EPR113387

THIS DRAWING CONTAINS PROPRIETARY INFORMATION AND IS LOANED SUBJECT TO RETURN UPON DEMAND AND UPON THE EXPRESS CONDITION THAT IT WILL NOT BE USED IN ANY WAY DETRIMENTAL TO THE INTEREST OF EATON CORPORATION

DRAWN IN THIRD ANGLE PROJECTION

TOLERANCE UNLESS SPEC'D
 .XX ± .02
 .XXX ± .005
 < ± .1"

ALL DIMENSIONS IN INCHES

CAGE NUMBER: 81824	CUSTOMER: EATON CHANNEL
DES. BY: MQuaglia	11/28/11
DRWN. BY: MQuaglia	11/28/11
DESIGN MGMT SITE: Worcester	PROD. GRP: 50 - Paramount
MATERIAL:	COLOR: -
MATERIAL FINISH:	CRS GA: N/A
SPEC #:	OTHER: -

EATON	
PMOUNT CONFIG 44U X 30W X 42D RACK HYGIENE, 2 EPDUS & HCS TOP	
SHEET: 1 OF 8	REV DATE: 11/28/11
D PMT443042HCSTPL	REV -

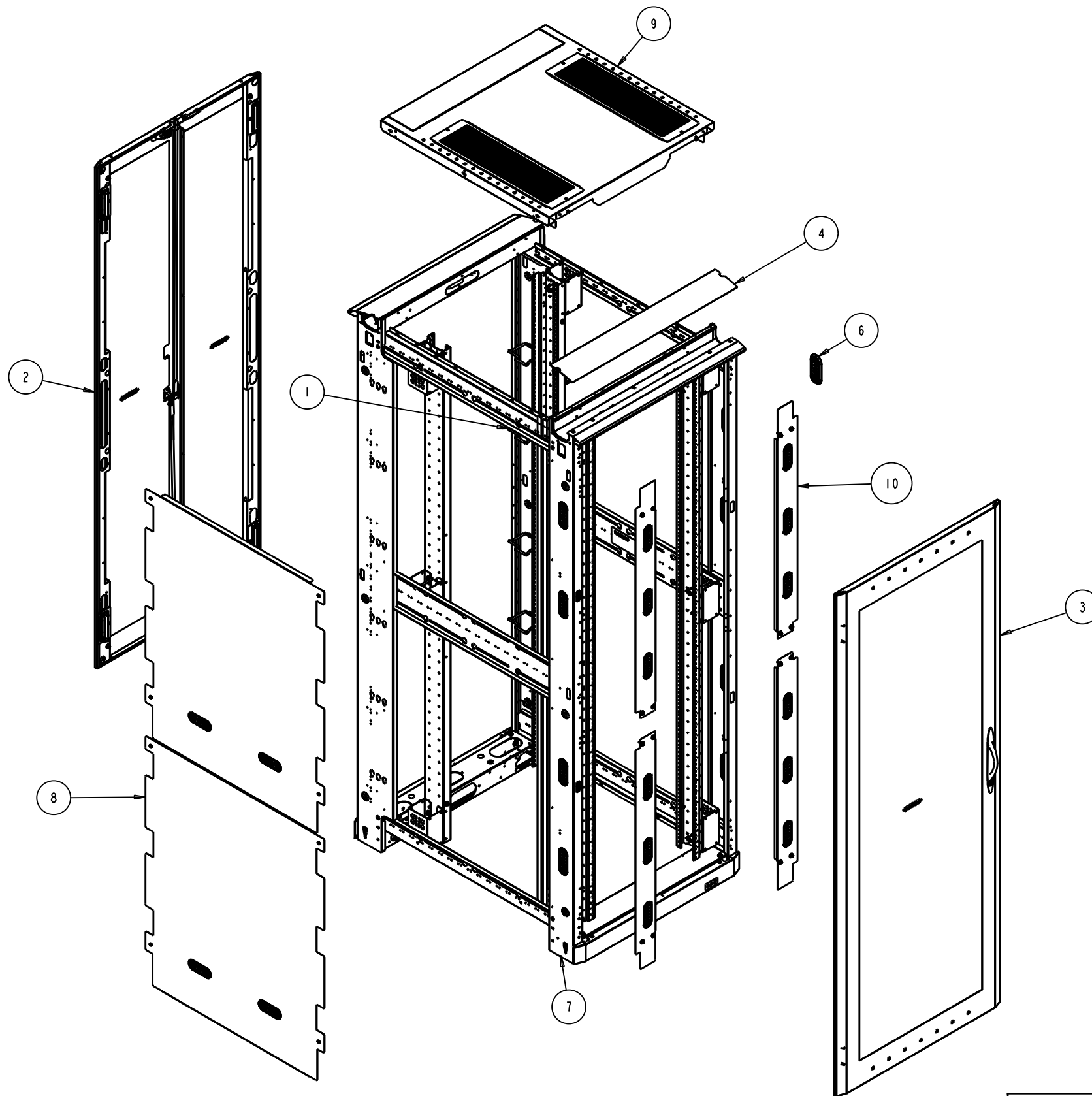

ASSEMBLY WIRING NOTE:

- 1. GROUND ALL DOORS, RAILS, TOP AND DIVIDER PANELS.
USE GROUNDING LANYARDS FROM KIT P/N GRNDPMT.
USE STANDARD W/L GROUND POINTS FOR ATTACHMENT AREAS.

ITEM	TYPE	DOCUMENT #	REV	DESCRIPTION	QTY
11	SA	GRNDPMT	-	GROUND KIT - PARAMOUNT	1
10	MA	PMTVDP4430	-	VERTICAL BLANKING PANELS	1
9	MA	PMTNWP3042HCS	A	HCS TOP PANEL - 30W X 42D, DBL	1
8	MA	PMTJVD4442S	A	DIVIDER PANEL ASY - 44U X 42D	1
7	MA	PMTFRM443040	A	WLD - FRAME, 44U X 30W X 40D	1
6	MA	JWOVLGROM	A	GROMMET - OVAL 1.5WX4L	8
5	MA	JRR44CMSQ	C	RM REDUCER RAILS - 44U,	1
4	MA	JFTK30_	B	FRAME TRIM KIT - 30"W	1
3	MA	JDHF8430L	-	DOOR, HIGH FLOW	1
2	MA	JDDHF8430	-	ASSEMBLY - SPLIT DOOR, HIGH FLOW	1
1	MA	CMDRNR032U_	-	D-RING KIT, 2U	1

THIS DRAWING CONTAINS PROPRIETARY INFORMATION AND IS LOANED SUBJECT TO RETURN UPON DEMAND AND UPON THE EXPRESS CONDITION THAT IT WILL NOT BE USED IN ANY WAY DETRIMENTAL TO THE INTEREST OF EATON CORPORATION

DRAWN IN THIRD ANGLE PROJECTION

TOLERANCE UNLESS SPEC'D
.XX ± .02
.XXX ± .005
∠ ± 1°
ALL DIMENSIONS IN INCHES

CAGE NUMBER: 81824
CUSTOMER: EATON CHANNEL
DES. BY: MQuaglia 11/28/11
DRWN. BY: MQuaglia 11/28/11
DESIGN MGMT SITE: Worcester
PROD. GRP: 50 - Paramount
COLOR: -
CRS GA: N/A
OTHER: -
MATERIAL:
MATERIAL FINISH:
SPEC #:



PMOUNT CONFIG 44U X 30W X 42D
RACK HYGIENE, 2 EPDUS & HCS TOP

SHEET: 2 OF 8
REV DATE: 11/28/11
D PMT443042HCSTPL REV -

REV	REV. DATE	REV'D BY	CURRENT REVISION DESCRIPTION	ECN OR EPR NUMBER
-	11/28/11	MQuaglia	PRODUCTION RELEASE	EPR113387

RELEASE STATUS
Production

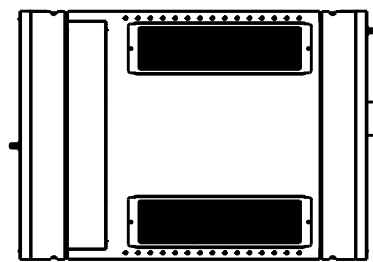

TOP

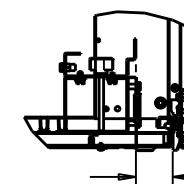
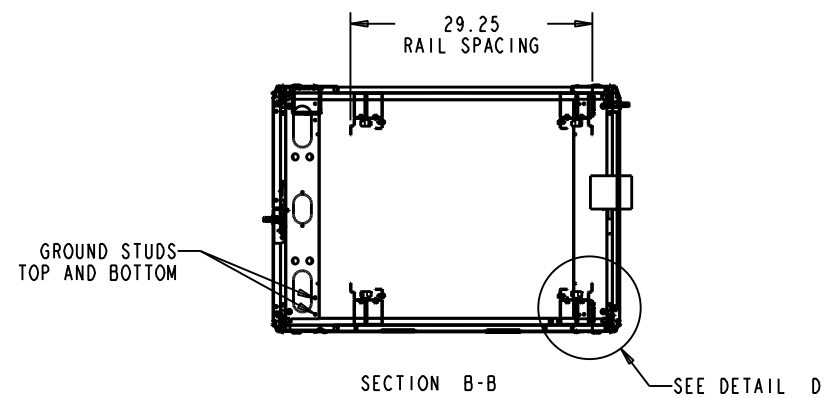

2.00 FROM FRONT OF
RAIL TO FRONT OF
CORNER POST

DETAIL D
SCALE 0.200

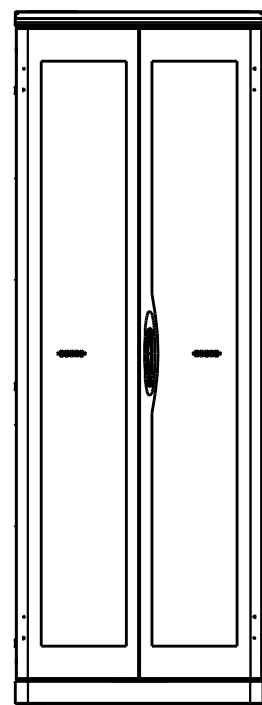

REAR

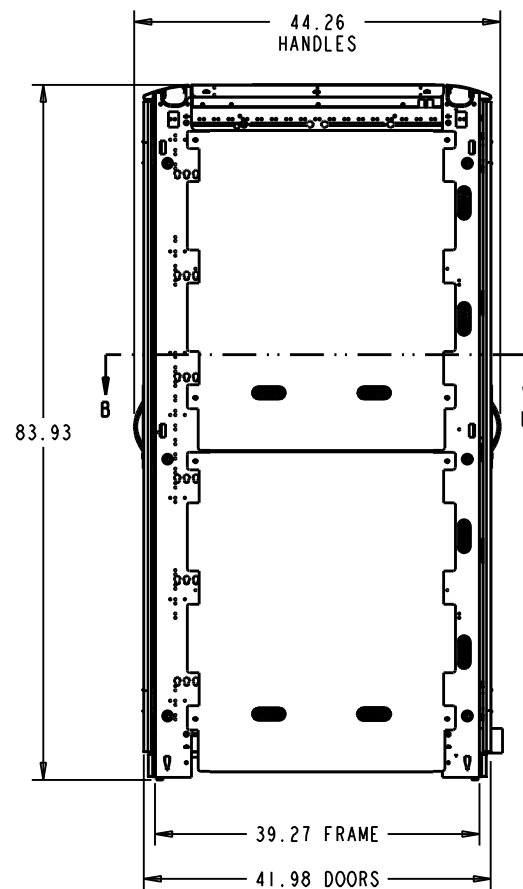

LEFT SIDE

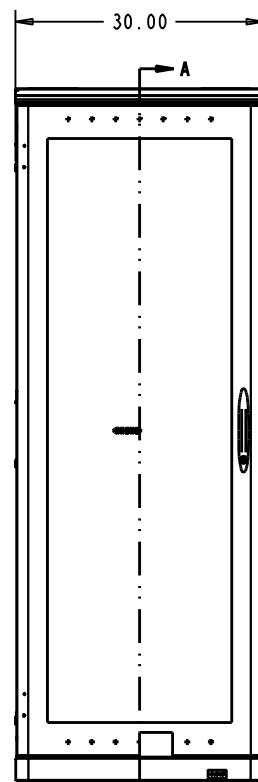

FRONT

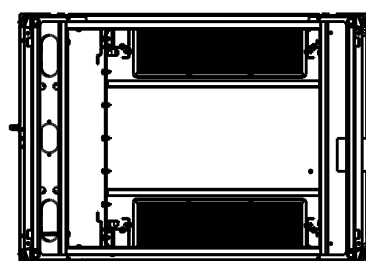
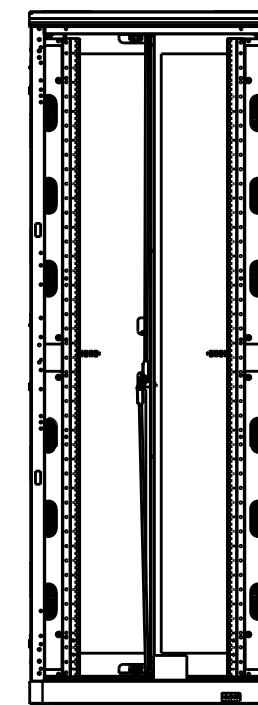
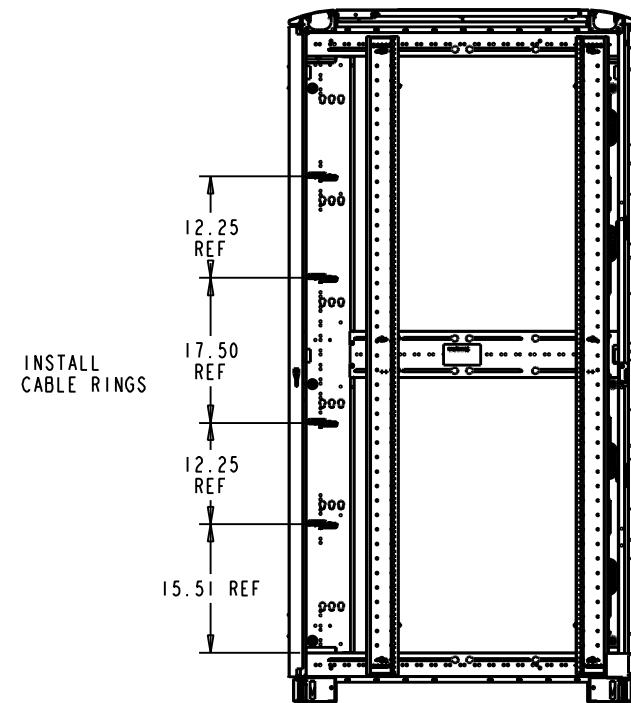

LEVELING FEET

BOTTOM

-	11/28/11	MQuaglia	PRODUCTION RELEASE	EPR113387
REV	REV. DATE	REV'D BY	CURRENT REVISION DESCRIPTION	ECN OR EPR NUMBER

THIS DRAWING CONTAINS PROPRIETARY INFORMATION AND IS LOANED SUBJECT TO RETURN UPON DEMAND AND UPON THE EXPRESS CONDITION THAT IT WILL NOT BE USED IN ANY WAY DETRIMENTAL TO THE INTEREST OF EATON CORPORATION

DRAWN IN THIRD ANGLE PROJECTION

TOLERANCE UNLESS SPEC'D
.XX ± .02
.XXX ± .005
ALL DIMENSIONS IN INCHES

CAGE NUMBER: 81824	CUSTOMER: EATON CHANNEL
DESIGN MGMT SITE: Worcester	DES. BY MQuaglia 11/28/11
MATERIAL:	DRWN. BY MQuaglia 11/28/11
MATERIAL FINISH:	PROD. GRP 50 - Paramount
SPEC #:	COLOR: -
	CRS GA: N/A
	OTHER: -

EATON	
PMOUNT CONFIG 44U X 30W X 42D RACK HYGIENE, 2 EPDUS & HCS TOP	
SHEET: 3 OF 8	REV DATE: 11/28/11
D	PMT443042HCSTPL REV -