

RELEASE STATUS
Production

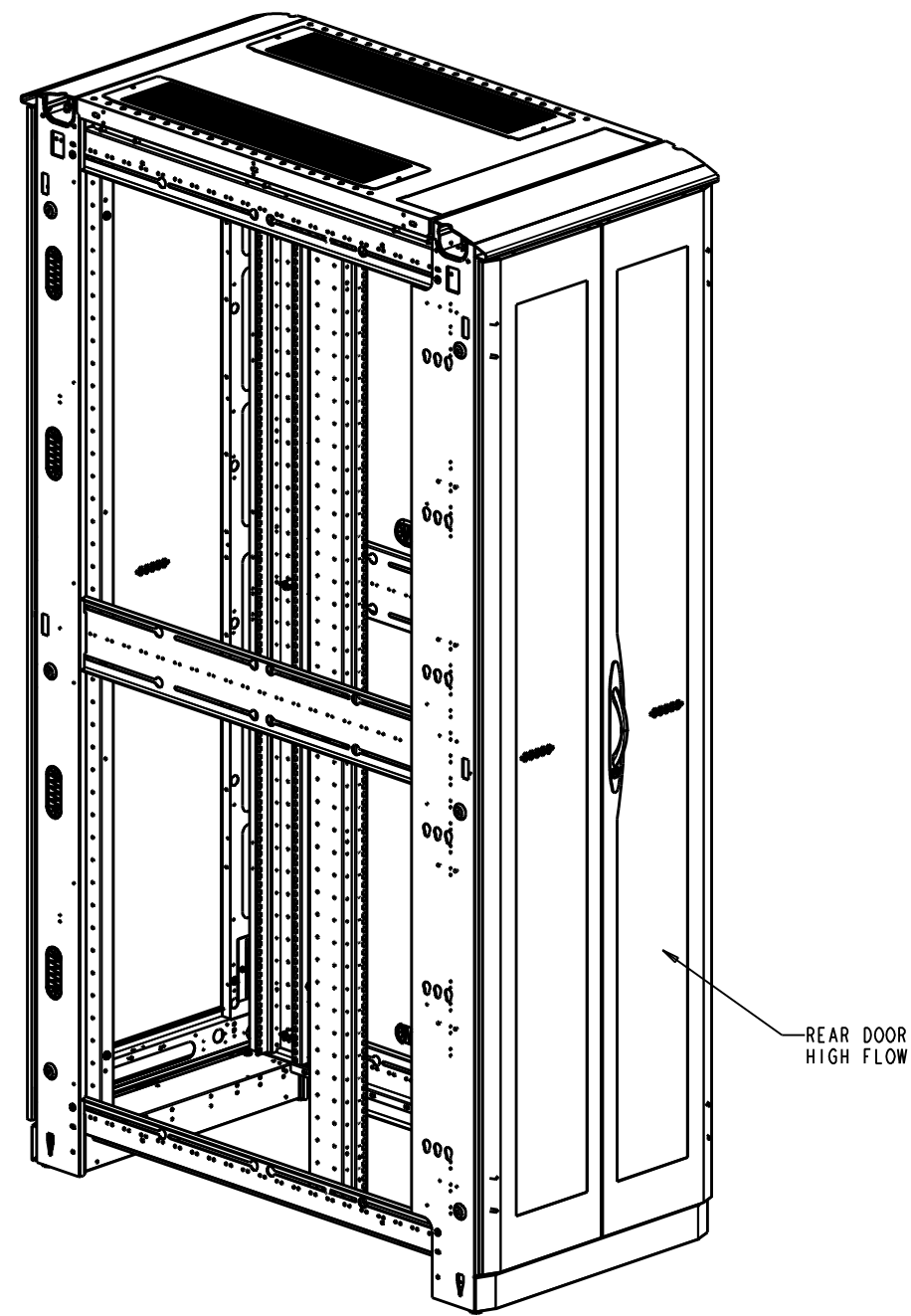
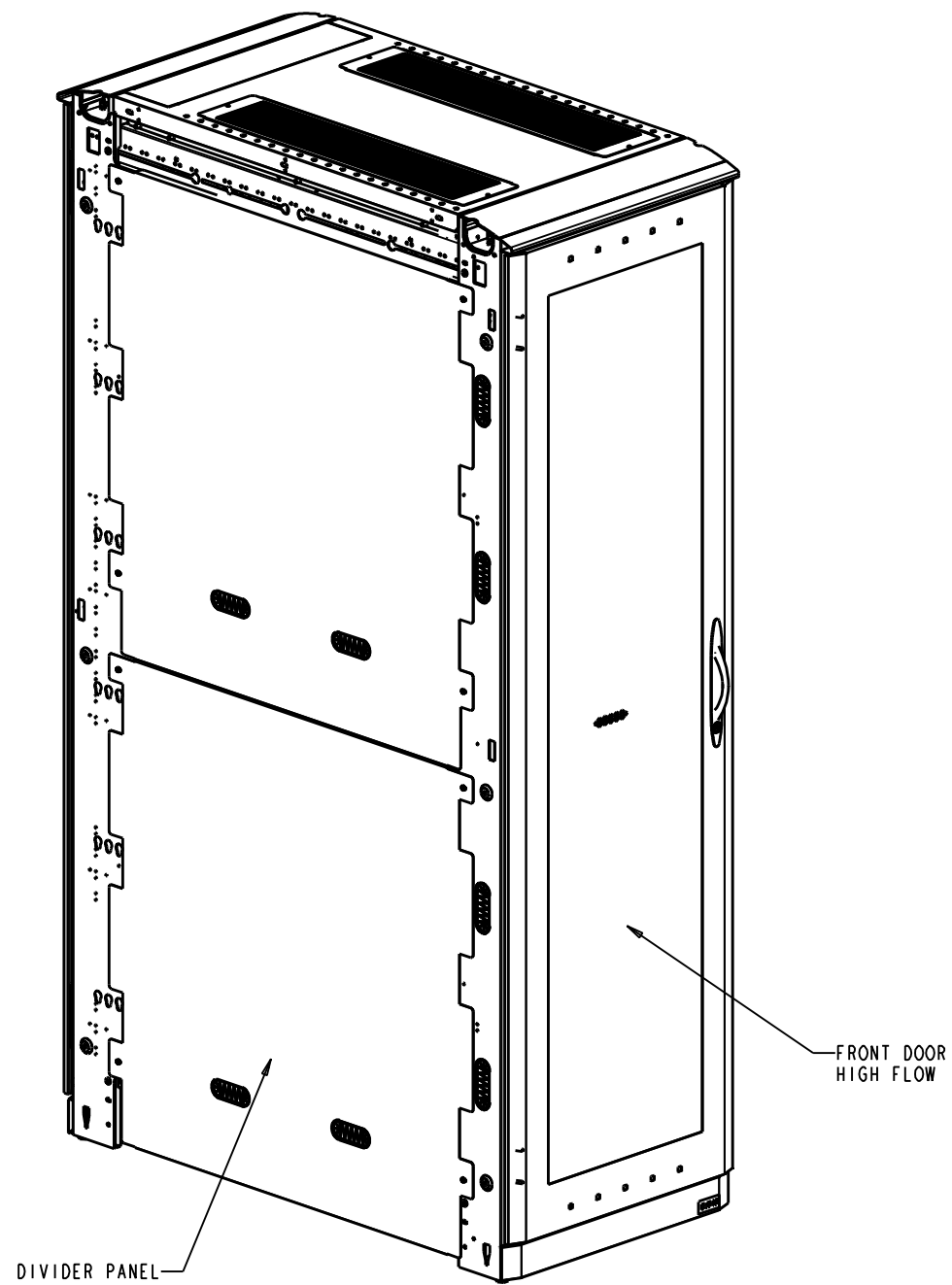

SHIPPING WEIGHT: 385 LBS

REV	REV. DATE	REV'D BY	CURRENT REVISION DESCRIPTION	ECN OR EPR NUMBER
-	11/28/11	MQuaglia	PRODUCTION RELEASE	EPR113387

THIS DRAWING CONTAINS PROPRIETARY INFORMATION AND IS LOANED SUBJECT TO RETURN UPON DEMAND AND UPON THE EXPRESS CONDITION THAT IT WILL NOT BE USED IN ANY WAY DETRIMENTAL TO THE INTEREST OF EATON CORPORATION

DRAWN IN THIRD ANGLE PROJECTION

TOLERANCE UNLESS SPEC'D
 .XX ± .02
 .XXX ± .005
 < ± .1"

ALL DIMENSIONS IN INCHES

CAGE NUMBER: 81824	CUSTOMER: EATON CHANNEL
DESIGN MGMT SITE: Worcester	DES. BY MQuaglia 11/28/11
MATERIAL:	DRWN. BY MQuaglia 11/28/11
MATERIAL FINISH:	PROD. GRP 50 - Paramount
SPEC #:	COLOR: -
	CRS GA: N/A
	OTHER: -

EATON	
PMOUNT CONFIG 44U X 24W X 48D RACK HYGIENE, 2 EPDUS & HCS TOP	
SHEET: 1 OF 8	REV DATE: 11/28/11
D PMT442448HCSTPL	REV -

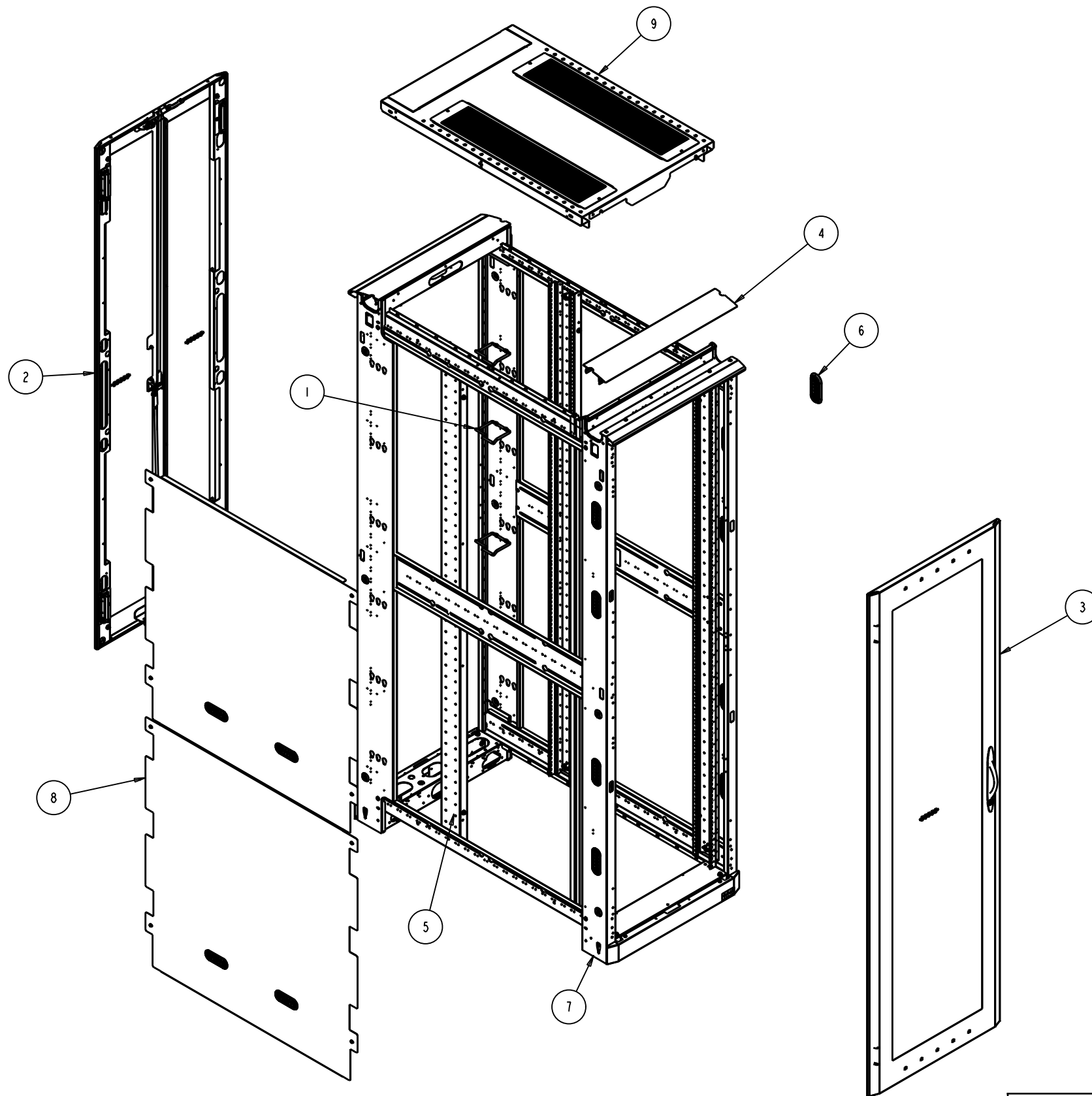

ASSEMBLY WIRING NOTE:

- GROUND ALL DOORS, RAILS, TOP AND DIVIDER PANELS. USE GROUNDING LANYARDS FROM KIT P/N GRNDPMT. USE STANDARD W/L GROUND POINTS FOR ATTACHMENT AREAS.

ITEM	TYPE	DOCUMENT #	REV	DESCRIPTION	QTY
10	SA	GRNDPMT	-	GROUND KIT - PARAMOUNT	1
9	MA	PMTNWP2448HCS	-	HCS TOP PANEL - 24W X 48D, DBL	1
8	MA	PMTJVD4448S	-	DIVIDER PANEL ASY - 44U X 48D	1
7	MA	PMTFRM442445	-	WLD - FRAME, 44U X 24W X 45D	1
6	MA	JWOVLGROM	A	GROMMET - OVAL 1.5WX4L	8
5	MA	JRM10000_	-	RACK MOUNT RAILS - 44U	1
4	MA	JFTK24_	B	FRAME TRIM KIT - 24"W	1
3	MA	JDDHF8424L	-	DOOR, HIGH FLOW	1
2	MA	JDDHF8424	-	ASSEMBLY - SPLIT DOOR, HIGH FLOW	1
1	MA	CMDRNR032U_	-	D-RING KIT, 2U	1

THIS DRAWING CONTAINS PROPRIETARY INFORMATION AND IS LOANED SUBJECT TO RETURN UPON DEMAND AND UPON THE EXPRESS CONDITION THAT IT WILL NOT BE USED IN ANY WAY DETRIMENTAL TO THE INTEREST OF EATON CORPORATION

DRAWN IN THIRD ANGLE PROJECTION

TOLERANCE UNLESS SPEC'D
 .XX ± .02
 .XXX ± .005
 < ± .1"

ALL DIMENSIONS IN INCHES

CAGE NUMBER: 81824

CUSTOMER: EATON CHANNEL

DES. BY: MQuaglia 11/28/11

DRWN. BY: MQuaglia 11/28/11

DESIGN MGMT SITE: Worcester

PROD. GRP: 50 - Paramount

COLOR: -

MATERIAL: CRS GA: N/A

MATERIAL FINISH: OTHER: -

SPEC #: -



PMOUNT CONFIG 44U X 24W X 48D
 RACK HYGIENE, 2 EPDUS & HCS TOP

REV	REV. DATE	REV'D BY	CURRENT REVISION DESCRIPTION	ECN OR EPR NUMBER
-	11/28/11	MQuaglia	PRODUCTION RELEASE	EPR113387

SHEET: 2 OF 8	REV DATE: 11/28/11
D	PMT442448HCSTPL
REV	-

RELEASE STATUS
Production

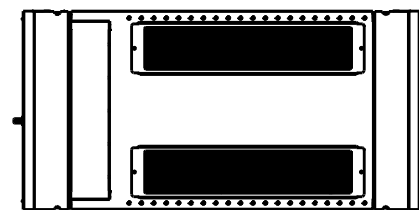

TOP

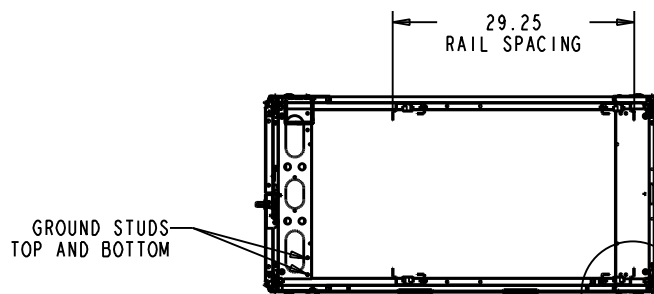

SECTION B-B

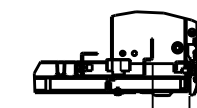

2.00 FROM FRONT
OF RAIL TO FRONT
OF CORNER POST

DETAIL D
SCALE 0.200

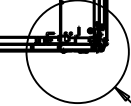

SEE DETAIL D

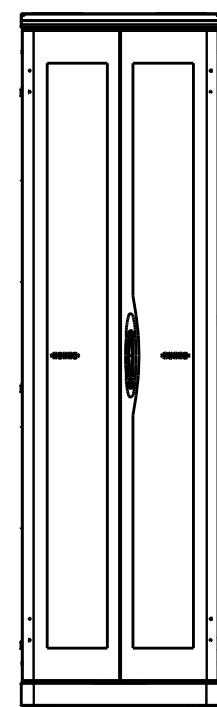

REAR

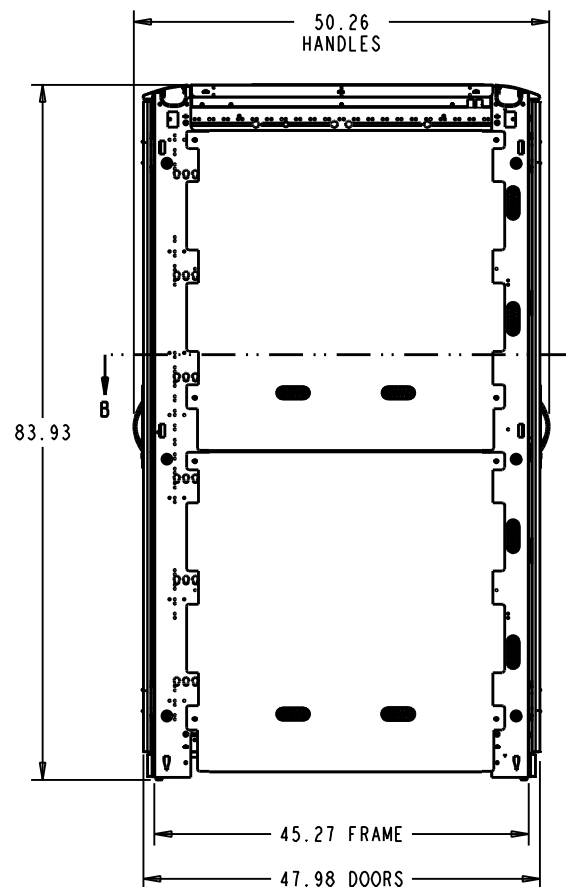

LEFT SIDE

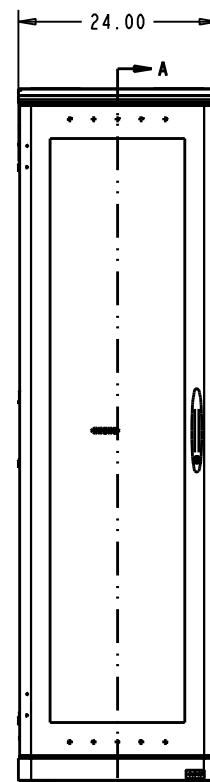

FRONT

INSTALL
CABLE RINGS

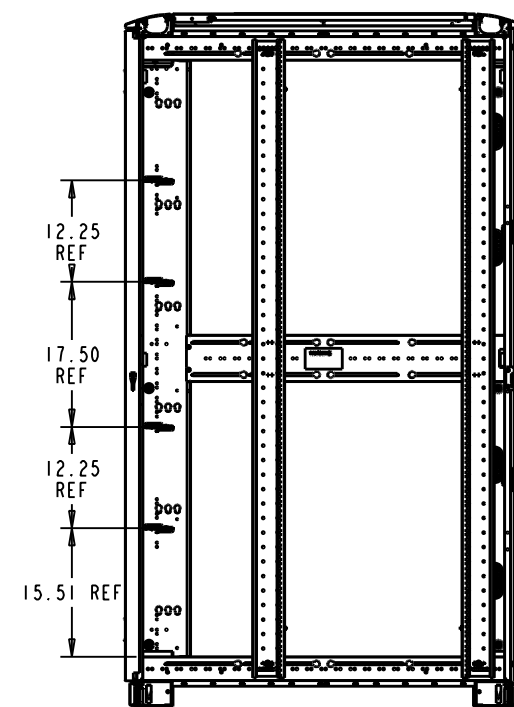

SECTION A-A

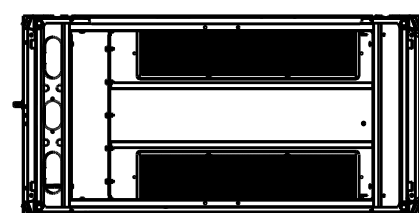
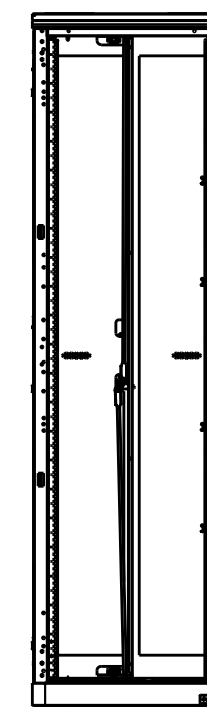

BOTTOM

LEVELING FEET

THIS DRAWING CONTAINS PROPRIETARY INFORMATION AND IS LOANED SUBJECT TO RETURN UPON DEMAND AND UPON THE EXPRESS CONDITION THAT IT WILL NOT BE USED IN ANY WAY DETRIMENTAL TO THE INTEREST OF EATON CORPORATION	CAGE NUMBER:	CUSTOMER: EATON CHANNEL	
	81824	DES. BY MQuaglia 11/28/11	
	DESIGN MGMT SITE:	DRWN. BY MQuaglia 11/28/11	
	Worcester	PROD. GRP 50 - Paramount	
DRAWN IN THIRD ANGLE PROJECTION 	TOLERANCE UNLESS SPEC'D .XX ± .02 .XXX ± .005 < ± 1"	COLOR: -	PMOUNT CONFIG 44U X 24W X 48D RACK HYGIENE, 2 EPDUS & HCS TOP
	ALL DIMENSIONS IN INCHES	CRS GA: N/A	
MATERIAL:		OTHER: -	SHEET: 3 OF 8
MATERIAL FINISH:		SPEC #:	REV DATE: 11/28/11
			D PMT44248HCSTPL REV -

-	11/28/11	MQuaglia	PRODUCTION RELEASE	EPR113387
REV	REV. DATE	REV'D BY	CURRENT REVISION DESCRIPTION	ECN OR EPR NUMBER