

Installing the Adjustable Blanking Panel

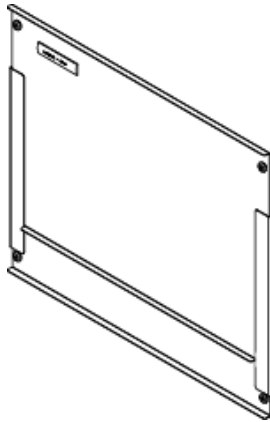

Complete these instructions to install the adjustable blanking panel in existing data center enclosures.

Adjustable blanking panels are designed to be used with either tapped or square hole rails. The panels meet EIA-310-D standards and can be installed in any compliant enclosure.

Applications

Make sure you have the appropriate size blanking panel and correct type of fastener for your application:

Item Number	Description	Size	Hole Type
SBP1222USQ	Sliding Blanking Panel	12-22U	Square
SBP1222UTPD	Sliding Blanking Panel	12-22U	Tapped
SBP712USQ	Sliding Blanking Panel	7-12U	Square
SBP712UTPD	Sliding Blanking Panel	7-12U	Tapped

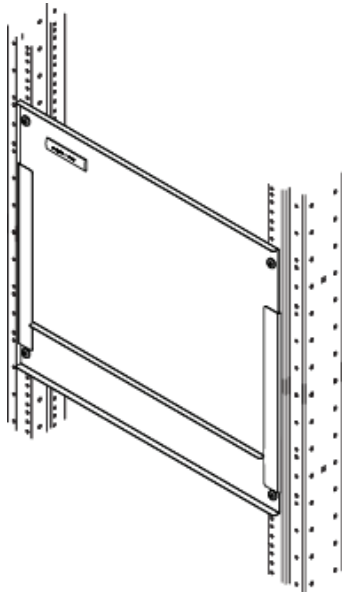

Prerequisites

- Clear any equipment or cabling that might interfere with the blanking panel.
- Unpack all components of the adjustable blanking panel.
- Make sure you have common installation tools including a utility knife and a #2 Philips screwdriver.

Assemble the Adjustable Blanking Panel

Complete the following steps to assemble the adjustable blanking panel.

1. Insert the sliding panel into the grooves in the lower panel. Make sure the flanges on both panels are facing the same direction as shown.
2. Slide the panels together as far as possible for installation.

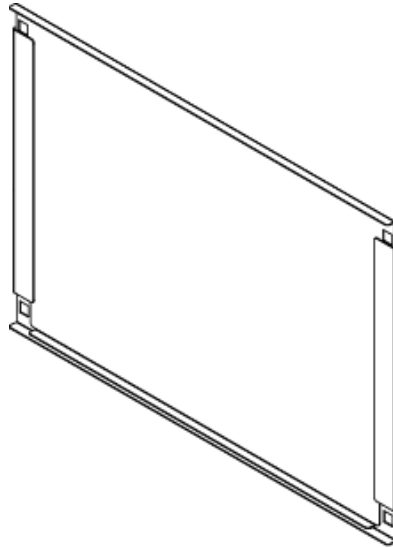
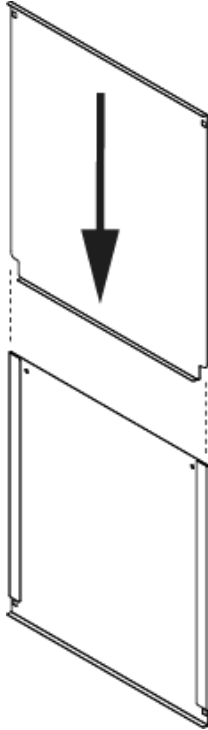

Install the Adjustable Blanking Panel

Complete the following steps to install the adjustable blanking panel in an enclosure.

1. Align the bottom of the lower panel at the desired location in the equipment rack.

Note: The top and bottom panels must be assembled before installation, as previously described.

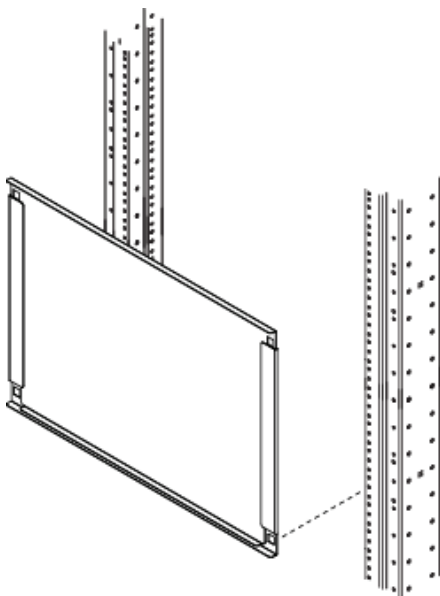

2. Position the panel assembly in the rails.

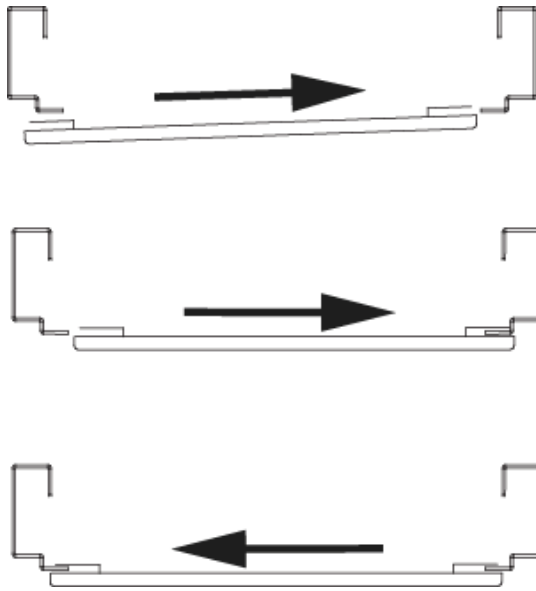

For tapped holes, the sides of the bottom panel are split to hold the edge of each rail. Slide one side as far as possible over the rail, then align the opposite side and slide the assembly back the other way until the panel is centered between the rails.

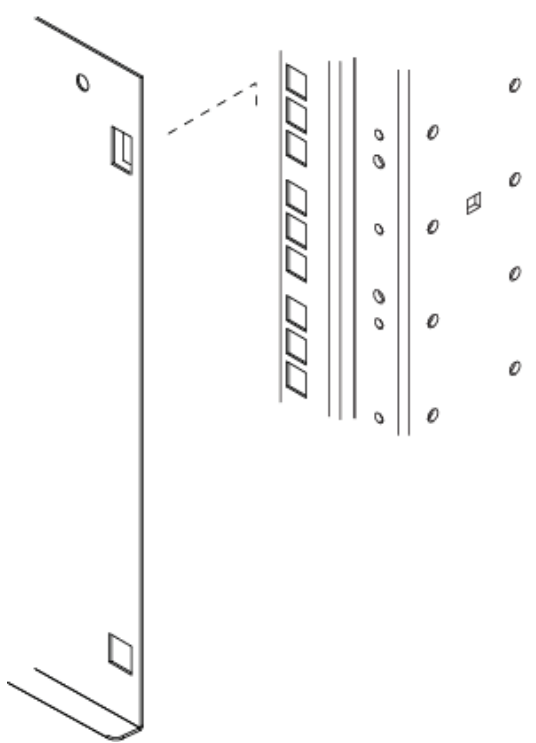

For square holes, insert the two hooks on the back of the bottom panel into the appropriate cutouts. Push down gently to seat the hooks in the rail cutouts.

3. Insert bottom panel fasteners.

For tapped rails, insert two screws through the bottom holes and tighten.

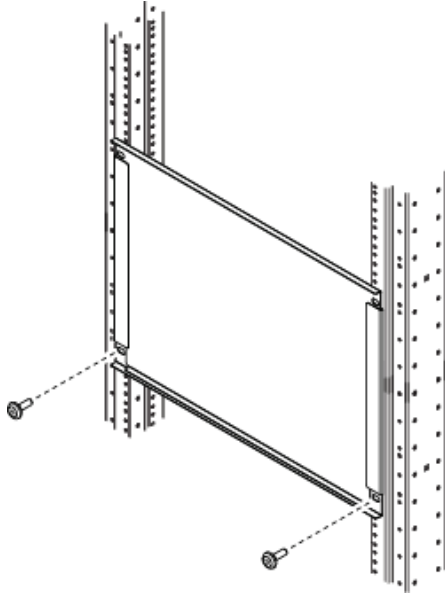

For square cutout rails, insert two plastic receptacles. Insert the plastic pins and push in to close.

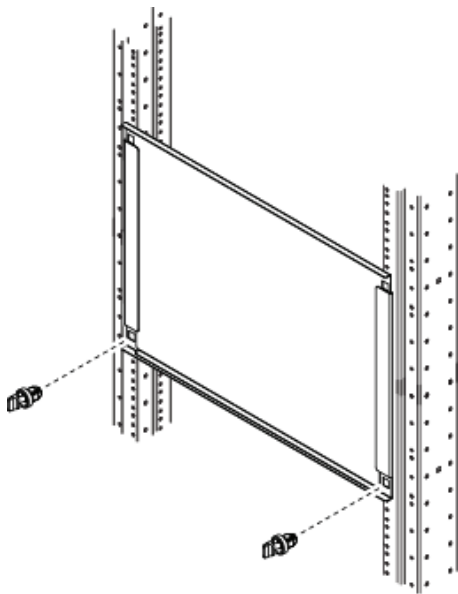

Note: The complete name of the tool-less fastener is **D7 DZUS® Pilot-Arrow Push-To-Close, Turn-To-Open Quarter-Turn Fastener.**

The pin can be partially inserted into the receptacle before installation. The pin must be firmly pressed in to expand the receptacle and secure the panel.

To remove the fastener, pull out the knob while rotating one quarter turn counter-clockwise then remove the receptacle

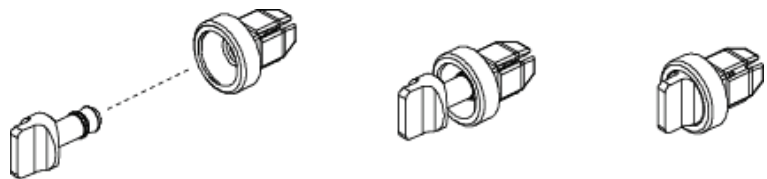

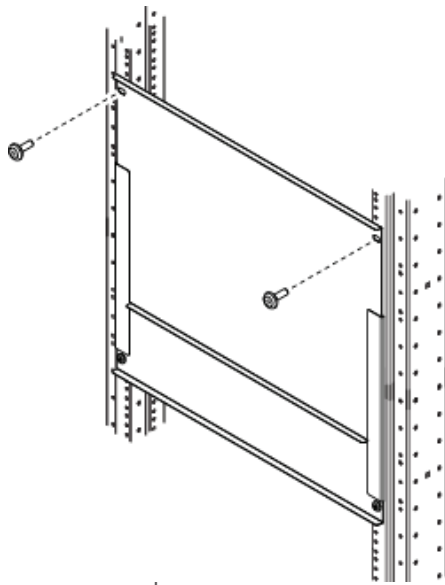

4. Move the sliding panel up to the desired location in the equipment rack.

5. Insert top panel fasteners.

For tapped rails, insert two screws and tighten.

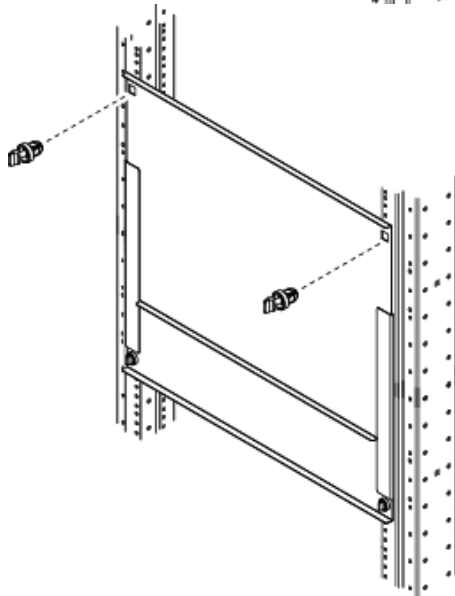

For square hole rails, insert two plastic receptacles. Insert the plastic pins and push in to close.

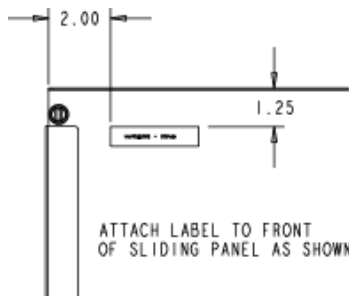

6. If the Wright Line logo is not attached, affix the logo to the sliding panel, 2 inches from the left edge and 1-1/4 inches from the top as shown.

7. Insert foam blocks or foam tape as needed to complete the seal above and below the blanking panel.

Installation is complete.