

## X10 Mini Sounder Beacon

The X10 Mini sounder beacon is an industrial signaling alarm, available in 4 fade resistant body colours, 6 LED beacon colours, and high and low voltage variants. It is certified to IP66 and IP69K, and verified to operate at extreme temperatures -40°C to 70°C, and is therefore suitable for use in harsh conditions where a robust industrial sounder beacon is required. The X10 Mini sounder beacon comes with an Eaton 10 year Extended Warranty and offers up to 100 dB(A) with 102 tones, and a versatile 4 stage alarm to allow you to retrofit to an existing installation.

### Technical specifications

X10 Mini Sounder Beacon				
	Low voltage DC / AC product		AC Mains product	
Rated voltage	10V - 60V	DC 10V - 30V AC	115V AC	230V AC
Sounder only* (DIN Tone, High Vol)	20 - 35 mA	50 - 85 mA	65 mA	32 mA
AV* (DIN Tone, High Vol, 1Hz Flash)	35 - 130 mA	85 - 235 mA	67 mA	33 mA
Sound output	100dB			
Alarm tones	102			
Alarm stages	4			
Stage control options	+ve low voltage trigger -ve low voltage trigger +ve supply voltage trigger -ve supply voltage trigger Reverse polarity trigger		Dry / 0 volt contact trigger	
Flash rate	0.5Hz (30FPM) / 1Hz (60FPM) / Continuous / Off			
Operating temperature	-40°C to +70°C			
Ingress Protection (IP) rating	IP66 and IP69K (dust ingress/high pressure water jets)			
Warranty	10 years**			
Material	UV stabilised polycarbonate ASA			
Colour - housing	Red (RAL 3001) White (RAL9003) Dark grey (RAL7012) Light grey (RAL7035)			
Colour - beacon	Red Magenta Amber Clear Blue Green			
Cable entry	Top: 2 x M20 threaded cable entries Bottom: 1 x M20 threaded cable entry			
Connecting terminals	up to 2.5mm <sup>2</sup>			
Weight	0.860kg (AC Mains); 0.575kg (Low voltage DC / AC)			

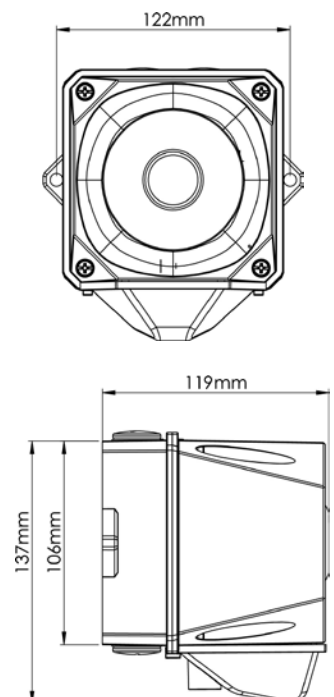

\* Supply current range is based on variation of the supply voltage. A change in tone, volume or beacon settings will also impact the supply current.





\*\* Terms and Conditions apply

## Key features

- 100dB(A) sound output
- IK08 Impact resist and Dual IP Rated to IP66 and IP69K
- 10 year warranty\*\*
- 102 tones facilitates install and retrofits accommodating a wide range of Industry requirements
- 6 lens colours available, secured by 1 single ¼ turn captive fastener
- 4 fade resistant housing colours available
- Up to 4 stage alarm, with multiple alert and control possibilities for both AC and DC variants
- Modular LED beacon capable of multiple functionality on / off; 1/2Hz (30FPM) / 1Hz (60FPM)
- Temperature range -40°C to +70°C
- Captive salt water resistant stainless steel fasteners
- M20 pre drilled threaded cable entries fitted with IP69K blanking plugs as standard
- UV stabilised polycarbonate ASA
- Low Inrush current with a range of dB(A) outputs





## X10 Housing colours

### Housing colours

	R1 = Red (RAL3001)
	G1 = Dark grey (RAL7012)
	G2 = Light grey (RAL7035)
	W1 = White (RAL9003)

## X10 Modular lenses

### Lens colours

	RL = Red lens
	AL = Amber lens
	BL = Blue lens
	GL = Green lens
	CL = Clear lens
	ML = Magenta lens

## Catalogue numbers

Catalogue no.	Reference	Description
7092353FUL-0389	X10/CE/MNH/R1/10-60 VAC-DC	X10 mini, red housing, 10-60 VAC-DC
7092354FUL-0390	X10/CE/MNH/R1/115/230 VAC	X10 mini, red housing, 115/230 VAC
7092355FUL-0391	X10/CE/MNH/W1/10-60 VAC-DC	X10 mini, white housing, 10-60 VAC-DC
7092356FUL-0392	X10/CE/MNH/W1/115/230 VAC	X10 mini, white housing, 115/230 VAC
7092357FUL-0393	X10/CE/MNH/G1/10-60 VAC-DC	X10 mini, dark grey housing, 10-60 VAC-DC
7092358FUL-0394	X10/CE/MNH/G1/115/230 VAC	X10 mini, dark grey housing, 115/230 VAC
7092359FUL-0395	X10/CE/MNH/G2/10-60 VAC-DC	X10 mini, light grey housing, 10-60 VAC-DC
7092360FUL-0396	X10/CE/MNH/G2/115/230 VAC	X10 mini, light grey housing, 115/230 VAC
7092361FUL-0397	X10/CE/M1B/RL	X10 mini beacon, red lens
7092362FUL-0398	X10/CE/M1B/AL	X10 mini beacon, amber lens
7092363FUL-0399	X10/CE/M1B/BL	X10 mini beacon, blue lens
7092364FUL-0400	X10/CE/M1B/GL	X10 mini beacon, green lens
7092365FUL-0401	X10/CE/M1B/CL	X10 mini beacon, clear lens
7092366FUL-0402	X10/CE/M1B/ML	X10 mini beacon, magenta lens

**Eaton**  
 EMEA Headquarters  
 Route de la Longeraie 7  
 1110 Morges, Switzerland  
 Eaton.eu

© 2018 Eaton  
 All Rights Reserved  
 Printed in EMEA  
 Version 1.1, March 2018

Eaton is a registered trademark.

All other trademarks are property of their respective owners.