

CASB383AU wall sounder beacon specification

| | |
|---|---|
| Supply Voltage | 18 ~ 32 Vdc |
| Cable Size / type | 0.5 ~ 2.5mm/ FIRETUF, FP200 or MICC |
| Standby current | < 450 uA |
| Operating temperature | -10 to +55 degrees C (95%RH) |
| Sound output @ +/-3dB (set by panel) | Low volume : 92dB @ <6.5mA |
| | Medium volume : 97dB @ <7.5mA |
| | High volume : 100dB @ <8.5mA |
| Tones (set by panel) | Continuous 984Hz |
| | Bell Tone |
| | Pulsed Sweep ISO8201 3x500ms 800-970Hz 1/2 Sec Gap |
| | Pulsed 984 / 0Hz pulse 1Hz |
| Beacon | |

Cooper Fire
Wheatley Hall Road
Doncaster
South Yorkshire
DN2 4NB
Tel: 01302 321 541
www.cooper-fs.com

Order codes

| | |
|--------------|---|
| CASB383AU | Addressable Wall Sounder/Beacon |
| CASB383AU/WP | Addressable Wall Sounder/Beacon IP66 |

Installation details

Wall Sounder/Beacon

1. Mounting base

- (i) Drill required holes for cable gland fixing
- (ii) Drill out the required fixing holes
- (iii) Fix to mounting surface using two suitable screws

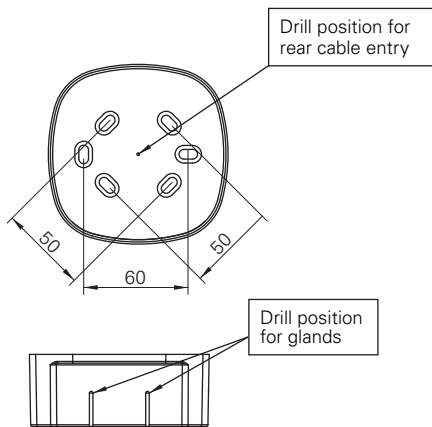

2. Connection details

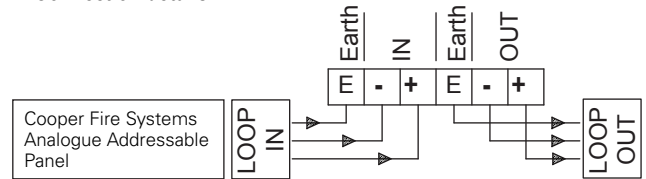

WARNING: Do NOT use high voltage testers if ANY equipment is connected to the system.

Earth screen must be continuous along entire length of loop.

3. Sounder assembly

- (i) Clip sounder onto base
- (ii) Ensure cables do not put stress on the PCB

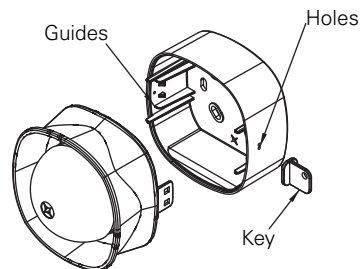

Dimensions

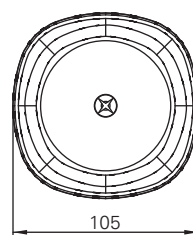

To Un-Lock use key provided

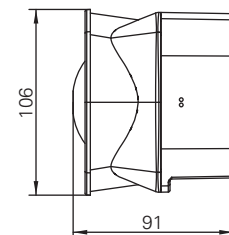

Wall Sounder/Beacon IP66

1. Mounting base

- (i) Drill required holes for cable gland fixing (top or bottom) and ensure cables are correctly sealed for IP66 integrity.
- (ii) Fix to mounting surface using four suitable screws

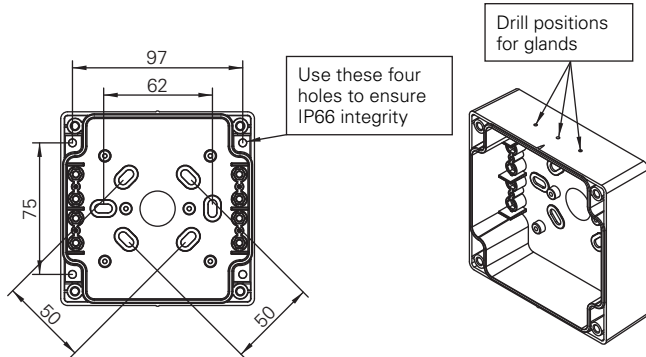

2. Connection details

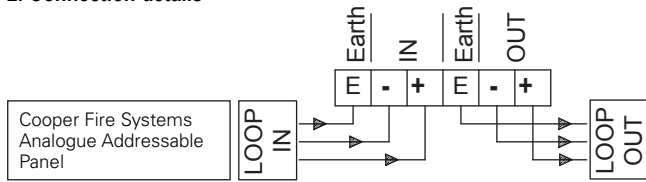

WARNING

Do NOT use high voltage testers when beacons or control panel are connected to the system.

Earth screen of cable to be continuous between sounders.

3. Sounder assembly

- (i) Location ribs must align on base and sounder
- (ii) Ensure cables do not put stress on the PCB
- (iii) Bolt sounder onto base

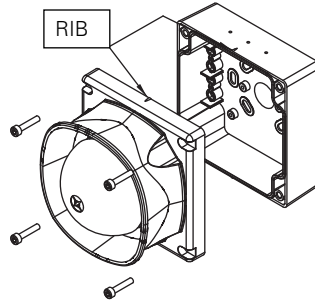

Dimensions

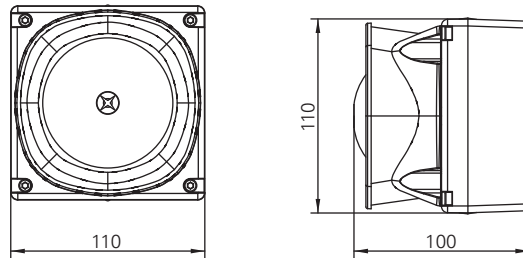

Eaton
 EMEA Headquarters
 Route de la Longeraie 7
 1110 Morges, Switzerland
 Eaton.eu

© 2017 Eaton
 All Rights Reserved
 Publication No. PR211-179-595-01 / XXX
 November 2017