



- Multi-functional usability (escape route, open-area and exit signage)
- Exit sign with 20m & 30m viewing distance options available
- IP65 ingress protection suitable for indoor and outdoor applications (small version only)
- Maintained and non-maintained configurable
- 60,000 hour life LED (L80) for reduced maintenance costs

Lamp Options

8 x 0.6W (small) and 12 x 0.6W (large) LED

Power Consumption

Maintained – 6.5 VA/5.5W

Non-maintained – 5.5 VA/4.25W

Materials

Luminaire body – white polycarbonate RAL9003

Battery - NiCd

Installation Notes

Surface ceiling or wall mount

BESA entry drilling template on rear

Cable entry to top, bottom and rear

Lens snap fits into position

Three screw less terminals (L, N, L2)

Terminals take wire up to 2 x 2.5mm²

IP65 rating is achievable with sealing plugs included. (Small version only)

Large version is IP42 rated.

Options

Switch-maintained or non-maintained

Can be used as an emergency luminaire or exit sign

Optional double sided diffuser accessory is available for use as a double sided exit luminaire (Legend Kit purchased separately)

Continuing the success of the Zetalite family of products is the improved and upgraded Zeta 4. The aesthetics have been enhanced to create a more modern and discreet appearance which is suitable for most project applications.

By utilising the latest LED technology the result is increased spacing performance while still maintaining low energy usage.

Zeta 4 is suitable for use as an Escape route and open area luminaire, while providing extra versatility as an exit sign via the application of an optional adhesive legend kit.



Specification

Self-Contained (Small Version) – To specify: IP65 self-contained emergency luminaire, suitable for use as an emergency luminaire or 20m viewing distance exit sign by application of a self-adhesive legend, NiCd battery, as per Zeta 4 range, part no. _____

Self-Contained (Large Version) – To specify: IP65 self-contained emergency luminaire, suitable for use as an emergency luminaire or 30m viewing distance exit sign by application of a self-adhesive legend, NiCd battery, as per Zeta 4 range, part no. _____

Maximum Viewing Distance

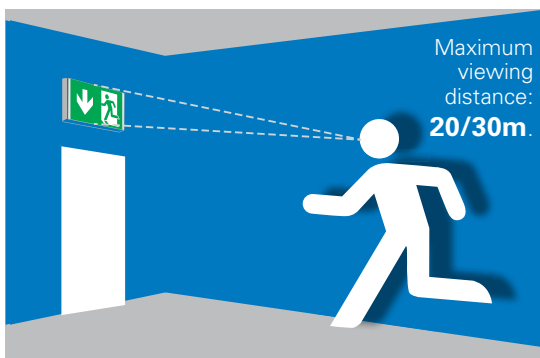



7

**Double side cone diffuser:**

Used to do ceiling signage, double or single side (blind picto inside).
In accordance with EN1838 standard.
Exit pictograms comply with ISO7010. Compatible with IP42 and IP65 luminaire versions.
Could be associated with recessed base. Adhesives pictograms have to be ordered separately (or re use ones delivered with luminaires).

**Double side plexi diffuser:**

Used to do ceiling signage, double or single side.
Exit pictograms comply with ISO7010.
Select order code according to signage configuration requested.
Compatible with IP42 and IP65 luminaire versions.
Could be associated with recessed base.

**Recessed base:**

Option used for full recessed mounting in false ceiling.
Compatible with IP42 and IP65 luminaire versions.
Could be associated with double side diffuser and panel signage.

Order code	Viewing distance (m)	IP	IK	Duration (h)	Lum in emergency	Lum in mains	Operation	NM VA	NM W	M VA	M W	Battery	Weight (kg)	Adhesive Exit Legend included	
ZE42ML3	20	65	07	3	150	60	MNM	3.2	2.5	3.8	3.2	3.6V	1.7 Ah	0.7	ISO (L, R, D)
ZE43ML3	30	65	07	3	150	60	MNM	3.2	2.5	3.8	3.2	3.6V	1.7 Ah	0.9	ISO (L, R, D)

7 Accessories

Wire guard - ensures high degree of protection

SL2PG	Zeta 4 20m, Wire guard
O-EL-GRID	Zeta 4 30m, Wire guard

Recessed base - For full recessed mounting, compatible IP42 & IP65 variants, can be associated to double side diffusers

SL2RB	Zeta 4 20m, RecesBase
SL3RB	Zeta 4 30m, RecesBase

Recessed box

SL2WB	Zeta 4 20m, Wall Base
-------	-----------------------

Double side cone diffuser - compliant with EN1838

ZE42DB	Zeta 4 small, 20m viewing distance double sided cone diffuser
ZE43DB	Zeta 4 large, 30m viewing distance double sided cone diffuser

**Pictograms have to be ordered separately (or re use ones delivered with luminaires).*

Set of adhesive exit legends

ZE42LEG	20m viewing distance (Small) Euro legend kit
ZE42LEG-ISO	20m viewing distance (Small) SO7010
ZE43LEG	30m viewing distance (Large) Euro legend kit
ZE43LEG-ISO	30m viewing distance (Large) ISO7010 legend kit



Dimensions

Type	Width (mm)	Depth (mm)	Length (mm)
ZE42ML3	119	49	270
ZE43ML3	170	69	371

ZE42ML3 - Zeta 4 Small

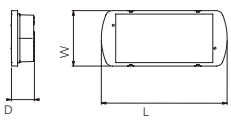

ZE43ML3 - Zeta 4 Large

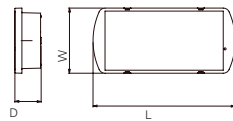

Catalogue Numbers

System Mode	Cat No	Weight (kg)
Maintained/Non maintained 3Hr Small	ZE42ML3	0.5
Maintained/Non maintained 3Hr Large	ZE43ML3	0.9

Legend Kits

20m viewing distance (Small) Euro legend kit	ZE42LEG	0.03
20m viewing distance (Small) ISO7010 legend kit	ZE42LEG-ISO	0.03
30m viewing distance (Large) Euro legend kit	ZE43LEG	0.06
30m viewing distance (Large) ISO7010 legend kit	ZE43LEG-ISO	0.06

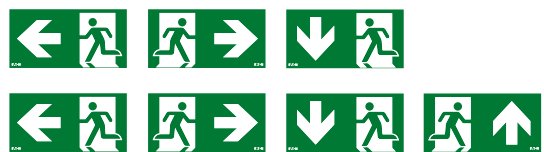

Accessories

20m viewing distance (Small) double sided diffuser	ZE42DB	0.2
30m viewing distance (Large) double sided diffuser	ZE43DB	0.5

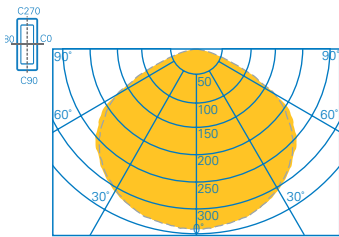

Light distribution curve

Escape Optics (Asymmetric) Escape Route 2M wide 1 lux min to centre line

	Mounting height [m]	Lux level directly under				
Self-Contained Small	2.5	5.7	3.1	7.8	7.7	3.1
	2.8	4.6	3.2	8.2	8.0	3.1
	3.0	4.0	3.2	8.4	8.2	3.1
	3.5	2.9	3.2	8.8	8.5	3.1
	4.0	2.2	3.0	8.9	8.6	3.0
	4.5	1.8	2.8	8.9	8.7	2.8
	5.0	1.4	2.5	8.8	8.6	2.4
	5.5	1.2	1.9	8.5	8.4	1.8
	6.0	N/A	N/A	N/A	N/A	N/A
	6.5	N/A	N/A	N/A	N/A	N/A
	7	N/A	N/A	N/A	N/A	N/A
7.5	N/A	N/A	N/A	N/A	N/A	
8	N/A	N/A	N/A	N/A	N/A	

7

Open area optics (symmetric) Open (anti panic) area 0.5 lux min

	Mounting height [m]	Lux level directly under				
Self-Contained Small	2.5	5.7	3.3	7.7	8.0	3.3
	2.8	4.6	3.4	8.6	8.6	3.3
	3.0	4.0	3.5	8.9	8.8	3.4
	3.5	2.9	3.6	9.7	9.7	3.5
	4.0	2.2	3.7	10.1	10.0	3.6
	4.5	1.8	3.7	10.5	10.3	3.6
	5.0	1.4	3.6	10.7	10.6	3.6
	5.5	1.2	3.6	11.0	10.9	3.5
	6.0	N/A	3.4	11.4	11.2	3.3
	6.5	N/A	3.2	11.4	11.4	3.1
	7	N/A	3.0	11.5	11.6	2.9
7.5	N/A	2.7	11.6	11.9	2.6	
8	N/A	2.2	11.6	12.1	2.1	

Escape Optics (Asymmetric) Escape Route 2M wide 1 lux min to centre line

	Mounting height [m]	Lux level directly under				
Self-Contained Large	2.5	5.2	3.0	7.5	7.5	2.9
	2.8	4.2	3.0	8.0	7.8	3.0
	3.0	3.6	3.1	8.3	8.0	3.0
	3.5	2.7	3.0	8.5	8.2	2.9
	4.0	2.1	2.8	8.6	8.4	2.8
	4.5	1.6	2.6	8.5	8.4	2.5
	5.0	1.3	2.1	8.3	8.2	2.0
	5.5	1.1	1.2	8.0	7.9	1.2
	6.0	N/A	N/A	N/A	N/A	N/A
	6.5	N/A	N/A	N/A	N/A	N/A
	7	N/A	N/A	N/A	N/A	N/A
7.5	N/A	N/A	N/A	N/A	N/A	
8	N/A	N/A	N/A	N/A	N/A	

Open area optics (symmetric) Open (anti panic) area 0.5 lux min

	Mounting height [m]	Lux level directly under				
Self-Contained Large	2.5	5.7	3.4	7.4	7.3	3.4
	2.8	4.6	3.5	7.9	7.8	3.4
	3.0	4.0	3.5	8.3	8.2	3.4
	3.5	2.9	3.5	9.2	9.1	3.4
	4.0	2.2	3.6	9.9	9.6	3.5
	4.5	1.8	3.6	10.5	9.9	3.5
	5.0	1.4	3.5	10.8	10.3	3.5
	5.5	1.2	3.4	10.8	10.5	3.4
	6.0	N/A	3.3	10.8	10.6	3.3
	6.5	N/A	3.0	10.9	10.8	3.0
	7	N/A	2.7	10.9	10.8	2.7
7.5	N/A	2.2	10.9	10.8	2.2	
8	N/A	1.3	10.9	10.8	1.3	