



VIA8

-  Suspended exit sign
-  LED
-  120/180min

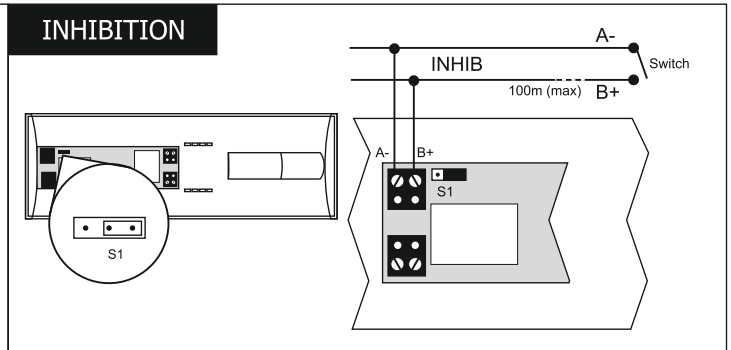
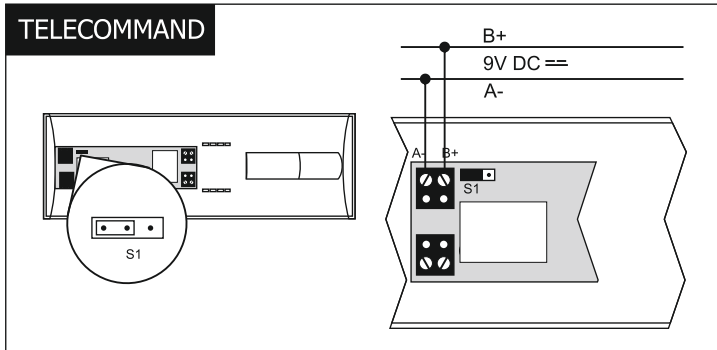
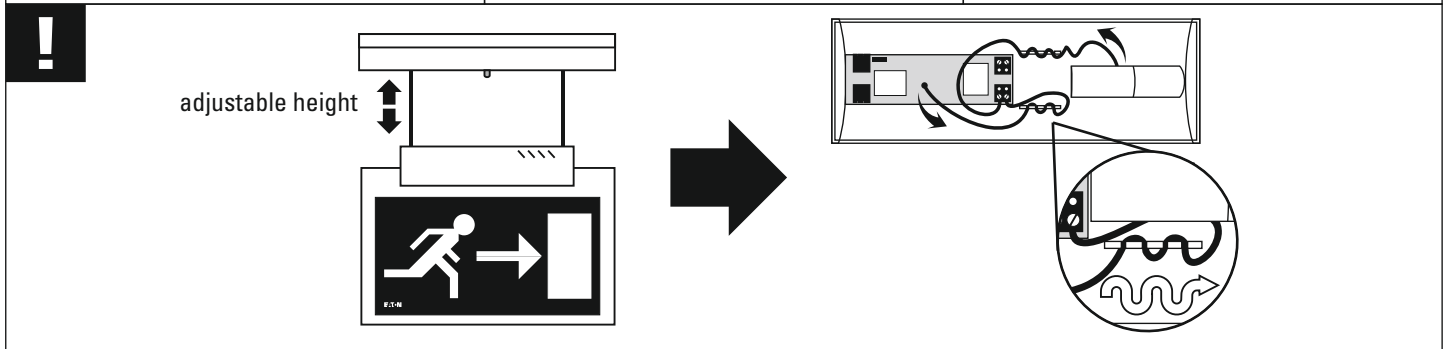
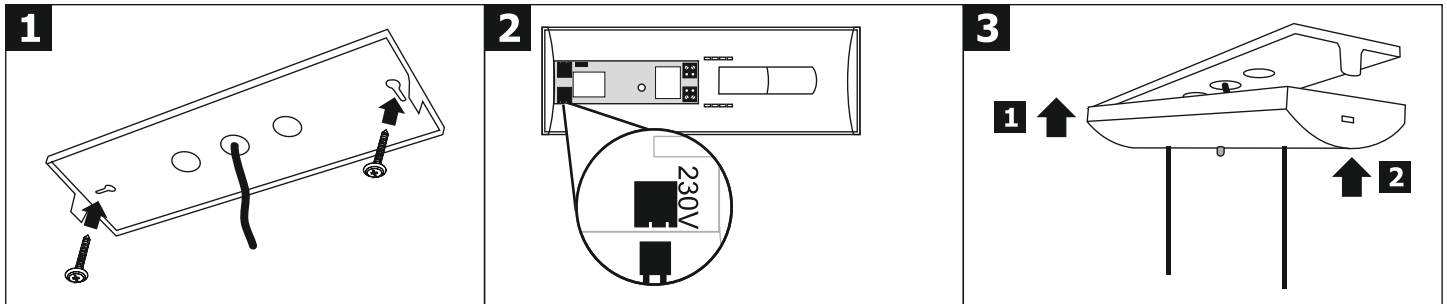

General safety instructions

- The luminaire is not suitable for private use.
- It can only be installed by a qualified electrician in compliance with the regulations on safety and prevention of accidents.
- The luminaire must be used in accordance with its intended use in a proper and undamaged condition.
- Remove all foreign objects from the device before its first use.
- When working on the luminaire, first turn off the power completely, ensure that it cannot be turned back on, and check if it is free of voltage. (The above applies to mains power, backup power and possibly control and external voltage).
- Battery should be replaced when rated duration is no longer achieved. Battery is not a user serviceable item; it shall only be replaced by a competent person.
- Use only original spare parts for replacement.

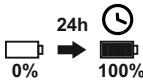

24h
24h charge for optimal operation



recyclable parts complying with WEEE directive

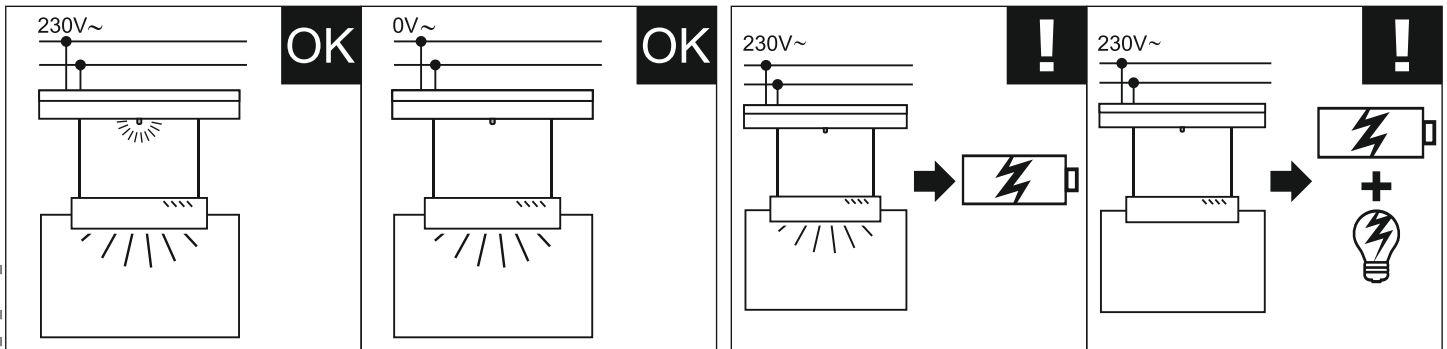

1_05_VIA8_Eaton