

# SafeLite AT

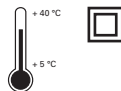

1



a

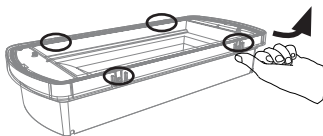

b

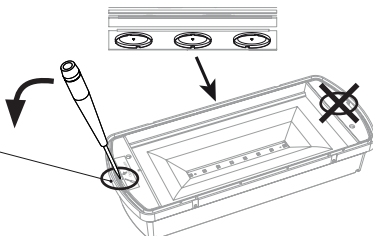
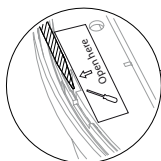

2

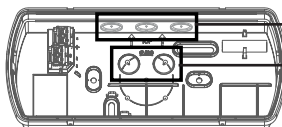

5xØ 20,5 mm

a

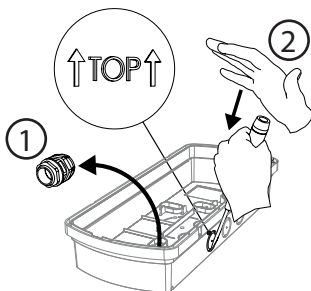

b

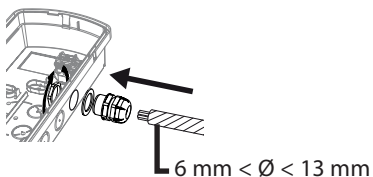

3

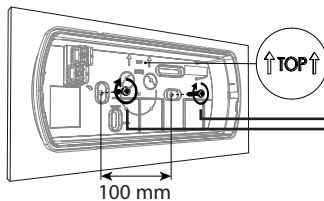

100 mm

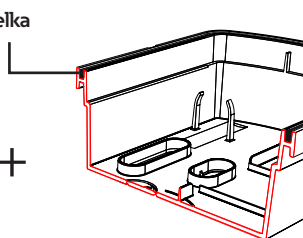
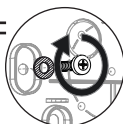

# EATON

Powering Business Worldwide

4

Drut lub linka  
 $0,5 < S < 2,5 \text{ mm}^2$

Tylko drut  
 $1,5 < S < 2,5 \text{ mm}^2$



Wpinanie przewodu

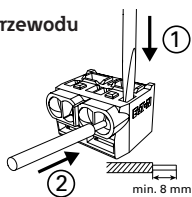

Wycinanie przewodu

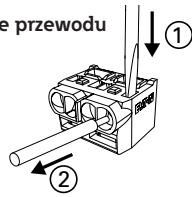

a

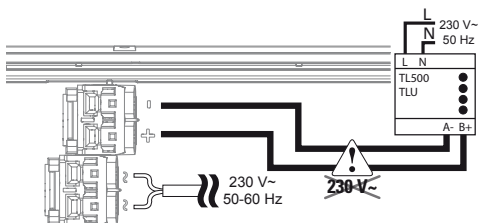

Patrz instrukcja TLU

b

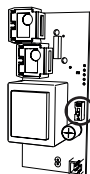

OFF Tryb awaryjny

ON Tryb ciągły

c

1

Data instalacji  
dd/mm/yyyy

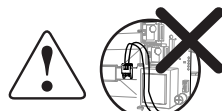
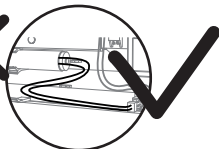
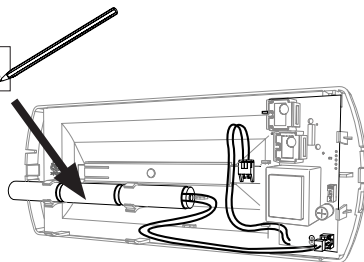

5

Naklejanie piktogramu

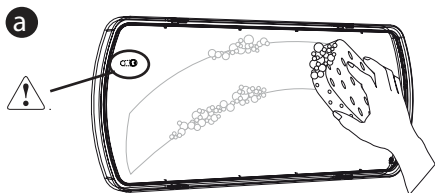

! Zwróć uwagę na kierunek mocowania klosza.

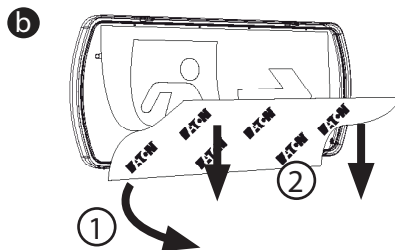

6

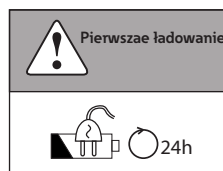
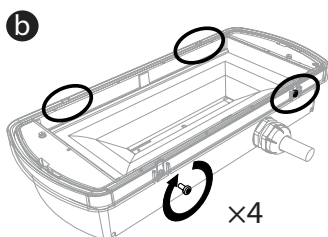
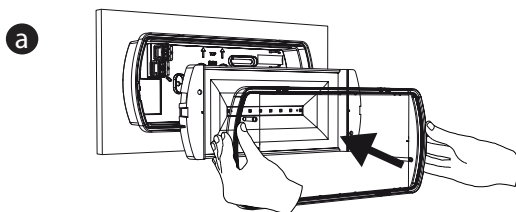

7

AUTOTEST

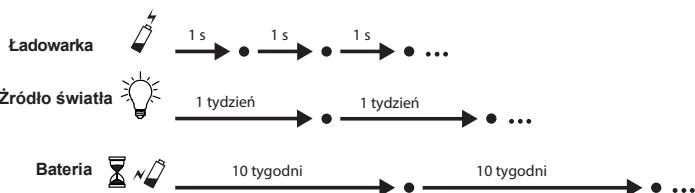
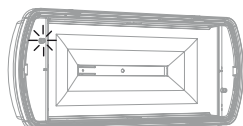

Zielony		OK
Zielony		Test

Żółty		2 s	
Żółty		0,5 s	

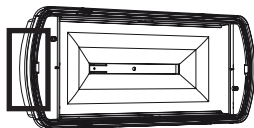

Tryb awaryjny = 0  
Tryb ciągły = 1

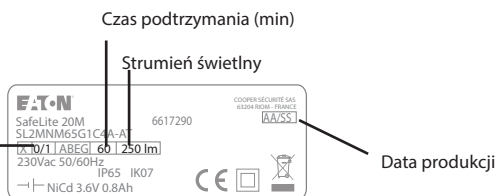

PN-EN

SafeLite 20M SL2MNM65G1C4A-AT

IP65 / IK07

NiCd 3.6 V/0.8 Ah

Cs Ronda / BYD

1h

250lm

8 x LED 2.8 V 68 mA

230 Vac 50/60 Hz

PN-EN 60598.1

PN-EN 60598.2.22

PN-EN 62034



Wymienne



Źródło światła nie jest przewidziane do wymiany przez użytkownika

Wymień baterie jeśli czas podtrzymania jest zbyt krótki.

Wymień oprawę jeśli źródło światła uległo zużyciu.

Eaton  
Cooper Sécurité SAS  
PEE II - Rue Beethoven - BP10184  
63204 RIOM CEDEX FRANCE  
+33 (0) 825 826 212  
www.cooperfrance.com  
www.eaton.com

Eaton Electric sp. z o.o.  
ul. Galaktyczna 30  
80-299 Gdańsk  
www.eaton.pl

© 2020 Eaton  
All Rights Reserved



Eaton.com/Recycling

**EATON**

Powering Business Worldwide

Eaton is a registered trademark.

All trademarks are property of their respective owners.

