

Manual

Manuel / Manuale / Betriebsanleitung / Manuál / Priručnik / Uputstvo / Használati utasítás / Instrukcja / Navodila
ZNO2036600 B 10/2017

SafeLite

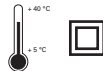

1

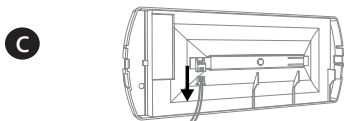
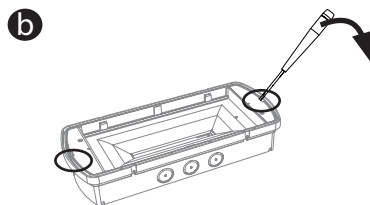
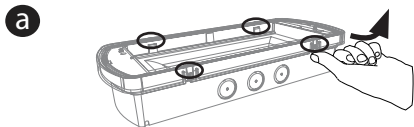

2

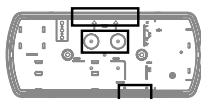

6xØ 20,5 mm

IP42

IP65

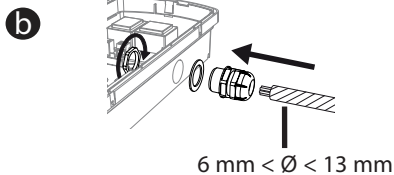
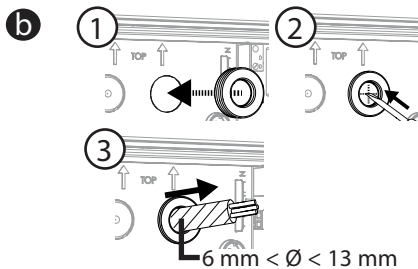
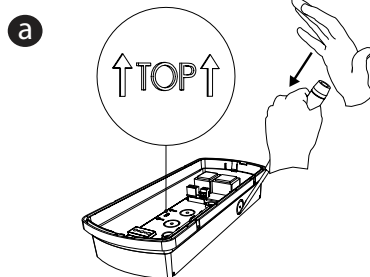
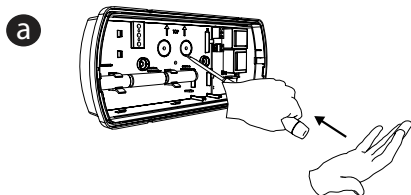

3

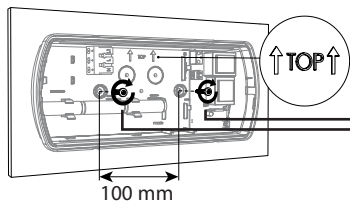

IP65

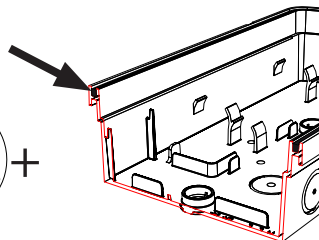
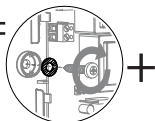

EAT•N

Powering Business Worldwide

4

a

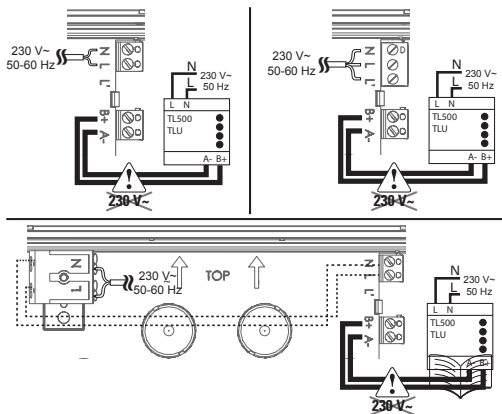
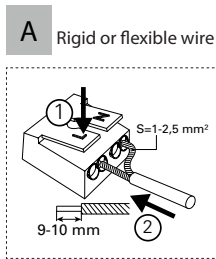
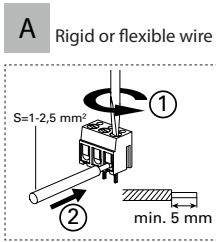

B See manual
TLU - ZNO2016600
TL500 - ZNO2016400

b

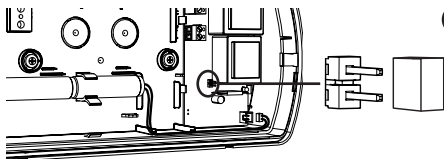

c

C

Non Maintained

Maintained

1

D

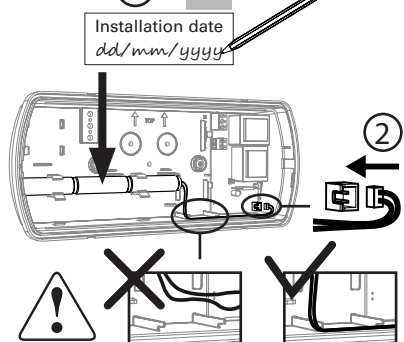

5



E Option

a

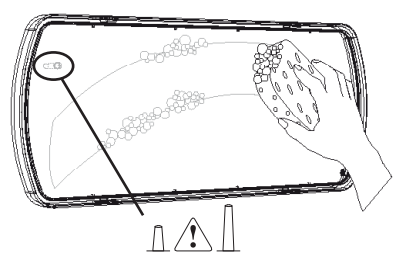

b

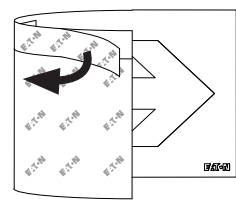

C

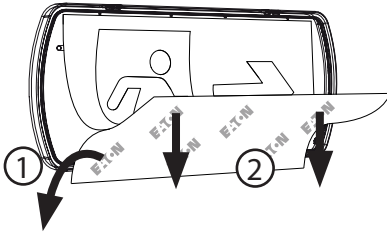

6

a

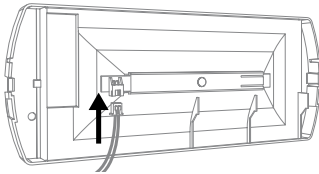

b

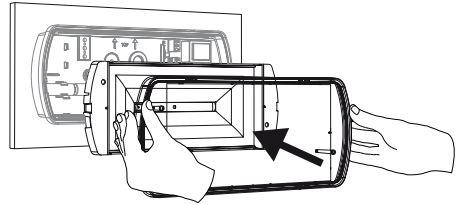

IK07

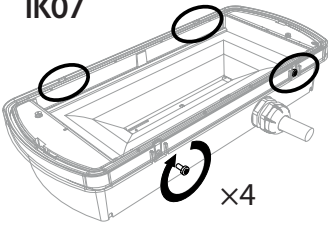

c

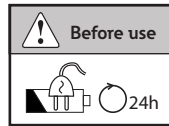

F

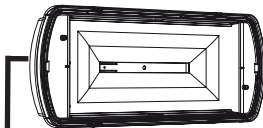

EATON		COOPER SÉCURITÉ SAS 63204 RIOM - FRANCE	
SL2MNM42D2C		XX/XX	
SafeLite 20m			
X1 ABEG 60 100 lm			
230V ac 50/60 Hz		P42 IK04	
— — NiCd 3.6V 0.8Ah		CE	

C Non Maintained/
Maintained

Light output
Battery duration

G



Not replaceable H

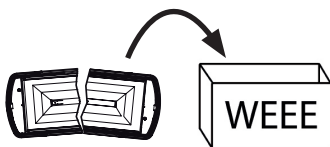

A

B

C

D

E

F

IT	Cavo rigido o flessibile	cfr. manuale	Non permanente/Permanente	Data installazione	Opzione	Prima carica
PT	Fio rígido ou flexível	Ver manual	Não Mantido/Mantido	Data instalação	Opção	Antes da primeira utilização
ES	Hilo rígido o flexible	Ver manual	Non Permanente/Permanente	Fecha instalaci6n	Opci6n	Primer uso
FR	Fil souple ou rigide	Voir manuel	Non maintenu/Maintenu	Date installation	Option	Avant toute utilisation
EN	Rigid or flexible wire	See manual	Non Maintained/Maintained	Installation date	Option	Before use
DE	Starre oder flexible Leitung	Sehen Betriebsanleitung	Bereitschaftslicht/Dauerlicht	Installationsdatum	Option	Vor Gebrauch
RO	Cablu rigid sau flexibil	Vezi manual	Nementinut / Mentinut	Data de instalare	Optiune	Înainte de utilizare
CZ	Pevný nebo slaněný vodič	Viz manuál	Pohotovostní/Trvalý	Datum instalace	Volitelné	Před použitím
SK	Pevný alebo slaněný vodič	Pozri manuál	Pohotovostný / Trvalý	Dátum inštalácie	Voliteľne	Pred použitím
HR	Fleksibilna ili kruta žica	Pogledati priručnik	Pripravni/trajni	Datum instalacije	Opcija	Prije uporabe
RS	Fleksibilna ili kruta žica	Pogledati uputstvo	Pripravni/trajni	Datum instalacije	Opcije	Pre upotrebe
HU	Merev vagy hajlékony kábel	Lásd a használati utasítást	Készletléti / Állandó üzemmód	Üzembehelyezés dátuma	Opció	Használat előtt
PL	Drut lub linka	Patrz instrukcja	Awaryjna/Awajjno-sieciowa	Data instalacji	Opcja	Przed użyciem
SI	Trda ali mehka žica	Glej navodila	Pripravni spoj/Trajni spoj	Datum namestitve	Možnosti	Pred uporabo

G

H

IT	Flusso luminoso - Autonomia batteria	Non sostituibili
PT	Fluxo luminoso - Autonomia bateria	Não substituíveis
ES	Flujo luminoso - Autonomía batería	No sustituibles
FR	Flux lumineux - Autonomie batterie	Non remplaçables
EN	Light output - Battery duration	Not replaceable
DE	Lichtstrom - Nennbetriebsdauer	Nicht auswechselbaren
RO	Flux luminos - Autonomie	Nu se înlocuiește
CZ	Osvětlení - Doba provozu na baterie	Nelze vyměnit
SK	Osvetlenie - Doba prevádzky na batérie	Nemožno vymeniť
HR	Svjetlosni izlaz - Autonomija	Nije zamjenjivo
RS	Svetlosni izlaz - Autonomija	Nije zamjenjivo
HU	Fénykibocsátás - akkumulátor üzemeideje	Nem cserélhető
PL	Strumień świetlny-praca z baterii	Nie wymienne
SI	Izhodna svetilnost -Trajanje Baterije (Avtonomija)	Ni zamenljiva

Eaton
 EMEA Headquarters
 Route de la Longeraie 7
 1110 Morges, Switzerland
 Eaton.eu

ZNO2036600 B - 10/2017

© 2017 Eaton
 All Rights Reserved.



Eaton is a registered trademark.

All trademarks are property
 of their respective owners.



EAT•N

Powering Business Worldwide