

NexiTech LED IP65

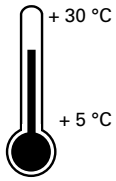

 1xCAP222045 1xCAP222094 1xCAP452002		2xØ 5 mm	Ref. COOPER 919-000-002 F=1600 g
			24
			Remplaçable Replaceable Auswechselbare Sostituibile

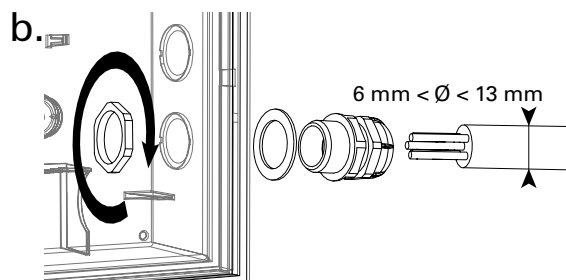

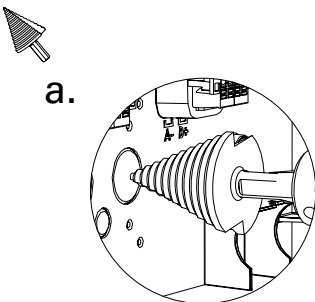
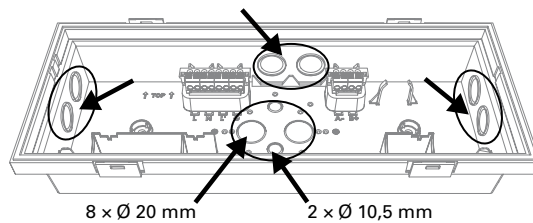
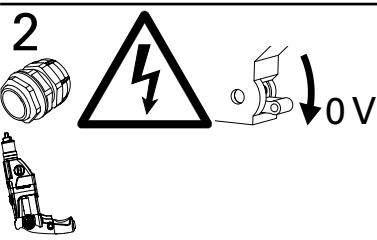
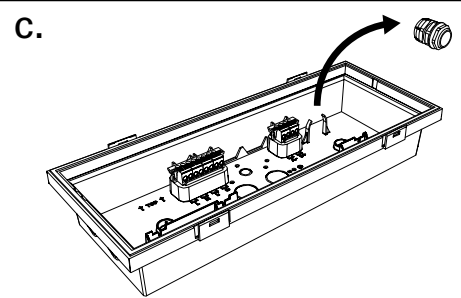
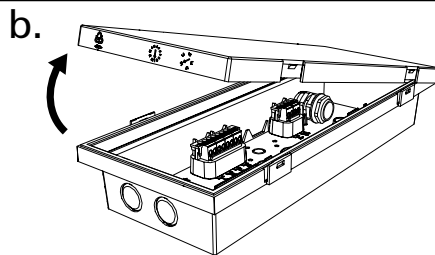
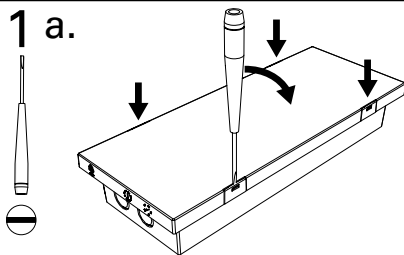
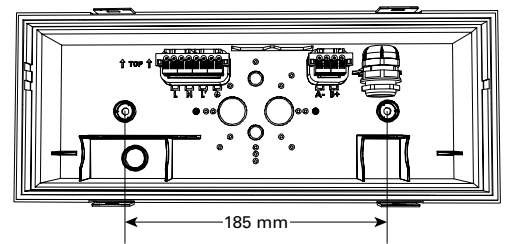
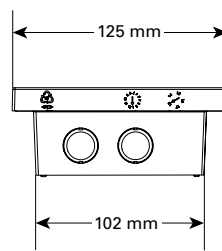
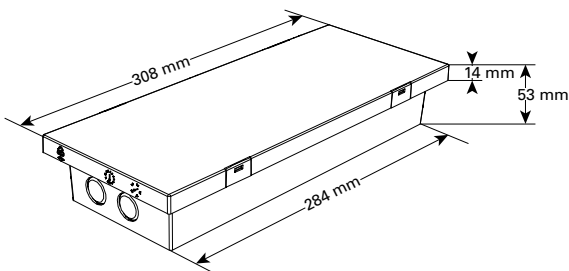
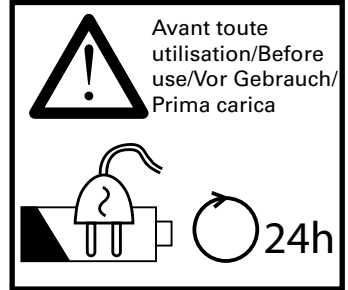
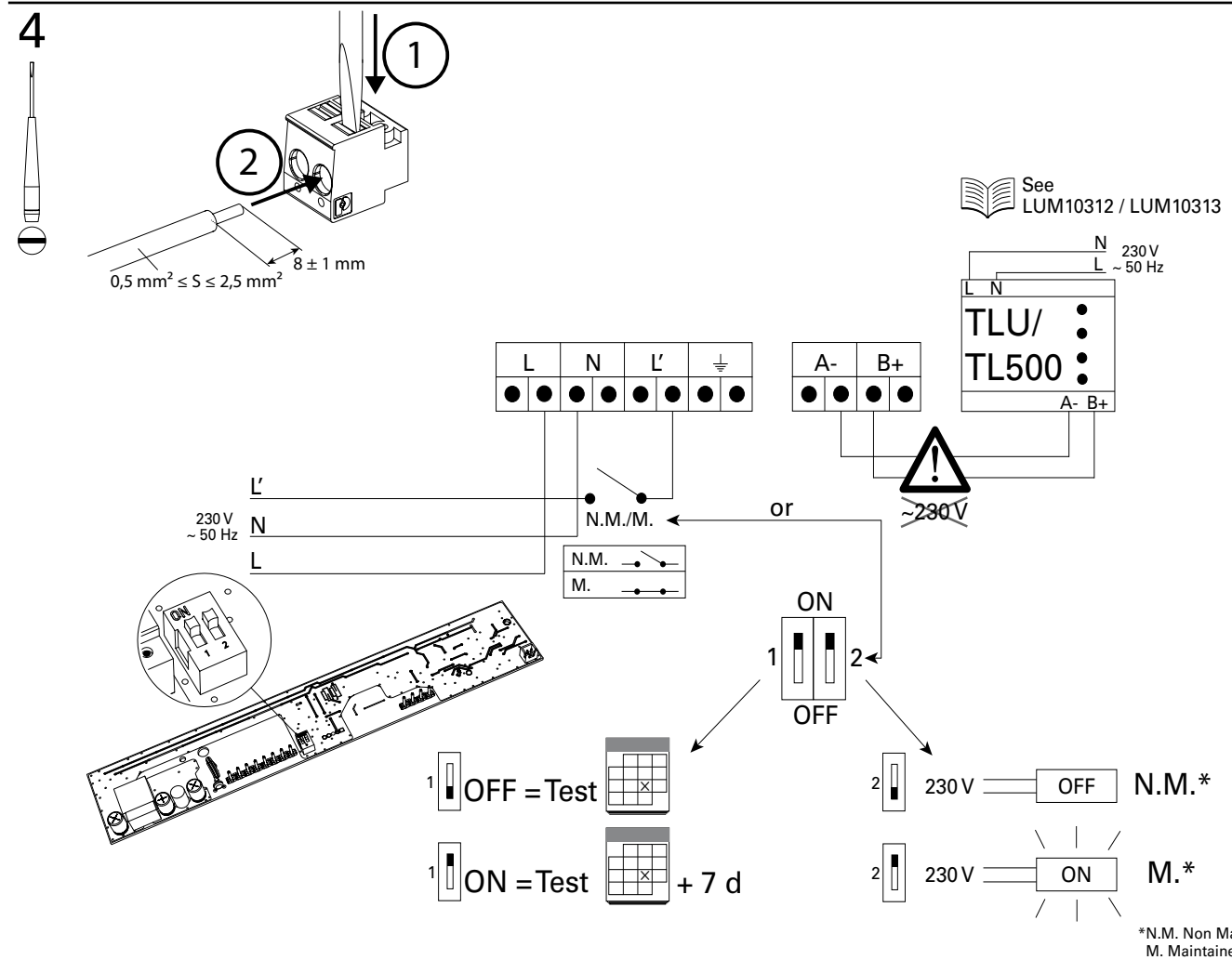
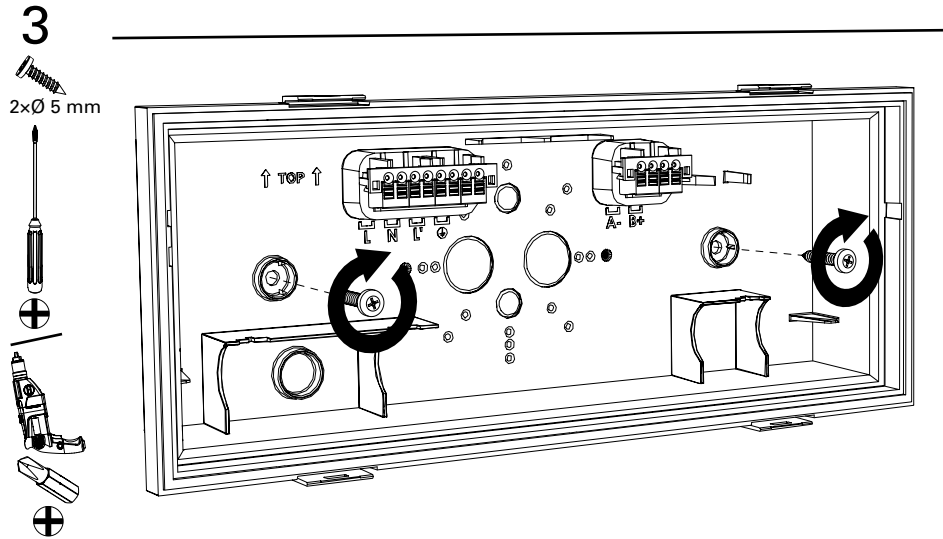

5 option

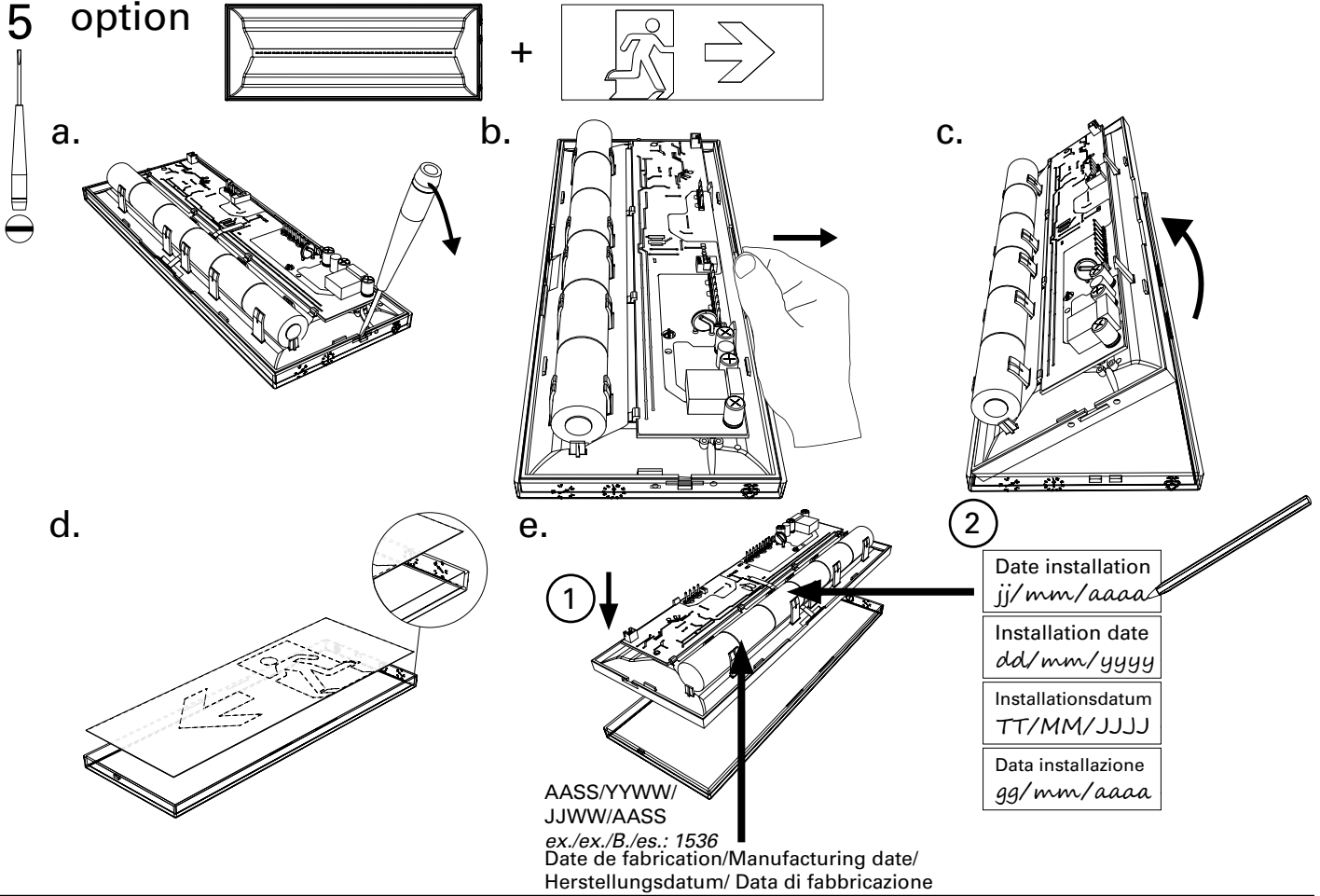

6

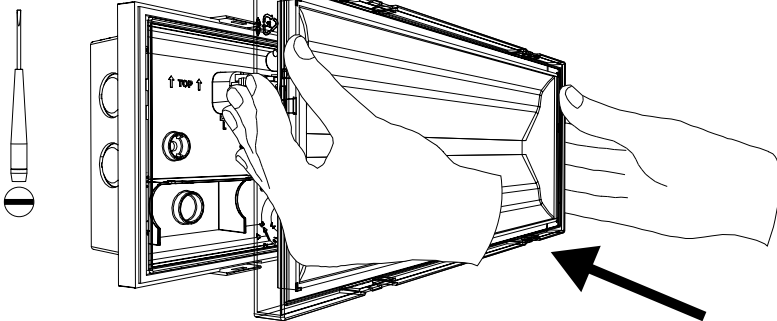

7

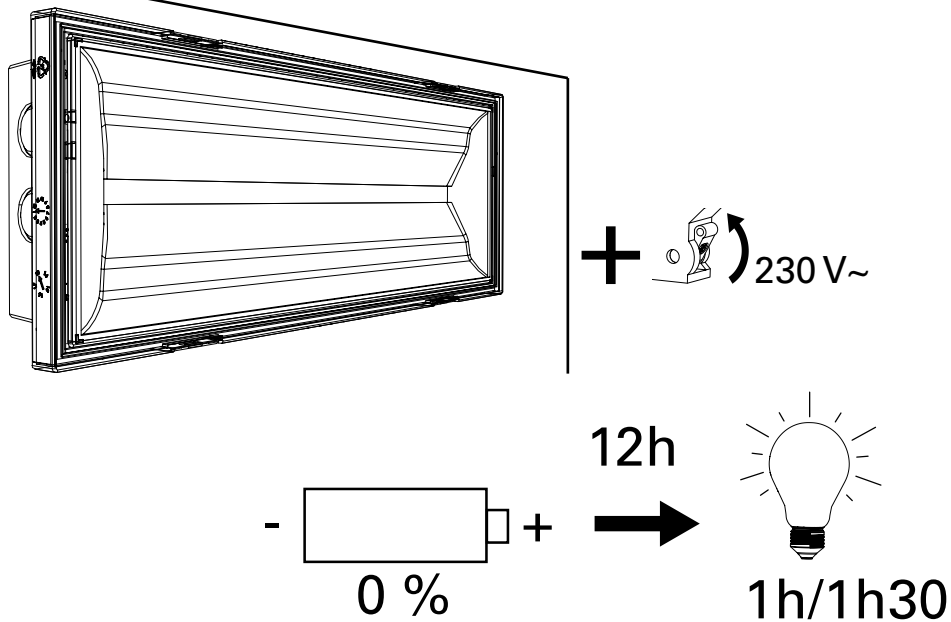

Autotest / SATI

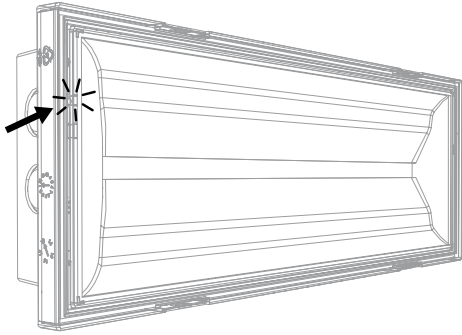

V/G/G/V		OK
V/G/G/V		Test
V-J/G-Y/G-G/V-G		•))))) com/kom
J/Y/G/G		2 s
J/Y/G/G		0,5 s

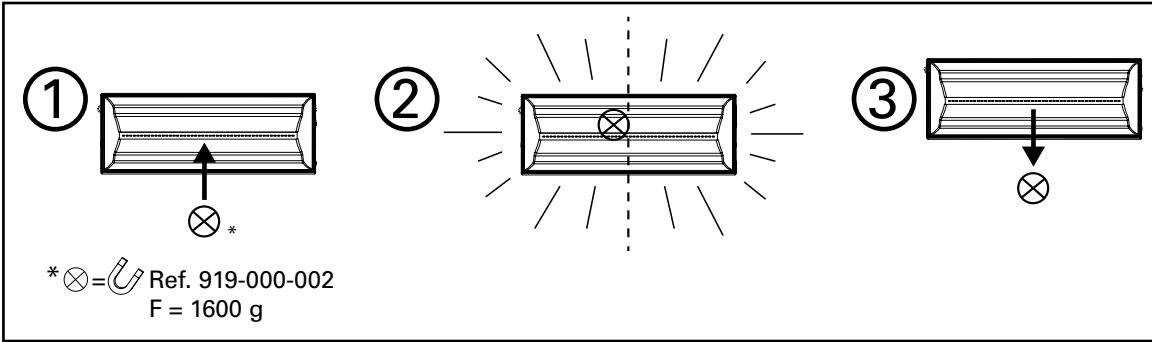

NEXI-PICTO-D



NEXI-PICTO-L



NEXI-PICTO-R



NEXI-PICTO-U

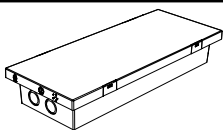
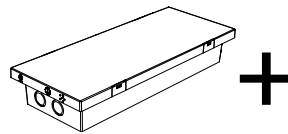

ENEC



EN



NEXITECH LED 100LM 1,5H IP65 AT	NEXI100-AT-IP	IP 65 / IK 07	3,6 V/0,8 Ah Ni-Cd	1h30	100 lm	N.M. : 0,65 W	EN 60598.1 EN 60598.2.2 EN 60598.2.22 EN62034
NEXITECH LED 150LM 1H IP65 AT	NEXI150-AT-IP		3,6 V/0,8 Ah Ni-Cd	1h	150 lm	M. : 2,4 W N.M. : 0,65 W	
NEXITECH LED 250LM 1,5H IP65 AT	NEXI250-AT-IP	7,2 V/1,7 Ah Ni-Cd	1h30	250 lm	M. : 3,6 W N.M. : 2,25 W		
NEXITECH LED 400LM 1,5H IP65 AT	NEXI400-AT-IP	7,2 V/1,7 Ah Ni-Cd	1h30	400 lm	M. : 3,2 W N.M. : 2 W		

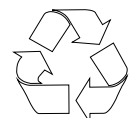
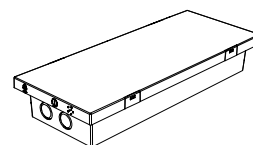

Powering Business Worldwide

Eaton
Cooper CSA srl
Via San Bovio, 3
20090 Segrate (MI) - ITALIA
Tel. +39 02 0959501
www.coopercsa.it
www.eaton.it

© 2016 Eaton
ZNO2035300 A - 01/2016
Tous droits réservés.
All rights reserved.
Alle Rechte vorbehalten.
Tutti i diritti riservati.

