

MATRIX 1-3h CGLine+

Self-contained luminaire / Bloc autonome d'éclairage de sécurité / Einzelbatterieleuchte

+ Web-Controller CGLine+

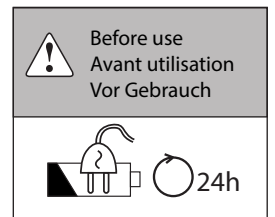
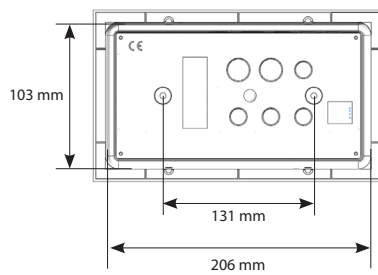
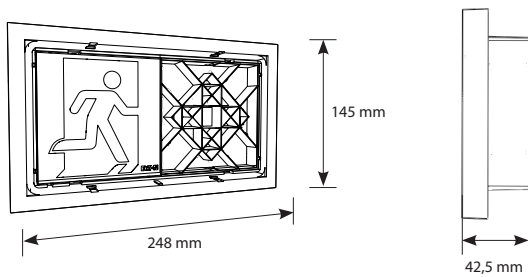
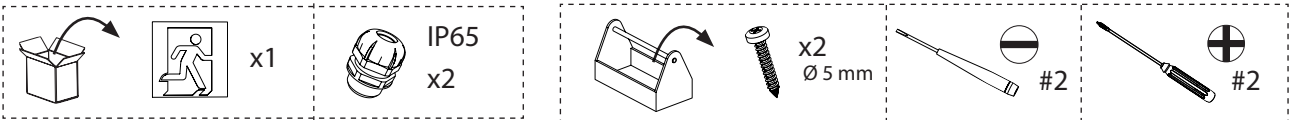
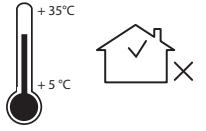

1

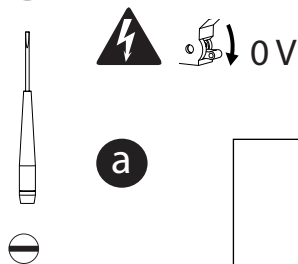

a

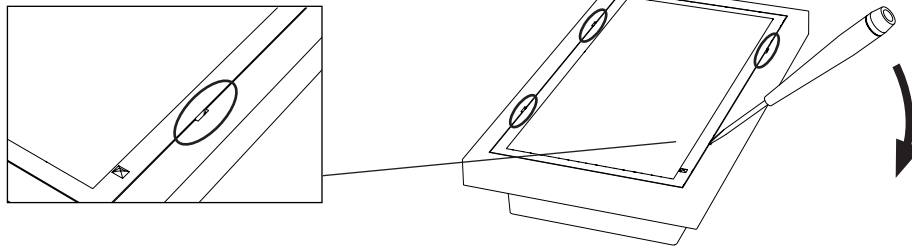

b

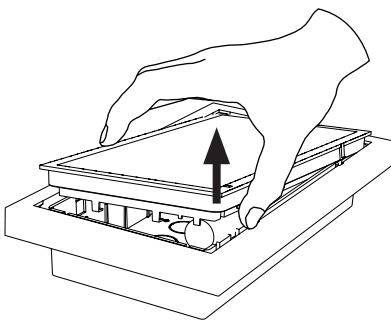

c

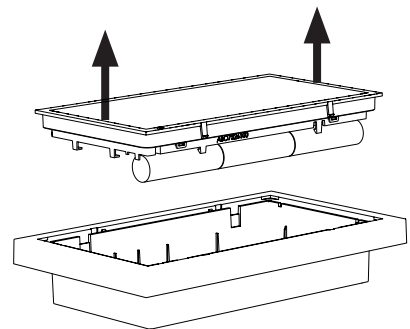

2

⚠

- Ø 20 : Secteur / Mains / Stromnetz
- Ø 15 : Câblage communication / Communication wiring / Kabel Kommunikation

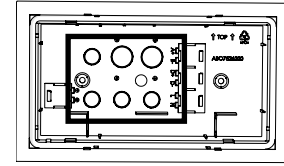
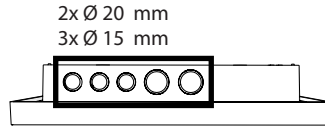

2x Ø 20 mm
4x Ø 15 mm



a

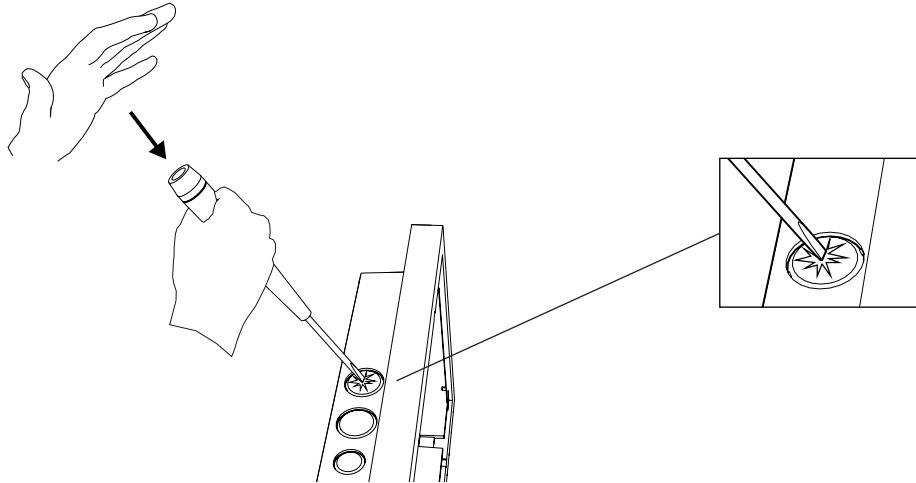

b

IP42

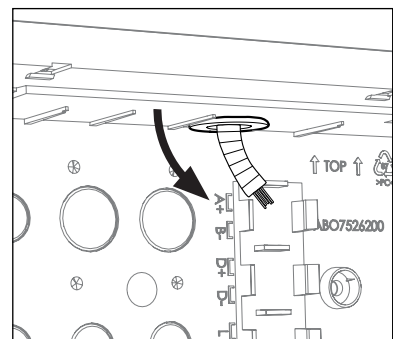
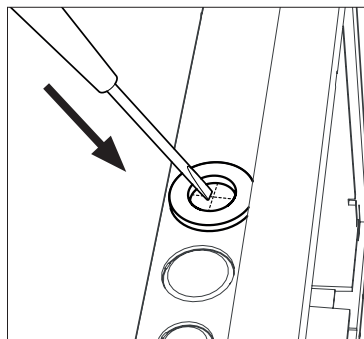
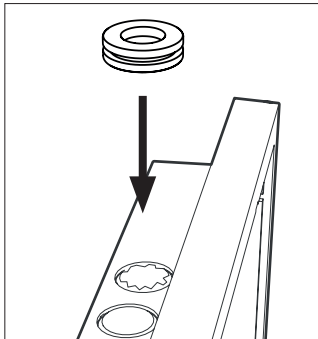

IP65

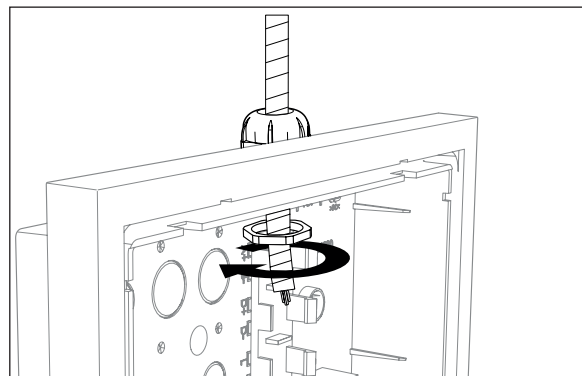
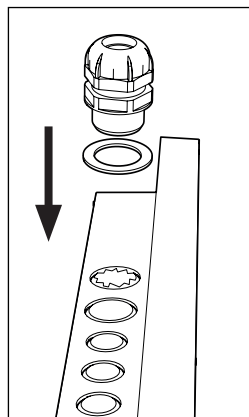

C



Pour la version IP65, vérifier que les rondelles fibres sont correctement installées.
For IP65 variant, make sure the fiber washers are properly installed.
Für IP65, überprüfen Sie die richtige Positionierung der Dichtscheiben.

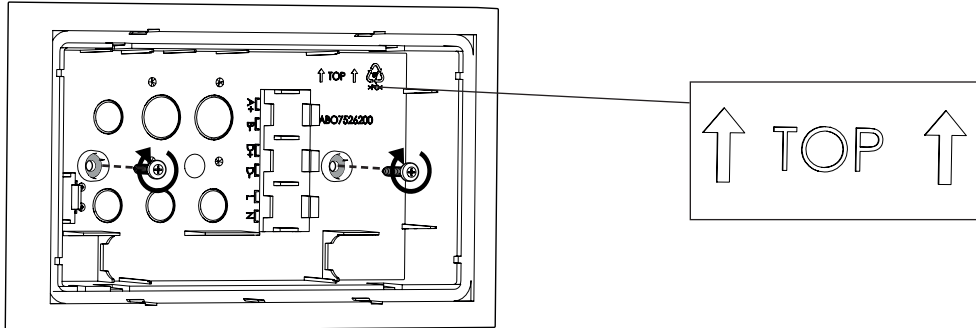

3

Rigid or flexible wire / Fil souple ou rigide / Starre oder flexible Leitung
0,5 < S < 2,5 mm²

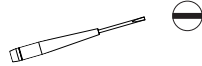

If rigid wire/ Si fil rigide / Wenn starre Leitung
1,5 < S < 2,5 mm²



IN
Entrée de câble

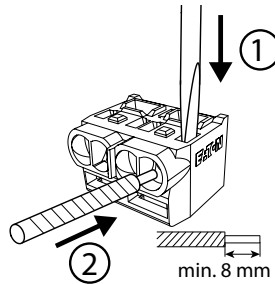

OUT
Sortie de câble

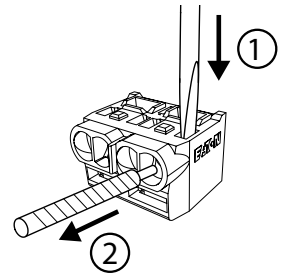

a

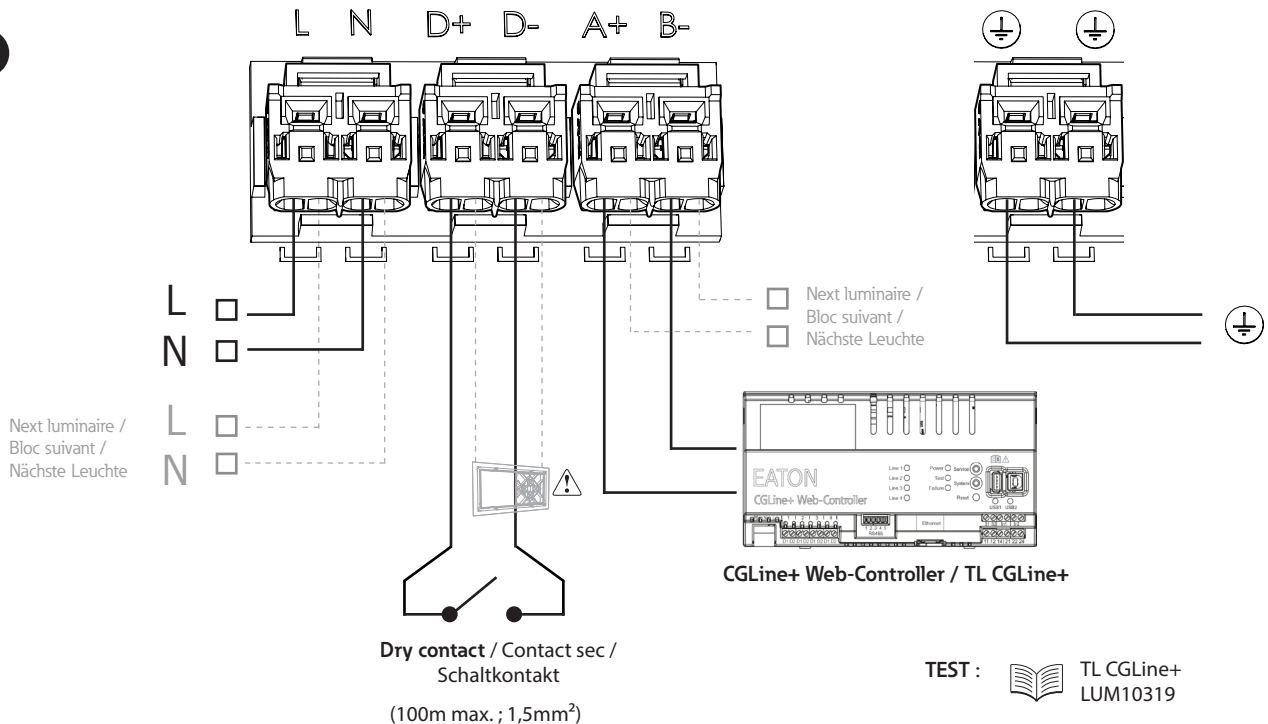

Polarité / Polarity / Polarität

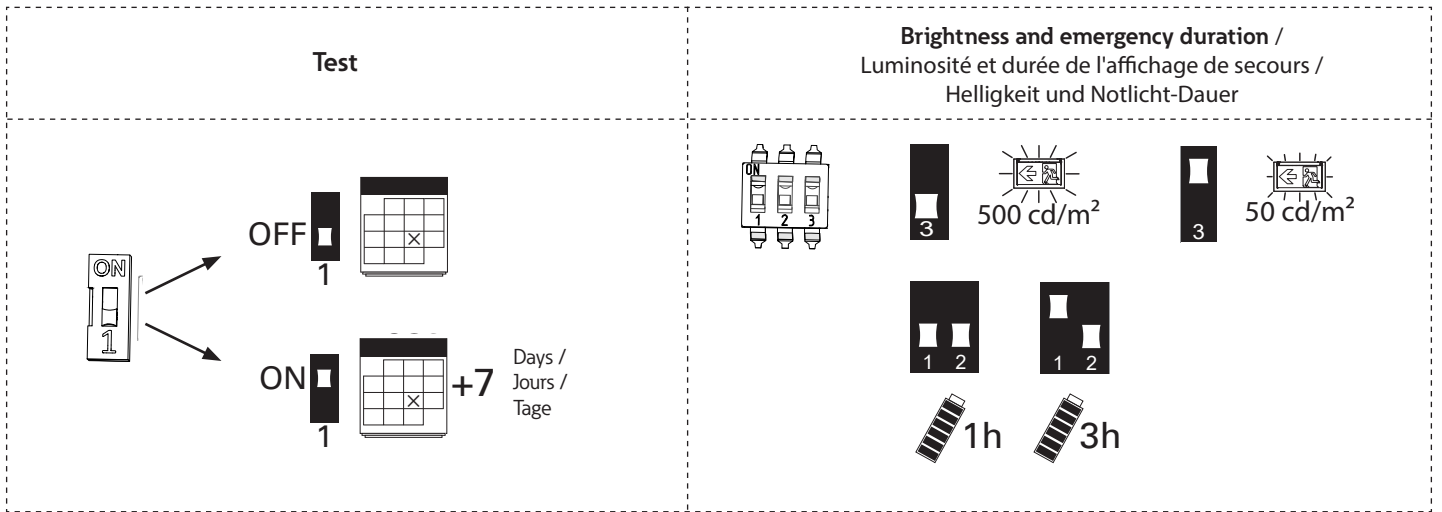
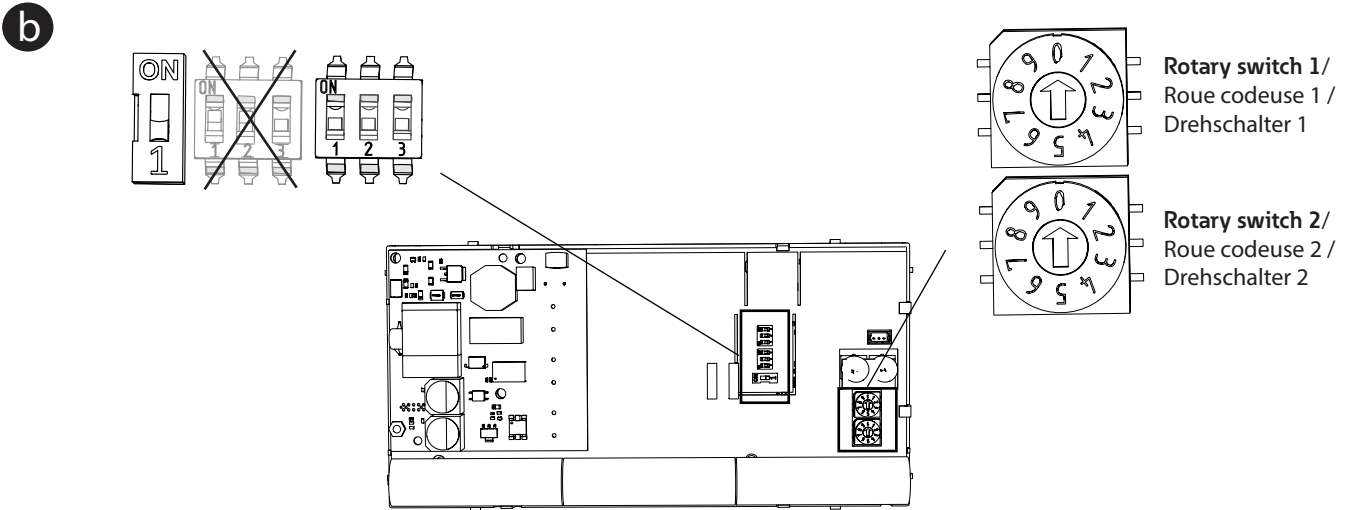

c

Rotary switch 1 : Default signaling /
Roue codeuse 1 : Affichage par défaut /
Drehschalter 1 : Standard-Anzeige

0	1	2	3	4	5

Rotary switch 2 : Signaling when dry contact closed /
Roue codeuse 2 : Affichage lorsque les contacts secs sont fermés /
Drehschalter 2 : Anzeige, wenn Schaltkontakt geschlossen

0	1	2	3	4	5	6	7	8	9

d **Reset**
Réinitialisation

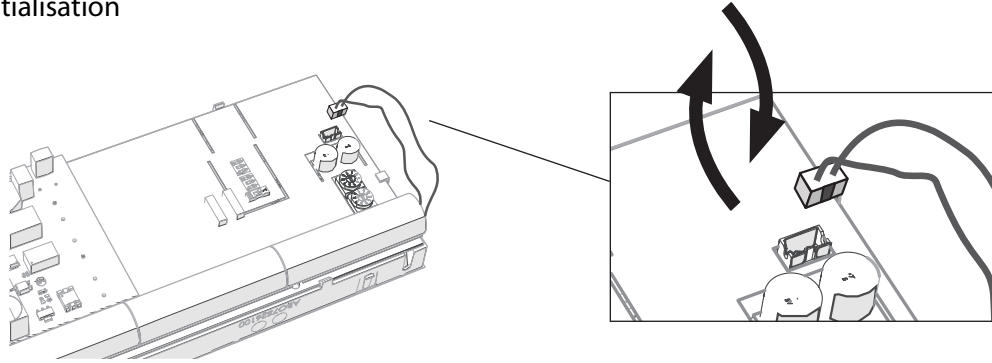

e

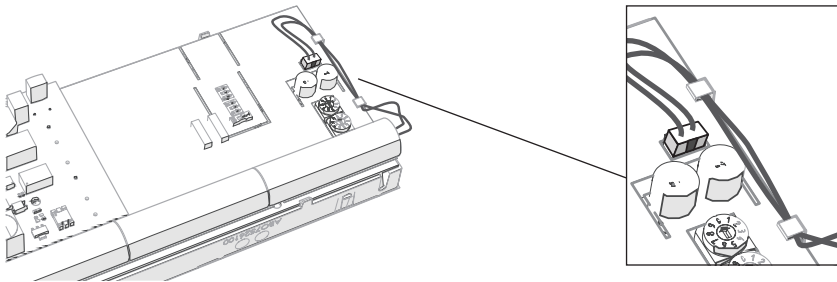

f

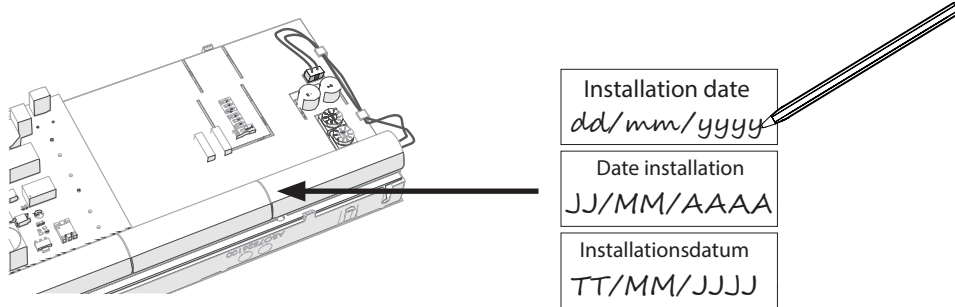

4

a

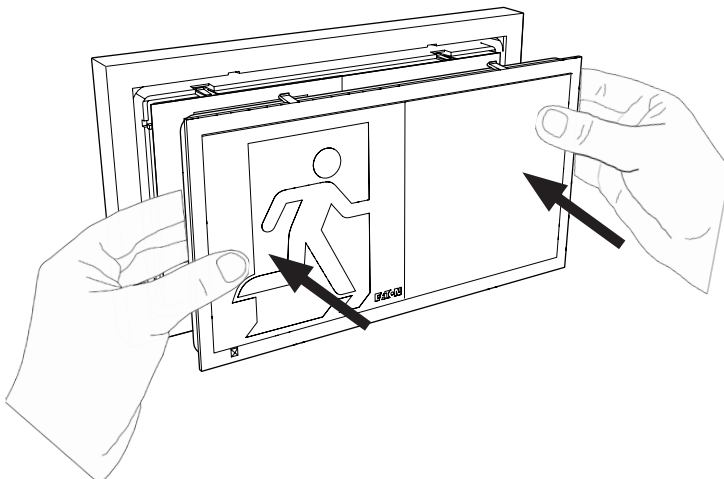

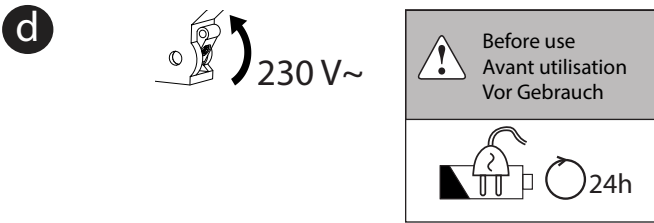
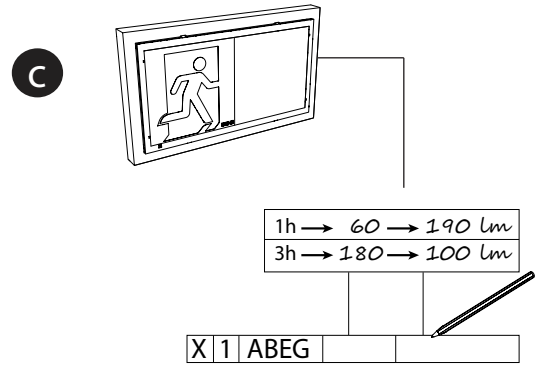
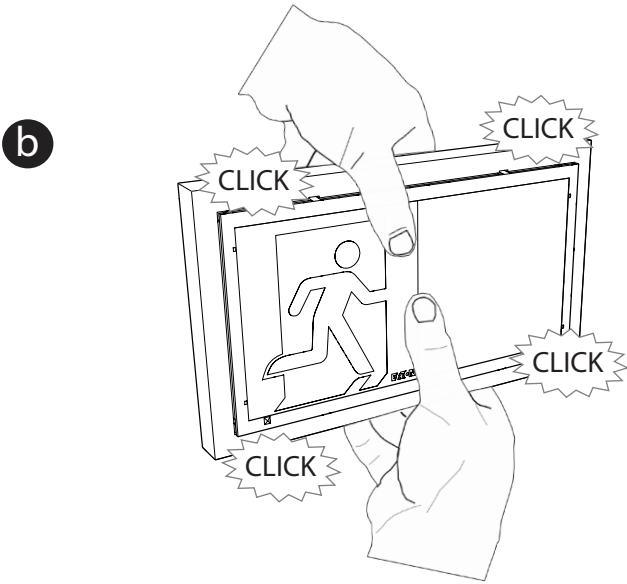

5 Operation / Utilisation / Betrieb

5.1. Indicator / Voyant / Leuchtanzeige

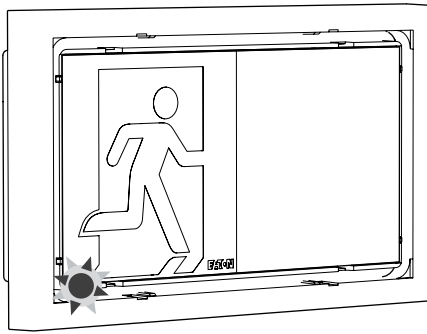

Green/ Vert / Grün	●		OK
Green/ Vert / Grün	★		Test
Green & yellow/ Vert & Jaune/ Grün & Gelb	★))) ○ com
Yellow/ Jaune / Gelb	★	2 s	🔋
Yellow/ Jaune / Gelb	★	0,5 s	💡

● Constant/
Fixe/
Permanent

★ Blinking/
Clignotant/
Blinkend

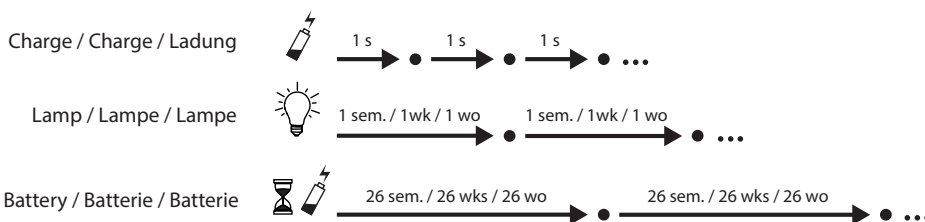



If no web-controller or communication fault with the web-controller/

Si absence de web-controller ou défaut de la communication avec le web-controller

Ohne Web-Controller oder bei Kommunikationsfehler

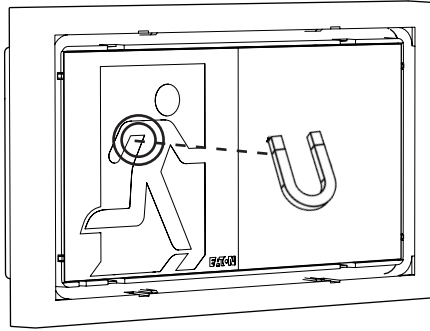
5.2. Test



 Ref. 40071352379
F - 1600g

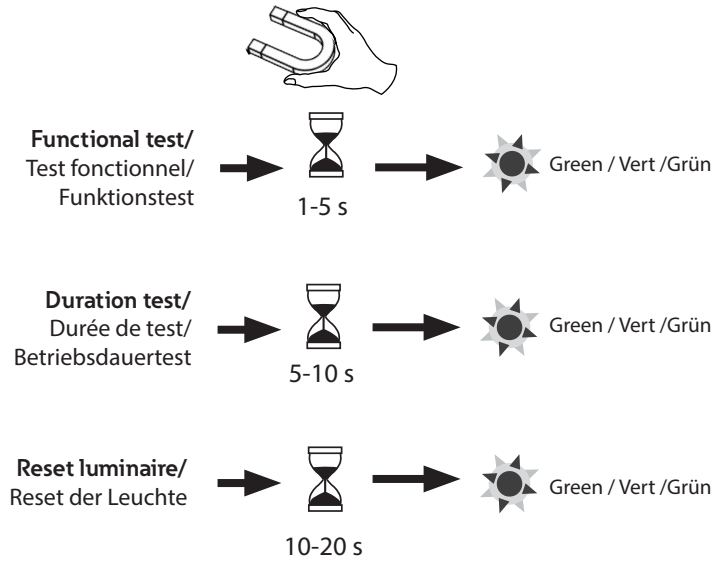

6 Initialization of test interval and product configuration / Initialisation de l'intervalle des tests et configuration / Initialisierung des Test-Intervalls und Produktkonfiguration

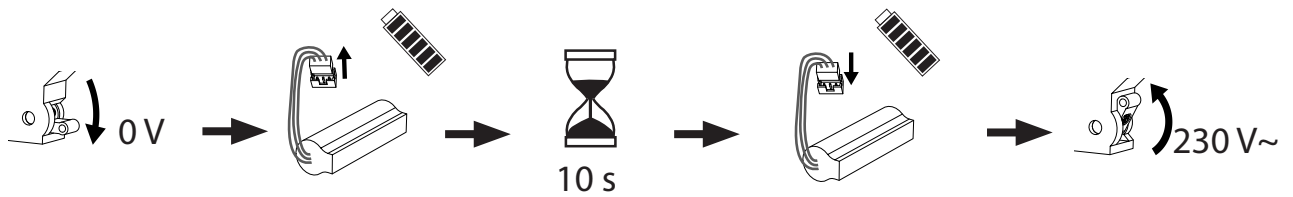

OR CGLine+ web-controller / TL CGLine+

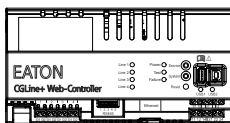

 See manual / Voir manuel / Siehe Betriebsanleitung
CGLine+ Web-Controller 40071361055
TL CGLine+ LUM10319

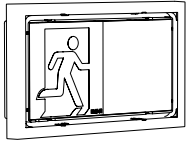

Battery pack
Pack batterie
Akku-pack



EN



Matrix 1-3h CGLine+	40071777002	IP42 / IK07	3.6V/3.3 Ah Li-Ion	1 h / 3 h	62 x LED 2,6V 5mA 38 x LED 3V 30mA 38 x LED 2V 10mA	230 V~ /50-60 Hz 50 cd/m ² : 3,2W - 7,7VA 500 cd/m ² : 6,6W - 13,7VA	EN60598.1 EN60598.2.22 EN1838/ISO30061 EN62034
	40071777003	IP65/ IK07					



Replaceable
Remplaçable
Auswechselbar



NEXI-BAT3

If the battery duration is insufficient, replace the battery.
Si l'autonomie est insuffisante, changer la batterie.
Wenn die Notlichtdauer nicht mehr erreicht wird, ersetzen Sie die Batterie.



Not replaceable
Non remplaçable
Nicht auswechselbar



WEEE : contact your local dealer