

Installation Instructions for: Halo-Pack 2



IP20 CE

- Product luminaires comply with EN60598 and are suitable for use in normal interior conditions.
- This luminaire has an ambient temperature range of 5°C to 25°C.

1

Cut aperture and feed mains cable through

Max. 70.0mm Ø

Note: For retrofit, the adaptor plate can be used for a cutout size up to 110.0mm Ø

2

Remove gear pod lid using a screwdriver and connect battery connector to PCB, refit lid

3

To mains

Connect plug from LED head into socket in gear pod

Connector from LED head

Connect mains cable to flying lead from gear pod, connector is not supplied. Use a WAGOBOX junction box and Wago Series 222 connectors, or suitable alternative.
Ensure mains supply is turned OFF
Brown - Live
Blue - Neutral
Yellow/Green - Earth

4

Feed gearpod through aperture to sit in ceiling

5

Hold fitting with thumb and forefinger, use middle fingers to bend springs and guide the fitting into the ceiling cutout. Ensure springs hold fitting securely place

NOTE: Adaptor plate is **NOT** required for new installations

For retrofit applications (cutout up to 110mm) - Adaptor plate required

Adaptor Plate

Fitting Secured in Ceiling

IMPORTANT NOTE:

- Luminaire battery **MUST NOT** be connected until building has a permanent un-switched live supply.
- Repeated full discharges caused by fully removing power to luminaires with connected batteries (i.e. a nightly building power down prior to hand over) will permanently damage the battery and invalidate any warranty.
- This luminaire is equipped with a dual state battery charger, whilst the boost charge is in operation the LED indicator will flash. After boost charge the LED indicator will illuminate.
 - Boost charge 16 hours at initial power up and after a supply failure of more than 10 minutes.
 - Boost charge 1 hour after a supply failure of less than 10 minutes.

Testing Maintained:

The unit should be connected to an unswitched live supply, which should be connected to the normal lighting sub-circuit in that location. The LED indication should be checked to ensure that it is illuminated, this indicates that the batteries are charging.

A short discharge should be performed to check that the units are operating correctly. This is carried out by interrupting the unswitched supply at the distribution board or by isolating the appropriate unswitched supply sub-circuit. The supply should then be restored and the LED indication checked. After 24hrs carry out a full rated discharge test. The testing regime as defined in EN 50172 should then be implemented.

If the unit no longer meets the emergency duration the battery must be replaced with a battery of the same type.

Nominal lamp lumen output: 1 Lumen (NOTE: This figure is obtained after safety cycling tests).

This value is provided to permit checking of correct operation, determination of the lighting level on an escape route can only be made with full photometric data.

When used as intended this product complies with the EMC Directive 2004/108/EC and Low Voltage Directive 2006/95/EC.

Date of commissioning to be entered in the space provided on the battery label by either the installer or commissioning engineer.

Safe Operation

1. Check the rating label for voltage and frequency before connecting this luminaire to the electrical supply.
2. Ensure that the mains supply is switched off when working on this luminaire, whether installing or carrying out any other servicing.
3. Do not mount luminaire on or close to readily flammable materials.
4. To prevent damage to driver, do not mix with conventional magnetic ballasts on the same electrical circuit.
5. Where use in more onerous situations is required, e.g. In part-completed buildings before "drying-out" is completed, or areas where ambient temperatures are outside the normal temperature range, then consult our Sales Office.
6. The light output of the product may cause injuries to human eyes in circumstances where the product is viewed directly with unshielded eyes for more than a few seconds.

Servicing and Disposal

1. At commissioning and handing over of installation ensure that a copy of these instructions is presented to the authority responsible for the operation and maintenance of the luminaires.
2. Servicing, e.g. cleaning, must only be carried out after the electricity supply has been switched off. It must not be assumed that luminaires with lamps not lit are switched off-always check before servicing.
3. Cleaning should be carried out at regular intervals to ensure that dirt does not accumulate to an extent that will impair the thermal safety or optical performance of the luminaire. Regular cleaning will also ensure that the optical performance of the luminaires is maintained.
4. Avoid touching the LED array surface. To clean - Blow surface with either dry air or nitrogen gas.
5. At the end of life the luminaire is classed as WEEE under directive 2002/96/EC and should be disposed of in accordance with local legislation.

Luminaire Cleaning

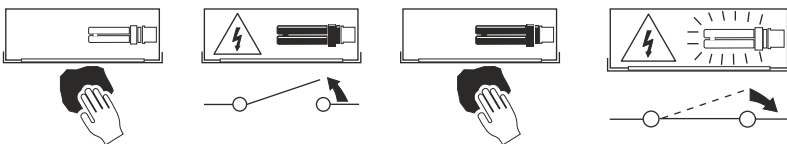

End of Life and Components Disposal

