

We make emergency lighting
child's play

EATON

Powering Business Worldwide



Flexible and easy Emergency Lighting

New FlexiTech range

FlexiTech makes emergency lighting unmissable

In an emergency, exit signage and safety lighting is vital to guide a building's occupants to safety.

Yet a project may have different requirements for signage and safety lighting. It will need both wall and ceiling mounted options with different lighting levels and exit legends to suit various applications.

Whatever the project, FlexiTech can offer multiple options. FlexiTech SE is all you need for safety lighting. FlexiTech ED meets your exit signage requirements, all from one box.

CGLine+ variants brings you even more peace of mind, making monitoring and visualisation of the system easier and evacuation safer thanks to new Increased Affordance functionality.





FlexiTech facilitates your day to day jobs and projects thanks to an easy to manage and consistent range

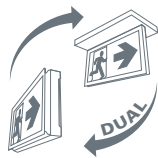

Exit sign - FlexiTech ED (Exit Sign Dual position)

FlexiTech ED is a double-sided exit sign (IP43) that can be mounted on either the wall or the ceiling. The edge panel is equipped with a LED strip and lightguide for a perfect and homogenized illumination of the exit legends. Slide the edge panel on the electronic casing and connect the LED strip to configure the luminaire in the ceiling position. The new Increased Affordance functionality is available on CGLine+ variants.

Safety lighting - FlexiTech SE (Safety light for Escape route illumination)

The safety light, FlexiTech SE (IP65), is optimized for escape route illumination offering efficient spacing between luminaires and adapts to most applications. For other use, the optical lens could be easily replaced by optional one providing a different light distribution.



FlexiTech is available as Self-Contained luminaires. Variants for Central Power Systems will follow.

FlexiTech ED - Exit sign Dual position

Exit Sign - Single or double-sided, 20m viewing distance, IP43

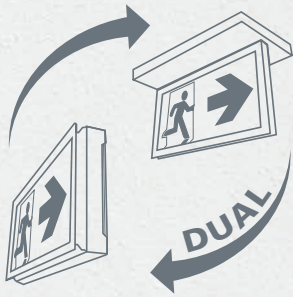

Modern and flexible design

- One product for wall or ceiling mounting
- Straightforward design
- Lean housing
- Minimum technical details, clean surfaces





Perfect illumination

- Homogenized illumination
- High luminance of white contrast colour >500 Cd/m²
- Configurable level of light in mains mode



FlexiTech facilitates your day to day jobs and projects

- Multiple configurations in one box
- Fast installation
- Increased affordance for safer evacuation
- Customization for improved integration
- Reduced maintenance effort, energy savings and respectful to the environment



New DUAL system

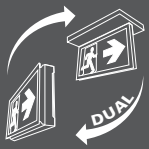

The new patented dual system enables the edge panel to be easily mounted into the case. This can be fitted into the wall or ceiling position without additional accessories required.

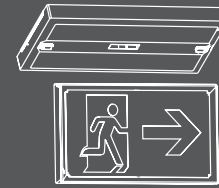

5 features that make FlexiTech easy to manage, all in 1 box

One product offers multiple configurations. This makes easier quoting, ordering and stock management. Thus, the installer doesn't need to anticipate the exact configuration of the building (direction of the arrow, mounting position, etc.). This One box solution also avoids risk of missing parts on worksite.



- **Wall or ceiling mounting** simply done by clipping edge panel to electronic case 
- Edge panel composed of a LED strip and light guide for **single or double-sided use**
- Delivered with non adhesive exit legends for **most of existing configurations**
- Self-Contained luminaire gives the possibility to **configure easily the duration** (1 to 8 hours)
- Possibility to **configure the lighting level** in mains mode of Self-Contained luminaires

6 innovations that make FlexiTech easier to install

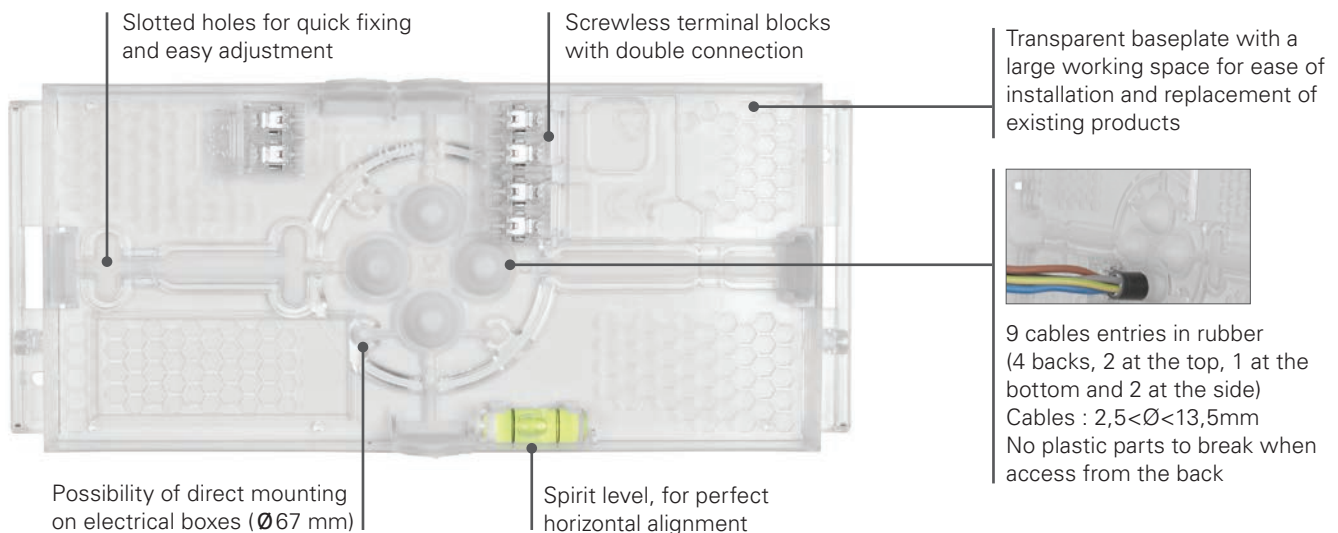

Technologies and features that make FlexiTech a friend for life

FlexiTech range has been developed to minimize maintenance efforts, generate energy savings and respect the environment.

Automatic Test...

- AT**
- Reduced efforts for inspection
 - Result of test is displayed on LED visible in all mounting positions

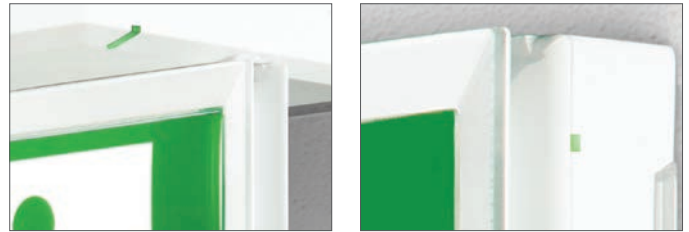

... Monitoring for projects and long use

- CG+_{Line}**
- Automatic Tests and individual monitoring
 - Compatible with CGLine+ systems

- 
- 0 replacement of spare parts for 10 years



... Fast and intuitive interventions on luminaires



Easy separation of the transparent baseplate from the casing

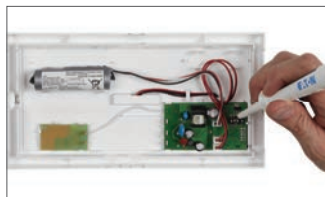

Maximum accessibility of components, easy replacement of battery pack



Honeycomb footprint zones to easily reuse existing fixing holes.



EATON magnet can be used to :

- Carry out manual tests
- Configure the lighting level in mains mode (30, 70 or 100%)

... Eco-design preserving your product and the environment



- Reduced impact on the environment throughout its life cycle (manufacture, use, recycling)



- Conform to REACH and ROHS



- Batteries without Cadmium



- Latest generation of high performance LEDs



- Low consumption
- Brightness in mains mode could be also adjusted (30, 70, 100%)
- Luminaires could be used in Maintained & Non-Maintained mode



Unmissable exit signs...



... thanks to Increased Affordance

Increased Affordance function (IA) available on CGLine+ versions, makes exit signs more recognizable when evacuation is needed, even in a very brightly lit environment.



In mains operation, **uniform illumination** of the pictograms facilitates the identification of emergency exits.



An evacuation order (fire, danger or climatic risk) triggers the **Increased Affordance** function which enables better recognition of the escape route through blinking or pulsing.



In case of power failure, the pictograms are perfectly legible **without risk of glare** for users.

... for safer evacuation

Without IA

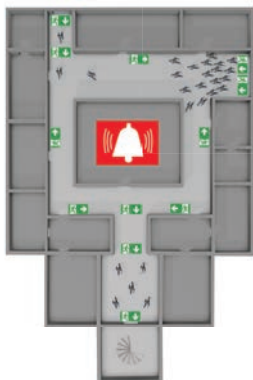

Risk of congestion at entry points of the building.



Difficult for those with impaired hearing who may not hear any accompanying vocal instructions.

With IA

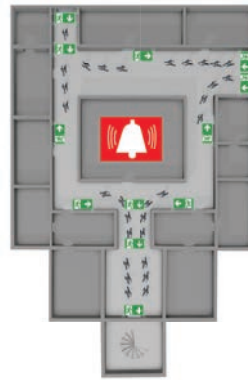

The animation of the safety pictograms (blinking) facilitates the identification of ALL available escape routes and exits.

Go further with additional integration...



Recess Kit for Ceiling

- One kit compatible with FlexiTech SE and ED
- Low profile for full recessed ability
- Cutting template included for quick implementation

... and customization

Frames and accessories in a variety of colours*

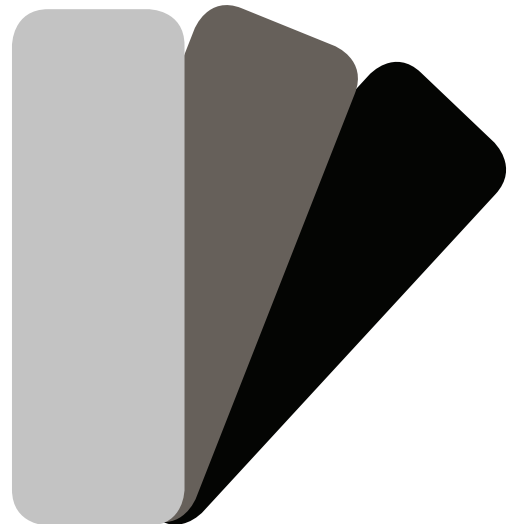

Custom designed pictograms*



*For more information, contact us.

FlexiTech ED - Datasheet



FlexiTech ED - Wall mounted



FlexiTech ED - Ceiling mounted



FlexiTech ED CGLine+

- LED self-contained luminaire with automatic test and individual monitoring (CGLine+) for reduced inspection effort
- 20m viewing distance Exit sign, single and double sided
- Non obstrusive design and slim housing (34mm)
- Same aesthetic either in wall or ceiling mounting
- "Dual" concept, Exit sign luminaire ready for use in wall-surface or ceiling-surface mounting (one box solution)
- Delivered with non adhesive exit legends for most of existing configurations (single & double sided signage)
- Increased affordance functionality for better visibility of the exit sign and faster evacuation
- Perfect homogeneity and uniformity of the pictogram's illuminance
- Optimal recognition via high luminance of white contrast colour > 500 Cd/m² according to DIN4844-1 / ISO 3864-1 (for bright surroundings), and high uniformity L_{min}/L_{max} > 0.8
- Brightness selectable in two steps in mains operation (eg. theater: 50 cd/m², Supermarket: 500 cd/m²) and additional setting (30%, 70%, 100%)
- Selectable operating time (1/2/3/8h operation)
- Selectable operation mode (M or NM) via external switch
- Large working space, cable entries in flexible material and spirit level for easy and fast installation
- Transparent base plate with honeycomb footprint for easy replacement of existing products
- Low eco footprint thanks to eco designed luminaire, low consumption and Lithium battery
- Life span: 10 years, proved with 1 year aging test @ 70°C ambient temperature
- No component replacement during 10 years
- Simple fault analysis and status display via bicolor LED, testing button (magnet) and supervision solutions
- Complete range of accessories (Recess Kit for Ceiling, Wire Guard)
- Other colours available on demand
- Custom designed pictograms also available

Pictogram	
Viewing distance	20m
Included labels	4 Non adhesive Exit legends (D,U,R,L) ISO format
Luminous flux Φ_E/Φ_N at end of rated operating time	100% @ 1h, 50% @ 2h, 42% @ 3h, 16% @ 8h
Illumination in mains mode	50 or 500 cd setting via switch, and possible additional setting via magnet (30%, 70%, 100%)
Operation	Maintained / Non-Maintained (via external switch)
Testing system	Automatic test in compliance with EN 62034 Connection possible to the CGLine+ monitoring system
Housing	
Type of mounting	Wall surface-mounting, Ceiling surface-mounting
Material	Polycarbonate
Colour	White RAL9003
Degree of protection	IP43 / IK07
Terminals	Screwless terminals for flexible and rigid wires From 0,5 to 2,5 mm ²
Connection voltage	220 - 240 V AC, 50/60 Hz
Permissible ambient temperature	5°C to 35°C for 10 years lifetime
Battery	LifePo
Light source	LED
Dimensions	Housing: 120 x 228 x 34 mm - Edge panel thickness: 14.4 mm
Insulation Class	II

Ordering details

Order code	Duration (h)	Illumination in mains mode (cd)	Operation	Consumption		Battery	Weight (kg)
				NM WVA	M 500 cd WVA		
FT2ED4ICGL18	1/2/3/8	50 or 500	MNM	0,4W / 1VA	2W / 5 VA	FT-BATLL2	0.5



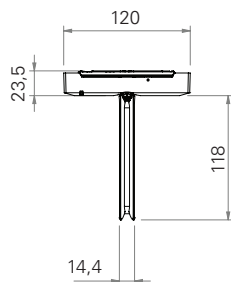
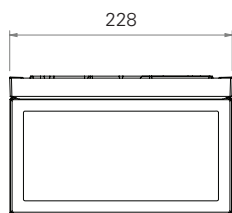

Dimensions in mm (ceiling mounted)

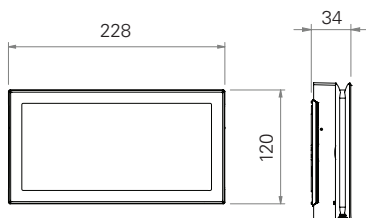







Dimensions in mm (wall mounted)



Accessories

	FT2-RKC	Recess Kit for Ceiling, compatible with FlexiTech SE and FlexiTech ED (ceiling position)
	FT2-WG	Wire Guard, compatible with FlexiTech SE and FlexiTech ED
	40071352379	Eaton Magnet for lighting configuration and manual tests
	FT-BATLL2	Battery Pack, LifePo long life 3,2V / 1,5Ah
	FT2ED-4I	Set of 4 pictos for FlexiTech ED, 20m (D, L, R, U), ISO format

Pictograms

	FT2ED-PICTO-VL	EATON FlexiTech 20m, Picto, ISO7010-E001 VL, Exit Vertical Left
	FT2ED-PICTO-VR	EATON FlexiTech 20m, Picto, ISO7010-E002 VR, Exit Vertical Right
	FT2ED-PICTO-VD	EATON FlexiTech 20m, Picto, ISO7010-E002 VD, Exit Vertical Down
	FT2ED-PICTO-UR	EATON FlexiTech 20m, Picto, ISO7010-E002 U/R, Exit Up Right
	FT2ED-PICTO-DR	EATON FlexiTech 20m, Picto, ISO7010-E002 D/R, Exit Down Right
	FT2ED-PICTO-DL	EATON FlexiTech 20m, Picto, ISO7010-E001 D/L, Exit Down Left
	FT2ED-PICTO-UL	EATON FlexiTech 20m, Picto, ISO7010-E001 U/L, Exit Up Left
	FT2ED-PICTO-DMD	EATON FlexiTech 20m, Picto, FDX08-040-3 T28, Man in wheel chair door & arrow down
	FT2ED-PICTO-DML	EATON FlexiTech 20m, Picto, FDX08-040-3 T28, Man in wheel chair door & arrow left
	FT2ED-PICTO-DMR	EATON FlexiTech 20m, Picto, FDX08-040-3 T28, Man in wheel chair door arrow right
	FT2ED-PICTO-DML1	EATON FlexiTech 20m, Picto, DIN4844, Man in wheel chair & arrow left
	FT2ED-PICTO-DMR1	EATON FlexiTech 20m, Picto, DIN4844, Man in wheel chair & arrow right
	FT2ED-PICTO-DMD1	EATON FlexiTech 20m, Picto, DIN4844, Man in wheel chair & arrow down
	FT2ED-PICTO-MP	EATON FlexiTech 20m, Picto, ISO7010-E007, Meeting Point
	FT2ED-PICTO-H	EATON FlexiTech 20m, Picto, Hydrant
	FT2ED-PICTO-CR	EATON FlexiTech 20m, Picto, ISO7010-E003, First-Aid
	FT2ED-PICTO-FEX	EATON FlexiTech 20m, Picto, ISO7010-F001, Fire Extinguisher
	FT2ED-PICTO-FHO	EATON FlexiTech 20m, Picto, ISO7010-F002, Fire Hose
	FT2ED-PICTO-INFO	EATON FlexiTech 20m, Picto, ISO7001/P-I PF001, INFO
	FT2ED-PICTO-WC	EATON FlexiTech 20m, Picto, ISO7001/P-I PF003, WC
	FT2ED-PICTO-EWL	EATON FlexiTech 20m, Picto, ISO7010-E016, Escape Window Left
	FT2ED-PICTO-EWR	EATON FlexiTech 20m, Picto, ISO7010-E016, Escape Window Right
	FT2ED-PICTO-EWD	EATON FlexiTech 20m, Picto, ISO7010-E016, Escape Window Down
	FT2ED-PICTO-RWL	EATON FlexiTech 20m, Picto, ISO7010-E017, Rescue Window Left
	FT2ED-PICTO-RWR	EATON FlexiTech 20m, Picto, ISO7010-E017, Rescue Window Right
	FT2ED-PICTO-RWD	EATON FlexiTech 20m, Picto, ISO7010-E017, Rescue Window Down

FlexiTech ED - Datasheet

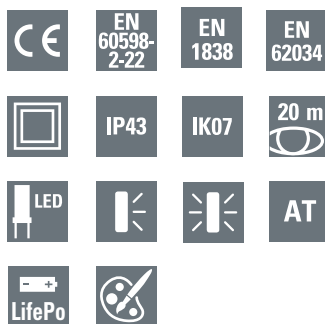

FlexiTech ED AT

- LED self-contained luminaire with Automatic Test (AT) for reduced inspection effort
- 20m viewing distance Exit sign, single and double sided
- Non obstrusive design and slim housing (34mm)
- Same aesthetic either in wall or ceiling mounting
- "Dual" concept, Exit sign luminaire ready for use in wall-surface or ceiling-surface mounting (one box solution)
- Delivered with non adhesive exit legends for most of existing configurations (single & double sided signage)
- Perfect homogeneity and uniformity of the pictogram's illuminance
- Optimal recognition via high luminance of white contrast colour > 500 Cd/m² according to DIN4844-1 / ISO 3864-1 (for bright surroundings), and high uniformity L_{min}/L_{max} > 0.8
- Brightness selectable in two steps in mains operation (eg. theater: 50 cd/m², Supermarket: 500 cd/m²) and additional setting (30%, 70%, 100%)
- Selectable operating time (1/2/3/8h operation)
- Selectable operation mode (M or NM) via external switch
- Large working space, cable entries in flexible material and spirit level for easy and fast installation
- Transparent base plate with honeycomb footprint for easy replacement of existing products
- Low eco footprint thanks to eco designed luminaire, low consumption and Lithium battery
- Simple fault analysis and status display via bicolor LED, testing button (magnet)
- Complete range of accessories (Recess Kit for Ceiling, Wire Guard)
- Other colours available on demand
- Custom designed pictograms also available

FlexiTech ED - Wall mounted



FlexiTech ED - Ceiling mounted



Pictogram	
Viewing distance	20m
Included labels	4 Non adhesive Exit legends (D,U,R,L) ISO format
Luminous flux Φ_e/Φ_N at end of rated operating time	100% @ 1h, 50% @ 2h, 42% @ 3h, 16% @ 8h
Illumination in mains mode	50 or 500 cd setting via switch, and possible additional setting via magnet (30%, 70%, 100%)
Operation	Maintained / Non-Maintained (via external switch)
Testing system	Automatic Test in compliance with EN 62034
Housing	
Type of mounting	Wall surface-mounting, Ceiling surface-mounting
Material	Polycarbonate
Colour	White RAL9003
Degree of protection	IP43 / IK07
Terminals	Screwless terminals for flexible and rigid wires From 0,5 to 2,5 mm ²
Connection voltage	220 - 240 V AC, 50/60 Hz
Permissible ambient temperature	5°C to 45°C, 0°C to 45°C in maintained mode
Battery	LifePo
Light source	LED
Dimensions	Housing: 120 x 228 x 34 mm - Edge panel thickness: 14.4 mm
Insulation Class	II

Ordering details

Order code	Duration (h)	Illumination in mains mode (cd)	Operation	Consumption		Battery	Weight (kg)
				NM WVA	M 500 cd WVA		
FT2ED4IATL18	1/2/3/8	50 or 500	MNM	0,4W / 1VA	2W / 5 VA	FT-BAT1	0.5



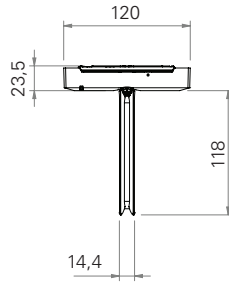
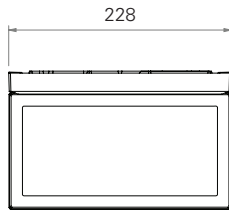

Dimensions in mm (ceiling mounted)

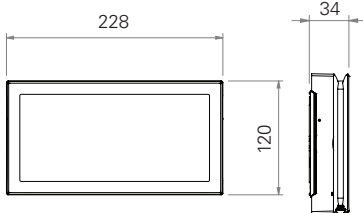

Dimensions in mm (wall mounted)

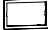

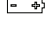
Accessories

	FT2-RKC	Recess Kit for Ceiling, compatible with FlexiTech SE and FlexiTech ED (ceiling position)
	FT2-WG	Wire Guard, compatible with FlexiTech SE and FlexiTech ED
	40071352379	Eaton Magnet for lighting configuration and manual tests
	FT-BAT1	Battery Pack, LifePo 3,2V / 0,6Ah
	FT2ED-4I	Set of 4 pictos for FlexiTech ED, 20m (D, L, R, U), ISO format

Pictograms

	FT2ED-PICTO-VL	EATON FlexiTech 20m, Picto, ISO7010-E001 VL, Exit Vertical Left
	FT2ED-PICTO-VR	EATON FlexiTech 20m, Picto, ISO7010-E002 VR, Exit Vertical Right
	FT2ED-PICTO-VD	EATON FlexiTech 20m, Picto, ISO7010-E002 VD, Exit Vertical Down
	FT2ED-PICTO-UR	EATON FlexiTech 20m, Picto, ISO7010-E002 U/R, Exit Up Right
	FT2ED-PICTO-DR	EATON FlexiTech 20m, Picto, ISO7010-E002 D/R, Exit Down Right
	FT2ED-PICTO-DL	EATON FlexiTech 20m, Picto, ISO7010-E001 D/L, Exit Down Left
	FT2ED-PICTO-UL	EATON FlexiTech 20m, Picto, ISO7010-E001 U/L, Exit Up Left
	FT2ED-PICTO-DMD	EATON FlexiTech 20m, Picto, FDX08-040-3 T28, Man in wheel chair door & arrow down
	FT2ED-PICTO-DML	EATON FlexiTech 20m, Picto, FDX08-040-3 T28, Man in wheel chair door & arrow left
	FT2ED-PICTO-DMR	EATON FlexiTech 20m, Picto, FDX08-040-3 T28, Man in wheel chair door arrow right
	FT2ED-PICTO-DML1	EATON FlexiTech 20m, Picto, DIN4844, Man in wheel chair & arrow left
	FT2ED-PICTO-DMR1	EATON FlexiTech 20m, Picto, DIN4844, Man in wheel chair & arrow right
	FT2ED-PICTO-DMD1	EATON FlexiTech 20m, Picto, DIN4844, Man in wheel chair & arrow down
	FT2ED-PICTO-MP	EATON FlexiTech 20m, Picto, ISO7010-E007, Meeting Point
	FT2ED-PICTO-H	EATON FlexiTech 20m, Picto, Hydrant
	FT2ED-PICTO-CR	EATON FlexiTech 20m, Picto, ISO7010-E003, First-Aid
	FT2ED-PICTO-FEX	EATON FlexiTech 20m, Picto, ISO7010-F001, Fire Extinguisher
	FT2ED-PICTO-FHO	EATON FlexiTech 20m, Picto, ISO7010-F002, Fire Hose
	FT2ED-PICTO-INFO	EATON FlexiTech 20m, Picto, ISO7001/P-I PF001, INFO
	FT2ED-PICTO-WC	EATON FlexiTech 20m, Picto, ISO7001/P-I PF003, WC
	FT2ED-PICTO-EWL	EATON FlexiTech 20m, Picto, ISO7010-E016, Escape Window Left
	FT2ED-PICTO-EWR	EATON FlexiTech 20m, Picto, ISO7010-E016, Escape Window Right
	FT2ED-PICTO-EWD	EATON FlexiTech 20m, Picto, ISO7010-E016, Escape Window Down
	FT2ED-PICTO-RWL	EATON FlexiTech 20m, Picto, ISO7010-E017, Rescue Window Left
	FT2ED-PICTO-RWR	EATON FlexiTech 20m, Picto, ISO7010-E017, Rescue Window Right
	FT2ED-PICTO-RWD	EATON FlexiTech 20m, Picto, ISO7010-E017, Rescue Window Down

FlexiTech SE - Safety light for Escape route illumination

Safety Luminaires - IP65



Modern and flexible design

- Straightforward design
- Minimum technical details, clean surfaces
- Lean housing



Fully recessed with optional kit

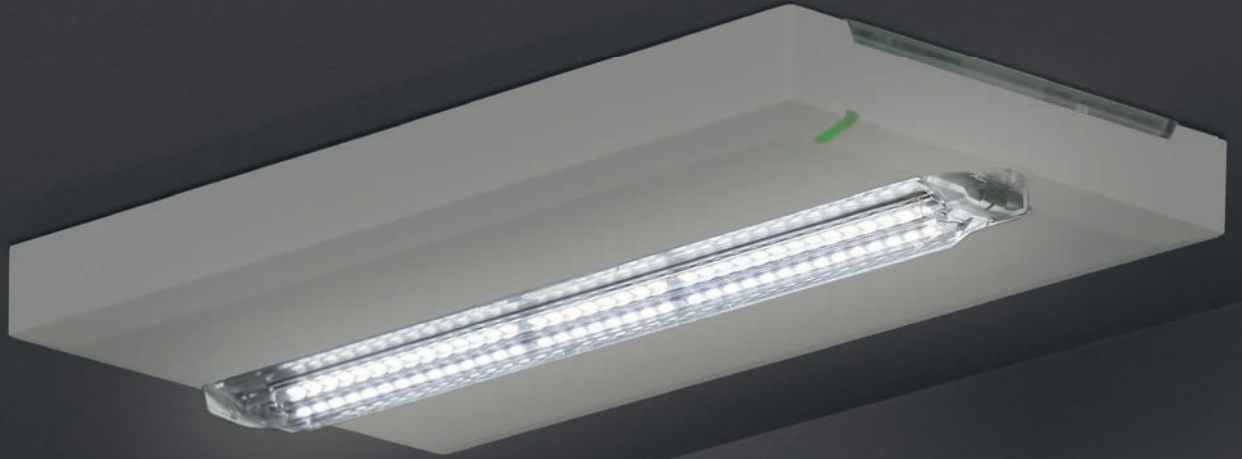

Lighting performance

- Distribution optimized for escape route illumination
- Optional lens to provide different light distribution
- Selectable level of light in mains mode

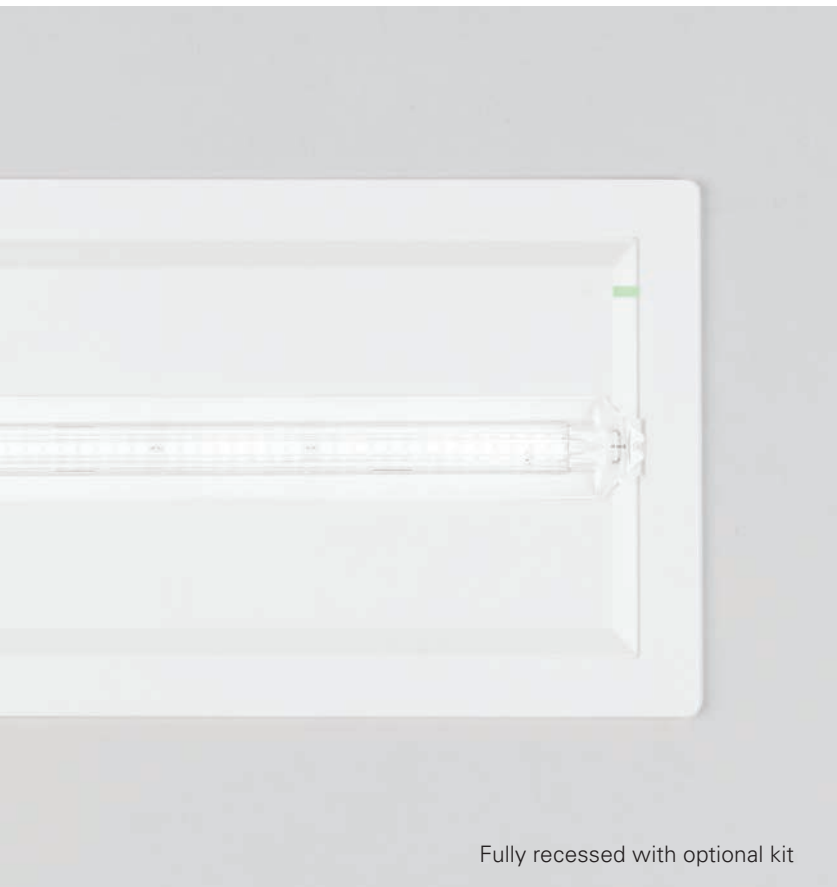

Fully recessed with optional kit

FlexiTech facilitates your day to day jobs and projects

- One product for multiple durations
- Efficient lighting performance
- Fast installation
- Customization for improved integration
- Reduced maintenance effort, energy savings and respectful to the environment, *see page 7*

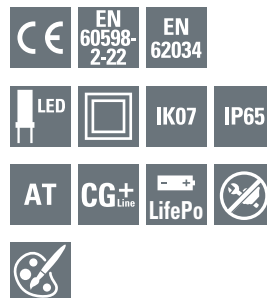

Efficient lighting performance

FlexiTech SE is optimized for escape route illumination, offering efficient spacing between luminaires and powerful light output. It adapts to most applications. For other use, the optical lens could be easily replaced by optional one providing a different light distribution.

Powerful lighting, up to 600 lm in a compact housing

Order code	Duration (h)	lm in emergency mode depending on selected duration					lm in mains
		1h	1.5h	2h	3h	8h	
FT2SE400ATL18IP	1/2/3/8	400	-	230	200	75	10 or 100
FT2SE600CGL13IP	1/1,5/2/3	600	400	300	200	-	10 or 100

Escape route illumination

FlexiTech SE, is optimized to offer efficient spacing between lights and meet most of the applications.

Spacing data available on page 19

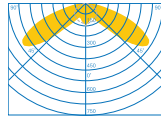

FlexiTech SE
Asymmetric optics

Open area illumination and more

This optional lens provides a symmetric light distribution for more flexibility :

- Open area
 - 5 lux vertically for safety equipment
 - 15 lux for high task area
 - Reduced glare, no direct view on LEDs
- enables the use on the wall (e.g. stair cases)

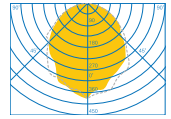

Optional Lens SO
Symmetric optics



Lens of FlexiTech SE can be easily replaced by other one to offer different light distribution

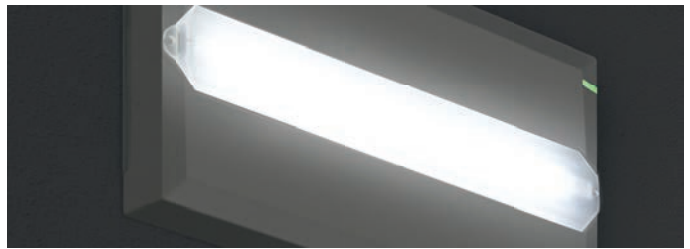

Optional Lens for open area

IP65

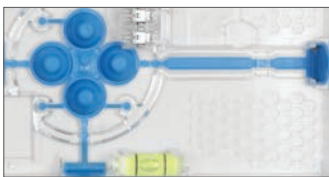

- Special material for IP65, blue rubber
- For IP65 rating, only use slotted holes
- More information on installation, see page 6

Easy product configuration

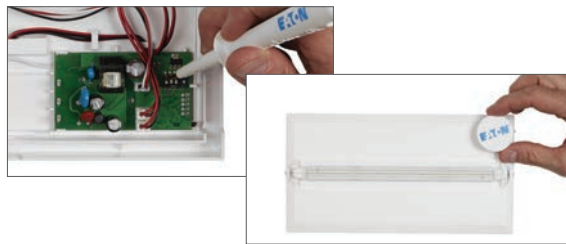

- Dipswitch and jumpers for configuration of duration and light level in mains mode (additional setting could be done with magnet)

Go further with additional integration...

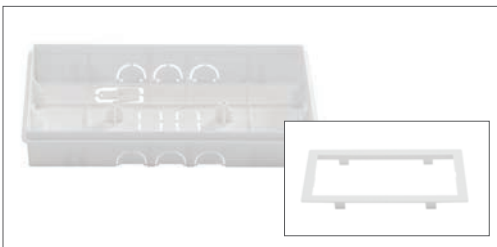

Recessed Box

- Full recess in brick or plaster wall
- Thin frame for a perfect finish

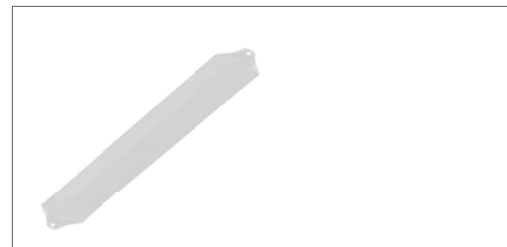

Lens SO

- For open area illumination
- Reduced glare
- Easy mounting

... and customization

Frames and accessories in a variety of colours*

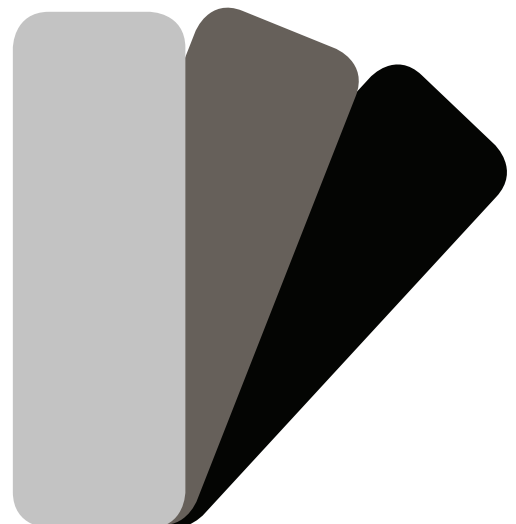

*For more information, contact us.

FlexiTech SE CGLine+- Datasheet

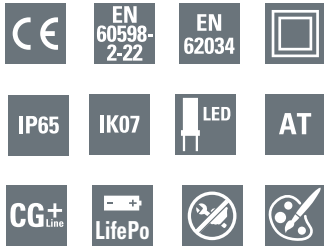

FlexiTech SE CGLine+

- LED Self-Contained luminaire with automatic test and individual monitoring (CGLine+) for reduced inspection effort
- Safety luminaire, light distribution optimized for escape route application, IP65
- Non obtrusive design and slim housing (31.2 mm)
- Good lighting performance and spacing in a compact housing
- Possibility to modify the light distribution by changing the optical lens (option)
- Light output selectable in two steps in mains operation (eg. theater: 10 lm, supermarket: 100 lm) and additional setting (30%, 70%, 100%)
- Selectable operating time (1/1,5/2/3h operation)
- Selectable operation mode (M or NM) via external switch
- Large working space, cable entries in flexible material and spirit level for easy and fast installation
- Transparent base plate with honeycomb footprint for easy replacement of existing products (IP43 use only)
- A green footprint thanks to eco designed luminaire, low consumption and Lithium battery
- Life span: 10 years, proved with 1 year aging test @ 70°C ambient temperature
- No component replacement during 10 years
- Simple fault analysis and status display via bicolor LED, testing button (magnet) and supervision solutions
- Complete range of accessories (Recess Kit for Ceiling, Recessed Box for plaster and brick wall, Wire Guard)
- Other colours available on demand

FlexiTech SE



Dimensions in mm

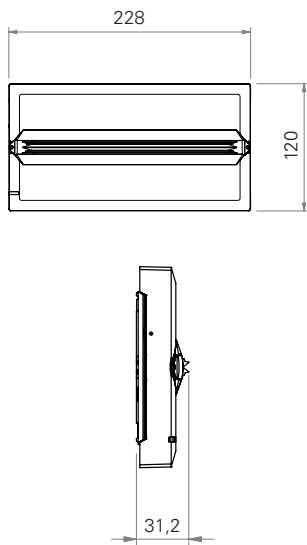

Luminous flux Φ_e/Φ_N at end of rated operating time	100% @ 1h, 68% @ 1.5h, 50% @ 2h, 33% @ 3h
Illumination in mains mode	10 or 100lm setting via switch, and possible additional setting via magnet (30%, 70%, 100%)
Operation	Maintained / Non-Maintained (via external switch)
Testing system	Automatic test in compliance with EN 62034 Connection possible to the CGLine+ monitoring system
Housing	
Type of mounting	Surface-mounting
Material	Polycarbonate
Colour	White RAL9003
Degree of protection	IP65 / IK07
Terminals	Screwless terminals for flexible and rigid wires From 0,5 to 2,5 mm ²
Connection voltage	220 - 240 V AC, 50/60 Hz
Permissible ambient temperature	5°C to 35°C for 10 years lifetime
Battery	LifePo
Light source	LED
Dimensions	120 x 228 x 31.2 mm
Insulation Class	II

Ordering details

Order code	IP	IK	Duration (h)	lm in emergency				lm in mains	Operation	Consumption		Battery	Weight (kg)
				1h	1.5h	2h	3h			NM W/WA	M 100 lm W/WA		
FT2SE600CGL13IP	65	7	1/1,5/2/3	600	400	300	200	10 or 100	MNM	0.4W / 1VA	2W / 5 VA	FT-BATLL3	0.4

Accessories

	FT2-RKC	Recess Kit for Ceiling, compatible with FlexiTech SE and FlexiTech ED (ceiling position)
	FT2-WG	Wire Guard, compatible with FlexiTech SE and FlexiTech ED
	FT2SE-RB	Recessed Box for plaster and brick compatible with FlexiTech SE
	FT2SE-LO	Lens with light distribution optimized for Open area, compatible with FlexiTech SE
	40071352379	Eaton Magnet for lighting configuration and manual tests
	FT-BATLL3	Battery Pack, LifePo long life 3,2V / 3Ah

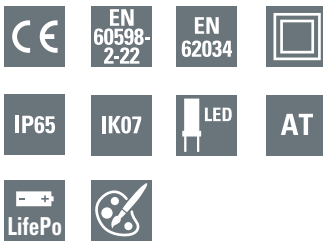

FlexiTech SE AT

- LED self-contained luminaire with Automatic Test (AT) for reduced inspection effort
- Safety luminaire, light distribution optimized for escape route application
- Non obtrusive design and slim housing (31.2 mm)
- Good lighting performance and spacing in a compact housing
- Possibility to modify the light distribution by changing the optical lens (option)
- Light output selectable in two steps in mains operation (eg. theater: 10 lm, Supermarket: 100 lm) and additional setting (30%, 70%, 100%)
- Selectable operating time (1/2/3/8h operation)
- Selectable operation mode (M or NM) via external switch
- Large working space, cable entries in flexible material and spirit level for easy and fast installation
- Transparent base plate with honeycomb footprint for easy replacement and fast installation
- Low eco footprint thanks to eco designed luminaire, low consumption and Lithium battery
- Simple fault analysis and status display via bicolor LED, testing button (magnet)
- Complete range of accessories (Recess Kit for Ceiling, Recessed Box for plaster and brick wall, Wire Guard)
- Other colours available on demand

FlexiTech SE



Dimensions in mm

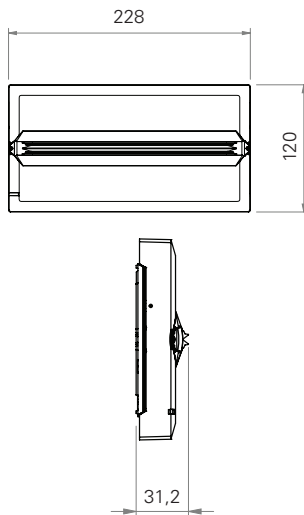

Luminous flux Φ_e/Φ_N at end of rated operating time	100% @ 1h, 58% @ 2h, 50% @ 3h, 18% @ 8h
Illumination in mains mode	10 or 100lm setting via switch, and possible additional setting via magnet (30%, 70%, 100%)
Operation	Maintained / Non-Maintained (via external switch)
Testing system	Automatic Test in compliance with EN 62034
Housing	
Type of mounting	Surface-mounting
Material	Polycarbonate
Colour	White RAL9003
Degree of protection	IP65 / IK07
Terminals	Screwless terminals for flexible and rigid wires From 0,5 to 2,5 mm ²
Connection voltage	220 - 240 V AC, 50/60 Hz
Permissible ambient temperature	5°C to 45°C, 0°C to 45°C in maintained mode
Battery	LifePo
Light source	LED
Dimensions	120 × 228 × 31.2 mm
Insulation Class	II

Ordering details

Order code	IP	IK	Duration (h)	lm in emergency				lm in mains	Operation	Consumption			Weight (kg)
				1h	2h	3h	8h			NM W/A	M 100 lm W/A	Battery	
FT2SE400ATL18IP	65	7	1/2/3/8	400	230	200	75	10 or 100	MNM	0.4W / 1VA	2W / 5 VA	FT-BAT3	0.4

Accessories

	FT2-RKC	Recess Kit for Ceiling, compatible with FlexiTech SE and FlexiTech ED (ceiling position)
	FT2-WG	Wire Guard, compatible with FlexiTech SE and FlexiTech ED
	FT2SE-RB	Recessed Box for plaster and brick compatible with FlexiTech SE
	FT2SE-LO	Lens with light distribution optimized for Open area, compatible with FlexiTech SE
	40071352379	Eaton Magnet for lighting configuration and manual tests
	FT-BAT3	Battery Pack, LifePo 3,2 V / 3 Ah

Spacing data

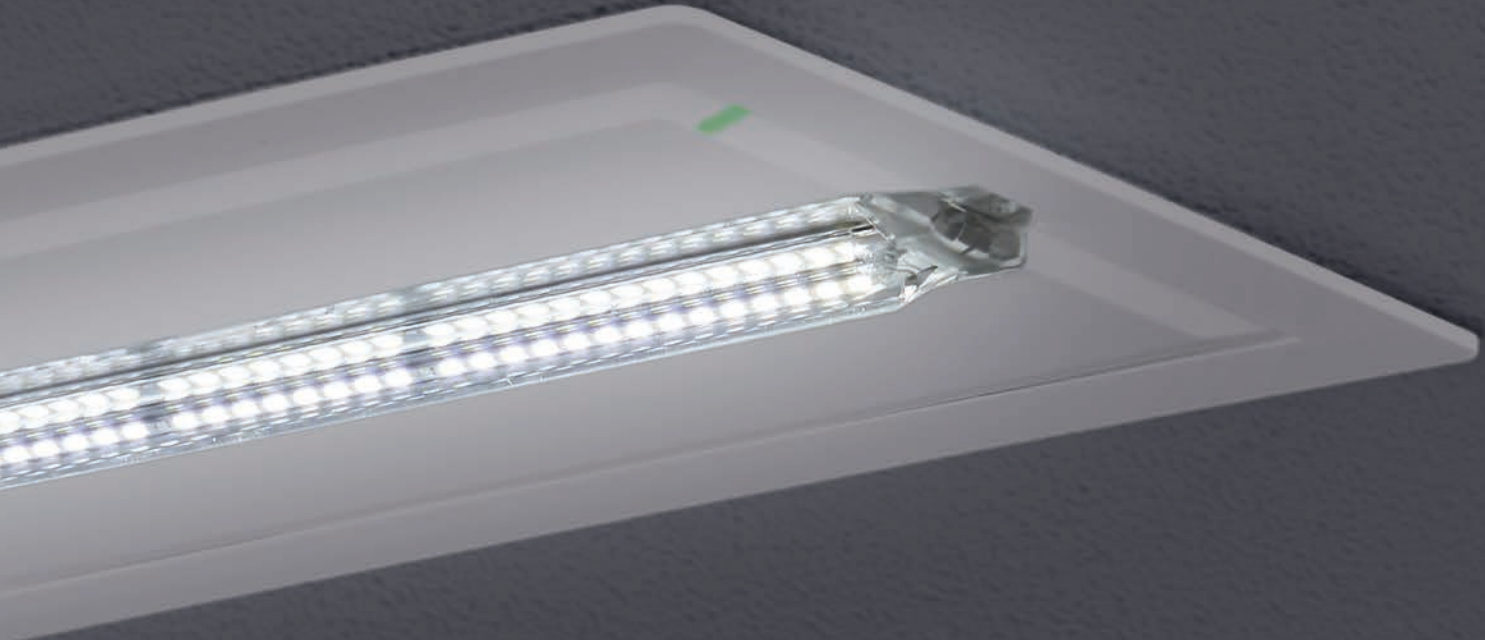

FlexiTech SE - Spacing data for flux value: 75 lm

400 lumens AT variant configured @8 hours

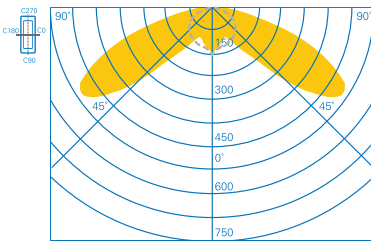

Light distribution curve

FlexiTech SE, asymmetric distribution : 1 lux (0.5 lux)

Ceiling mounting, measurement at floor level, battery operation ,distances in m

Escape route illumination

Mounting height [m]	Lux level directly under				
2,5		1,2 (2,2)	4,4 (6,1)	0,8 (4,7)	7,6 (11,7)
3,0		0,6 (2,0)	4,0 (6,2)	0,3 (5,0)	6,7 (12,6)

Open area illumination

Mounting height [m]	Lux level directly under				
2,5		0,5 (0,7)	4,4 (6,1)	1,1 (5,1)	10,3 (12,2)
3,0		0,5 (0,5)	4,7 (6,3)	0,7 (1,4)	7,8 (13,4)
3,5		0,7 (0,5)	4,9 (6,2)	0,5 (1,5)	7,3 (14,5)
4,0		0,5 (0,6)	5,1 (6,6)	0,5 (0,8)	6,7 (11,3)

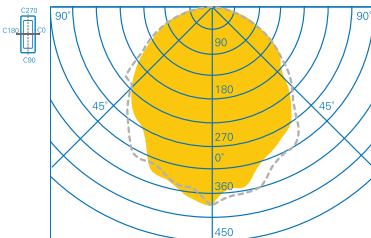

Light distribution curve

FlexiTech SE, with optional lens for open area, symmetric distribution : 1 lux (0.5 lux)

Ceiling mounting, measurement at floor level, battery operation ,distances in m

Escape route illumination

Mounting height [m]	Lux level directly under				
2,5	4	2,4 (3,2)	6,4 (8,1)	2,4 (3,2)	6,5 (8,2)
3,0	2,8	2,4 (3,3)	6,7 (8,6)	2,4 (3,3)	6,7 (8,7)
3,5	2	2,3 (3,4)	6,8 (9,0)	2,2 (3,4)	6,8 (9,1)
4,0	1,5	2,1 (3,5)	6,9 (9,4)	1,9 (3,4)	6,9 (9,4)

Open area illumination

Mounting height [m]	Lux level directly under				
2,5		2,1 (2,6)	5,7 (7,1)	2,1 (2,5)	5,6 (7,0)
3,0		2,1 (2,6)	6,2 (7,6)	1,9 (2,6)	5,9 (7,5)
3,5		1,9 (2,6)	6,3 (8,0)	2,0 (2,7)	6,3 (8,0)
4,0		1,8 (2,7)	6,6 (8,4)	1,8 (2,7)	6,5 (8,3)
4,5		1,5 (2,6)	6,7 (8,7)	1,6 (2,7)	6,7 (8,7)
5,0		1,2 (2,5)	6,9 (9,0)	1,3 (2,6)	6,7 (8,9)
5,5		0,8 (2,4)	7,1 (9,2)	0,7 (2,5)	6,5 (9,1)
6,0		0,5 (2,2)	6,9 (9,4)	0,7 (2,3)	6,3 (9,3)
6,5		0,8 (1,8)	7,1 (9,5)	0,5 (2,0)	5,4 (9,5)

FlexiTech SE - Spacing data for flux value: 200 lm

400 lumens variants configured @3 hours

600 lumens variants configured @3 hours

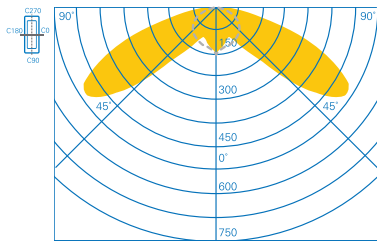

Light distribution curve

FlexiTech SE, asymmetric distribution : 1 lux (0.5 lux)

Ceiling mounting, measurement at floor level, battery operation, distances in m

Escape route illumination

Mounting height [m]	Lux level directly under				
2,5	4	2,6 (3,4)	6,8 (8,6)	5,2 (6,3)	12,6 (15,2)
3,0	2,5	2,5 (3,5)	7,1 (9,1)	5,5 (6,9)	13,7 (16,6)
3,5	1	2,3 (3,6)	7,2 (9,6)	5,8 (7,3)	14,6 (17,8)
4,0		2,0 (3,6)	7,2 (9,9)	1,4 (7,7)	12,9 (18,9)

Open area illumination

Mounting height [m]	Lux level directly under				
2,5		0,6 (0,8)	6,8 (8,6)	5,5 (6,5)	13,2 (15,7)
3,0		0,6 (0,7)	7,2 (9,2)	0,9 (7,1)	14,4 (17,2)
3,5		0,8 (0,8)	7,3 (9,7)	1,6 (1,2)	15,5 (18,5)
4,0		0,6 (0,7)	7,3 (10,0)	1,2 (8,0)	16,6 (19,8)
4,5		1,1 (0,6)	7,7 (10,2)	0,5 (2,2)	13,2 (21,0)
5,0		0,6 (0,6)	7,8 (10,4)	0,6 (1,1)	12,5 (22,1)
5,5		1,0 (0,5)	8,0 (10,3)	0,5 (1,8)	12,0 (23,2)
6,0		0,5 (0,5)	8,0 (10,5)	0,5 (1,2)	11,8 (20,4)
6,5		0,5 (0,5)	8,4 (10,9)	0,5 (0,5)	10,9 (18,4)
7,0		0,5 (0,7)	6,6 (11,0)	0,9 (0,6)	11,8 (17,7)
7,5		0,5 (0,7)	4,9 (11,1)	0,9 (0,5)	12,5 (17,3)

FlexiTech SE - Spacing data for flux value: 200 lm

400 lumens variants configured @3 hours

600 lumens variants configured @3 hours

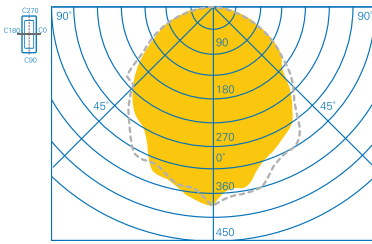

Light distribution curve

FlexiTech SE, with optional lens for open area, symmetric distribution : 1 lux (0.5 lux)

Ceiling mounting, measurement at floor level, battery operation, distances in m

Escape route illumination

Mounting height [m]	Lux level directly under				
2,5	10	3,5 (4,4)	8,8 (10,8)	3,6 (4,5)	9,0 (11,1)
3,0	7	3,7 (4,7)	9,4 (11,7)	3,8 (4,8)	9,6 (11,9)
3,5	5	3,9 (5,0)	9,9 (12,4)	3,9 (5,1)	10,1 (12,6)
4,0	4	3,9 (5,2)	10,4 (13,1)	3,9 (5,3)	10,5 (13,3)
4,5	3	4,0 (5,4)	10,8 (13,6)	4,0 (5,4)	10,8 (13,9)
5,0	2,5	4,0 (5,5)	11,0 (14,1)	3,9 (5,5)	11,0 (14,4)
5,5	2	3,9 (5,5)	11,1 (14,6)	3,7 (5,5)	11,1 (14,8)
6,0		3,7 (5,6)	11,2 (15,0)	3,4 (5,6)	11,2 (15,1)
6,5		3,5 (5,6)	11,3 (15,3)	3,2 (5,6)	11,2 (15,3)
7,0		3,2 (5,6)	11,2 (15,5)	2,8 (5,5)	11,1 (15,5)

Open area illumination

Mounting height [m]	Lux level directly under				
2,5		2,8 (3,4)	7,7 (9,3)	2,8 (3,4)	7,6 (9,3)
3,0		2,9 (3,6)	8,3 (10,1)	2,9 (3,6)	8,2 (10,1)
3,5		2,9 (3,7)	8,8 (10,8)	3,0 (3,7)	8,8 (10,8)
4,0		3,0 (3,9)	9,2 (11,4)	3,1 (3,9)	9,2 (11,4)
4,5		3,0 (4,0)	9,6 (12,0)	3,1 (4,0)	9,6 (11,9)
5,0		3,1 (4,0)	10,1 (12,5)	2,9 (4,1)	9,8 (12,4)
5,5		2,9 (4,0)	10,2 (12,9)	3,1 (4,2)	10,2 (12,9)
6,0		2,8 (4,0)	10,5 (13,3)	2,9 (4,2)	10,4 (13,3)
6,5		2,6 (4,1)	10,7 (13,7)	2,7 (4,1)	10,6 (13,6)
7,0		2,4 (4,0)	10,9 (14,0)	2,5 (4,1)	10,8 (14,0)
7,5		2,0 (3,9)	11,0 (14,3)	2,3 (4,1)	11,0 (14,3)
8,0		1,7 (3,9)	11,1 (14,6)	2,0 (4,0)	11,0 (14,5)
8,5		1,0 (3,6)	11,1 (14,8)	1,8 (3,9)	11,1 (14,8)
9,0		0,7 (3,5)	11,4 (15,0)	1,1 (3,8)	10,8 (15,0)

FlexiTech SE - Spacing data for flux value: 300 lm

600 lumens variants configured @2 hours

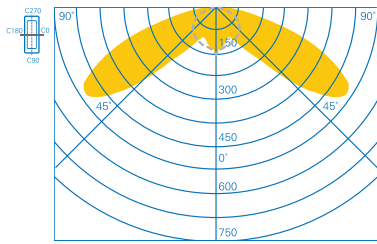

Light distribution curve

FlexiTech SE, asymmetric distribution : 1 lux (0.5 lux)

Ceiling mounting, measurement at floor level, battery operation, distances in m

Escape route illumination

Mounting height [m]	Lux level directly under				
2,5	5,5	3,0 (3,9)	7,8 (9,6)	5,8 (7,0)	14,1 (16,8)
3,0	4	3,1 (4,1)	8,3 (10,4)	6,3 (7,7)	15,3 (18,4)
3,5	3	3,1 (4,3)	8,6 (11,0)	6,7 (8,2)	16,4 (19,8)
4,0	2	2,9 (4,4)	8,8 (11,5)	7,0 (8,7)	17,4 (21,1)
4,5		2,7 (4,4)	8,9 (11,9)	7,1 (9,1)	18,2 (22,3)

Open area illumination

Mounting height [m]	Lux level directly under				
2,5		0,7 (1,2)	7,9 (9,7)	6,1 (7,1)	14,6 (17,3)
3,0		0,9 (1,0)	8,4 (10,5)	1,0 (7,7)	15,9 (19,0)
3,5		0,8 (0,7)	8,7 (11,1)	7,0 (8,4)	17,2 (20,6)
4,0		0,7 (0,6)	8,9 (11,6)	1,8 (8,9)	18,4 (22,0)
4,5		0,7 (0,6)	9,0 (12,0)	1,2 (9,3)	19,5 (23,3)
5,0		0,6 (0,7)	8,8 (12,3)	1,8 (9,8)	20,5 (24,5)
5,5		0,8 (0,6)	9,4 (12,5)	0,5 (2,6)	16,3 (25,7)
6,0		0,6 (0,6)	9,5 (12,7)	0,6 (1,3)	15,5 (26,8)
6,5		0,5 (0,6)	9,6 (12,7)	0,5 (1,5)	15,1 (27,9)
7,0		1,4 (0,5)	10,1 (12,5)	0,5 (2,1)	14,2 (29,0)
7,5		0,7 (0,9)	9,9 (13,1)	0,5 (0,8)	14,2 (23,9)

FlexiTech SE - Spacing data for flux value: 300 lm

600 lumens variants configured @2 hours

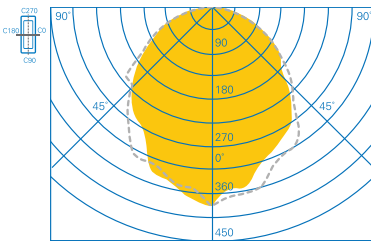

Light distribution curve

FlexiTech SE, with optional lens for open area, symmetric distribution : 1 lux (0.5 lux)

Ceiling mounting, measurement at floor level, battery operation ,distances in m

Escape route illumination

Mounting height [m]	Lux level directly under				
2,5	16	4,0 (5,0)	9,9 (12,0)	4,1 (5,1)	10,2 (12,4)
3,0	11	4,3 (5,4)	10,7 (13,1)	4,4 (5,5)	10,9 (13,5)
3,5	7,5	4,5 (5,7)	11,4 (14,0)	4,6 (5,8)	11,6 (14,3)
4,0	6	4,7 (6,0)	11,9 (14,8)	4,7 (6,1)	12,1 (15,1)
4,5	5	4,8 (6,2)	12,4 (15,5)	4,8 (6,3)	12,6 (15,8)
5,0	4	4,8 (6,4)	12,8 (16,1)	4,8 (6,5)	12,9 (16,4)
5,5	3	4,9 (6,6)	13,2 (16,7)	4,9 (6,6)	13,2 (17,0)
6,0		4,9 (6,7)	13,4 (17,2)	4,8 (6,7)	13,4 (17,5)
6,5		4,8 (6,8)	13,5 (17,6)	4,6 (6,8)	13,5 (17,9)
7,0		4,7 (6,8)	13,6 (18,1)	4,4 (6,8)	13,6 (18,2)
7,5		4,5 (6,9)	13,8 (18,4)	4,2 (6,9)	13,7 (18,5)
8,0		4,3 (6,9)	13,8 (18,7)	3,9 (6,9)	13,7 (18,7)

Open area illumination

Mounting height [m]	Lux level directly under				
2,5		3,1 (3,8)	8,6 (10,4)	3,1 (3,7)	8,6 (10,4)
3,0		3,3 (4,0)	9,3 (11,3)	3,3 (4,0)	9,3 (11,3)
3,5		3,4 (4,2)	10,0 (12,1)	3,4 (4,2)	9,9 (12,1)
4,0		3,4 (4,4)	10,5 (12,9)	3,5 (4,3)	10,5 (12,8)
4,5		3,5 (4,5)	11,0 (13,5)	3,6 (4,5)	10,9 (13,5)
5,0		3,5 (4,6)	11,4 (14,1)	3,7 (4,7)	11,4 (14,1)
5,5		3,6 (4,7)	11,8 (14,7)	3,6 (4,8)	11,7 (14,6)
6,0		3,5 (4,7)	12,1 (15,2)	3,7 (4,9)	12,1 (15,1)
6,5		3,5 (4,8)	12,4 (15,6)	3,6 (5,0)	12,4 (15,6)
7,0		3,4 (4,8)	12,7 (16,1)	3,5 (4,9)	12,6 (16,0)
7,5		3,2 (4,9)	12,9 (16,4)	3,4 (5,0)	12,9 (16,4)
8,0		3,0 (5,1)	13,1 (17,2)	3,3 (4,6)	13,1 (16,4)
8,5		2,9 (4,8)	13,3 (17,1)	3,0 (5,0)	13,2 (17,1)
9,0		2,5 (4,7)	13,4 (17,4)	2,8 (5,0)	13,4 (17,4)
9,5		2,4 (4,8)	13,9 (17,9)	2,2 (4,7)	13,2 (17,5)

FlexiTech SE - Spacing data for flux value: 400 lm

400 lumens variants configured @1 hours

600 lumens variants configured @1,5 hours

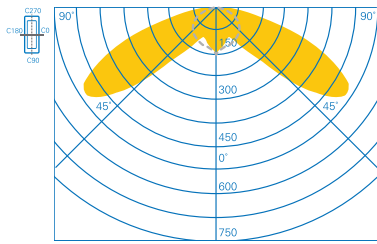

Light distribution curve

FlexiTech SE, asymmetric distribution : 1 lux (0,5 lux)

Ceiling mounting, measurement at floor level, battery operation, distances in m

Escape route illumination

Mounting height [m]	Lux level directly under				
2,5	8	3,4 (4,3)	8,6 (10,4)	6,3 (7,6)	15,2 (18,1)
3	5,8	3,5 (4,6)	9,1 (11,3)	6,9 (8,3)	16,6 (19,8)
3,5	4	3,6 (4,8)	9,6 (12,1)	7,3 (8,9)	17,8 (21,4)
4		3,6 (4,9)	9,9 (12,7)	7,7 (9,5)	18,9 (22,8)
4,5		3,4 (5,1)	10,1 (13,2)	8,0 (10,0)	19,9 (24,1)
5		3,2 (5,1)	10,2 (13,6)	8,1 (10,4)	20,8 (25,3)
5,5		2,9 (5,1)	10,2 (13,9)	2,1 (10,7)	19,7 (26,4)

Open area illumination

Mounting height [m]	Lux level directly under				
2,5		0,9 (0,9)	8,6 (10,5)	6,5 (7,6)	15,7 (18,7)
3,0		0,8 (1,2)	9,2 (11,4)	7,1 (8,3)	17,2 (20,4)
3,5		0,6 (0,9)	9,7 (12,2)	7,5 (8,9)	18,6 (22,1)
4,0		0,8 (0,6)	10,0 (12,8)	8,0 (9,5)	19,8 (23,7)
4,5		0,9 (0,6)	10,3 (13,3)	1,0 (10,1)	20,9 (25,1)
5,0		0,7 (0,7)	10,4 (13,7)	1,2 (10,5)	22,1 (26,4)
5,5		0,5 (0,5)	10,4 (14,1)	1,2 (1,4)	23,2 (27,7)
6,0		1,0 (0,5)	10,6 (14,3)	0,9 (11,5)	20,4 (28,9)
6,5		0,5 (0,7)	10,9 (14,5)	0,6 (2,6)	18,5 (30,0)
7,0		0,6 (0,7)	11,0 (14,7)	0,6 (1,3)	17,8 (31,1)
7,5		0,6 (0,6)	11,1 (14,7)	0,5 (1,6)	17,4 (32,2)
8,0		1,8 (0,5)	11,8 (14,5)	0,5 (2,2)	16,2 (33,3)
8,5		0,5 (0,6)	11,3 (15,0)	0,5 (0,9)	16,7 (28,6)

FlexiTech SE - Spacing data for flux value: 400 lm

400 lumens variants configured @1 hours

600 lumens variants configured @1,5 hours

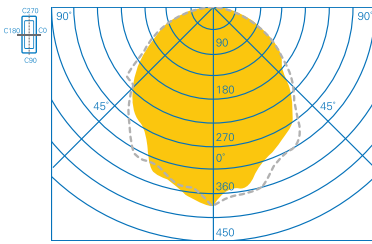

Light distribution curve

FlexiTech SE, with optional lens for open area, symmetric distribution : 1 lux (0.5 lux)

Ceiling mounting, measurement at floor level, battery operation ,distances in m

Escape route illumination

Mounting height [m]	Lux level directly under				
2,5	20	4,4 (5,4)	10,8 (13,0)	4,5 (5,5)	11,1 (13,5)
3,0	15	4,7 (5,8)	11,7 (14,1)	4,8 (6,0)	11,9 (14,6)
3,5	10	5,0 (6,2)	12,4 (15,2)	5,1 (6,3)	12,6 (15,6)
4,0	7,5	5,2 (6,5)	13,1 (16,1)	5,3 (6,6)	13,3 (16,5)
4,5	6	5,4 (6,8)	13,6 (16,9)	5,4 (6,9)	13,9 (17,3)
5,0	5	5,5 (7,1)	14,1 (17,7)	5,5 (7,2)	14,4 (18,0)
5,5	4	5,5 (7,3)	14,6 (18,3)	5,5 (7,4)	14,8 (18,6)
6,0	3,5	5,6 (7,5)	15,0 (18,9)	5,6 (7,5)	15,1 (19,2)
6,5	3	5,6 (7,6)	15,3 (19,4)	5,6 (7,6)	15,3 (19,8)
7,0	2,5	5,6 (7,7)	15,5 (19,9)	5,5 (7,7)	15,5 (20,3)
7,5	2,3	5,5 (7,8)	15,6 (20,4)	5,4 (7,8)	15,6 (20,7)
8,0	2	5,4 (7,9)	15,7 (20,8)	5,1 (7,9)	15,7 (21,0)
8,5	1,7	5,2 (7,9)	15,9 (21,2)	4,9 (7,9)	15,8 (21,3)
9,0	1,5	5,0 (8,0)	15,9 (21,5)	4,6 (7,9)	15,9 (21,5)

Open area illumination

Mounting height [m]	Lux level directly under				
2,5		3,4 (4,1)	9,3 (11,3)	3,4 (3,9)	9,3 (11,2)
3,0		3,6 (4,4)	10,1 (12,3)	3,6 (4,2)	10,1 (12,2)
3,5		3,8 (4,6)	10,8 (13,1)	3,7 (4,5)	10,8 (13,1)
4,0		3,9 (4,8)	11,4 (14,0)	3,9 (4,7)	11,4 (13,9)
4,5		3,9 (5,0)	12,0 (14,7)	4,0 (4,9)	12,0 (14,6)
5,0		3,9 (5,1)	12,5 (15,4)	4,1 (5,0)	12,5 (15,3)
5,5		4,0 (5,3)	13,0 (16,0)	4,1 (5,2)	12,9 (15,9)
6,0		4,1 (5,3)	13,4 (16,6)	4,1 (5,3)	13,3 (16,5)
6,5		4,0 (5,3)	13,7 (17,1)	4,2 (5,5)	13,7 (17,1)
7,0		4,6 (5,3)	14,8 (17,6)	3,5 (5,6)	13,3 (17,6)
7,5		3,9 (5,4)	14,3 (18,1)	4,1 (5,6)	14,3 (18,0)
8,0		4,0 (5,5)	14,8 (18,5)	3,8 (5,6)	14,4 (18,4)
8,5		3,7 (5,5)	14,8 (18,9)	4,0 (5,7)	14,8 (18,8)
9,0		3,5 (5,5)	15,0 (19,2)	3,8 (5,7)	15,0 (19,2)
9,5		3,3 (5,5)	15,2 (19,6)	3,6 (5,6)	15,2 (19,5)
10,0		3,1 (6,1)	15,5 (20,7)	3,3 (4,9)	15,3 (19,1)

FlexiTech SE - Spacing data for flux value: 600 lm

600 lumens variants configured @1 hour

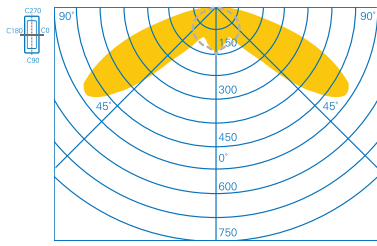

Light distribution curve

FlexiTech SE, asymmetric distribution : 1 lux (0.5 lux)

Ceiling mounting, measurement at floor level, battery operation, distances in m

Escape route illumination

Mounting height [m]	Lux level directly under				
2,5	11	3,9 (4,8)	9,6 (11,8)	7,0 (8,4)	16,8 (20,0)
3,0	8	4,1 (5,2)	10,4 (12,7)	7,7 (9,2)	18,4 (22,0)
3,5	6	4,3 (5,5)	11,0 (13,6)	8,2 (9,9)	19,8 (23,7)
4,0	4,5	4,4 (5,8)	11,5 (14,4)	8,7 (10,6)	21,1 (25,3)
4,5	3,5	4,4 (5,9)	11,9 (15,1)	9,1 (11,1)	22,3 (26,8)
5,0		4,4 (6,1)	12,2 (15,6)	9,5 (11,7)	23,4 (28,2)
5,5		4,2 (6,2)	12,4 (16,1)	9,8 (12,2)	24,4 (29,5)
6,0		4,0 (6,3)	12,5 (16,5)	10,0 (12,6)	25,2 (30,7)
6,5		3,7 (6,3)	12,5 (16,9)	2,9 (13,0)	26,0 (31,8)

Open area illumination

Mounting height [m]	Lux level directly under				
2,5		0,9 (1,3)	9,7 (11,9)	7,1 (8,3)	17,4 (20,6)
3,0		1,1 (1,3)	10,5 (12,8)	7,7 (9,1)	19,0 (22,6)
3,5		0,8 (1,3)	11,1 (13,7)	8,4 (9,8)	20,6 (24,4)
4,0		0,8 (1,3)	11,6 (14,5)	8,9 (10,4)	22,0 (26,1)
4,5		0,7 (0,8)	12,0 (15,2)	9,4 (11,1)	23,3 (27,8)
5,0		0,5 (0,8)	12,3 (15,8)	9,8 (11,7)	24,6 (29,3)
5,5		0,7 (0,7)	12,6 (16,3)	1,2 (12,2)	25,7 (30,7)
6,0		0,8 (0,5)	12,7 (16,7)	1,5 (12,7)	26,8 (32,1)
6,5		1,2 (0,7)	12,8 (17,1)	1,3 (1,8)	27,7 (33,3)
7,0		1,0 (0,8)	12,6 (17,4)	1,9 (1,8)	28,8 (34,5)

FlexiTech SE - Spacing data for flux value: 600 lm

600 lumens variants configured @1 hour

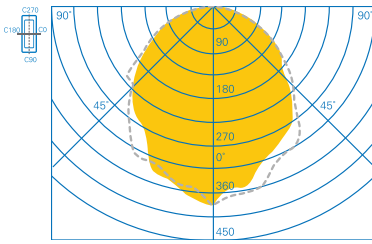

Light distribution curve

FlexiTech SE, with optional lens for open area, symmetric distribution : 1 lux (0.5 lux)

Ceiling mounting, measurement at floor level, battery operation ,distances in m

Escape route illumination

Mounting height [m]	Lux level directly under				
2,5	30	5,0 (6,0)	12,0 (14,5)	5,1 (6,2)	12,4 (15,1)
3,0	20	5,4 (6,5)	13,1 (15,8)	5,5 (6,7)	13,5 (16,4)
3,5	16	5,7 (7,0)	14,0 (17,0)	5,8 (7,2)	14,3 (17,5)
4,0	12,5	6,0 (7,4)	14,8 (18,0)	6,1 (7,6)	15,1 (18,6)
4,5	10	6,2 (7,8)	15,5 (19,0)	6,3 (7,9)	15,8 (19,5)
5,0	8	6,4 (8,1)	16,1 (19,9)	6,5 (8,2)	16,4 (20,4)
5,5	7	6,6 (8,3)	16,7 (20,7)	6,6 (8,5)	17,0 (21,1)
6,0	5,5	6,7 (8,6)	17,2 (21,4)	6,7 (8,8)	17,5 (21,8)
6,5	5	6,8 (8,8)	17,6 (22,1)	6,8 (9,0)	17,9 (22,5)
7,0	4	6,8 (9,0)	18,1 (22,7)	6,8 (9,1)	18,2 (23,1)
7,5	3,5	6,9 (9,2)	18,4 (23,3)	6,9 (9,3)	18,5 (23,7)
8,0	3,2	6,9 (9,4)	18,7 (23,8)	6,9 (9,4)	18,7 (24,3)
8,5	2,8	6,9 (9,5)	18,9 (24,3)	6,8 (9,5)	18,9 (24,8)
9,0	2,5	6,8 (9,5)	19,1 (24,8)	6,6 (9,5)	19,1 (25,2)
9,5		6,7 (9,6)	19,2 (25,2)	6,4 (9,6)	19,2 (25,5)
10,0		6,6 (9,7)	19,3 (25,6)	6,2 (9,6)	19,3 (25,9)

Open area illumination

Mounting height [m]	Lux level directly under				
2,5		3,8 (4,6)	10,4 (12,6)	3,7 (4,3)	10,4 (12,5)
3,0		4,0 (4,7)	11,3 (13,5)	4,0 (4,8)	11,3 (13,9)
3,5		4,2 (5,0)	12,1 (14,5)	4,2 (5,1)	12,1 (14,9)
4,0		4,4 (5,4)	12,9 (15,6)	4,3 (5,3)	12,8 (15,6)
4,5		4,6 (5,6)	13,5 (16,5)	4,5 (5,5)	13,5 (16,4)
5,0		4,7 (5,8)	14,1 (17,2)	4,7 (5,8)	14,1 (17,2)
5,5		4,7 (6,0)	14,7 (18,0)	4,8 (5,9)	14,6 (17,9)
6,0		4,7 (6,2)	15,2 (18,7)	4,9 (6,1)	15,2 (18,6)
6,5		4,8 (6,3)	15,7 (19,3)	4,9 (6,2)	15,6 (19,2)
7,0		4,9 (6,3)	16,1 (19,9)	5,0 (6,4)	16,0 (19,9)
7,5		4,9 (6,3)	16,5 (20,4)	5,0 (6,5)	16,4 (20,5)
8,0		4,8 (6,5)	16,8 (21,0)	5,0 (6,6)	16,8 (20,9)
8,5		5,1 (6,5)	17,5 (21,5)	4,7 (6,7)	16,8 (21,4)
9,0		4,9 (6,5)	17,7 (22,0)	4,7 (6,8)	17,2 (21,9)
9,5		4,7 (6,6)	17,7 (22,4)	4,9 (6,8)	17,7 (22,3)
10,0		4,6 (6,7)	18,0 (23,0)	4,8 (6,7)	17,9 (22,6)



Eaton is a power management company with 2017 sales of \$20.4 billion. We provide energy-efficient solutions that help our customers effectively manage electrical, hydraulic and mechanical power more efficiently, safely and sustainably. Eaton is dedicated to improving the quality of life and the environment through the use of power management technologies and services. Eaton has approximately 96,000 employees and sells products to customers in more than 175 countries.

For more information, visit **Eaton.com**.

Eaton
EMEA Headquarters
Route de la Longeraie 7
1110 Morges, Switzerland
Eaton.eu

© 2019 Eaton
All Rights Reserved
Printed in October 2019
Publication No. BR451035EN
October 2019

Changes to the products, to the information contained in this document, and to prices are reserved; so are errors and omissions. Only order confirmations and technical documentation by Eaton is binding. Photos and pictures also do not warrant a specific layout or functionality. Their use in whatever form is subject to prior approval by Eaton. The same applies to Trademarks (especially Eaton, Moeller, Cutler-Hammer and CEAG). The Terms and Conditions of Eaton apply, as referenced on Eaton Internet pages and Eaton order confirmations.

Eaton is a registered trademark.

All other trademarks are property of their respective owners.