

CGLine+ Web-Controller with integrated web server

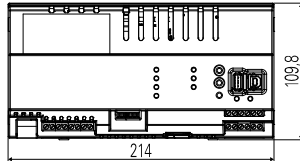

Dimensional drawings, data in mm

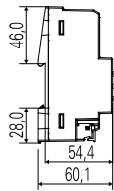

CGLine+ Web-Controller connection box



Dimensional drawings, data in mm

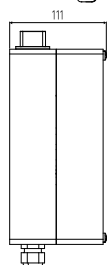
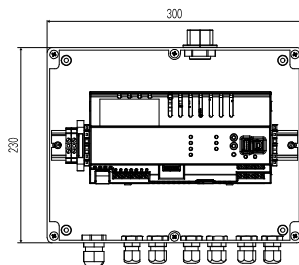

CGLine+ Web-Controller

- For connecting up to 800 luminaires in max. 4 lines
- The integrated web server enables there to be convenient visualisation, control and monitoring
- Unique ID per luminaires assigned by the manufacturer
- Automatic luminaire search function requiring no manual addressing
- Simple sorting using unrestricted short address assignment
- Unrestricted entry of target location names for the luminaires with up to 20 characters
- Clearly-shown allocation of luminaires to up to 8 zones per line
- Automatic function test and duration test
- Up to 8 test groups per luminaire can be defined for the function test (FT) and duration test (DT)
- Electronic log book storage for a period of minimum 4 years
- E-mail service for sending automatic e-mail in case of malfunctions to up to 10 e-mail addresses, assignable to 2 escalation groups
- Blocking the emergency lighting function during non-operational periods (all / per bus line/ per zone / per luminaire)
- Luminaires in maintained mode switchable (all / per bus line / per zone / per luminaire)
- Password protected access as an administrator or user
- Visualisation of luminaires in up to 30 different building layouts
- Efficient and convenient analysis of the log book using the CGLine+ PC software

10

Dimensions	214 x 109.8 x 60.1 mm
Housing type	For DIN rail 12 TE
Power supply	230 V AC, 50/60 Hz
Power consumption	< 4 W in standby, < 21 W at full load
Connection terminals	max. 2.5 mm ²
Permissible ambient temperature	0 °C ... 35 °C
Storage temperature	-20 °C ... 70 °C
Degree of protection	IP20

Ordering details

Type	Scope of supply	Order No.
CGLine+ Web-Controller	Module in installation housing for DIN rails	40071361055

Accessories

Type	Scope of supply	Order No.
CGLine+ PC software	on CD-ROM	40071361178
CGLine+ Web-Controller connection box	CGLine+ Web-Controller in wall-mounted housing	40071361184