

# XD70 HD IP series

## Explosion proof PTZ dome camera station



### Overview

Eaton's XD70 series are highly advanced process and surveillance camera stations that are certified to meet worldwide specifications for use in hazardous areas and harsh environmental conditions.

The customized dome is hard-coated for Electro-Magnetic Compatibility (EMC).

### Features

- Scratch resistant coating (EMC)
- EX certified for zone 1 (gas group IIB+H2)
- Full HD 1080p resolution
- H264 video compression
- Flexible powering(30VAC, 24VDC or PoE)
- Endless panoramic rotation
- Automatic image flip
- Scratch proof, tempered glass
- Auto focus with manual override on motorised zoom lenses
- Auto iris with manual override on motorised zoom lenses
- Built-in heating
- Designed to accept future software upgrades remotely



## Certifications

ATEX	PRESAFE 18 ATEX 12335X
IECEX	IECEX PRE 18.6627X
Ex Certification Code	Ex II 2 G, Ex d IIB+H2 T5 Gb

## Specifications

Weight	13.1kg
Dimensions	262 x 260mmØ (400mm including junction box)
Mounting	Ceiling (bolts:M10, not included)
Material & finish	Stainless steel AISI 316L, electro polished EX coated polycarbonate dome cupola

### Operating conditions camera

IP protection rate	IP66
Operating temperature range	-20°C to +45°C (heating element inside housing)

Humidity	Up to 100%
----------	------------

Vibration	3 - 100Hz (1mm or 0.7gr)
-----------	--------------------------

Enclosure	Salt mist tested
-----------	------------------

EMI/EMC	All locations including open deck
---------	-----------------------------------

### Camera

Image sensor	1/2.8" Progressive Scan CMOS
--------------	------------------------------

Sync system	Internal
-------------	----------

Frame rate	50 Hz: 25 fps (1920 x 1080), 25 fps (1280 x 720) 60 Hz: 30 fps (1920 x 1080), 30 fps (1280 x 720)
------------	--

Min. illumination	Color: 0.05Lux @(F1.6, AGC ON) B/W: 0.01Lux @(F1.6, AGC ON)
-------------------	--

S/N ratio / WDR	>50 dB / WDR
-----------------	--------------

### Lens

Focal length	4.7-94mm, 20 x optical
--------------	------------------------

Aperture range	F1.6-F3.5
----------------	-----------

Angle of view	61.4-2.9° (wide - tele)
---------------	-------------------------

Min. working distance	10mm-1500mm (wide - tele)
-----------------------	---------------------------

Zoom speed	Approx. 2.7s (optical, wide - tele)
------------	-------------------------------------

Day & night	IR cut filter auto switch
-------------	---------------------------

### Attributes

Power supply	30VAC (+10% -30%, 50/60Hz) / 24VDC (+/-10%) / PoE (IEEE802.3at) Dome can be powered with 30VAC or 24VDC For PoE operation a different DIP switch setting is necessary The power setting of each XD70 is configured according to the project requirements
--------------	---

Power consumption / heat dissipation	12W (20W max. when heater is on)
--------------------------------------	----------------------------------

Rotating angle / variable speed	Pan: continuous 360°/speed 1.8°/sec. - 110°/sec Tilt: 180°/ speed 1.8°/sec. - 110°/sec
---------------------------------	---

Preset / home position	100 preset + 1 home positions, accuracy ≤ 0.1°
------------------------	--

### Specifications

Protocol	IPv4/IPv6, TCP/IP, HTTP, DHCP, DNS, DDNS, RTP, RTSP, PPPoE, SMTP, NTP, UPnP, SNMP, FTP, 802.1x, QoS, HTTPS, IPv6 (SIP, SRTP optional)
----------	---

Compression	Main stream: H.264 Sub stream: H.264, MJPEG
-------------	--

H.264 compression profile	Main profile, High profile
---------------------------	----------------------------

Dual-streaming	Supported
----------------	-----------

Video bit rate	256 Kbps - 13 Mbps
----------------	--------------------

Ethernet port	1 RJ45 10M/100M Ethernet interface
---------------	------------------------------------

Electrical data	CAT6 Cable AWG23
-----------------	------------------

## General arrangement drawing (all dimensions in mm)

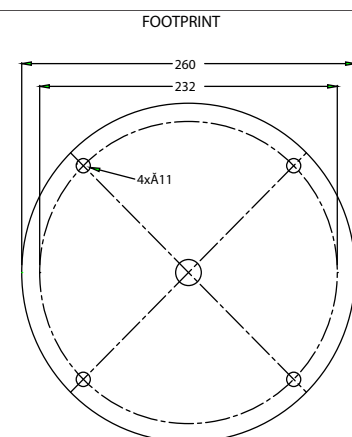
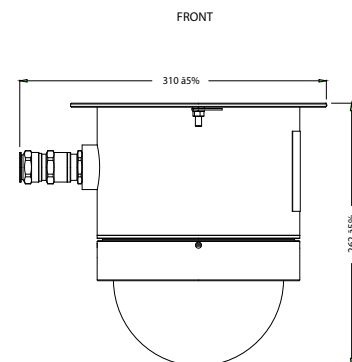

# Ordering requirements

The following code is designed to help in selection of the correct unit. Build up the reference number by inserting the code for each component into the appropriate box

XD70													
------	--	--	--	--	--	--	--	--	--	--	--	--	--

**Housing type**  
Visual camera housing  
**Code**  
V

**Wiper options**  
No wiper  
**Code**  
N

**Video type**  
HD IP system  
**Code**  
I

**Day/night module**  
20x zoom 1080p network camera  
**Code**  
H

**Thermal core module**  
No thermal core  
**Code**  
N

**Thermal core lens**  
No thermal imaging lens  
**Code**  
N

**Video system**  
IP  
**Code**  
I

**Supply voltage**  
24 VAC/DC  
POE  
**Code**  
1  
2

**Camera rotation**  
Continuous rotation  
**Code**  
1

**Protocol requirements**  
Pelco D protocol, baud rate 2400bps  
**Code**  
D

**Certification**  
ATEX/IECEX combined  
**Code**  
Q

**Temperature type**  
T5, -20°C to +70°C  
**Code**  
2

**Transmission type**  
Standard electrical IP no cable tail  
Standard electrical IP POE 10M cable Tail  
Standard electrical IP 24VAC/DC 3M cable Tail  
**Code**  
0  
7  
8