

Pole Line Hardware

Contents

FASTENERS	2
Carriage bolts	2
Double-arming bolts	3
Machine bolts	4
Ovaleye bolts	7
Regular square nuts	9
Heavy square nuts	9
Washernuts	9
MF locknuts	10
Round washers	10
Square washers	11
Square curved washers	11
Static-proof spring	12
Fetter-drive	12
Twist drive	13
Gimlet point	13
GUY ACCESSORIES	14
Adjustable pole bands	14
Guy hooks	15
Pole eye plate	16
Guy grip/pole eye combo	17
Eyenuts	18
Bolt eyes (eyelets)	19
Suspension/messenger clamp	20
INSULATOR CLEVISES	21
Secondary/deadend	21
Single upset insulator bolts	22
Swinging	23
Anchor shackle	24
Clevis thimble with side pulling eye	25
INSULATOR PINS AND ACCESSORIES	26
Pole-top insulator bracket	26
Line-post insulator studs	27
Crossarm clamp	28
Crossarm pins	29
Insulator adapter pin	30



Powering Business Worldwide

Effective June 2017

Fasteners

Carriage bolts

For attaching hardware to crossarms.

Standard carriage-bolt head with square shoulders.

Rolled threads assure uniformity and strength.

All carriage bolts include a regular square nut.

Hot-dipped galvanized for corrosion resistance.

IEEE Std C135.80™-2012 standard

RUS Section I

3/8" Diameter

DF1C Series

Ultimate Tensile Strength: 4,250 lbs.

Catalog Number	Dimensions (in.)		Std. Pkg (pcs.)	Weight 100/pcs. (lbs.)
	A Length (in.)	B Minimum Thread Length (in.)		
DF1C450	4-1/2	3	250	16
DF1C5	5	3	250	18

Note: 3/8" bolts have 16 threads per inch.

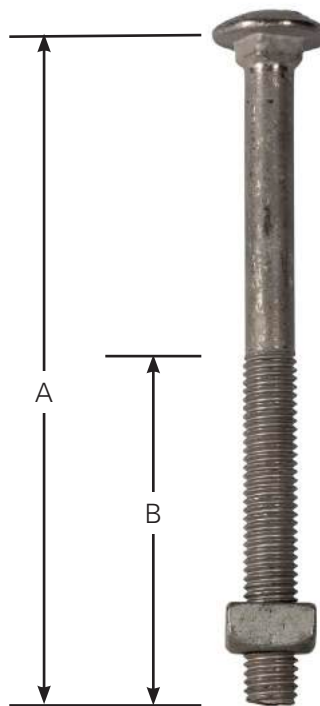

DF_C Series

1/2" Diameter

DF2C Series

Ultimate Tensile Strength: 7,800 lbs.

Catalog Number	Dimensions (in.)		Std. Pkg (pcs.)	Weight 100/pcs. (lbs.)
	A Length (in.)	B Minimum Thread Length (in.)		
DF2C6	6	3	100	39

Note: 1/2" bolts have 13 threads per inch.

Double-arming bolts

Manufactured using cold drawn steel in accordance with IEEE Std C135.80™-2012 standard and RUS Section N.

All double-arming bolts are hot-dipped galvanized in accordance with ASTM A153 for corrosion resistance.

Tensile strength and cold bend tests are performed per ANSI® specifications to ensure strength and ductility.

Machine rolled threads guarantee uniformity and strength.

Cone type points at both ends allow for easy starting and driving out without damage to the threads.

Each double-arming bolt is furnished with four square nuts unless otherwise noted.

5/8" Diameter with 4 square nuts

DF2D Series

Ultimate Tensile Strength: 12,400 lbs.

Catalog Number	Bolt Length (in.)	Std. Pkg (pcs.)	Weight 100/pcs. (lbs.)
DF2D12	12	25	132
DF2D14	14	25	144
DF2D16	16	25	164
DF2D18	18	25	180
DF2D20	20	25	192
DF2D22	22	25	212
DF2D24	24	25	224

Note: Length dimensions do not include cone points.
5/8" bolts have 11 threads per inch.

3/4" Diameter with 4 square nuts

DF3D Series

Ultimate Tensile Strength: 18,350 lbs.

Catalog Number	Bolt Length (in.)	Std. Pkg (pcs.)	Weight 100/pcs. (lbs.)
DF3D12	12	25	204
DF3D14	14	25	216
DF3D16	16	25	244
DF3D18	18	20	260
DF3D20	20	15	280
DF3D22	22	15	304
DF3D24	24	12	325

Note: Length dimensions do not include cone points.
3/4" bolts have 10 threads per inch.



DF_D Series

Effective June 2017

Machine bolts

Manufactured using cold drawn steel in accordance with IEEE Std C135.80™-2012 standard, RUS Section C.

All machine bolts are hot-dipped galvanized in accordance with ASTM A153 for corrosion resistance.

Tensile strength and cold bend tests are performed per ANSI® specifications to ensure strength and ductility.

Machine rolled threads guarantee uniformity and strength. Industry preferred square heads and nuts fit standard wrenches.

Each bolt includes an assembled square nut.

1/2" Diameter

DF2B Series

Ultimate Tensile Strength: 7,800 lbs.

Catalog Number	Dimensions (in.)		Std. Pkg (pcs.)	Weight 100/pcs. (lbs.)
	A Length	B Min. Thread Length		
DF2B6	6	3	100	42
DF2B7	7	3	100	45
DF2B8	8	4	100	49
DF2B10	10	6	50	58
DF2B12	12	6	50	68
DF2B14	14	6	50	78

Note: Bolts 8" or longer have cone points for easier nut starting.
 Bolts shorter than 8" have blunt ends.
 1/2" bolts have 13 threads per inch.

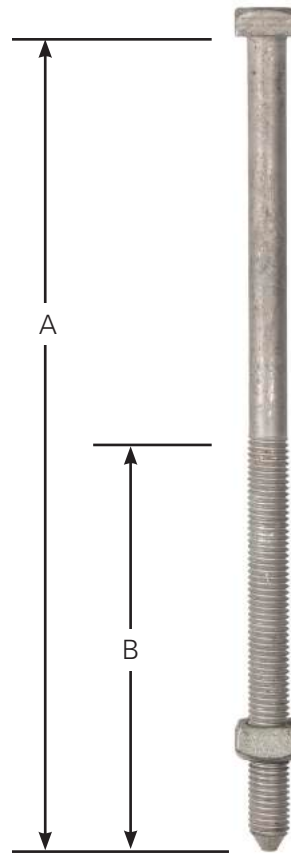

DF_B Series

Machine bolts

(continued)

5/8" Diameter

DF3B Series

Ultimate Tensile Strength: 12,400 lbs.

Catalog Number	Dimensions (in.)		Std. Pkg (pcs.)	Weight 100/pcs. (lbs.)
	A Length	B Min. Thread Length		
DF3B6	6	3	50	64
DF3B7	7	4	50	74
DF3B8	8	4	50	82
DF3B9	9	4	50	88
DF3B10	10	6	50	96
DF3B12	12	6	50	110
DF3B14	14	6	25	124
DF3B16	16	6	25	140
DF3B18	18	6	25	154
DF3B20	20	6	25	168
DF3B22	22	6	25	180
DF3B24	24	6	25	196

Note: Bolts 8" or longer have cone points for easier nut starting.
 Bolts shorter than 8" have blunt ends.
 5/8" bolts have 11 threads per inch.

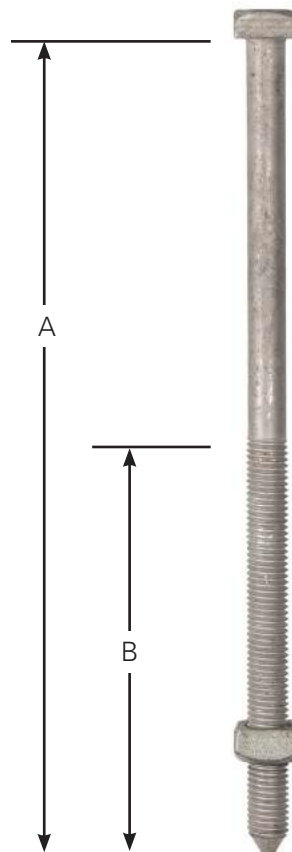

DF_B Series

3/4" Diameter

DF4B Series

Ultimate Tensile Strength: 18,350 lbs.

Catalog Number	Dimensions (in.)		Std. Pkg (pcs.)	Weight 100/pcs. (lbs.)
	A Length	B Min. Thread Length		
DF4B6	6	3	50	101
DF4B7	7	4	50	112
DF4B8	8	4	25	124
DF4B9	9	4	25	135
DF4B10	10	6	25	146
DF4B12	12	6	25	168
DF4B14	14	6	25	192
DF4B16	16	6	25	210
DF4B18	18	6	25	230
DF4B20	20	6	20	252
DF4B22	22	6	20	280
DF4B24	24	6	15	296

Note: Bolts 8" or longer have cone points for easier nut starting.
 Bolts shorter than 8" have blunt ends.
 3/4" bolts have 10 threads per inch."

Effective June 2017

Machine bolts

(continued)

7/8" Diameter

DF5B Series

Ultimate Tensile Strength: 25,400 lbs.

Dimensions (in.)

Catalog Number	A Length	B Min. Thread Length	Std. Pkg (pcs.)	Weight 100/pcs. (lbs.)
DF5B12	12	6	25	240
DF5B14	14	6	20	264
DF5B16	16	6	10	296
DF5B18	18	6	10	320
DF5B20	20	6	10	380
DF5B22	22	6	10	390
DF5B24	24	6	10	426

Note: Bolts 8" or longer have cone points for easier nut starting.
 Bolts short than 8" have blunt ends.
 7/8" bolts have 9 threads per inch.

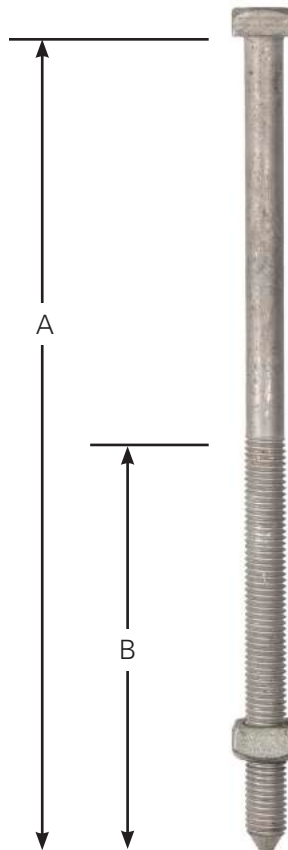

DF_B Series

Ovaleye bolts

DF2E Series

For deadending wires and guy strands on cross-arms, poles, or buildings.

Used with flat washers on crossarms and arms; used with curved flat washers on poles.

Order washers separately (see page 11).

Rolled threads assure uniformity and strength.

Cone points ease nut starting.

Eye dimensions on all ovaleye bolts are 1-1/2 x 2".

Hot-dipped galvanized for corrosion resistance.

IEEE Std C135.80™-2012 standard

RUS Section O

5/8" Diameter

DF2E Series*

Ultimate Tensile Strength: 13,500 lbs.**

Catalog Number	A Bolt Length** (in.)	B Thread Length (in.)	Std. Pkg (pcs.)	Weight 100/pcs. (lbs.)
DF2E8	8	4-1/2	25	128
DF2E10	10	4-1/2	25	146
DF2E12	12	6	25	156
DF2E14	14	6	25	168

* One regular square nut included.

** Measured from directly under eye to last thread at bolt end.

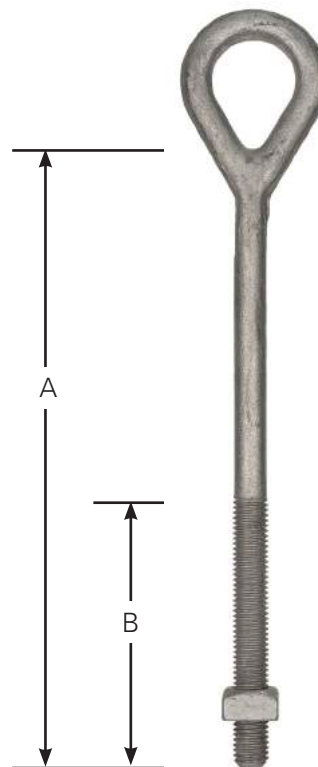

DF2E Series

Effective June 2017

Ovaleye bolts

(continued)

DF2F Series

For deadending wires and guy strands on cross-arms, poles, or buildings.

Used with flat washers on crossarms and arms; used with curved flat washers on poles.

Order washers separately (see page 11).

Rolled threads assure uniformity and strength.

Cone points ease nut starting.

Eye dimensions on all ovaleye bolts are 1-1/2 x 2".

Hot-dipped galvanized for corrosion resistance.

IEEE Std C135.80™-2012 standard

RUS Section O

3/4" Diameter

DF2F Series*

Tensile Strength: 20,050 lbs.**

Catalog Number	A Bolt Length** (in.)	B Thread Length (in.)	Std. Pkg (pcs.)	Weight 100/pcs. (lbs.)
DF2F14	14	6	20	240

* One regular square nut included.

** Measured from directly under eye to last thread at bolt end.

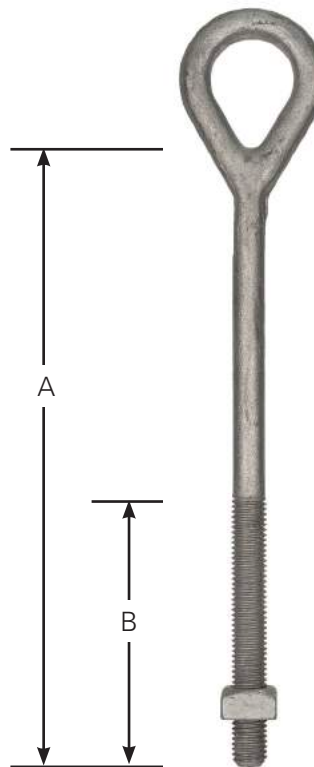

DF2F Series

Regular square nuts

DF1N Series

For use with all galvanized hardware items, except anchor rods.

Hot-dipped galvanized steel for corrosion resistance."

IEEE Std C135.80™-2012 standard

Catalog Number	Accommodates Bolt Dia. (in.)	Ultimate Tensile Strength (lbs.)	Std. Pkg (pcs.)	Weight 100/ pcs. (lbs.)
DF1N2	1/2	7,800	1000	6
DF1N4	5/8	12,400	500	10
DF1N6	3/4	18,350	250	15



DF1N Series

Heavy square nuts

DF2N Series

Oversized threads allow for use with anchor rods only.

Hot-dipped galvanized for corrosion resistance.

Catalog Number	Accommodates Anchor Rod Dia. (in.)	Ultimate Tensile Strength (lbs.)	Std. Pkg (pcs.)	Weight 100/ pcs. (lbs.)
DF2N4	5/8	12,400	250	13
DF2N6	3/4	18,350	250	24
DF2N9	1	53,300	100	52



DF2N Series

Washernuts

DF14S Series

Large contact area.

Nut and washer are an integral unit, eliminating the need for separate components.

Hot-dipped galvanized for corrosion resistance.

IEEE Std C135.80™-2012 standard

Catalog Number	Dimensions (in.)		Ultimate Tensile Strength (lbs.)	Std. Pkg (pcs.)	Weight 100/ pcs. (lbs.)
	Washer Dia.	Accommodates Bolt Dia.			
DF14S1	2	1/2	7,800	100	17
DF14S2	2-1/2	5/8	12,400	100	28
DF14S3	2-3/4	3/4	18,350	100	39



DF14S Series

Effective June 2017

MF locknuts

DF3N Series

For permanently locking regular nuts.

Hot-dipped galvanized for corrosion resistance.

RUS Section EK



Catalog Number	Accommodates Bolt Dia. (in.)	Std. Pkg (pcs.)	Weight 100/pcs. (lbs.)
DF3N4	5/8	800	4
DF3N6	3/4	550	5

DF3N Series

Round washers

DF1W Series

Used with bolts on poles and crossarms.

Hot-dipped galvanized for corrosion resistance.

IEEE Std C135.80™-2012 standard

RUS Section D



Catalog Number	Dimensions (in.)		Std. Pkg (pcs.)	Weight 100/pcs. (lbs.)
	Outer Diameter	Accommodates Bolt Dia.		
DF1W1	1	3/8	2500	2
DF1W2	1-3/8	1/2	1000	4
DF1W3	1-3/4	5/8	500	9
DF1W4	2	3/4	500	10

DF1W Series

Square washers

DF2W Series

Hot-dipped galvanized for corrosion resistance.

IEEE Std C135.80™-2012 standard

RUS Section D

Catalog Number	Dimensions (in.)		Std. Pkg (pcs.)	Weight 100/pcs. (lbs.)
	Square Size	Accommodates Bolt Dia.		
DF2W1	2 x 2 x 1/8	1/2	300	11
DF2W2	2 x 2 x 1/8	5/8	250	13
DF2W4	2-1/4 x 2-1/4 x 3/16	5/8	100	22
DF2W5	2-1/4 x 2-1/4 x 3/16	3/4	100	22
DF2W7	3 x 3 x 1/4	3/4	50	68



DF2W Series

Square curved washers

DF4W Series

Used on poles to distribute the strain evenly over the pole surface.

Hot-dipped galvanized for corrosion resistance.

IEEE Std C135.80™-2012 standard

Catalog Number	Dimensions (in.)		Std. Pkg (pcs.)	Weight 100/pcs. (lbs.)
	Washer Size	Accommodates Bolt Dia.		
DF4W1	2-1/4 x 2-1/4 x 3/16	5/8	200	22
DF4W2	2-1/2 x 2-1/2 x 3/16	5/8	150	31
DF4W4	3 x 3 x 1/4	5/8	50	61
DF4W5	3 x 3 x 1/4	3/4	50	64
DF4W9	3-1/4 x 3-1/4 x 1/4	3/4	50	72
DF4W17	4 x 4 x 1/4	7/8	50	110



DF4W Series

Effective June 2017

Static-proof spring

DF17W Series

Eliminates interference caused by loose hardware.

Hot-dipped galvanized for corrosion resistance.

IEEE Std C135.80™-2012 standard

RUS Section AW

Catalog Number	Dimensions (in.)		"Accommodates Bolt Dia. (in.)"	Std. Pkg (pcs.)	Weight 100/pcs. (lbs.)
	A	B			
DF17W2	1	2-1/2	1/2	250	29
DF17W3	1-3/4	3-3/4	5/8	50	100
DF17W4	1-3/4	3-3/4	3/4	50	102
DF17W5	1-3/4	3-3/4	7/8	50	96

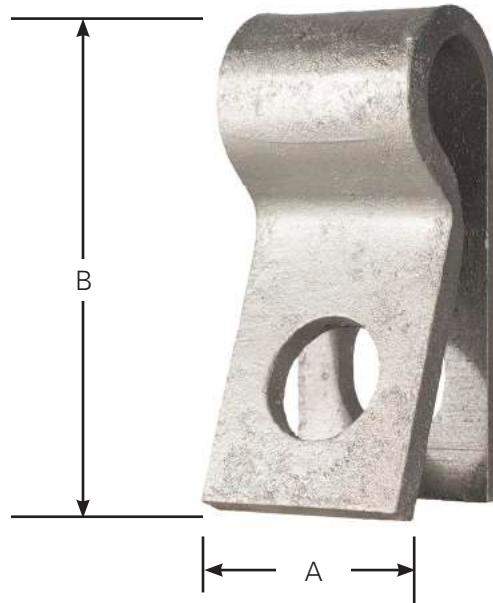

DF17W Series

Fetter-drive

DF9L Series

High-strength forged steel.

Sharp or pilot points for easy starting and driving.

Standard square heads.

Rolled threads assure uniformity and strength.

Can be hand-driven part way for fast installation; should be wrenched to final tightened position for maximum holding strength.

Hot-dipped galvanized for corrosion resistance.

3/8" Diameter; Drive Point

DF6L Series

Catalog Number	Dimensions (in.)		Ultimate Tensile Strength (lbs.)	Std. Pkg (pcs.)	Weight 100/pcs. (lbs.)
	A Screw Length	B Thread Length			
DF6L250	2-1/2	1-3/4	3,500	500	9
DF6L3	3	2	3,500	500	10

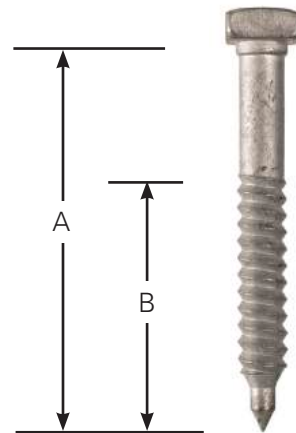

DF_L Series

1/2" Diameter; Pilot Point

DF9L Series

Catalog Number	Dimensions (in.)		Ultimate Tensile Strength (lbs.)	Std. Pkg (pcs.)	Weight 100/pcs. (lbs.)
	A Screw Length"	B Thread Length"			
DF9L4	4	2-1/2	6,500	250	12

Twist drive

DF12L Series

High strength forged steel.

Standard square heads.

Twist drive lag screws are furnished with a pilot point for easy starting and driving.

Can be hand-driven part way for fast installation; should be wrenched to final tightened position for maximum holding strength.

Hot-dipped galvanized for corrosion resistance.

IEEE Std C135.80™-2012 standard

RUS Section J

1/2" Diameter; Pilot Point

DF12L Series

Catalog Number	Dimensions (in.)		Ultimate Tensile Strength (lbs.)	Std. Pkg (pcs.)	Weight 100/pcs. (lbs.)
	A Screw Length	B Thread Length			
DF12L4	4	2-1/2	6,500	250	22

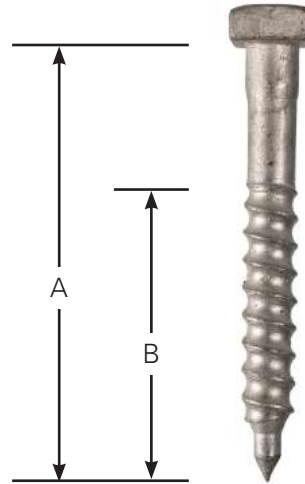

DF12L Series

Gimlet point

DF1L Series

Easy starting; threads are clean and free from rough edges.

Standard square heads.

For maximum holding power, should be installed with a wrench.

Hot-dipped galvanized for corrosion resistance.

IEEE Std C135.80™-2012 standard

1/4" Diameter

DF1L Series

Catalog Number	Dimensions (in.)		Ultimate Tensile Strength (lbs.)	Std. Pkg (pcs.)	Weight 100/pcs. (lbs.)
	A Screw Length	B Thread Length			
DF1L2	2	1-1/2	1,500	2000	3
DF1L250	2-1/2	1-3/4	1,500	1000	4
DF1L3	3	2	1,500	1000	4

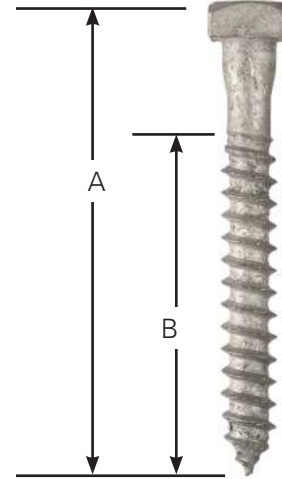

DF1L Series

Guy accessories

Adjustable pole bands

DG40B Series

Provides attachment points for guys and suspension insulators.

Four-piece design permits fast installation.

Includes (4) 3/4" x 6-5/8" double arming bolts and (16) 3/4" square nuts.

Rated at 20,000 lbs. ultimate tensile strength.

Hot-dipped galvanized for corrosion resistance.

RUS Section V



DG40B

Catalog Number	Pole Diameter Range (in.)	Std. Pkg (pcs.)	Weight 100/pcs. (lbs.)
DG40B1	7 to 9-1/2	3	1,320
DG40B2	8 to 11	3	1,500

Guy hooks

Aluminum attachments

Aluminum hook design permits attaching guy loop after hook has been mounted to the pole, simplifying installation.

A 5/8" machine bolt and 1/2" lag screw are required for mounting to the pole.

Machine bolts (pages 4-6) and lag screws (pages 12-13) sold separately.

IEEE Std C135.17™-1979 standard

RUS Section V

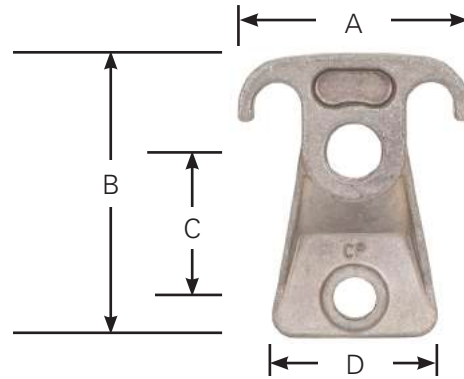

DG21A Series

Catalog Number	Mounting Hole Diameters (in.)		Dimensions (in.)				Tensile Strength (lbs.)	Std. Pkg	Weight 100/pcs. (lbs.)
	Upper	Lower	A	B	C	D			
DG21A1	3/4	5/8	3-3/8	4-1/4	2-1/4	2-7/16	12,400	100	38

Malleable iron attachments

Cast iron hook design permits attaching guy loop after hook has been mounted to the pole, simplifying installation.

A 5/8" or 3/4" machine bolt is required for mounting to the pole. In addition, the 2-hole design requires a 1/2" lag screw for bottom hole.

Spur design prevents down-slotting.

Machine bolts (pages 4-6) and lag screws (pages 12-13) sold separately.

RUS Section V

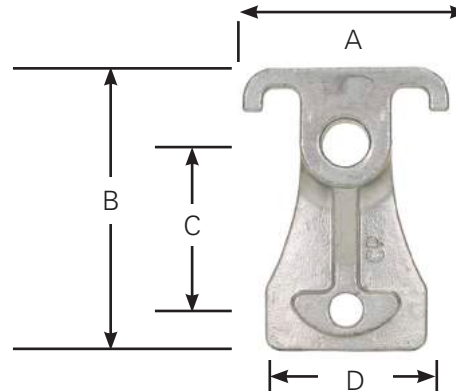

DG21H Series

Catalog Number	Mounting Hole Diameters (in.)		Dimensions (in.)				Tensile Strength (lbs.)	Std. Pkg (pcs.)	Weight 100/pcs. (lbs.)
	Upper	Lower	A	B	C	D			
DG21H2	11/16	9/16	3-3/8	4-3/4	2-13/16	2-3/4	13550	25	88
DG21H3	13/16	9/16	3-3/8	4-3/4	2-13/16	2-3/4	20050	25	149

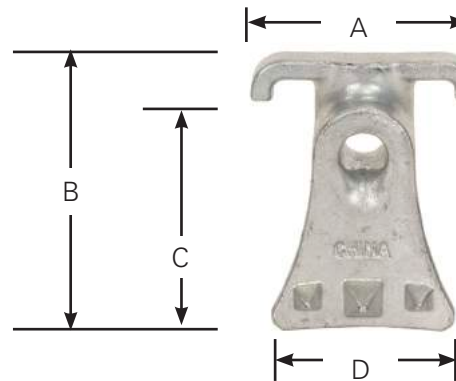

DG22H Series

Catalog Number	Mounting Hole Diameters (in.)		Dimensions (in.)				Tensile Strength (lbs.)	Std. Pkg (pcs.)	Weight 100/pcs. (lbs.)
	Upper	Lower	A	B	C	D			
DG22H2	11/16	Spur	3-3/8	4	3-1/2	2-3/4	13550	25	88
DG22H3	13/16	Spur	3-3/8	4	3-1/2	2-3/4	20050	25	149

Pole eye plate

DG30P Series

Used for guying or deadending.

Ductile iron, hot-dipped galvanized for corrosion resistance.

RUS Section V

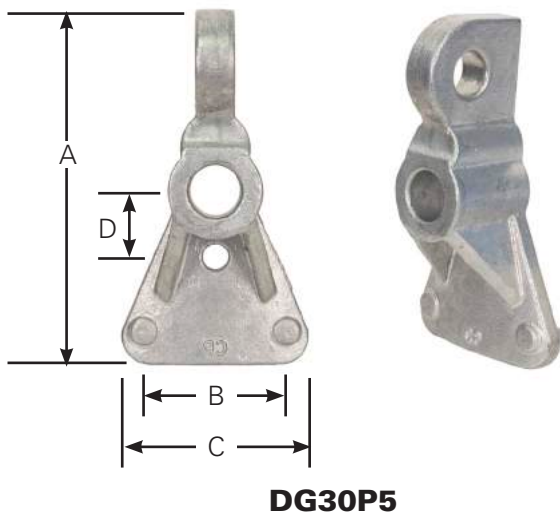
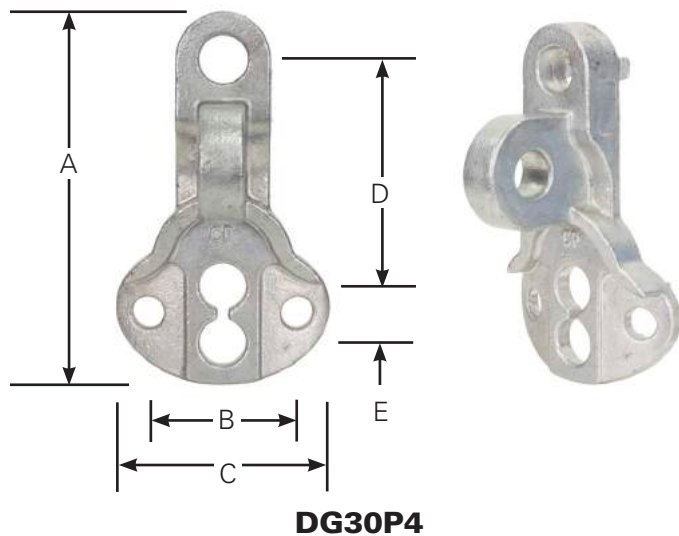

Catalog Number	Upper Mounting Hole Dia. (in.)	Clevis Pin Hole Dia. (in.)	Dimensions (in.)					Ultimate Strength (lbs.)	Std. Pkg (pcs.)	Weight 100/pcs. (lbs.)
			A	B	C	D	E			
DG30P4	13/16	13/16	6-9/16	2-5/8	3-13/16	4	1	21,000	25	220
DG30P5	15/16	13/16	6-1/2	2-11/16	3-1/2	1-1/4	N/A	21,000	20	265

Guy grip/pole eye combo

DG30G Series

Multi-functional design providing the benefits of both a guy hook and a pole eye plate.

The hook design permits attaching guy loop after hook has been mounted to the pole, simplifying installation.

Ductile iron, hot-dipped galvanized for corrosion resistance

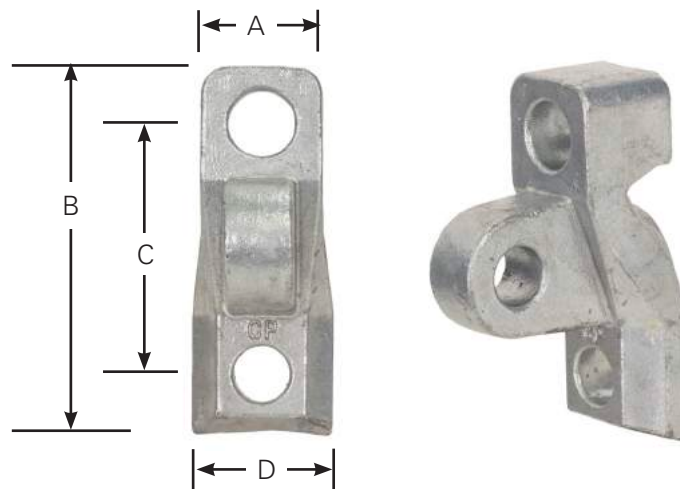

DG30G2

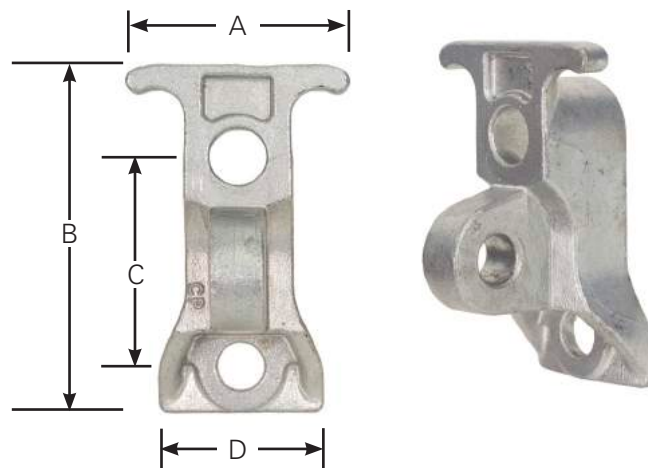

DG30G4

Catalog Number	Mounting Hole Diameters (in.)		Clevis Pin Hole Dia. (in.)	Dimensions (in.)				Ultimate Strength (lbs.)	Std. Pkg.	Weight 100/ pcs. (lbs.)
	Upper	Lower		A	B	C	D			
DG30G2	13/16	11/16	11/16	1-1/2	4-1/2	3	1-3/4	15,000	25	140
DG30G4	3/4	11/16	11/16	3-1/4	5	3	2-7/16	21,000	20	145

Effective June 2017

EyenuTs

For attaching guy strands and deadends to poles.

Used with double-arming bolts to connect suspension insulators to crossarms.

Tapped for use with industry standard bolts; strength rating of eyenut is equal to that of bolt.

Order bolts separately (see pages 1-6).

Forged steel, hot-dipped galvanized for corrosion resistance.

IEEE Std C135.80™-2012 standard

RUS Section AB



DG1E Series

Single-strand

DG1E Series

Maximum strand diameter is 1/2".

Catalog Number	Accommodates Bolt Dia. (in.)	Tensile Strength (lbs)	Std. Pkg (pcs.)	Weight 100/pcs. (lbs.)
DG1E1	5/8	12,400	50	100

Oval

DG2E Series

Catalog Number	Accommodates Bolt Dia. (in.)	Tensile Strength (lbs)	Std. Pkg (pcs.)	Weight 100/pcs. (lbs.)
DG2E3	5/8	12,400	50	72



DG2E Series

Bolt eyes (eyelets)

DG6E Series

Bolt eyes, also known as eyelets, are used for guying, deadending or fastening suspension insulators to a crossarm.

Used with standard machine bolts, bolt eyes are installed under the bolt head or nut of a bolt.

All bolt eyes are compatible with the strength of the bolts used with them.

Contains a slotted hole for ease of inserting bolt.

Ductile iron, hot-dipped galvanized for corrosion resistance.

IEEE Std C135.80™-2012 standard

RUS Section AB



DG6E

Standard

DG6E Series

Catalog Number	Accommodates Bolt Dia. (in.)	Mounting Bolt Hole Size (in.)	Tensile Strength (lbs)	Std. Pkg (pcs.)	Weight 100/ pcs. (lbs.)
DG6E1	5/8	3/4 x 1-1/16	12,400	50	72

Effective June 2017

Suspension/messenger clamp

Three-bolt messenger clamp

DJ2C7 Series

Tangent clamp mounted through center hole.

Mounting bolt (order separately; see pages 1-6) serves as third clamp bolt.

Includes two 1/2" x 1-11/16" track bolts and two 1/2" regular square nuts.

Hot-dipped galvanized for corrosion resistance.



DJ2C7

Catalog Number	Dimensions (in.)		Mounting Hole Dia.	Accommodate Wire Sizes	Std. Pkg (pcs.)	Weight 100/pcs. (lbs.)
	Length	Width				
DJ2C7	5 3/4	1-11/16	11/16 15/16 slot	1/4 to 7/16	25	180

Insulator clevises

Secondary/deadend

For secondary takeoffs or deadending at pole or crossarm. A variety of styles and mounting holes are offered for end user preference.

Broad base styles resist torsional loading.

Curved back styles prevent twisting under heavy load.

Channel style offers high deadend strength.

Rounded edges prevent cable insulation damage.

Hot-dipped galvanized steel for corrosion resistance.

Insulator not included.

IEEE Std C135.20™-1998 standard

RUS Section BH and DA

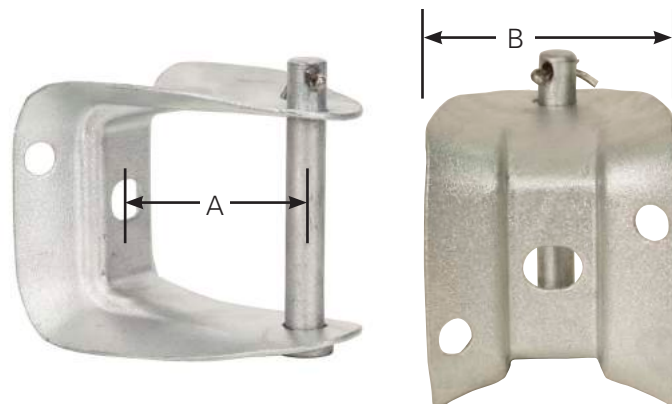

DC2C Series

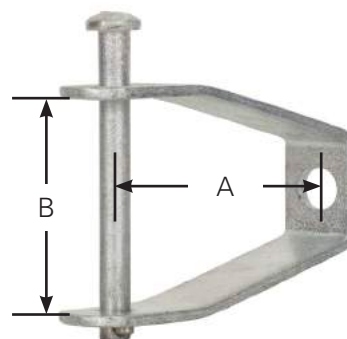

DC3F Series

Catalog Number	Dimensions (in.)				Tensile Strength (lb.)	Std. Pkg (pcs.)	Weight 100/pcs. (lbs.)
	A	B	Pin Dia.	Mounting Holes			
DC2C1	4	3-1/4	3/4	(1) 11/16 x 7/8 (2) 9/16	4,000	25	210
DC3F1	4-1/4	2-3/8	9/16	(1) 11/16 x 13/16	2,000	50	118
DC3F6	5	3-3/8	9/16	(1) 11/16 x 13/16	4,000	25	152

Single upset insulator bolts

DC2E Series

For side of pole installation of conductors.

Shank diameter is 5/8".

Insulator is held loosely on bolt by washer, square nut, and self-locking cotter.

Insulator not included.

Rolled threads assure uniformity and strength.

Rated at 13,550 lbs. ultimate tensile strength.

Hot-dipped galvanized steel for corrosion resistance.

RUS Section BS

Catalog Number	Dimensions (in.)			Std. Pkg (pcs.)	Weight 100/pcs. (lbs.)
	A Shank Length	B	Thread Length		
DC2E4	9	4-3/4	4-1/4	25	145
DC2E5	10	4-3/4	4-1/4	25	156
DC2E14	12	4-3/4	4-1/4	25	173

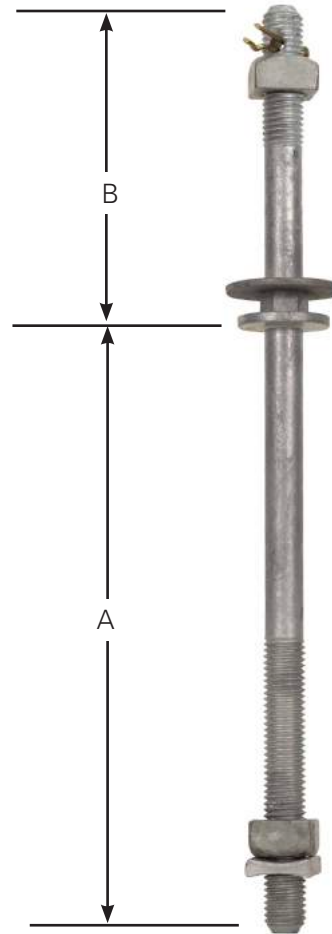

DC2E Series

Swinging

Used where flexible mounting allows clevis to conform to any tension angle.

To attach, use mounting angle (included with DC7S1 only) or any suitable eye-type fastener with a 5/8" diameter or larger opening.

Hot-dipped galvanized for corrosion resistance.

Insulators not included.

IEEE Std C135.20™-1998 standard

RUS Section AS

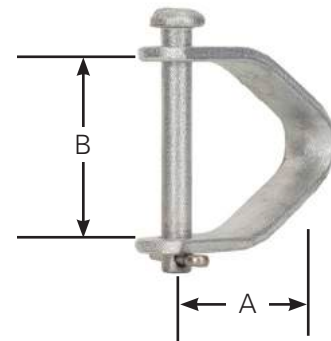

DC4S Series

Catalog Number	Dimensions (in.)				Ultimate Tensile Strength (lbs.)	Std. Pkg (pcs.)	Weight 100/pcs. (lbs.)
	A	B	Pin Dia.	Mounting Holes			
DC4S1	5	3-3/8	5/8	–	4,000	25	160
DC7S1	5	2-1/4	3/8	11/16	2,000	50	95
DC7S2	2-7/8	2-1/4	3/8	–	2,000	100	45

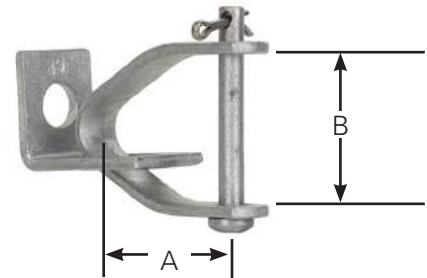

DC7S Series

Anchor shackle

DC7J1 Series

Interconnection applications include attachment of suspension insulators to towers, poles, and crossarms.

Includes 5/8" diameter pin and self-locking cotter.

Where additional clearance is required, use extension links.

Drop-forged steel, hot-dipped galvanized for corrosion resistance.

IEEE Std C135.62™-2009 and IEEE Std C135.61™-1997 standards

RUS Section BO

Std. Pkg.: 50 Pcs.

Weight 100/Pcs.: 92 lbs.

Ultimate Tensile Strength: 15,000 lbs.



DC7J1 Series

Clevis thimble with side pulling eye

DC9A Series

Used for guying and deadending applications, with a side pulling eye for tensioning the guy wire or conductor.

Includes a stainless steel cotter pin.

Hot-dipped galvanized for corrosion resistance.

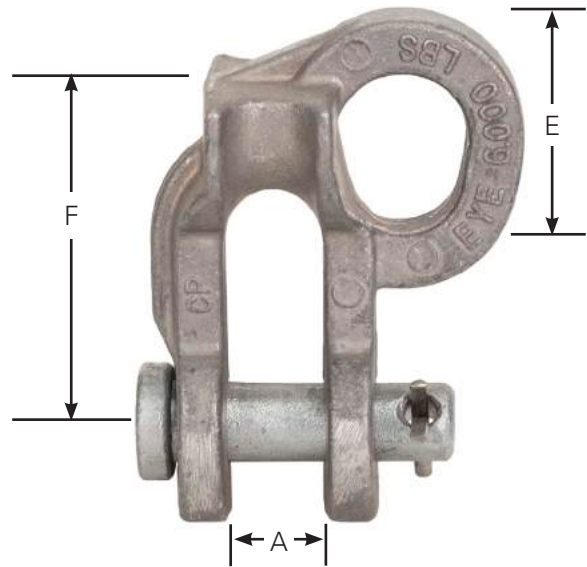

DC9A Series

Catalog Number	Conductor Range		Ultimate Tensile Strength (lbs.)		Dimensions (in.)						Std. Pkg (pcs.)	Weight 100/pcs. (lbs.)
	ACSR	Guy Wire (in.)	Thimble	Eye	A Groove Dia.	B Seat Dia.	C	D	E	F		
DC9A10	6 - 336.4	3/16 to 5/16	10,000	6,000	3/4	1-1/2	2-1/8	5/8	1-1/2	2-7/8	50	100
DC9A12	6 - 477	3/16 to 3/8	12,000	7,000	7/8	1-1/2	2-1/8	5/8	1-1/2	2-7/8	50	100

Effective June 2017

Insulator pins and accessories

Pole-top insulator bracket

For pole-top mounting of distribution post-type insulators.

Can be used with standard short-shank steel crossarm pins and pin-type insulators for inexpensive armless construction.

Permit clean, uncluttered appearance.

Order line-post insulator mounting studs (see page 27) and insulator adapter pins (see page 30) separately.

Hot-dipped galvanized ductile iron casting for corrosion resistance.

RUS Section EB

Std. Pkg.: 5 Pcs.

Weight 100/Pcs.: 860 lbs.

Ultimate Tensile Strength: 40,000 lbs.

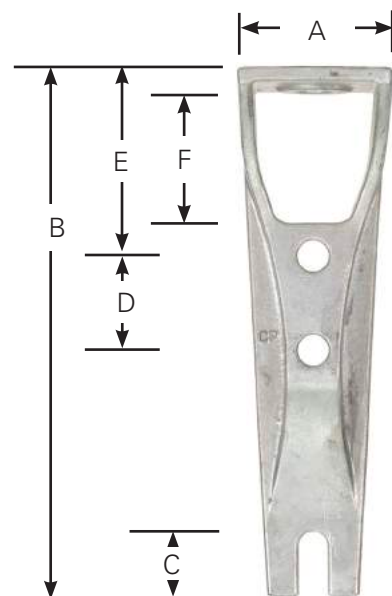

DC126B1

Catalog Number	Dimensions (in.)						Mounting Holes	Ultimate Tensile Strength (lbs.)	Std. Pkg (pcs.)	Weight 100/pcs. (lbs.)
	A	B	C	D	E	F				
DC126B1	4	14	2	2-1/2	4-3/4	3-1/2	0.82	40,000	5	860

Line-post insulator studs

DP30M Series

For steel crossarms.

Serrated collar and lockwasher secure unit to line post insulator and prevent accidental disassembly. Cut threads above serrated collar; rolled threads below collar.

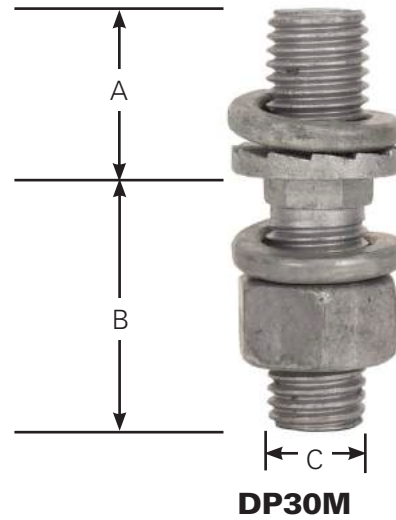

Catalog Number	Dimensions (in.)			Hardware Included	Std. Pkg (pcs.)	Weight 100/pcs. (lbs.)
	A	B	C			
DP30M1	1-1/8	1-3/4	5/8	(1) reg. hexnut and (2) spring lockwashers	100	48
DP30M3	1-1/8	1-3/4	3/4	(1) reg. hexnut and (2) spring lockwashers	100	58

Effective June 2017

Crossarm clamp

DP2C Series

An extremely strong crossarm pin with nylon alloy insulator threads, designed for straight, angle, or corner construction on flat crossarms.

Accommodate 3-3/4 x 4-3/4" crossarms.

Saddle-type pin base prevents turning; small projections on strap bite into crossarm's side, preventing pin movement.

Supplied with reversible clamp strap (for use on wood and fiberglass crossarms), 5/8" x 7" carriage bolts, regular square nuts, and MF locknuts.

Rated at 1,500 lbs. minimum cantilever load.

Hot-dipped galvanized steel for corrosion resistance.

IEEE Std C135.17™-1979 standard

RUS Section F

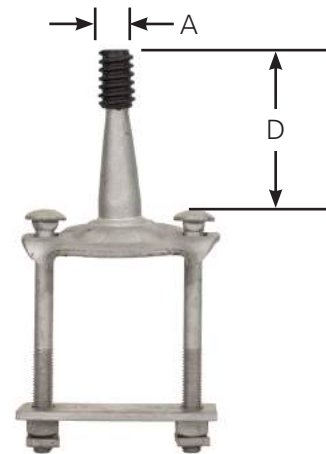

DP2C Series

Catalog Number	D Thread Diameter (in.)	A Shaft Height (in.)	Std. Pkg (pcs.)	Weight 100/pcs. (lbs.)
DP2C1	1	5-1/2	5	495
DP2C11*	1-3/8	6-3/4	5	553

* Heavy-duty type; suitable for converting to higher system voltages on existing crossarms.

Crossarm pins

Low-voltage

For supporting line wires, leads, and jumpers on poles and crossarms.

Manufactured with forged steel; hot-dipped galvanized for corrosion resistance.

Broad base diameter distributes load without damaging wood crossarms.

Wrench-flat design aids installation.

1" diameter ANSI®/NEMA®-standard nylon threads.

Includes one regular square nut.

Rated for 3,000 lbs. thread tensile strength and 1,200 lbs. minimum cantilever load.

IEEE Std C135.17™-1979 standard

RUS Section F

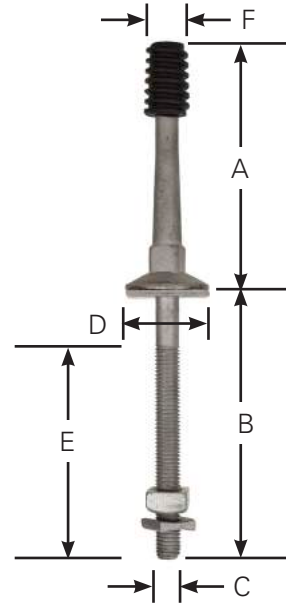

DP2S Series

Dimensions (in.)

Catalog Number	A Shaft Height	B Shank Length	C Shank Dia.	D Base Dia.	E Min Thread Length	F Thread Dia.	Additional Hardware Included	Std. Pkg (pcs.)	Weight 100/pcs. (lbs.)
DP2S1	5	6	5/8	2	4-1/2	1	"(1) 2" sq. washer; (1) MF locknut; (1) regular sq. nut"	25	138

High-voltage

Designed to take the heaviest strains on transmission and distribution lines.

Forged steel, hot-dipped galvanized for corrosion resistance.

1-3/8" diameter ASTM-standard nylon threads.

Includes one regular square nut.

Rated for 3,000 lbs. thread tensile strength and 2,000 lbs. minimum cantilever load.

IEEE Std C135.17™-1979 standard

RUS Section F

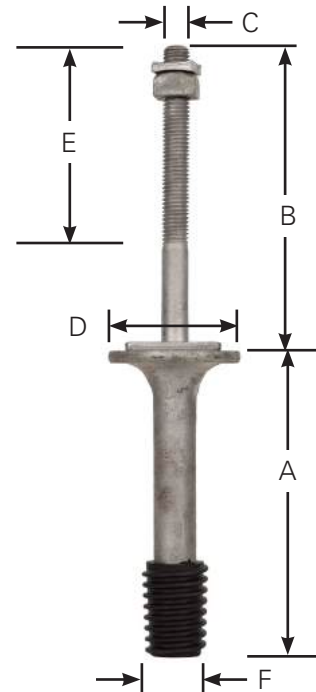

DP3T Series

Dimensions (in.)

Catalog Number	A Shaft Height	B Shank Length	C Shank Dia.	D Base Dia.	E Min Thread Length	F Thread Dia.	Additional Hardware Included	Std. Pkg (pcs.)	Weight 100/pcs. (lbs.)
DP3T1	7	7	5/8	2-3/4	4-3/8	1-3/8	"(1) 2" sq. washer; (1) MF locknut; (1) regular sq. nut"	10	302

Insulator adapter pin

DP1A Series

Used to provide a convenient insulator mounting position for down leads and jumpers anywhere a 5/8" diameter bolt already exists.

ASTM-standard nylon threads.

Hot-dipped galvanized steel for corrosion resistance.

IEEE Std C135.17™-1979 standard

Catalog Number	Dimensions (in.)		Std. Pkg (pcs.)	Weight 100/pcs. (lbs.)
	A Length"	B Thread Dia.		
DP10A1	5-1/2	1	25	79
DP10A2	5-1/2	1-3/8	25	130

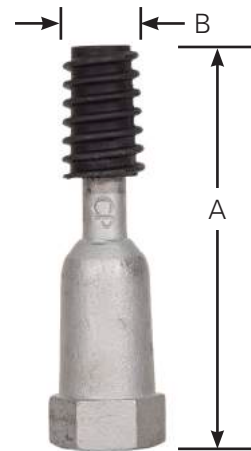

DP10A2 Series

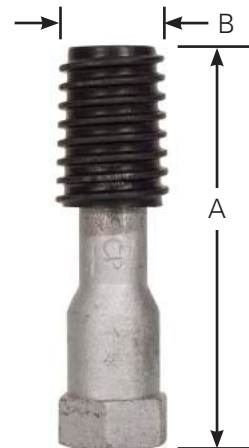

DP10A2 Series

This page is intentionally left blank.



Eaton
1000 Eaton Boulevard
Cleveland, OH 44122
United States
Eaton.com

Eaton's Power Systems Division
2300 Badger Drive
Waukesha, WI 53188
United States
Eaton.com/cooperpowerseries

© 2017 Eaton
All Rights Reserved
Printed in USA
Publication No. CA325002EN

Eaton is a registered trademark.
All other trademarks are property
of their respective owners.

For Eaton's Cooper Power series product
information, call 1-877-277-47636 or visit:
www.eaton.com/cooperpowerseries.