

23 and 38 kV Bay-O-Net fuse re-fusing installation instructions



DISCLAIMER OF WARRANTIES AND LIMITATION OF LIABILITY

The information, recommendations, descriptions and safety notations in this document are based on Eaton Corporation's ("Eaton") experience and judgment and may not cover all contingencies. If further information is required, an Eaton sales office should be consulted. Sale of the product shown in this literature is subject to the terms and conditions outlined in appropriate Eaton selling policies or other contractual agreement between Eaton and the purchaser.

THERE ARE NO UNDERSTANDINGS, AGREEMENTS, WARRANTIES, EXPRESSED OR IMPLIED, INCLUDING WARRANTIES OF FITNESS FOR A PARTICULAR PURPOSE OR MERCHANTABILITY, OTHER THAN THOSE SPECIFICALLY SET OUT IN ANY EXISTING CONTRACT BETWEEN THE PARTIES. ANY SUCH CONTRACT STATES THE ENTIRE OBLIGATION OF EATON. THE CONTENTS OF THIS DOCUMENT SHALL NOT BECOME PART OF OR MODIFY ANY CONTRACT BETWEEN THE PARTIES.

In no event will Eaton be responsible to the purchaser or user in contract, in tort (including negligence), strict liability or otherwise for any special, indirect, incidental or consequential damage or loss whatsoever, including but not limited to damage or loss of use of equipment, plant or power system, cost of capital, loss of power, additional expenses in the use of existing power facilities, or claims against the purchaser or user by its customers resulting from the use of the information, recommendations and descriptions contained herein. The information contained in this manual is subject to change without notice.

Contents

SAFETY INFORMATION

Safety Information	iv
--------------------------	----

PRODUCT INFORMATION

Introduction	1
Handling and Storage	1
Standards	1

RE-FUSING PROCEDURES

General Considerations	2
Sidewall-Mounted Bay-O-Net Fuse Holder Re-fusing	2
Cover-Mounted Bay-O-Net Fuse Holder Re-fusing	6



Safety for life



Eaton meets or exceeds all applicable industry standards relating to product safety with its Cooper Power™ series products. We actively promote safe practices in the use and maintenance of our products through our service literature, instructional training programs, and the continuous efforts of all Eaton employees involved in product design, manufacture, marketing, and service.

We strongly urge that you always follow all locally approved safety procedures and safety instructions when working around high voltage lines and equipment, and support our “Safety For Life” mission.

Safety information

The instructions in this manual are not intended as a substitute for proper training or adequate experience in the safe operation of the equipment described. Only competent technicians who are familiar with this equipment should install, operate, and service it.

A competent technician has these qualifications:

- Is thoroughly familiar with these instructions.
- Is trained in industry-accepted high and low-voltage safe operating practices and procedures.
- Is trained and authorized to energize, de-energize, clear, and ground power distribution equipment.
- Is trained in the care and use of protective equipment such as arc flash clothing, safety glasses, face shield, hard hat, rubber gloves, clampstick, hotstick, etc.

Following is important safety information. For safe installation and operation of this equipment, be sure to read and understand all cautions and warnings.

Hazard Statement Definitions

This manual may contain four types of hazard statements:

DANGER

Indicates an imminently hazardous situation which, if not avoided, will result in death or serious injury.

WARNING

Indicates a potentially hazardous situation which, if not avoided, could result in death or serious injury.

CAUTION

Indicates a potentially hazardous situation which, if not avoided, may result in minor or moderate injury.

CAUTION: Indicates a potentially hazardous situation which, if not avoided, may result in equipment damage only.

Safety instructions

Following are general caution and warning statements that apply to this equipment. Additional statements, related to specific tasks and procedures, are located throughout the manual.

DANGER

Hazardous voltage. Contact with hazardous voltage will cause death or severe personal injury. Follow all locally approved safety procedures when working around high- and low-voltage lines and equipment.

G103.3

WARNING

Before installing, operating, maintaining, or testing this equipment, carefully read and understand the contents of this manual. Improper operation, handling or maintenance can result in death, severe personal injury, and equipment damage.

G101.0

WARNING

This equipment is not intended to protect human life. Follow all locally approved procedures and safety practices when installing or operating this equipment. Failure to comply can result in death, severe personal injury and equipment damage.

G102.1

WARNING

Power distribution and transmission equipment must be properly selected for the intended application. It must be installed and serviced by competent personnel who have been trained and understand proper safety procedures. These instructions are written for such personnel and are not a substitute for adequate training and experience in safety procedures. Failure to properly select, install or maintain power distribution and transmission equipment can result in death, severe personal injury, and equipment damage.

G122.3

Product Information

Introduction

Eaton protects transformers and distribution systems with its Cooper Power™ series Bay-O-Net fuse assemblies. They are designed for use in pad-mounted or subsurface distribution transformers filled with transformer oil or approved equivalent. The assemblies combine the ease of hotstick operation with the safety of deadfront construction.

Removal of the fuse holder from the assembly indicates that the apparatus is electrically disconnected. It also allows convenient fuse element inspection and replacement. When typical safety practices are followed, the assemblies can be loadbreak-operated for working on the transformer secondary; changing distribution voltage with dual voltage switches or tap changers; or disconnecting the apparatus from the line.

Eaton's optional Cooper Power series Flapper™ valve Bay-O-Net fuse assembly (available as sidewall-mounted only) includes a flapper valve inside the housing which closes when the fuse holder is removed, thus minimizing oil spillage.

Read This Manual First

Read and understand the contents of this manual and follow all locally approved procedures and safety practices before installing or operating this equipment.

Additional Information

These instructions cannot cover all details or variations in the equipment, procedures, or process described nor provide directions for meeting every possible contingency during installation, operation, or maintenance. For additional information, contact your representative.

Acceptance and Initial Inspection

Each fuse is in good condition when accepted by the carrier for shipment. Upon receipt, inspect the shipping container for signs of damage. Unpack the fuse and inspect it thoroughly for damage incurred during shipment. If damage is discovered, file a claim with the carrier immediately.

Handling and Storage

Be careful during handling and storage of the fuse to minimize the possibility of damage. If the fuse is to be stored for any length of time prior to installation, provide a clean, dry storage area.

Standards

ISO 9001 Certified Quality Management System

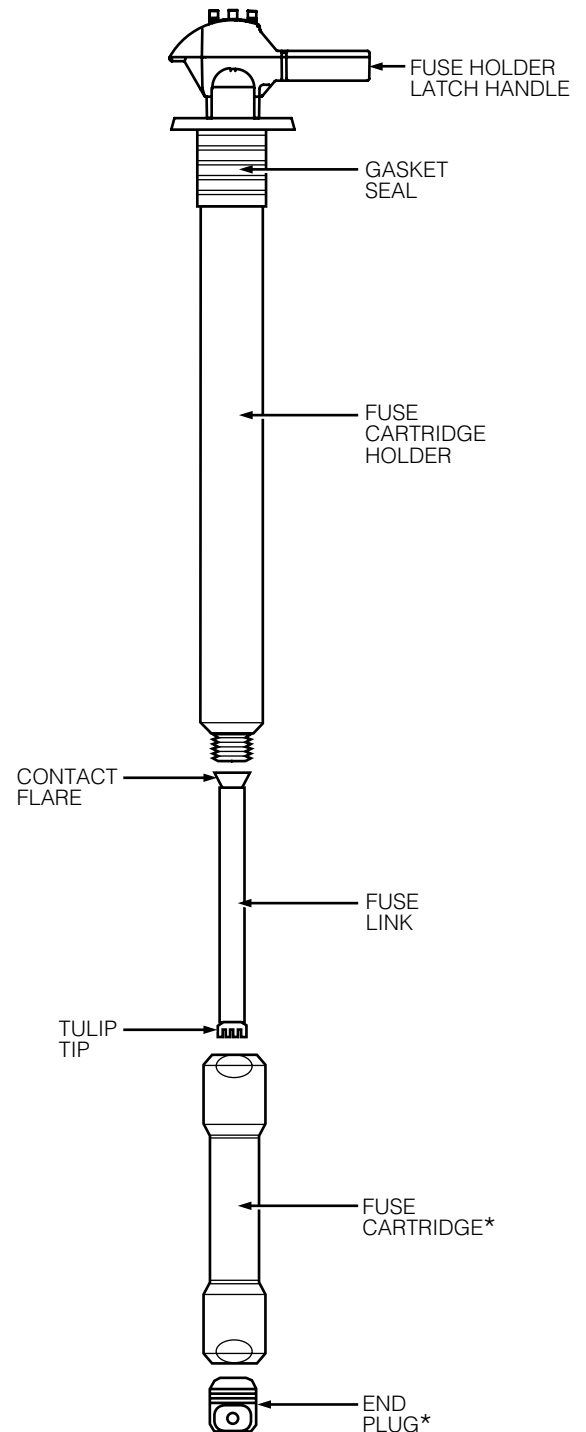

* Separate fuse link, fuse cartridge and end plug apply for all Eaton's Cooper Power series Bay-O-Net fuses except catalog numbers for 23 kV 4000358C16CB and C18CB, 4038361C03CB, C04CB, C05CB, along with solid link 4038361C10CB and 38 kV 4000380C06CB, C08CB, C10CB, C11CB, C12CB, C14CB, which are an integral assembly including the link, cartridge and end plug.

Figure 1. Sidewall-mounted Bay-O-Net fuse.

General considerations apply to both cover- and sidewall-mounted Bay-O-Net assemblies

WARNING

Bay-O-Net Fuse is not recommended for fault closing. Serious personal injury may result if attempted. Internal fault conditions can cause transformer to rupture or cover to blow off. Always energize transformer from remote location to be safe. This device was designed and intended for under-oil application only. Refer to Step 10 for correct oil level.

CAUTION

Do not re-energize suspected failed equipment. When replacing a blown fuse, the feed circuit should be opened and closed from a remote location. The Bay-O-Net fuse should be replaced using the procedure described below and re-energized from a remote location. If equipment is re-fused while energized, the fuse could close in on the system's maximum fault current. Any equipment that has a suspected failure should not be closed in with this fuse.

The Bay-O-Net fuse is designed to be operated in accordance with normal safe operating procedures. These instructions are not intended to supersede or replace existing or utility specific safety and operating procedures. The Bay-O-Net fuse should be installed and serviced only by personnel familiar with good safety practices and the handling of high voltage electrical equipment.

WARNING

Bay-O-Net Fuses can be used to turn transformers off or on, within the ratings listed below. Attempts to switch current in excess of those ratings can cause rupture of the transformer tank or cause the cover to blow off. Fire, injury or death may result.

Voltage	Amps	Maximum kV Rating
10 kV	160 A	23 kV Housing
15.5 kV	150 A	
26.7 kV	80 A	
34.5 kV	50 A	38 kV Housing
38 kV	50 A	

WARNING

Bay-O-Net fuses are operated manually and proper use requires skill and practice on the part of the user. Before using the Bay-O-Net to turn an energized transformer off, the operator should be experienced in removing the Bay-O-Net from its holder when it is mounted to the transformer. Improper operation can result in a failure to switch and could require the transformer to be replaced or result in a fire.

WARNING

Before operating the Bay-O-Net, carefully assess the condition of the transformer. Check for any audible sounds of arcing occurring inside the tank. Check for bulging of the tank or any signs of oil leakage or spillage. Check the tank in the proximity of the pressure relief device for any signs of oil leakage, spillage, or for black carbon smudges. If any of these conditions are present, do not attempt to switch the transformer on or off with the Bay-O-Net. Conditions within a transformer with these external signs could cause the transformer tank to rupture or cause the cover to blow off the transformer. Fire, injury or death may result.

CAUTION

Before operating the Bay-O-Net inspect the area around the unit to make sure the ground is level and the footing is sound. These conditions represent a significant risk of injury due to a fall. Failure to properly operate the Bay-O-Net, could result in personal injury due to a fire or explosion.

WARNING

If the transformer is in an enclosed building or vault, or if the operator is positioned directly over the transformer, Bay-O-Net fuse assemblies should not be used to turn the transformer on or off. In such instances, an operator may be prevented from properly operating the Bay-O-Net or from safely leaving the area in the event of an improper operation.

Sidewall-mounted Bay-O-Net fuse re-fusing procedure

Remove Fuse Holder

Step 1

Relieve tank pressure

- If transformer tank has a pressure relief valve, use hotstick and complete the following steps to relieve tank pressure.
 - Pull pressure relief valve open, keeping it held open for 30 seconds after pressurized air can no longer be heard evacuating audibly through the valve.
 - Close pressure relief valve and wait 30 seconds.
 - Pull pressure relief valve open. Keep it open until audible pressure stops and hold it open for an additional 5 seconds. Pulling the valve open again allows any residual pressure to be removed from the tank.

WARNING

Transformer tank pressure must be relieved prior to Bay-O-Net operation. Failure to properly vent the transformer tank pressure can result in violent ejection of the Bay-O-Net stab assembly along with hot oil. This can cause impact injury, burns and environmental contamination.

Step 2

Unlock fuse holder

- Standing to one side of the transformer, attach hotstick to fuse holder eye and twist hotstick to unlock fuse holder.

Step 3

Break seal

- Turn fuse holder 90° in the Bay-O-Net housing to break the seal between the seal gasket and the Bay-O-Net housing. (See Figure 2.)

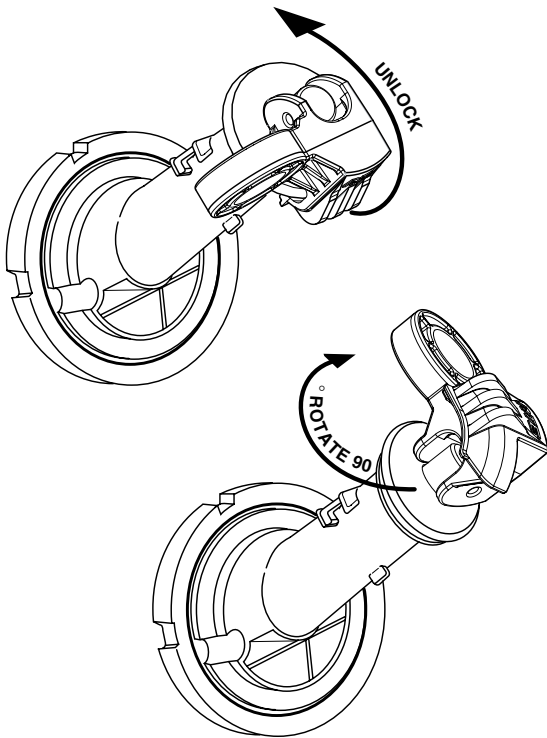

Figure 2. Unlock and turn fuse holder 90° in the Bay-O-Net housing.

Step 4

Draw fuse holder out

- Draw the fuse holder out rapidly in one motion 6 to 8 inches (152 to 203 mm) to interrupt transformer load. (See Figure 3.)

WARNING

Moving the fuse holder the first 6 to 8 inches (152 to 203 mm) rapidly is critical to the Bay-O-Net successfully switching the transformer off. Movement in this region should be as fast and smooth as possible. If the movement is slow or interrupted, the current may continue in the form of an arc, which could damage the transformer, requiring its replacement. A fire could result, as could death or moderate injury.

- Wait several seconds for fluid to drain into tank.

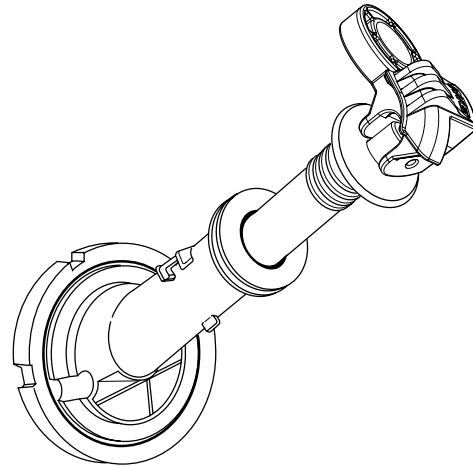

Figure 3. Draw fuse holder out 6 to 8 inches (152 to 203 mm).

Step 5

Remove fuse holder from Bay-O-Net housing

- Remove fuse holder from Bay-O-Net housing.

Note: If a drip guard (metal or plastic) is present, it is recommended to rest the Bay-O-Net holder on the drip guard for 30 seconds to 1 minute to minimize the potential of oil spillage onto rubber terminators.

- Wipe off fuse cartridge holder and fuse cartridge using a clean cloth. (See Figure 4.)

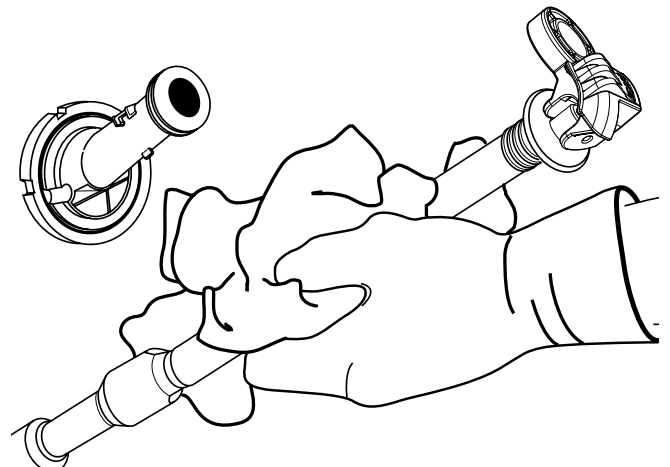

Figure 4. Remove fuse holder from Bay-O-Net housing and wipe clean of insulating fluid.

Note: If any fluid is coming out of Bay-O-Net Assembly, pull pressure relief valve again to equalize pressure inside the tank. (Refer to Step 1 for instructions.)

Replace Fuse Link

For all Eaton's Cooper Power series Bay-O-Net fuses except 23 kV 4000358C16CB and C18CB, 4038361C03CB, C04CB, C05CB, solid link 4038361C10CB, 38 kV 4000380C06CB, C08CB, C10CB, C11CB, C12CB, and C14CB follow steps 6 through 9. For the above listed integral cartridge fuses follow Step 6 and then tighten new cartridge/fuse/end plug against fuse holder using 50-70 in-lbs (5.65-7.9 Nm) of torque.

CAUTION

Prior to installing the new cartridge verify that the kV rating and length matches the cartridge being replaced. Failure to use the correct length integral cartridge will result in poor electrical contact between the cartridge and Bay-O-Net housing terminals, resulting in possible equipment damage.

Step 6

Remove fuse cartridge

- Use a 3/4 inch (19 mm) wrench to remove fuse cartridge from fuse cartridge holder. (See Figure 5.)
- Carefully inspect the fuse cartridge. (See Caution below.)

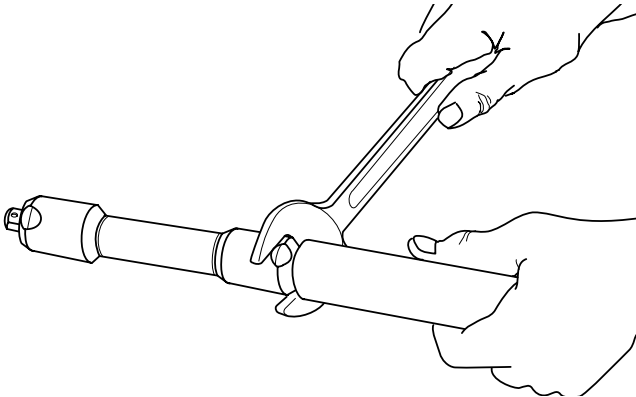

Figure 5. Remove fuse cartridge from fuse cartridge holder.

WARNING

Damage to the cartridge (such as severe erosion of the brass end piece, or burning on the interior or exterior surface of the insulation) may prevent the fuse from proper operation. Inspect the cartridge carefully to ensure there is no erosion greater than small pitting on any of the brass pieces, or blackening or burning of the insulating members longer than 1/2" (13 mm). If damage exceeds this level, the damaged cartridge should be replaced with a new one. If large amounts of melting of the brass have occurred, or burning extends more than half the length of the cartridge, the Bay-O-Net holders should also be replaced. This should be done in a transformer repair facility by qualified and trained personnel. If the assemblies are damaged, a failure to interrupt a later fault could result. This may cause injury to the operator or to the public.

Step 7

Remove end plug and fuse link from fuse cartridge

- Use 3/4 inch (19 mm) and 1/2 inch (13 mm) wrenches to remove end plug. (See Figure 6.)
- Use screwdriver or other tool to straighten the tulip tip end of fuse link and push fuse link out of fuse cartridge.

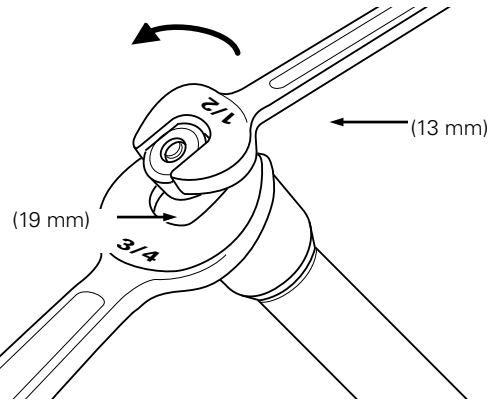

Figure 6. Remove end plug from fuse cartridge.

Step 8

Insert replacement fuse link into fuse cartridge (Figure 7.)

- A slight resistance may occur when inserting fuse link into cartridge (Refer to Figure 7A and 7B).
- If the catalog number of the fuse being replaced is not known or is illegible on the fuse, consult equipment specifications or manufacturer.

WARNING

Using a Bay-O-Net link with a higher amp rating could result in improper coordination with the backup current-limiting fuse inside the transformer or elsewhere on the system. This may result in a much larger outage in the event of failure within the transformer or a fire or explosion of the transformer. Installing a Bay-O-Net link with a smaller than recommended amp rating may cause an unnecessary fuse operation and service interruption. Always follow the equipment specifications when replacing a fuse link.

Step 9

Tighten cartridge to fuse cartridge holder

- Tighten fuse contact flare end against fuse cartridge holder using 50-70 in-lbs (5.65-7.9 Nm) of torque (Refer to Figure 7C).
- Replace end plug on other end of fuse cartridge and tighten to 50-70 in-lbs (5.65-7.9 Nm) torque (Refer to Figure 7D and 7E).
- Remove end plug and ensure that leaves of tulip tip have spread uniformly (Refer to Figure 7F).
- Replace end plug applying 50-70 in-lbs (5.65-7.9 Nm) torque to both connections (Refer to Figure 7D and 7E).

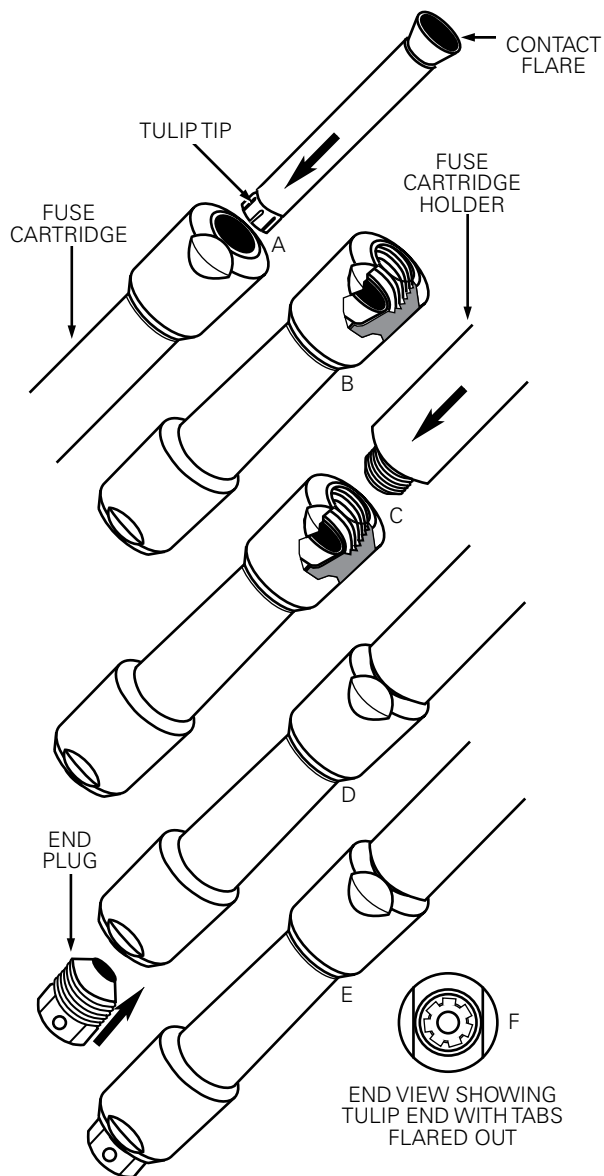

Figure 7. Fuse link replacement.

CAUTION

Failure to properly tighten the fuse cartridge holder and the end plug to the fuse cartridge will result in a poor electrical connection, resulting in damage to the Bay-O-Net and the transformer. The steps detailed in Figure 7 should be followed in proper order to ensure a good electrical connection.

Step 10

Check fluid level

- Refer to the equipment manufacturer's instruction book for correct oil level.
- The fluid level in the transformer should be approximately at the base of the protruding plastic threads of the Bay-O-Net housing at 25° C (77° F) with the transformer on a level surface. (See Figure 8.)

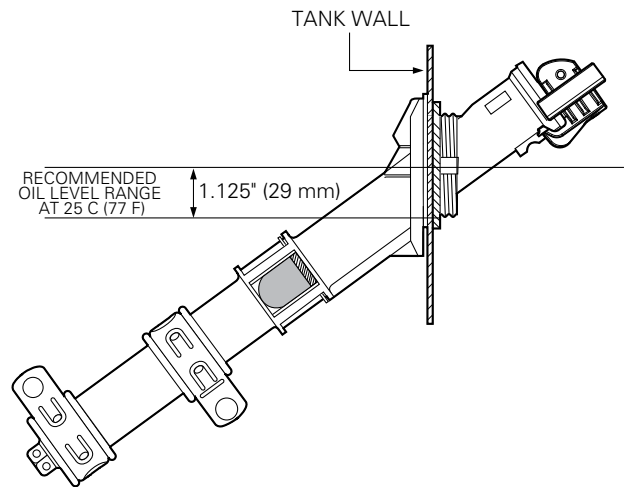

Figure 8. Check fluid level.

WARNING

Inadequate oil in the tank can result in a dielectric failure of the transformer causing an outage, damage to the transformer, fire or explosion. If the transformer has excess oil, spillage may result when the Bay-O-Net fuse holder is removed.

Step 11

Install fuse holder

- Pull pressure relief valve, keeping it held open until audible pressure evacuation stops and then hold open for another 5 seconds.
- Attach end of fuse holder assembly to hotstick and insert holder assembly firmly into the Bay-O-Net housing.

- Twist the locking handle so that the latch engages the Bay-O-Net housing's shoulder and the steel washer seats tightly on the end of the tube of the Bay-O-Net holder assembly. (See Figure 8.)

⚠ CAUTION

The last 6 to 8 inches (152 to 203 mm) of movement are critical to the Bay-O-Net successfully switching the transformer on. Movement in this region should be as fast and smooth as possible. If the movement is slow or interrupted, damage to the Bay-O-Net assembly could result.

⚠ CAUTION

Visually inspect the entire fuse holder assembly to be sure it is installed correctly. Ensure that the fingers of the latch are entirely under the latch ring of the housing. This ensures that the contacts inside the assembly are fully engaged. If the contacts are not fully engaged, damage and eventual failure of the fuse holder and cartridge will result.

Cover-mounted Bay-O-Net fuse (23 kV maximum) re-fusing procedure

Remove fuse holder

⚠ WARNING

Bay-O-Net fuse assemblies should not be used to turn on or off a transformer if the transformer is in an enclosed building or vault, or with the operator being positioned directly over the transformer. In such instances, an operator may be prevented from properly operating the Bay-O-Net or from safely leaving the area in the event of an improper operation.

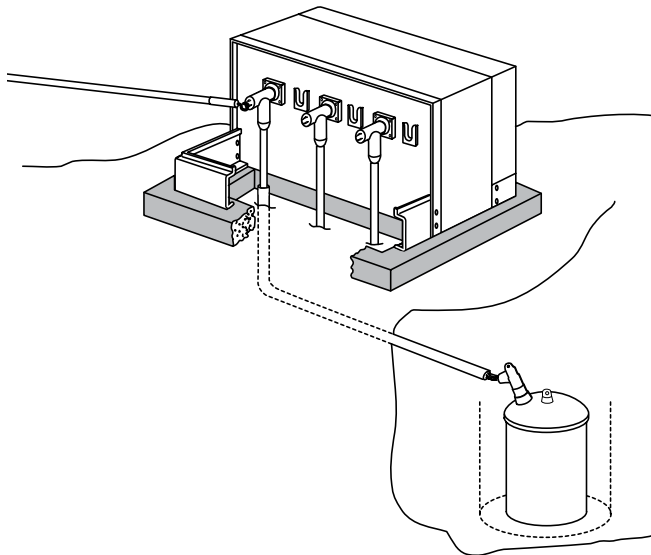

Figure 9. De-energize transformer from remote location.

Step 1

De-energize Transformer

- It is recommended that the transformer be de-energized from a remote location. (See Figure 9.) This is especially true when the transformer is located in a vault, room or in a position requiring the operator to operate the Bay-O-Net while standing directly over the transformer. If the transformer has a pressure relief valve, use a hotstick to relieve the tank pressure. (Refer to Step 1 on page 3.)

⚠ WARNING

Transformer tank pressure must be relieved prior to Bay-O-Net operation. Failure to properly vent the transformer tank pressure can result in violent ejection of the Bay-O-Net stab assembly along with hot oil. This can cause impact injury, burns and environmental contamination.

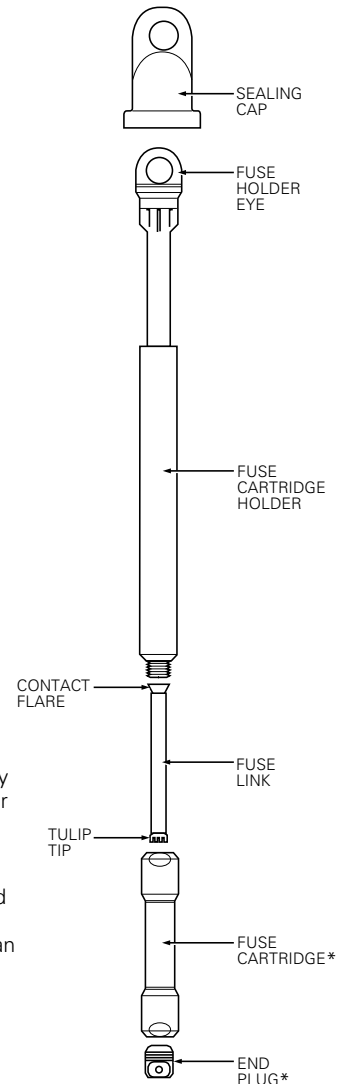

*Separate fuse link, fuse cartridge and end plug apply for all Eaton's Cooper Power series Bay-O-Net fuses except catalog numbers 4000358C16C and C18C, 4038361C03CB, C04CB and C05CB along with solid link 4038361C10CB which are an integral assembly including the link cartridge and end plug.

Figure 10. Cover-mounted Bay-O-Net Fuse.

⚠ WARNING

Manufacturer does not recommend using Bay-O-Net fuse to break load in submersed transformers. In such instances, an operator may be prevented from properly operating the Bay-O-Net or from safely leaving the area in the event of an improper operation. Violent ejection of the stab along with hot oil can result. This can cause impact injury, burns and environmental contamination.

Step 2

Unscrew sealing cap

- Standing in a safe position, use hotstick to unscrew sealing cap from apparatus. (See Figure 11.)

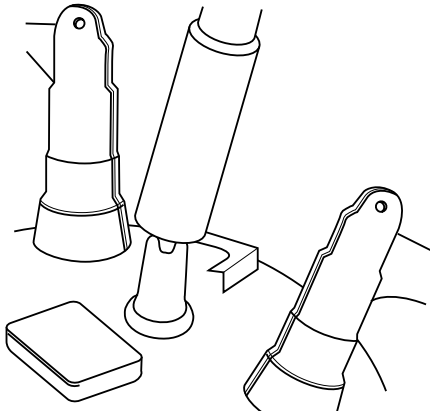

Figure 11. Unscrew sealing cap from apparatus.

Step 3

Clamp with hotstick

- Clamp exposed fuse holder eye with a hotstick and quickly withdraw fuse holder 6 to 8 inches (152 to 203 mm). Wait several seconds for fluid to drain into tank. (See Figure 12.)

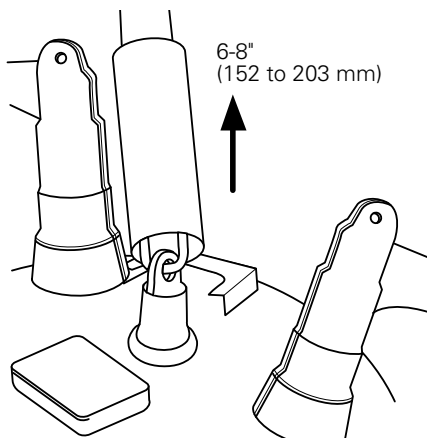

Figure 12. In one motion, rapidly withdraw fuse holder 6 to 8 inches (152 to 203 mm).

⚠ WARNING

The first 6 to 8 inches (152 to 203 mm) of movement are critical to the Bay-O-Net successfully switching the transformer off. Movement of the fuse holder should be in one rapid motion. If the movement is slow or interrupted, the current may continue in the form of an arc, which could damage the transformer, requiring its replacement. A fire could result, as could a burn injury.

Step 4

Remove fuse holder

- Remove fuse holder from Bay-O-Net housing and wipe off fuse cartridge holder and fuse cartridge using a clean cloth.

Note: If a drip guard (metal or plastic) is present, it is recommended to rest the Bay-O-Net holder on the drip guard for 30 seconds to 1 minute to minimize the portion of oil spillage onto rubber terminators.

- Replace sealing cap using a hotstick, standing at a safe distance from the apparatus. (See Figure 13.)

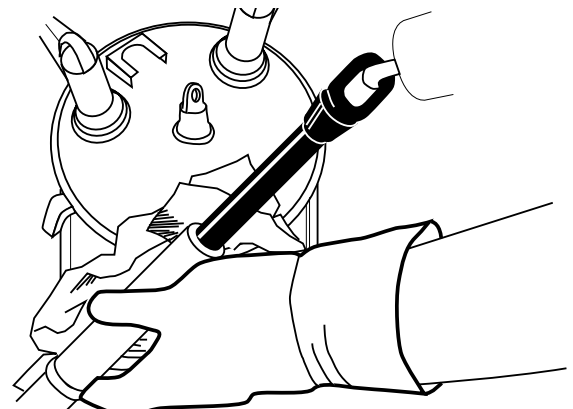

Figure 13. Remove fuse holder from Bay-O-Net housing, replace cap.

Replace fuse link

For all Cooper Bay-O-Net fuses except 4000358C16CB and C18CB, 4038361C03CB, C04CB and C05CB along with solid link 4038361C10CB follow Steps 5 through 7. For the above mentioned integral cartridge fuses follow Step 5, then tighten new cartridge/fuse/end plug against fuse holder using 50-70 in-lbs (5.65-7.9 Nm) of torque.

Step 5

Remove fuse cartridge

- Use a 3/4 inch (19 mm) wrench to remove fuse cartridge from fuse cartridge holder. (See Figure 14.)

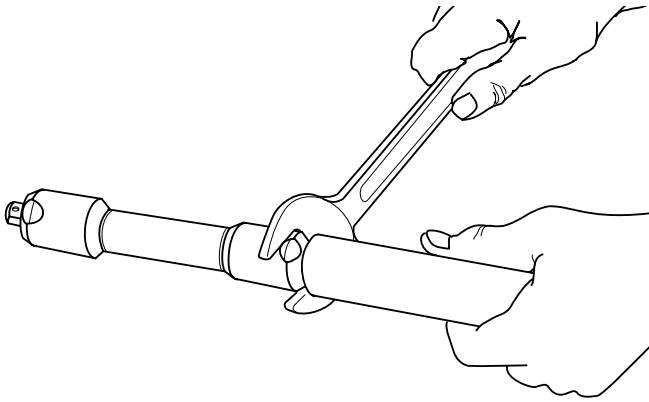

Figure 14. Remove fuse cartridge.

Step 6

Remove end plug and fuse link from fuse cartridge

- Use $\frac{3}{4}$ inch (19 mm) and $\frac{1}{2}$ inch (13 mm) wrenches to remove end plug. (See Figure 15.)

CAUTION

Damage to the cartridge such as severe erosion of the brass end piece, or burning on the interior or exterior surface of the insulation could prevent the fuse from proper operation. Inspect the cartridge carefully to ensure there is no erosion greater than small pitting on any of the brass pieces, blackening or burning of the insulating members longer than $\frac{1}{2}$ " (13 mm). If damage exceeds this level, the damaged cartridge should be replaced with a new one. If large amounts of melting of the brass have occurred, or burning extends more than half the length of the cartridge, the Bay-O-Net holders should also be replaced. This should be done in a transformer repair facility by qualified and trained personnel. If the assemblies are damaged, a failure to interrupt a later fault could result. This could cause injury to the operator or to the public.

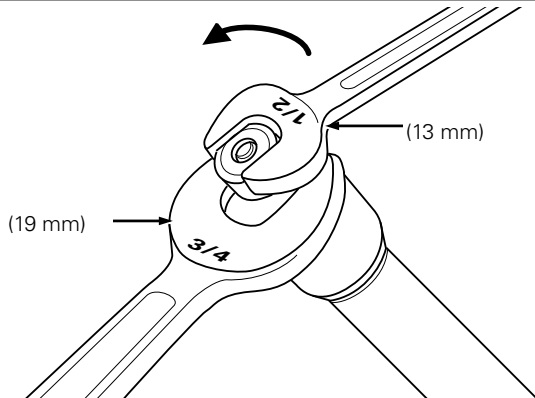

Figure 15. Remove end plug from fuse cartridge.

- Use screwdriver or other tool to straighten the tulip tip end of fuse link and push fuse link out of fuse cartridge.

Step 7

Insert replacement fuse link into fuse cartridge. (Figure 16.)

- A slight resistance may occur when inserting fuse link into cartridge.
- If the catalog number of the fuse being replaced is not known or is illegible on the fuse, consult equipment specifications or manufacturer.

CAUTION

Failure to properly tighten the cartridge will result in a loose connection, resulting in damage to the Bay-O-Net and the transformer. Damaged equipment must be removed from service to perform necessary repairs.

WARNING

Using a Bay-O-Net link with a higher amp rating could result in improper coordination with the backup current-limiting fuse inside the transformer or elsewhere on the system. This may result in a much larger outage in the event of failure within the transformer or a fire or explosion of the transformer. Installing a Bay-O-Net link with a smaller than recommended amp rating may cause an unnecessary fuse operation and service interruption. Always follow the equipment specifications when replacing a fuse link.

- Tighten cartridge (fuse contact flare end) against fuse cartridge inner holder using 50-70 in-lbs (5.65-7.9 Nm) of torque.
- Replace end plug on other end of fuse cartridge and tighten to 50-70 in-lbs (5.65-7.9 Nm) torque.
- Remove end plug and ensure that leaves of tulip tip have spread uniformly.
- Replace end plug applying 50-70 in-lbs (5.65-7.9 Nm) torque to both connections.

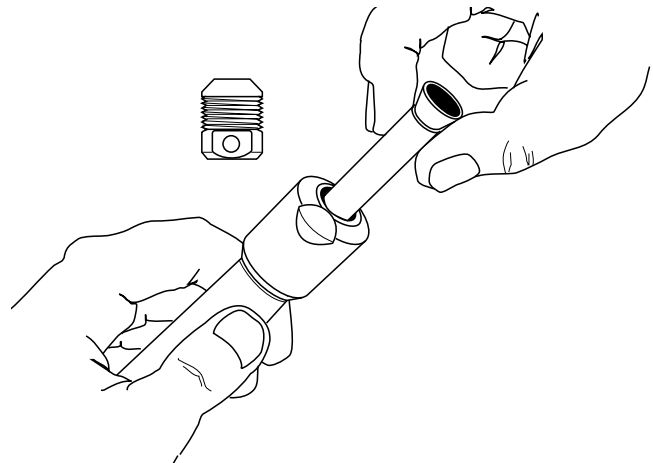

Figure 16. Insert replacement fuse link into fuse cartridge.

Step 8

Check fluid level

- Refer to manufacturer's instruction book for correct oil level. (See Figure 17.)

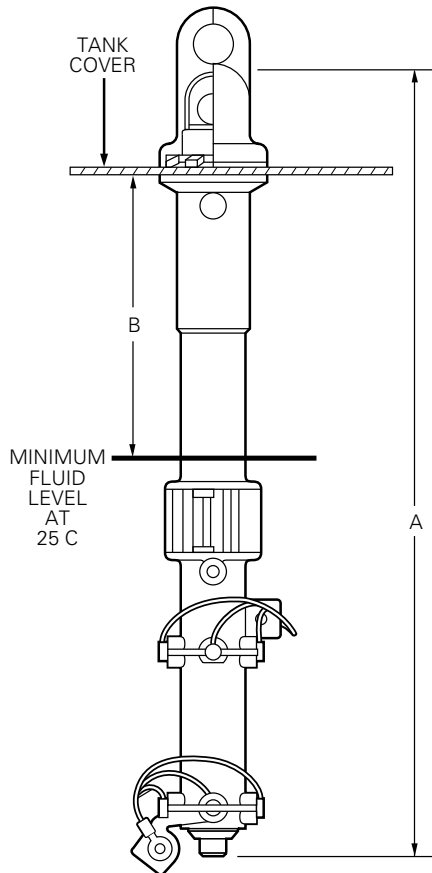

Figure 17. Check fluid level.

- To determine if a long or short Bay-O-Net assembly is used, measure the length of the entire fuse holder assembly (Dimension A). Dimension B in the drawing is the required fluid level. (See Table 1.)

Table 1. Fuse Lengths

Size	A	B
Short	15.0 in. (381 mm)	4.19 in. (106 mm)
Long	17.75 in. (450 mm)	6.94 in. (176 mm)

Step 9

Relieve tank pressure

- Pull pressure relief valve, keeping it held open until audible pressure evacuation stops and then hold open for another 5 seconds.

Remove sealing cap

- Standing in a safe position, use hotstick to unscrew sealing cap from apparatus. (See Figure 11.)

Replacing fuse holder using a hotstick.

- Clamp exposed fuse holder eye with a hotstick and with one rapid motion, insert assembly fully into the housing. (See Figure 18.)

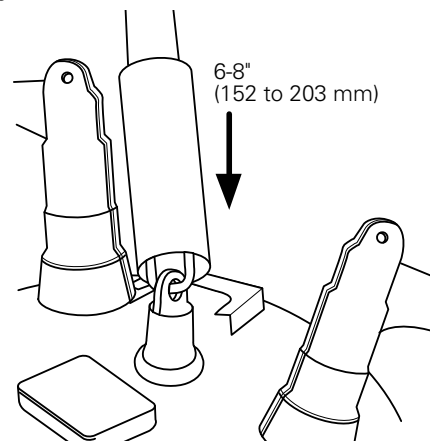

Figure 18. In one motion, rapidly replace the fuse holder.

CAUTION

The last 6 to 8 inches (152 to 203 mm) of movement are critical to the Bay-O-Net successfully switching the transformer on. Movement in this region should be as fast and smooth as possible. If the movement is slow or interrupted damage to the Bay-O-Net assembly could result.

Step 10

Reinstall sealing cap

- Standing in a safe position, use hotstick to reattach the sealing cap by screwing it onto the threads of the Bay-O-Net housing until tight. (See Figure 19.)

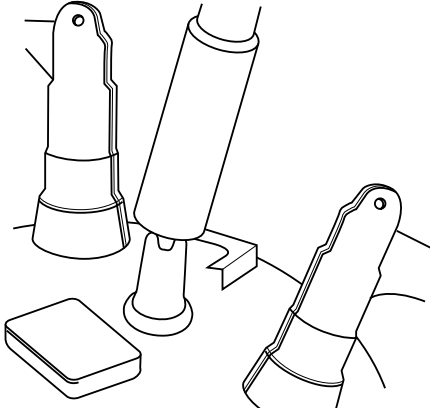

Figure 19. Screw on sealing cap from apparatus.



CAUTION

Visually inspect the entire fuse holder assembly to be sure it is installed correctly. Pay close attention to be sure the cap is fully tightened in place. This ensures that the contacts inside the assembly are fully engaged. If the contacts are not fully engaged, burning of the fuse holder and cartridge will result.

If the transformer has been de-energized remotely, re-energize apparatus from the remote location.

This page is intentionally left blank.



Eaton
1000 Eaton Boulevard
Cleveland, OH 44122
United States
Eaton.com

**Eaton's Cooper Power Systems
Division**
2300 Badger Drive
Waukesha, WI 53188
United States
Cooperpower.com

© 2015 Eaton
All Rights Reserved
Printed in USA
Publication No. MN132002EN Rev 00
Supersedes 5000023080 Rev 07

Eaton, Cooper Power, and Flapper are
valuable trademarks of Eaton in the U.S.
and other countries. You are not permitted
to use these trademarks without the prior
written consent of Eaton.

For Eaton's Cooper Power
series Bay-O-Net fuse
product information call
1-877-277-4636 or visit:
www.cooperpower.com.