

# Low voltage capacitors, fixed capacitor banks, and fixed detuned filters



Unipak capacitor banks, Unipump capacitor banks, and Unipak detuned filters

## Contents

Description	Page
Capacitor cells . . . . .	2
Unipump power factor correction capacitors . . . . .	4
Unipak low voltage fixed capacitor banks . . . . .	6
Unipak with heavy-duty capacitor cells . . . . .	9
Unipak low voltage fixed detuned filters . . . . .	10

**Note:** Images contained in this document may be shown with optional components and features not included as part of the base offering.



*Powering Business Worldwide*

## Capacitor cells



Capacitor cell with cage clamp terminals



Capacitor cell with quick disconnect terminals



Bulged capacitor cell top provides easy visual indication of pressure interrupter operation

## Features

- **Terminals:** Insulated fingersafe terminals rated for 3 kVAC withstand (cage clamp models only)
- **Dielectric fill:** Cells use soft organic polymer resin—Resinol
  - Eliminates potential for corona/partial discharge/ electrochemical oxidation
  - Excellent heat dissipation
  - Flash point: +444 °F (+229 °C)
  - Fire point: +840 °F (+449 °C)
- **Design:** Self-healing metallized high crystalline polypropylene with metallization film. Total losses less than 0.45 watt per kVAR (dielectric losses less than 0.2 watt per kVAR)
- **Pressure-sensitive interrupter:** Built-in UL® recognized three-phase pressure-sensitive interrupter, and thermally or mechanically activated disconnecting link removes capacitor from the supply before dangerous pressure buildup or excessive fault current occurs. Bulged capacitor cell top provides easy visual indication of interrupter operation
- **Discharge resistors:** Reduce residual voltage to less than 50 V within one minute of de-energization. Exceeds NEC® requirements
- **Capacitor operating temperature:** -40 °F to +115 °F (-40 °C to +46 °C)
- **Capacitor storage temperature:** -40 °F to +131 °F (-40 °C to +55 °C)
- **Case:** Aluminum housing
- **Warranty:** Standard one-year warranty on component capacitor cells per Eaton Selling Policy 25-000

Table 1. Capacitor Cell Catalog Numbering System

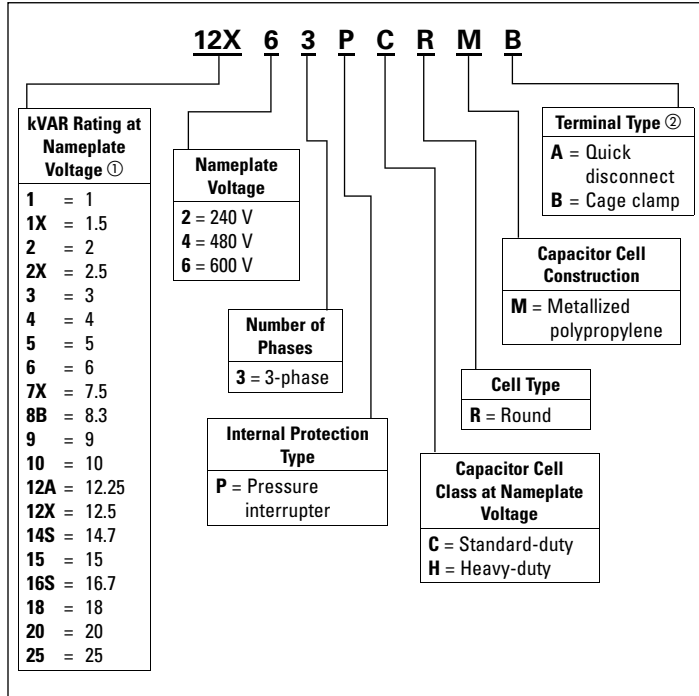

① Ratings are based on 60 Hz operation.

② Consult factory for terminal type on older cells.

Table 2. Heavy-Duty Capacitor Cell Chart

Nameplate Voltage	kVAR	Dimensions in Inches (mm)		Internal Voltage Rating	Weight in Lbs (kg)	Catalog Number
		D	H			
240	12.5	3.5 (89.5)	15.3 (388.0)	360	3.3 (1.5)	12X23PHRMB
480	15.0	3.5 (89.5)	12.3 (313.0)	525	2.6 (1.2)	1543PHRMB
480	16.7	3.5 (89.5)	15.3 (388.0)	600	3.3 (1.5)	16S43PHRMB
480	20.0	3.5 (89.5)	15.3 (388.0)	525	3.3 (1.5)	2043PHRMB
480	25.0	3.5 (89.5)	15.3 (388.0)	525	3.3 (1.5)	2543PHRMB
600	12.3	3.5 (89.5)	12.3 (313.0)	660	2.6 (1.2)	12A63PHRMB
600	14.7	3.5 (89.5)	15.3 (388.0)	660	3.3 (1.5)	14S63PHRMB
600	16.7	3.5 (89.5)	15.3 (388.0)	660	3.3 (1.5)	16S63PHRMB

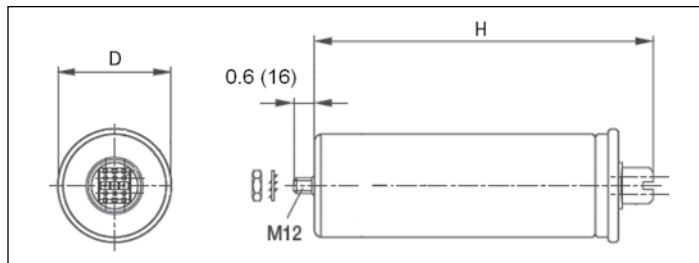

Figure 1. Capacitor Cell Dimensions in Inches (mm)

Table 3. Capacitor Cell Chart

Voltage	kVAR	Dimensions in Inches (mm)		Weight in Lbs (kg)	Catalog Number
		D	H		
240	1.5	3.1 (79.5)	7.9 (200.0)	1.1 (0.5)	643PCRMB
240	2	3.1 (79.5)	9.4 (238.0)	1.3 (0.6)	8B43PCRMB
240	2.5	3.1 (79.5)	9.4 (238.0)	1.3 (0.6)	1043PCRMB
240	3	3.5 (89.5)	9.4 (238.0)	1.8 (0.8)	12X43PCRMB
240	4	3.1 (79.5)	7.9 (200.0)	1.1 (0.5)	423PCRMB
240	5	3.5 (89.5)	12.3 (313.0)	2.6 (1.2)	2043PCRMB
240	6.3	3.1 (79.5)	9.4 (238.0)	1.3 (0.6)	6B23PCRMB
240	7.5	3.1 (79.5)	9.4 (238.0)	1.3 (0.6)	7X23PCRMB
240	8.3	3.5 (89.5)	9.4 (238.0)	3.3 (1.5)	8B23PCRMB
240	10	3.5 (89.5)	9.4 (238.0)	2.0 (0.9)	1023PCRMB
240	12.5	3.5 (89.5)	12.3 (313.0)	2.6 (1.2)	12X23PCRMB
240	15	3.5 (89.5)	12.3 (313.0)	2.6 (1.2)	1523PCRMB
480	1.5	2.1 (53.0)	5.0 (125.8)	0.7 (0.3)	1X43PCRMA
480	2	2.5 (63.5)	5.5 (140.8)	0.9 (0.4)	243PCRMA
480	2.5	2.5 (63.5)	5.5 (140.8)	0.9 (0.4)	2X43PCRMA
480	3	2.5 (63.5)	5.5 (140.8)	0.9 (0.4)	343PCRMA
480	4	2.5 (63.5)	6.5 (165.8)	0.9 (0.4)	443PCRMA
480	5	2.5 (63.5)	6.5 (165.8)	0.9 (0.4)	543PCRMA
480	6	3.1 (79.5)	7.9 (200.0)	1.1 (0.5)	643PCRMB
480	7.5	3.1 (79.5)	7.9 (200.0)	1.1 (0.5)	7X43PCRMB
480	8.3	3.1 (79.5)	9.4 (238.0)	1.3 (0.6)	8B43PCRMB
480	9	3.1 (79.5)	9.4 (238.0)	1.3 (0.6)	943PCRMB
480	10	3.1 (79.5)	9.4 (238.0)	1.3 (0.6)	1043PCRMB
480	12.5	3.5 (89.5)	9.4 (238.0)	1.8 (0.8)	12X43PCRMB
480	15	3.5 (89.5)	9.4 (238.0)	1.8 (0.8)	1543PCRMB
480	18	3.5 (89.5)	12.3 (313.0)	2.6 (1.2)	1843PCRMB
480	20	3.5 (89.5)	12.3 (313.0)	2.6 (1.2)	2043PCRMB
480	25	3.5 (89.5)	12.3 (313.0)	2.6 (1.2)	2543PCRMB
600	5	3.1 (79.5)	9.4 (238.0)	1.3 (0.6)	563PCRMB
600	7.5	3.1 (79.5)	9.4 (238.0)	1.3 (0.6)	7X63PCRMB
600	10	3.1 (79.5)	9.4 (238.0)	1.3 (0.6)	1063PCRMB
600	12.5	3.5 (89.5)	9.4 (238.0)	1.8 (0.8)	12X63PCRMB
600	15	3.5 (89.5)	12.3 (313.0)	2.6 (1.2)	1563PCRMB
600	17.5	3.5 (89.5)	12.3 (313.0)	2.6 (1.2)	17X63PCRMB
600	20	3.5 (89.5)	12.3 (313.0)	3.3 (1.5)	2063PCRMB
600	25	3.5 (89.5)	15.3 (388.0)	3.3 (1.5)	2563PCRMB

**Note:** kVAR rating standard. Standard kVAR tolerance is 0% to +5%. Part number shown is for three-phase units. Up to 5 kVAR at 480 V—quick disconnect terminals are standard. Above 5 kVAR at 480 V (and on all other voltages)—cage clamp terminals are standard.

## Unipump™ power factor correction capacitors



Unipump

### Product description

Non-fused capacitors for outdoor irrigation and oil field installations.

- Designed expressly for outdoor pumping applications
- Pole-mount or wall-mount
- Small, lightweight enclosure for easy installation
- SO-WA type flexible cable facilitates installation (4-conductor, 45-inch length from capacitor enclosure to end of wire)
- Gland-type weatherproof bushings
- Strong outer case
- UL 810 and CSA® C22.2 No. 190 Listed

### Applications

Outdoor irrigation, and oil and gas field pumping.

### Features and specifications

#### Configuration

- **Outer case:** Heavy, No. 14 gauge steel NEMA 3R enclosure finished with durable baked powder coat finish. Integral strap mounting bracket with keyhole at top for pole or wall installation; no knockouts
- **Unipump operating temperature:** –40 °F to +115 °F (–40 °C to +46 °C)
- **Unipump storage temperature:** –40 °F to +131 °F (–40 °C to +55 °C)
- **Pressure-sensitive interrupter:** Built-in UL recognized three-phase pressure-sensitive interrupter, and thermally or mechanically activated disconnecting link removes capacitor from the supply before dangerous pressure buildup or excessive fault current occurs. Bulged capacitor cell top provides easy visual indication of interrupter operation

Table 4. Unipump Catalog Numbering System

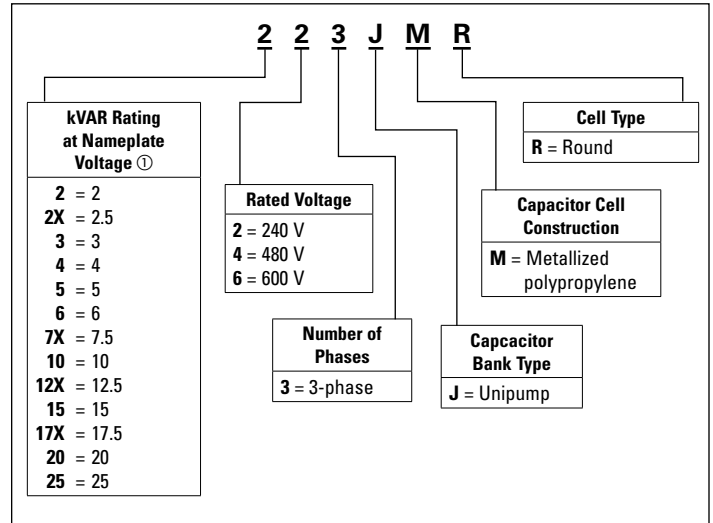

① Ratings are based on 60 Hz operation.



## Unipak™ low voltage fixed capacitor banks



Unipak—A2 enclosure



Unipak interior—E1 enclosure

### Features, benefits and functions

- Two-year warranty on capacitor cells (units with standard-duty cells)
- Five-year warranty on capacitor cells (units with heavy-duty cells)
- Indoor/outdoor service
- Wall-mount (up to C2) and floor-mounted units available
- Short lead-times
- Slim profile allows reduced footprint, conserving valuable floor space

### Standards and certifications

- UL 810 and CSA C.22.2 No.190 Listed

### Features and specifications

- **Outer enclosure:** Heavy, No. 14 gauge steel finished with durable baked powder coat finish. Wall-mounting flanges and floor-mounting feet. Elimination of knockouts permits indoor/outdoor use. Manufactured to NEMA 1 and 3R requirements
- Elevated floor-mounting feet allow access for easy maintenance
- **Cover:** "L" shaped gasketed cover with multiple fasteners provides front opening for ease of installation and service
- **Unipak operating temperature:** -40 °F to +115 °F (-40 °C to +46 °C)
- **Unipak storage temperature:** -40 °F to +131 °F (-40 °C to +55 °C)
- **Power and ground terminal lugs:** Furnished inside enclosure
- **Pressure-sensitive interrupter:** All units have built-in UL recognized pressure-sensitive interrupter, and thermally or mechanically activated disconnecting link removes capacitor from the supply before dangerous pressure buildup or excessive fault current occurs. Bulged capacitor cell top provides easy visual indication of interrupter operation
- **Standard fusing:**
  - **Size Code A1:** Three midget-type fuses with 100,000 A interrupting capacity
  - **Size Code A2 and larger:** Slotted-blade type fuses with 200,000 A interrupting capacity; fuses mounted on stand-off bushings; solderless connectors for easy hookup of incoming line conductors
  - **Fuse indicating lights:** Red, neon cleared-fuse indicating lights are protected by transparent weatherproof guard
- **Options:**
  - Non-fused units available, selected sizes
  - Heavy-duty capacitor cells, selected sizes

**Table 7. Unipak Capacitor Bank Catalog Numbering System**

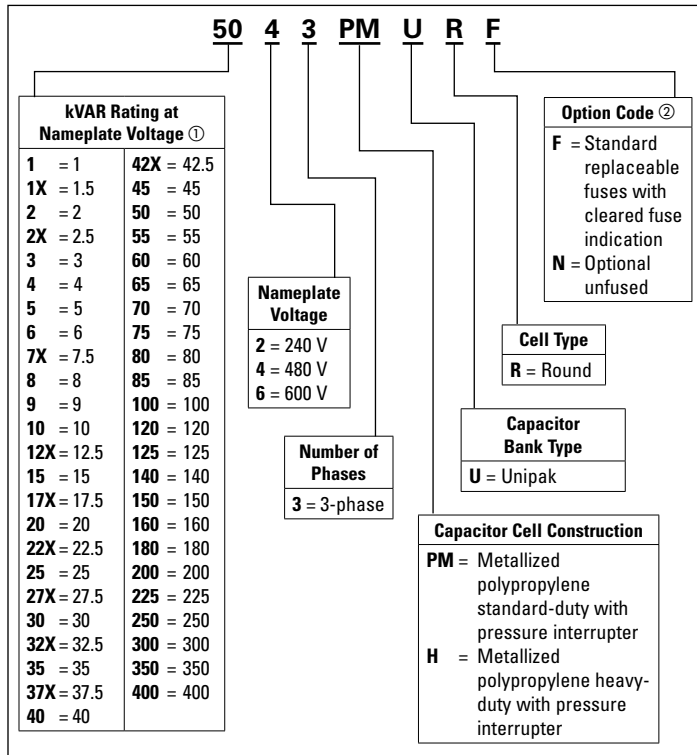

① Ratings are based on 60 Hz operation.

② Standard units have replaceable fuses with cleared fuse indication. Unfused units are intended for use with upstream overcurrent protection, as in the case of motor-connected capacitors.

**Table 8. 240 Vac Unipak Selection Chart**

kVAR	Rated Current (Amperes)	Enclosure	Shipping Weight in Lbs (kg)	Catalog Number
1	2.4	A1	18 (8)	123PMURF
1.5	3.6	A1	18 (8)	1X23PMURF
2	4.8	A1	19 (9)	223PMURF
2.5	6	A1	19 (9)	2X23PMURF
3	7.2	A1	19 (9)	323PMURF
4	9.6	A1	20 (9)	423PMURF
5	12	A2	29 (13)	523PMURF
6	14.4	A2	29 (13)	623PMURF
7.5	18	A2	30 (14)	7X23PMURF
8	19.2	A2	31 (14)	823PMURF
10	24	A2	31 (14)	1023PMURF
12.5	30	A2	32 (14)	12X23PMURF
15	36	A2	33 (15)	1523PMURF
17.5	42	B1	44 (20)	17X23PMURF
20	48	B1	45 (20)	2023PMURF
22.5	54	B1	46 (21)	22X23PMURF
25	60	B1	46 (21)	2523PMURF
30	72	B1	47 (21)	3023PMURF
32.5	78	C1	47 (22)	32X23PMURF
35	84	C1	48 (22)	3523PMURF
37.5	90	C1	60 (27)	37X23PMURF
40	96	C1	64 (29)	4023PMURF
42.5	102	C1	65 (30)	42X23PMURF
45	108	C1	66 (30)	4523PMURF
50	120	C1	68 (31)	5023PMURF
60	144	C1	69 (31)	6023PMURF
70	168	C2	99 (45)	7023PMURF
75	180	C2	100 (46)	7523PMURF
80	192	C2	101 (46)	8023PMURF
90	216	C2	103 (47)	9023PMURF
100	240	D1	104 (47)	10023PMURF
120	288	D1	133 (60)	12023PMURF
140	336	E1	137 (62)	14023PMURF
150	360	E1	140 (64)	15023PMURF
160	384	E1	175 (80)	16023PMURF
180	432	E1	182 (83)	18023PMURF
200	480	E1	189 (86)	20023PMURF

**Notes:** Multiply the 240 Vac kVAR rating by 0.75 to calculate the kVAR value at 208 Vac. For dimensional information, refer to **Pages 12 to 15**.

Unfused units available up to 50 kVAR at 240 V.

Ratings based on 60 Hz operation.

**Table 9. 480 Vac Unipak Selection Chart**

kVAR	Rated Current (Amperes)	Enclosure	Shipping Weight in Lbs (kg)	Catalog Number
1.5	1.8	A1	17 (8)	1X43PMURF
2	2.4	A1	18 (8)	243PMURF
2.5	3	A1	18 (8)	2X43PMURF
3	3.6	A1	19 (9)	343PMURF
4	4.8	A1	19 (9)	443PMURF
5	6	A1	19 (9)	543PMURF
6	7.2	A1	19 (9)	643PMURF
7.5	9	A1	20 (9)	7X43PMURF
8	9.6	A1	20 (9)	843PMURF
9	10.8	A1	20 (9)	943PMURF
10	12	A1	20 (9)	1043PMURF
12.5	15	A2	29 (13)	12X43PMURF
15	18	A2	29 (13)	1543PMURF
17.5	21	A2	30 (14)	17X43PMURF
20	24	A2	31 (14)	2043PMURF
22.5	27	B1	44 (20)	22X43PMURF
25	30	A2	32 (15)	2543PMURF
27.5	33	B1	44 (20)	27X43PMURF
30	36	B1	44 (20)	3043PMURF
32.5	39	B1	45 (20)	32X43PMURF
35	42	B1	45 (20)	3543PMURF
37.5	45	B1	46 (21)	37X43PMURF
40	48	B1	46 (21)	4043PMURF
42.5	51	B1	47 (21)	42X43PMURF
45	54	B1	47 (22)	4543PMURF
50	60	B1	48 (22)	5043PMURF
55	66	C1	48 (22)	5543PMURF
60	72	C1	48 (22)	6043PMURF
65	78	C1	64 (29)	6543PMURF
70	84	C1	65 (30)	7043PMURF
75	90	C1	65 (30)	7543PMURF
80	96	C1	66 (30)	8043PMURF
85	102	C1	68 (31)	8543PMURF
90	108	C1	68 (31)	9043PMURF
100	120	C1	69 (31)	10043PMURF
120	144	C2	69 (31)	12043PMURF
125	150	C2	99 (45)	12543PMURF
140	168	C2	100 (46)	14043PMURF
150	180	C2	101 (46)	15043PMURF
160	192	D1	103 (47)	16043PMURF
180	216	D1	104 (47)	18043PMURF
200	240	D1	137 (62)	20043PMURF
225	270	D1	140 (64)	22543PMURF
250	300	E1	170 (77)	25043PMURF
300	360	E1	175 (80)	30043PMURF
350	420	E1	182 (83)	35043PMURF
400	480	E1	189 (86)	40043PMURF

**Notes:** For dimensional information, refer to **Pages 12 to 15**.

Unfused units available up to 100 kVAR at 480 V.

480 V units above 50 kVAR have 525 V capacitor cells.

Ratings based on 60 Hz operation.

**Table 10. 600 Vac Unipak Selection Chart**

kVAR	Rated Current (Amperes)	Enclosure	Shipping Weight in Lbs (kg)	Catalog Number
5	4.9	A1	19 (9)	563PMURF
7.5	7.4	A1	19 (9)	7X63PMURF
10	9.8	A1	20 (9)	1063PMURF
12.5	12.3	A1	20 (9)	12X63PMURF
15	14.7	A2	29 (13)	1563PMURF
17.5	17.2	A2	29 (13)	17X63PMURF
20	19.6	A2	30 (14)	2063PMURF
22.5	22.1	B1	44 (20)	22X63PMURF
25	24.5	B1	31 (14)	2563PMURF
27.5	27.0	B1	44 (20)	27X63PMURF
30	29.4	B1	45 (20)	3063PMURF
32.5	31.9	B1	45 (20)	32X63PMURF
35	34.3	B1	46 (21)	3563PMURF
37.5	36.8	B1	46 (21)	37X63PMURF
40	39.2	B1	47 (21)	4063PMURF
42.5	41.7	B1	47 (22)	42X63PMURF
45	44.1	B1	48 (22)	4563PMURF
50	49.0	B1	48 (22)	5063PMURF
55	53.9	C1	64 (29)	5563PMURF
60	58.8	C1	64 (29)	6063PMURF
65	63.7	C1	65 (30)	6563PMURF
70	68.6	C1	65 (30)	7063PMURF
75	73.5	C1	66 (30)	7563PMURF
80	78.4	C1	68 (31)	8063PMURF
85	83.3	C1	68 (31)	8563PMURF
90	88.2	C1	69 (31)	9063PMURF
100	98.0	C1	69 (31)	10063PMURF
120	117.6	C2	99 (45)	12063PMURF
125	122.5	C2	100 (46)	12563PMURF
140	137.2	C2	101 (46)	14063PMURF
150	147.0	C2	103 (47)	15063PMURF
160	156.8	D1	135 (61)	16063PMURF
180	176.4	D1	137 (62)	18063PMURF
200	196.0	D1	140 (64)	20063PMURF
225	220.5	D1	143 (65)	22563PMURF
250	245.0	E1	170 (77)	25063PMURF
300	294.0	E1	175 (80)	30063PMURF
350	343.0	E1	182 (83)	35063PMURF
400	392.0	E1	189 (86)	40063PMURF

**Notes:** For dimensional information, refer to **Pages 12 to 15**.

Unfused units available up to 100 kVAR at 600 V.

Ratings based on 60 Hz operation.



### Unipak with heavy-duty capacitor cells

- Standard fixed capacitor systems using heavy-duty capacitor cells
- For use in moderate harmonic environments where engineering evaluation allows in place of detuned filter designs
- Provides future conversion capability into a detuned filter system when required by facility growth or increased nonlinear load levels

**Table 11. Low Voltage Fixed Capacitor Systems with Heavy-Duty Cells**

kVAR	Rated Current (Amperes)	Case Size	Shipping Weight in Lbs (kg)	Catalog Number
<b>240 V</b>				
15	36	B1	38.4 (17)	<b>1523HURF</b>
25	60	B1	38.4 (17)	<b>2523HURF</b>
30	72	C1	55.2 (25)	<b>3023HURF</b>
50	120	C1	57.6 (26)	<b>5023HURF</b>
60	144	C2	100.8 (46)	<b>6023HURF</b>
75	180	C2	104.4 (47)	<b>7523HURF</b>
100	240	D1	136.8 (62)	<b>10023HURF</b>
125	300	E1	189.6 (86)	<b>12523HURF</b>
<b>480 V</b>				
15	18	B1	25.2 (11)	<b>1543HURF</b>
25	30	B1	37.2 (17)	<b>2543HURF</b>
30	36	B1	38.4 (17)	<b>3043HURF</b>
50	60	C1	39.6 (18)	<b>5043HURF</b>
60	72	C1	52.8 (24)	<b>6043HURF</b>
75	90	C2	55.2 (25)	<b>7543HURF</b>
100	120	C2	57.6 (26)	<b>10043HURF</b>
125	150	D1	100.8 (46)	<b>12543HURF</b>
150	180	D1	104.4 (47)	<b>15043HURF</b>
200	240	E1	136.8 (62)	<b>20043HURF</b>
250	300	E1	186.0 (84)	<b>25043HURF</b>
<b>600 V</b>				
15	14.7	B1	37.2 (17)	<b>1563HURF</b>
25	24.5	B1	38.4 (17)	<b>2563HURF</b>
30	29.4	B1	39.6 (18)	<b>3063HURF</b>
50	49	C1	55.2 (25)	<b>5063HURF</b>
60	58.8	C1	57.6 (26)	<b>6063HURF</b>
75	73.5	C2	100.8 (46)	<b>7563HURF</b>
100	98	C2	104.4 (47)	<b>10063HURF</b>
125	122.5	D1	136.8 (62)	<b>12563HURF</b>
150	147	D1	136.8 (62)	<b>15063HURF</b>
200	196	E1	186.0 (84)	<b>20063HURF</b>
250	245	E1	189.6 (86)	<b>25063HURF</b>

**Notes:** For dimensional information, refer to **Pages 13 to 15**.  
Contact factory for availability of unfused units.

**Table 12. Replacement Fuse Chart**

kVAR Ratings			Fuse Amperes	Eaton Fuse Part Number
240 V	480 V	600 V		
Under 6	Under 11	Under 15	N/A	Contact TRC ①
6	N/A	15.00	35	<b>SP030217-0031A</b>
7.5 and 8	11 to 15	17.5 and 20	50	<b>SP030217-0031B</b>
9 to 11	17.5 and 20	22.5 to 27.5	60	<b>SP030217-0031C</b>
12.5	22.5 to 27.5	30 to 35	80	<b>SP030217-0031D</b>
15 and 17.5	30 to 35	37.5 to 42.5	100	<b>SP030217-0031E</b>
20	37.5 to 42.5	45 to 52.5	125	<b>SP030217-0031F</b>
22.5 and 25	45 to 52.5	55 to 65	150	<b>SP030217-0031G</b>
27.5	55	70	175	<b>SP030217-0031H</b>
30 to 32.5	60 to 70	75 to 85	200	<b>SP030217-0031J</b>
35 to 42.5	75 to 85	90 and 100	250	<b>SP030217-0031K</b>
45 to 50	90 to 100	120	300	<b>SP030217-0031L</b>
Over 60	Over 100	Over 120	N/A	Contact TRC ①

① Contact Eaton's Technical Resource Center (TRC) Power Factor Application Engineers at 1-800-809-2772, choose option #4, then option #2, for additional information and pricing.

**Note:** Replacement fuses also available from your local electrical distributor. For fuse sizes from 4 A to 30 A, ask for part number BUSS KTK (fuse ampere). For fuse sizes from 35 A to 300 A, ask for part number BUSS KBC (fuse ampere).

### Unipak low voltage fixed detuned filters

- Detuned filter systems for low voltage, heavy-duty applications
- Correct power factor in high harmonic environments
- Two-enclosure design isolates capacitors from high-temperature operating reactors and allows for flexible installation
- Five-year cell warranty / one-year reactor warranty
- Three-phase cell capacitor construction
- UL 508A and CSA C22.2 No. 190 Listed

#### Applications

Designed for power factor correction in plants with high amounts of nonlinear loads.

#### Standard features

- **Enclosures:** Standard NEMA 1 enclosures have durable baked powder coat finish
- **Unipak detuned filter operating temperature:** -40 °F to +115 °F (-40 °C to +46 °C)
- **Unipak detuned filter storage temperature:** -40 °F to +131 °F (-40 °C to +55 °C)
- **Power and ground terminal lugs:** Furnished inside enclosures

#### Reactors

- **Detuning:** Standard reactor designs are detuned to the 4.2nd harmonic and recommended to protect capacitors against harmonic resonance. Detuning to other harmonics is available as an option. The harmonic spectrum should be evaluated for applications involving reactors tuned above the 4.2nd harmonic to ensure optimal equipment life, specifically when used in conjunction with six-pulse motor drives
- **Construction:** 100% copper windings for cool operating temperatures; designed operating temperature rise less than 80 °C. Open frame construction with 220 °C insulation system
- **Thermal sensors:** One per phase, self-resetting thermal switches provide reactor overtemperature protection and indication
- **Reactor indicating light:** Thermal overload indicating light activates when reactor temperature reaches 180 °C
- **Fuses:** Standard fusing with cleared fuse indication

Table 13. Unipak Detuned Filter Catalog Numbering System

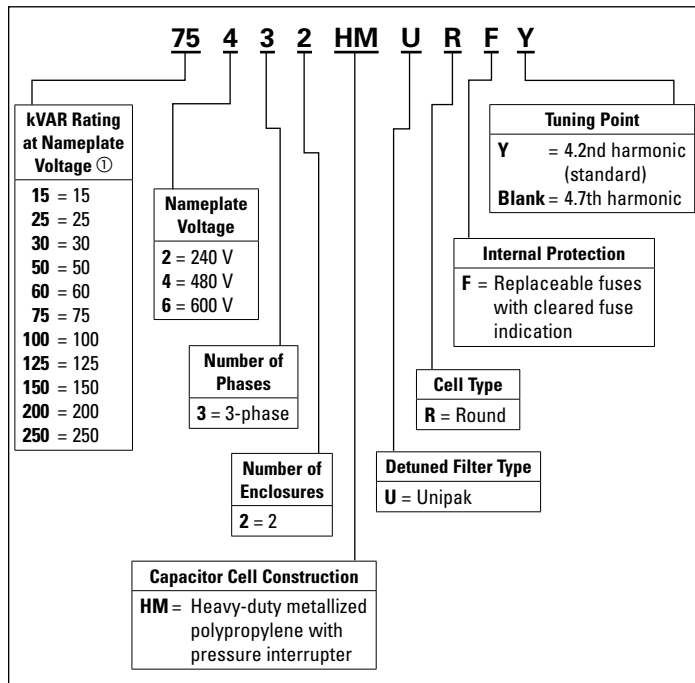

① Units are designed for 60 Hz operation. Consult factory for other frequencies.

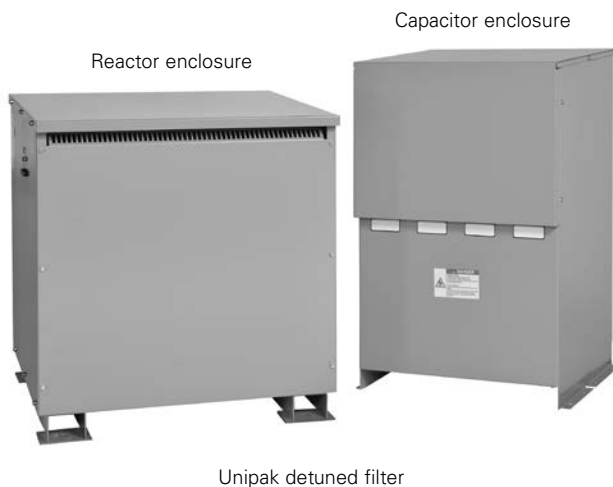

**Table 14. Fixed Unipak Detuned Filters**

kVAR	Rated Current (Amperes)	Capacitor Enclosure Size	Shipping Weight in Lbs (kg)	Reactor Enclosure Case Size	Reactor Shipping Weight in Lbs (kg)	Combined Shipping Weight in Lbs (kg)	Catalog Number
<b>240 V</b>							
15	36	B1	48.4 (22.0)	R	90.0 (40.9)	138.4 (62.8)	15232HMURFY
25	60	B1	48.4 (22.0)	R	105.0 (47.7)	153.4 (69.6)	25232HMURFY
30	72	C1	65.2 (29.6)	R	110.0 (49.9)	175.2 (79.5)	30232HMURFY
50	120	C1	67.6 (30.7)	R	130.0 (59.0)	197.6 (89.7)	50232HMURFY
60	144	C2	110.8 (50.3)	R	160.0 (72.6)	270.8 (122.9)	60232HMURFY
75	180	C2	114.4 (51.9)	R	185.0 (84.0)	299.4 (135.9)	75232HMURFY
100	240	D1	146.8 (66.6)	R	240.0 (109.0)	386.8 (175.6)	100232HMURFY
125	300	E1	199.6 (90.6)	S	280.0 (127.1)	479.6 (217.7)	125232HMURFY
150	360	E1	220.0 (99.9)	S	280.0 (127.1)	500.0 (227.0)	150232HMURFY
<b>480 V</b>							
15	18	B1	35.2 (16.0)	R	90.0 (40.9)	125.2 (56.8)	15432HMURFY
25	30	B1	47.2 (21.4)	R	105.0 (47.7)	152.2 (69.1)	25432HMURFY
30	36	B1	48.4 (22.0)	R	110.0 (49.9)	158.4 (71.9)	30432HMURFY
50	60	C1	49.6 (22.5)	R	130.0 (59.0)	179.6 (81.5)	50432HMURFY
60	72	C1	62.8 (28.5)	R	160.0 (72.6)	222.8 (101.2)	60432HMURFY
75	90	C2	65.2 (29.6)	R	185.0 (84.0)	250.2 (113.6)	75432HMURFY
100	120	C2	67.6 (30.7)	R	240.0 (109.0)	307.6 (139.7)	100432HMURFY
125	150	D1	110.8 (50.3)	R	280.0 (127.1)	390.8 (177.4)	125432HMURFY
150	180	D1	114.4 (51.9)	S	280.0 (127.1)	394.4 (179.1)	150432HMURFY
200	240	E1	146.8 (66.6)	S	330.0 (149.8)	476.8 (216.5)	200432HMURFY
250	300	E1	196.0 (89.0)	T	570.0 (258.8)	766.0 (347.8)	250432HMURFY
<b>600 V</b>							
15	14.7	B1	47.2 (21.4)	R	90.0 (40.9)	137.2 (62.3)	15632HMURFY
25	24.5	B1	48.4 (22.0)	R	90.0 (47.7)	153.4 (69.6)	25632HMURFY
30	29.4	B1	49.6 (22.5)	R	105.0 (49.9)	159.6 (72.5)	30632HMURFY
50	49	C1	65.2 (29.6)	R	110.0 (59.0)	195.2 (88.6)	50632HMURFY
60	58.8	C1	67.6 (30.7)	R	130.0 (72.6)	227.6 (103.3)	60632HMURFY
75	73.5	C2	110.8 (50.3)	R	160.0 (84.0)	295.8 (134.3)	75632HMURFY
100	98	C2	114.4 (51.9)	R	185.0 (109.0)	354.4 (160.9)	100632HMURFY
150	147	D1	146.8 (66.6)	S	280.0 (127.1)	426.8 (193.8)	150632HMURFY
200	196	E1	196.0 (89.0)	T	330.0 (149.8)	526.0 (238.8)	200632HMURFY
250	245	E1	199.6 (90.6)	T	570.0 (258.8)	769.6 (349.4)	250632HMURFY

**Note:** Other ratings available, please consult factory.

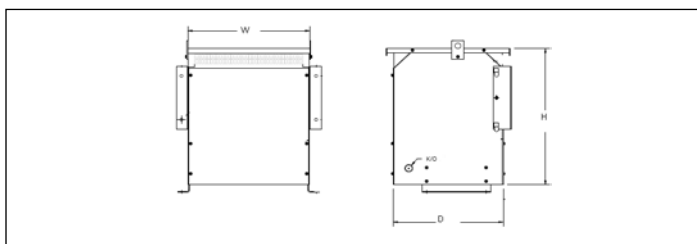

**Figure 3. Reactor Cabinet**

**Table 15. Reactor Cabinet Dimensions in Inches (mm)**

	Height	Width	Depth
R	20.50 (520.7)	20.50 (520.7)	20.75 (527.1)
S	24.50 (622.3)	24.50 (622.3)	22.00 (558.8)
T	32.00 (812.8)	30.75 (781.1)	27.75 (704.9)

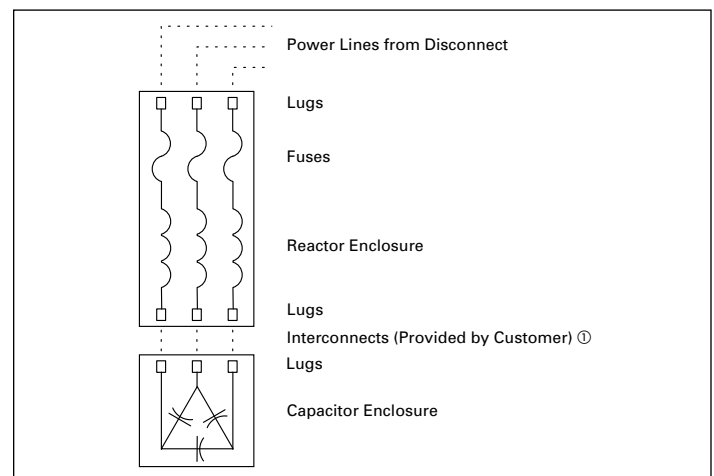

**Figure 4. Filter Schematic with Wiring Interconnects**

① Refer to NEC.

Low voltage fixed capacitor banks and fixed detuned filters—dimensions in inches (mm)

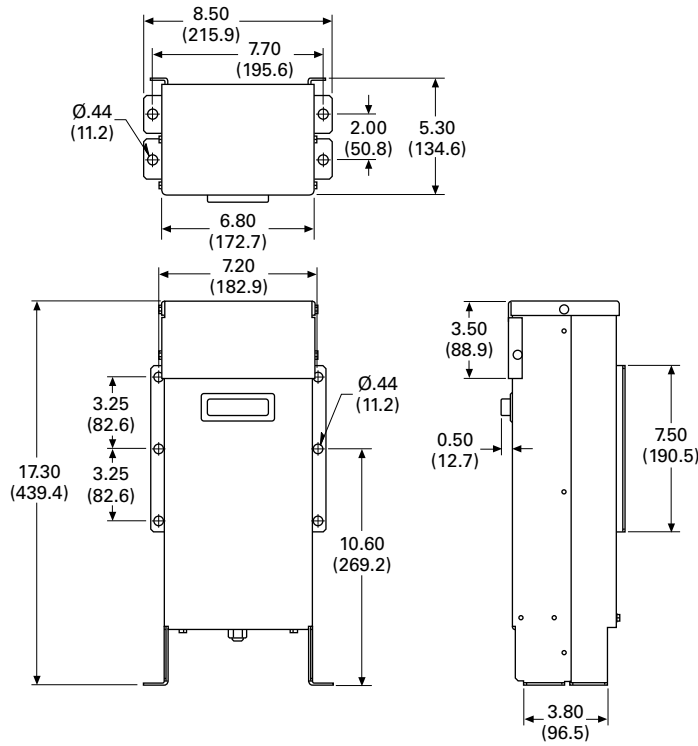

Figure 5. Case A1

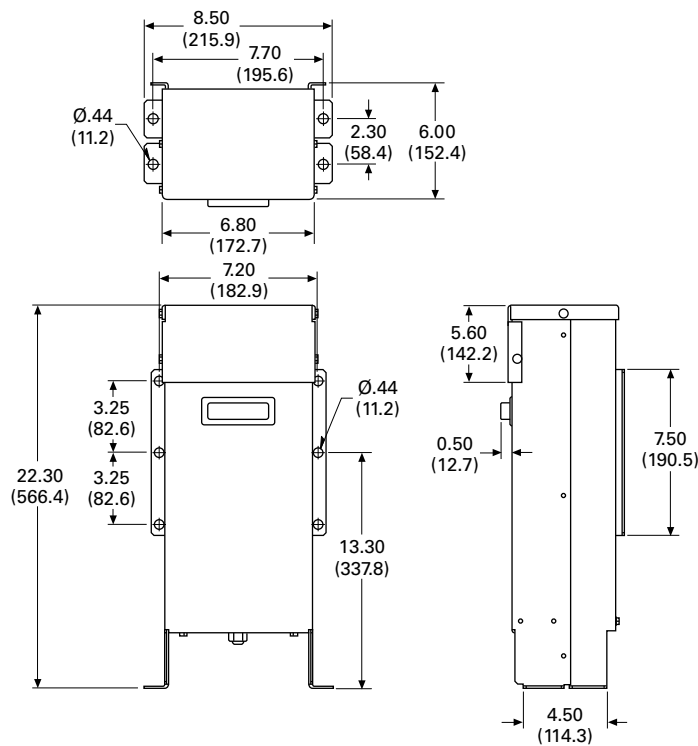

Figure 6. Case A2

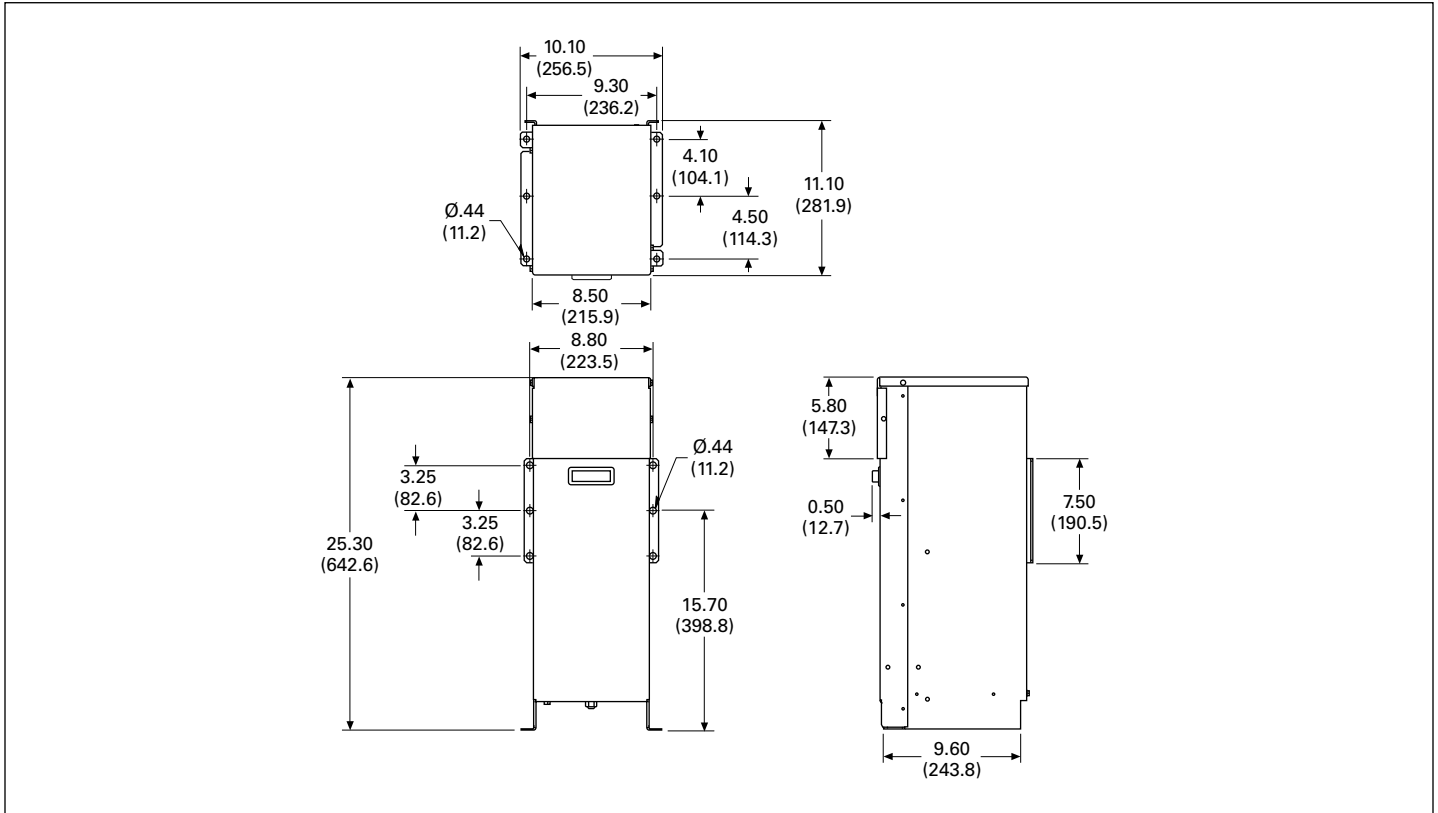

Figure 7. Case B1

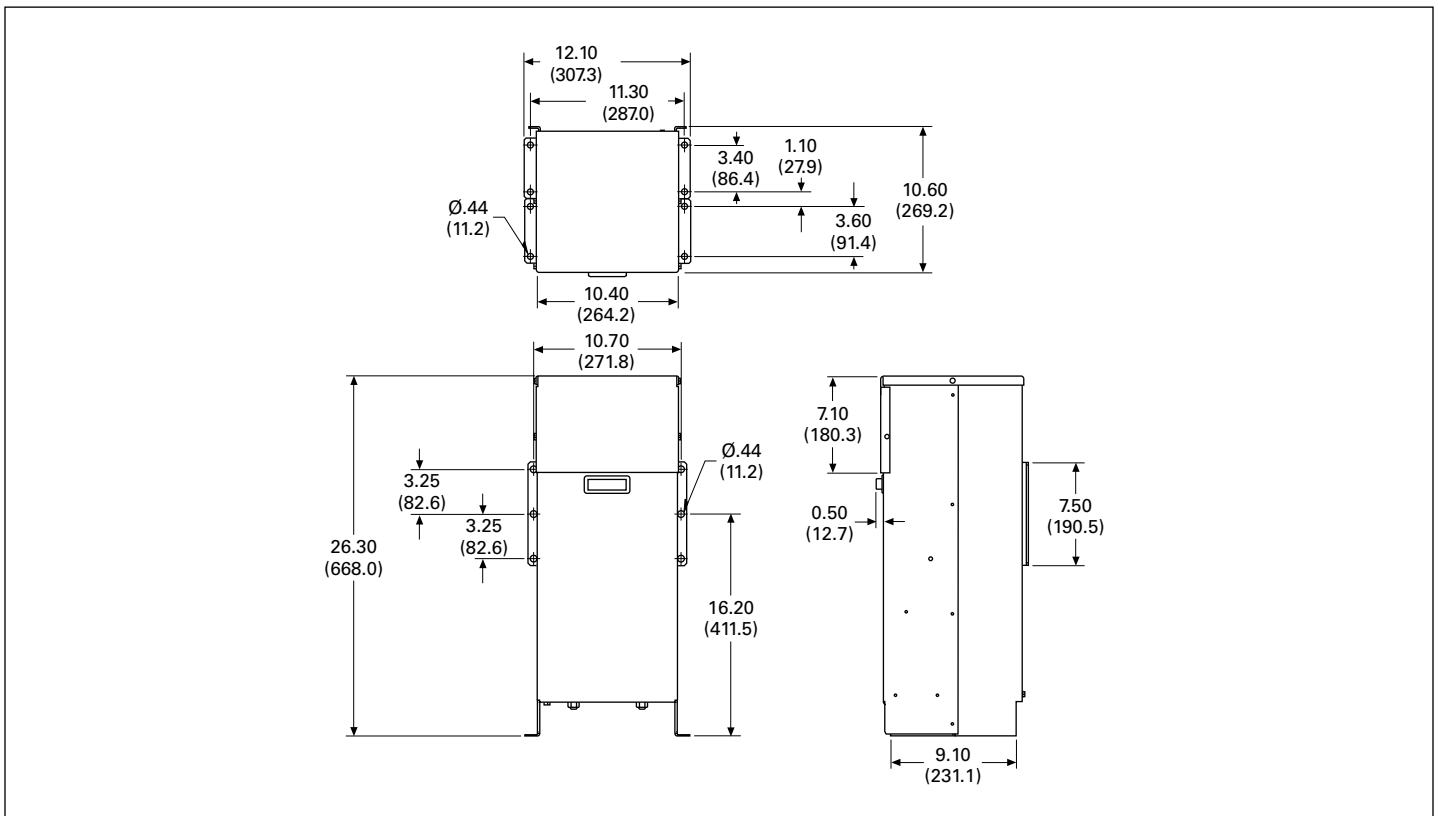

Figure 8. Case C1

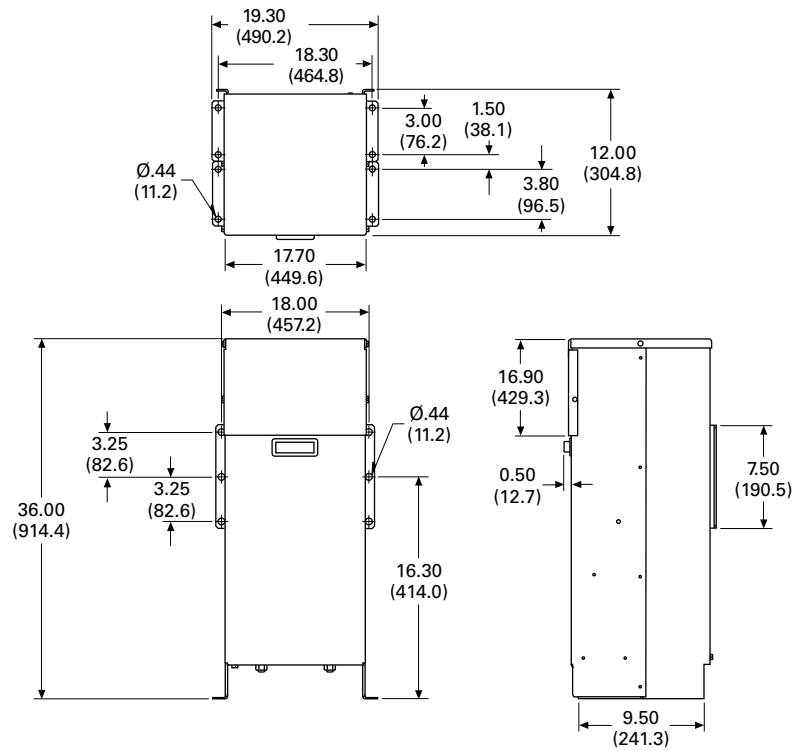

Figure 9. Case C2

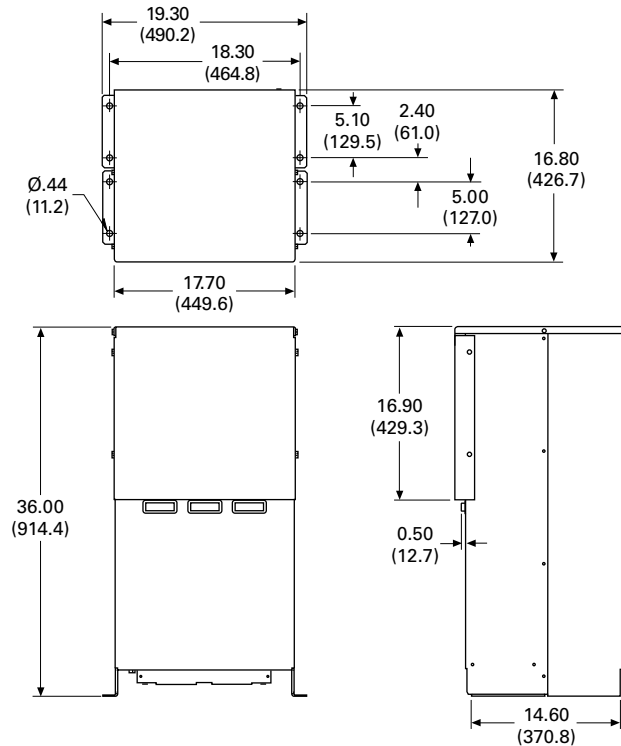

Figure 10. Case D1

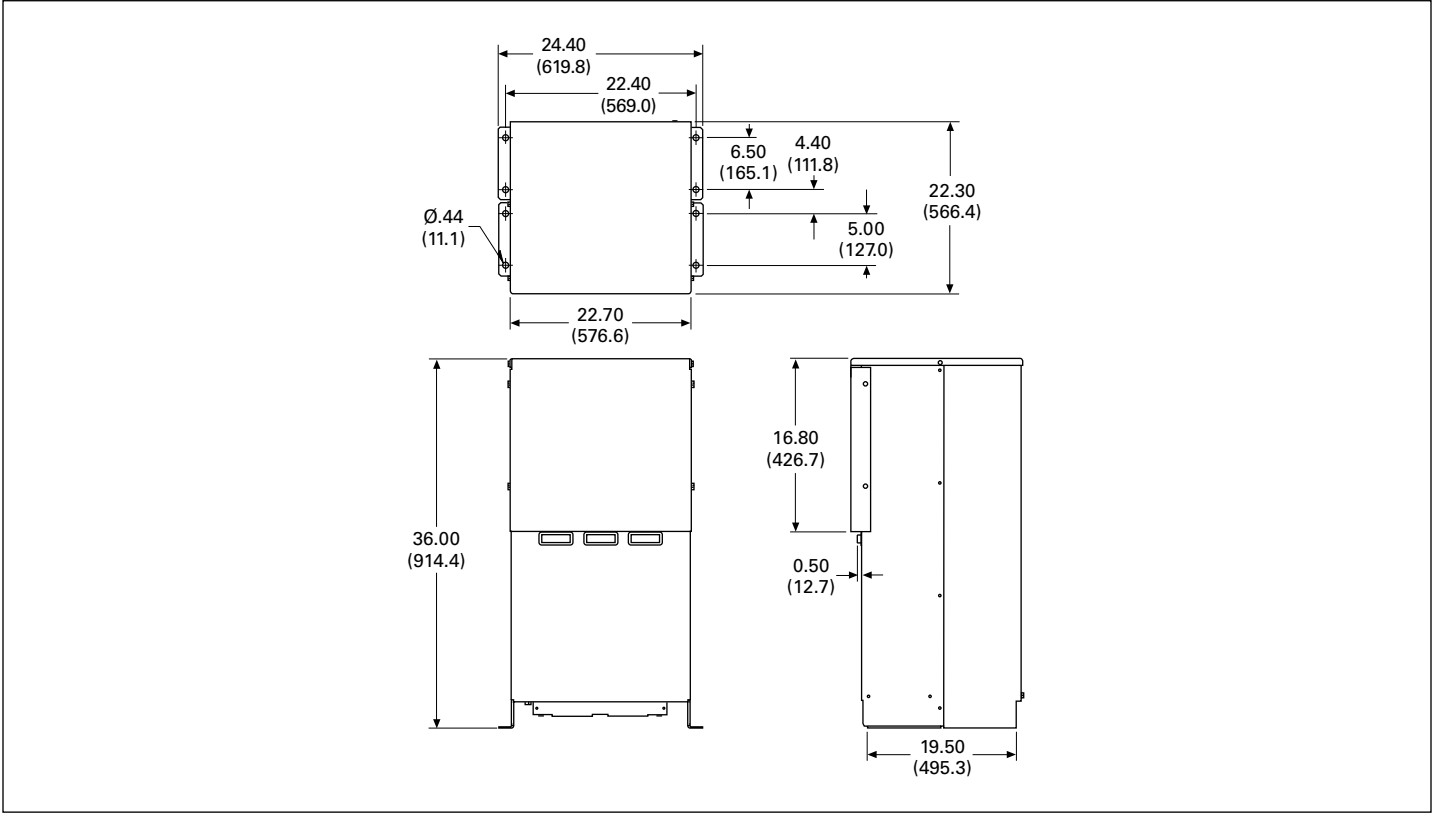

Figure 11. Case E1

For product support, please contact Eaton's  
Technical Resource Center (TRC) power factor  
application engineers at **1-800-809-2772**,  
choose option #4, then option #2.  
**pfc@eaton.com**

**Eaton**  
1000 Eaton Boulevard  
Cleveland, OH 44122  
United States  
Eaton.com

© 2014 Eaton  
All Rights Reserved  
Printed in USA  
Publication No. TD026001EN / Z15685  
September 2014