

833 / 834 SERIES

WATERTIGHT GENERAL ALARM CONTACT MARKER

Installation & Wiring Information

IF LBL1502

SAVE THESE INSTRUCTIONS FOR FUTURE REFERENCE

CAUTION Read carefully before installing and wiring the receptacle. Any warning or special instructions should be closely followed. Check the ratings to insure suitability for the environment & supply. Must be installed in accordance with the NEC or CEC and all other applicable codes. All receptacles must be properly grounded. These devices are not suitable for hazardous locations.

These devices are not provided with cable entry holes. All holes added should be done by experienced personnel through the thickened areas of the junction box suitable for threading. Keep tightly closed when in operation. Do not attempt to install this receptacle unless you are familiar with warnings, cautions and procedures outlined in this information sheet.

INSTALLATION & ELECTRICAL WIRING

WARNING Risk of electrical shock hazard, only qualified personnel should conduct this procedure!

Do not make electrical connections with the power ON. Apply lubricant to all screws and threads during installation, failure to use can result in voiding warranty.

1. Locate and drill cable gland hole through the thickened area of the junction box (0A) per instructions furnished with cable gland (not provided). Clean all foreign material out of junction box.
2. Mount the junction box (0A) in its intended location using min. 1/4" bolts (not provided). See illustration below for mounting dimensions.
3. Cables should be stripped back approx. 6" - 10" to allow individual wires to flex.
4. Install cable gland (not provided) to junction box (0A) per instructions furnished with cable gland.
5. Route cable in through cable gland and secure seal on cable jacket.

CAUTION See switch label for voltage and current ratings.

6. Using connectors, connect L1 - IN lead to terminal F (833) or 12 (834). See switch diagram below.
7. Connect L1 - OUT lead to terminal G (833) or 13 (834).
8. Connect L2 - IN lead to terminal B (833) or 16 (834).
9. Connect L2 - OUT lead to terminal C (833) or 17 (834).
10. Connect Green or earth wire to Ground screw (4B).
11. Slip gasket (7A) over cover (1A) so it can be installed between the cover and junction box (0A).
12. Mount cover (1A) with #10 screws (9A) and washers (9B) provided. Torque #10 screws only enough to insure a good gasket seal (approx. 10-20 in.lbs).

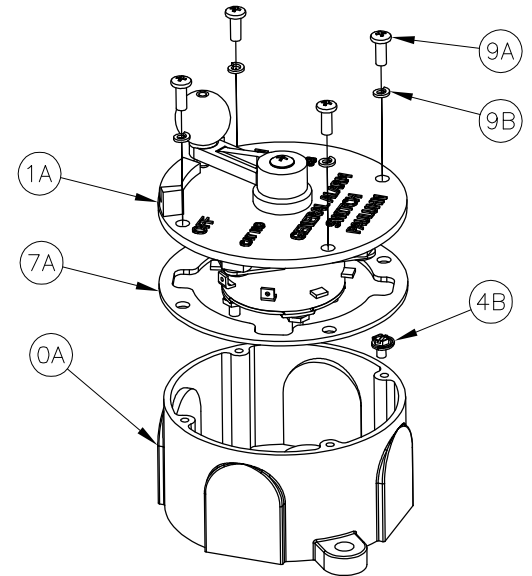

OPERATION:

To energize switch circuit, rotate the lever (1C) clockwise and depress the knob (1D) to engage the retaining pin against the stop wall, to lock in the "ON" position. To de-energize the switch, pull the knob (1D) and allow spring loaded switch to rotate counter-clockwise to the "OFF" position.

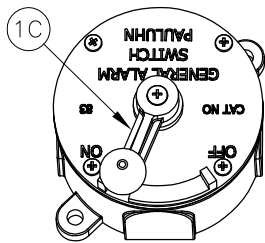

"ON" POSITION

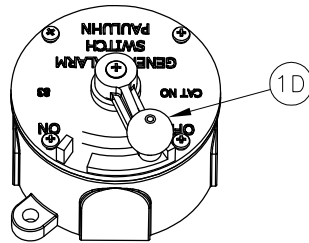

"OFF" POSITION

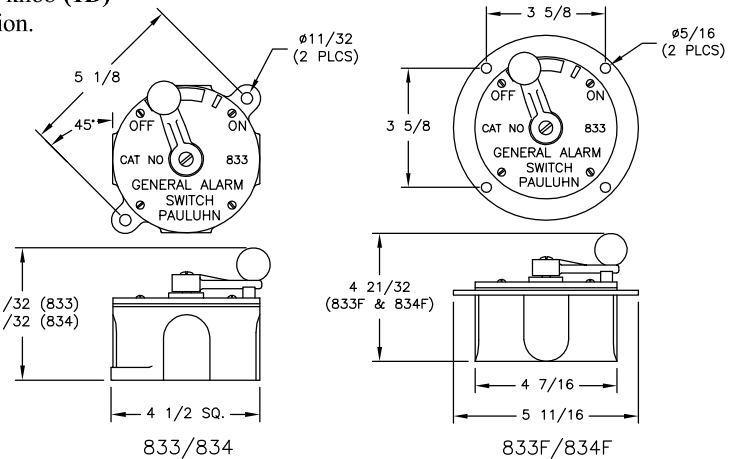

833/834

833F/834F

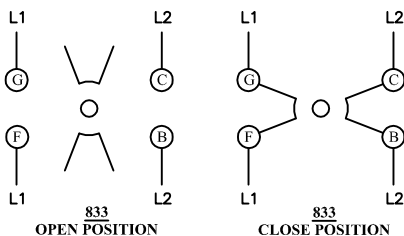

833 OPEN POSITION

833 CLOSE POSITION

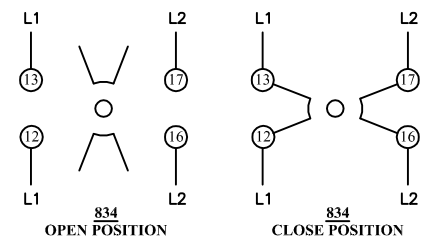
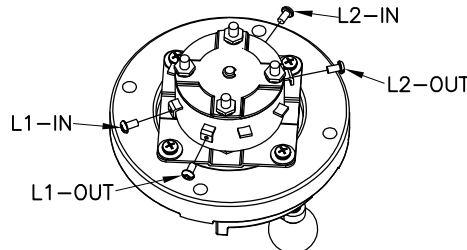

834 OPEN POSITION

834 CLOSE POSITION

All statements, technical information and recommendations contained herein are based on information and tests we believe to be reliable. The accuracy or completeness thereof are not guaranteed. In accordance with Crouse-Hinds "Terms and Conditions of Sale", and since conditions of use are outside our control, the purchaser should determine the suitability of the product for his intended use and assumes all risk and liability whatsoever in connection therewith.