

## PowerWave 2 Branch circuit monitoring



# PowerWave 2 branch circuit monitoring



PowerWave® 2 branch circuit monitoring is a busway metering system that provides revenue-grade metering accuracy and real-time insights from connected power equipment. PowerWave 2 branch circuit monitoring provides a quick plug-and-play installation, intuitive integration with building management system (BMS), and is scalable to accommodate facilities' reconfigurations or expansions.

### Features and benefits

The monitoring system ships complete and ready for installation from the manufacturing facility. Each tap-off box ships complete with current transformers (CTs) and meters pre-installed and calibrated. Each end feed ships complete with meters, voltage sensing, and CTs ready to be installed on the landing cables.

- Revenue-grade accuracy
- Class 0.5 system accuracy (ANSI C12.20 and IEC 61557-12)
- RJ45 daisy chain plug-and-play installation
- Breaker status monitor (on/off)
- Robust (no exposed PCBs)
- Engineered-to-order with fast market lead time
- Seamless BMS Integration with multiple communication protocols: Modbus® RTU/TCP, BACnet/IP and SNMPv1, v2, v3

# EATON

Powering Business Worldwide

## Meter components

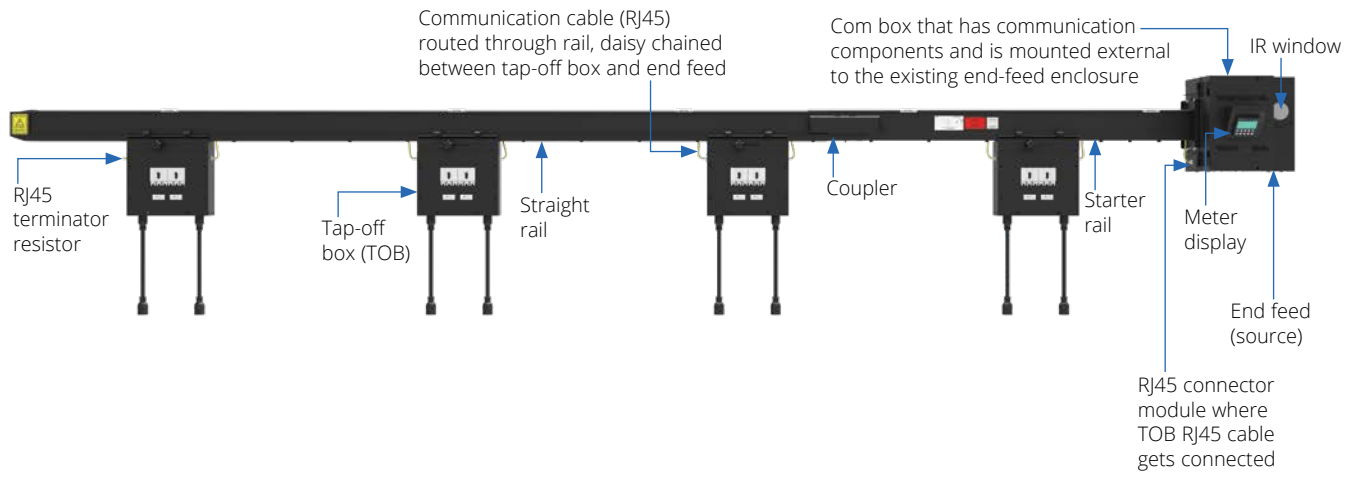

Front view

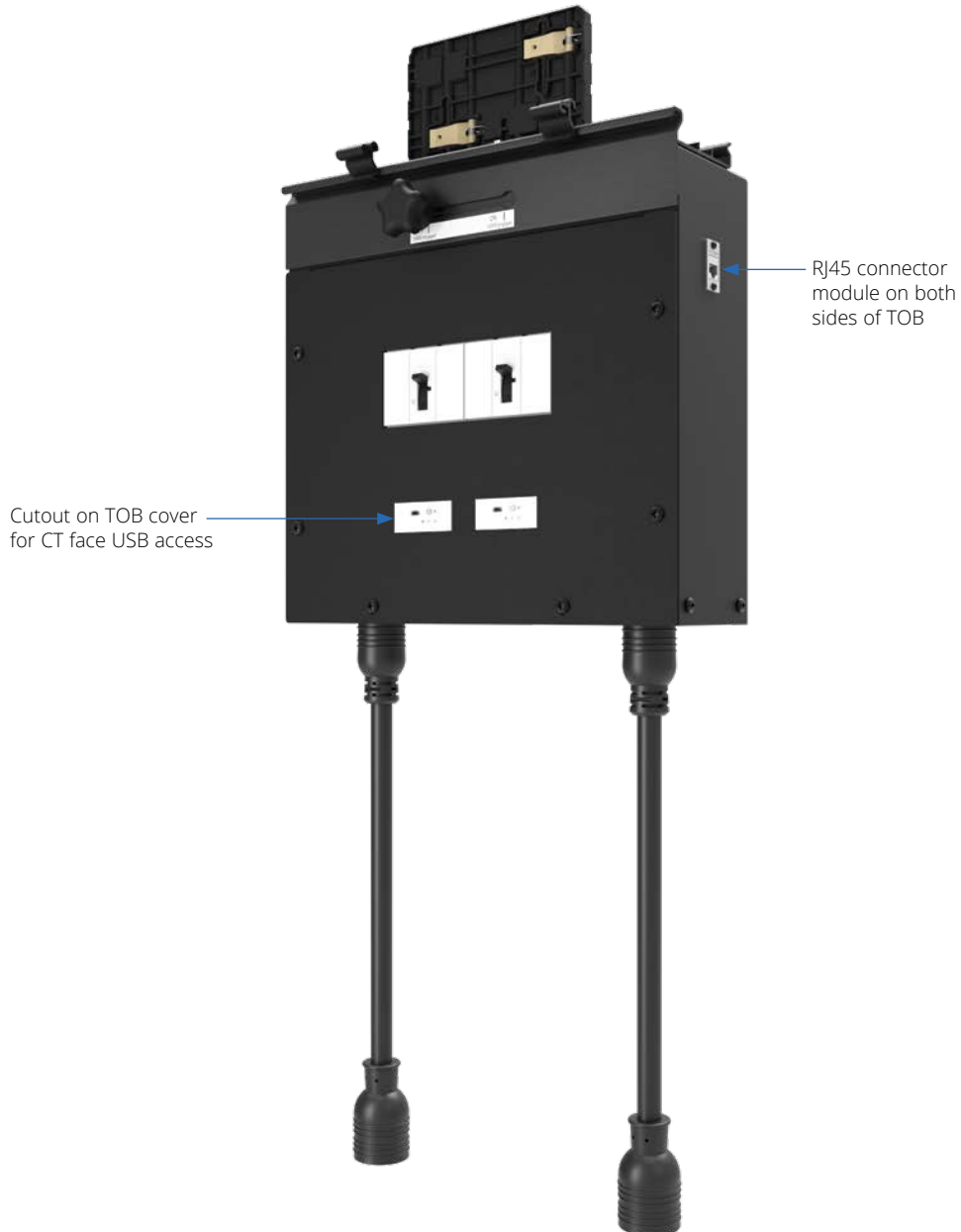

# Product dimensions

Dimensions in inches (mm)

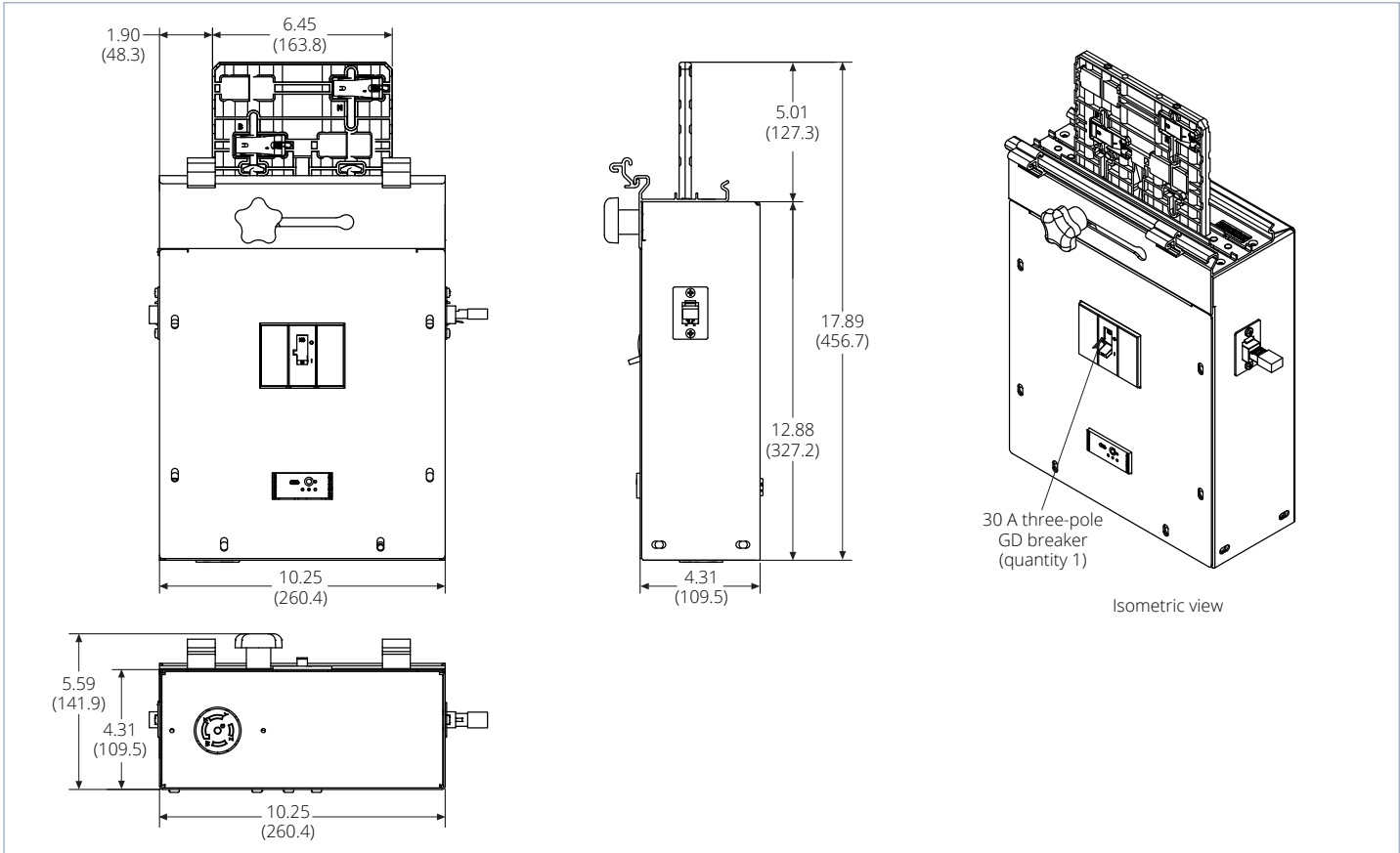

10.25-inch TOB design with single GD breaker (GD3030)

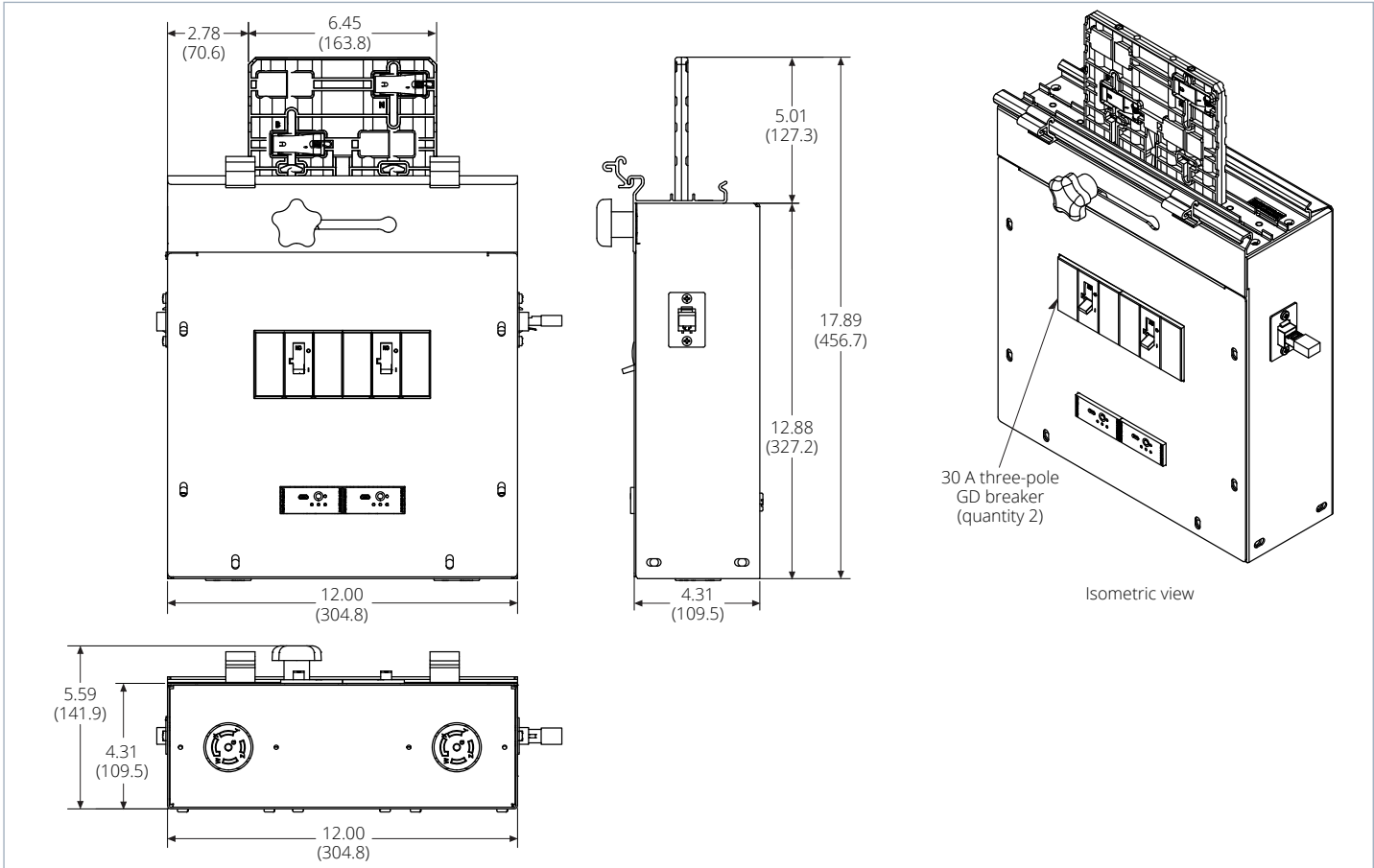

12-inch TOB design with dual GD breaker (GD3030)

## Technical specifications

Ratings	Specification
Input/output	Three-phase, four-wire plus housing ground; optional isolated or dedicated ground
Ampacity	250 A, 400 A, 600 A, 800 A, 1000 A
Voltage	600 Vac maximum
Frequency	50 Hz / 60 Hz
Neutral	100% or 150% (150% only for 250–400 A)
Tap-off box	128 A maximum per phase
Protection	IP2X finger-safe
Short circuit ratings	250 A and 400 A: 42 kA at 120/208 Vac, 35 kA at 277/480 Vac, 22 kA at 347/600 Vac 600 A, 800 A and 1000 A: 42 kA up to 600 Vac
Voltage drop	2 V per 100 ft (30.5 m)

### Safety and mounting option standards

ETL classified to UL 857, CSA C22.2 No. 27 and IEC 60439-2 standards

UL/CSA standards limit ratings to 225 A for the United States and 400 A for Canada for continuous plug-in busway

### Operating conditions

Storage temperature +40 to +158 °F (+4 to +70 °C)

Operating temperature +32 to +104 °F (0 to +40 °C)

Relative humidity 0% to 95% noncondensing

Operating altitude Up to 6600 ft (2000 m)

### Branch circuit monitoring system (BCMS)

Monitor Connect up to 30 source or branch modules to monitor current and voltage

Communications Modbus TCP, BACnet/IP and SNMP V1, V2 and V3

Indicator Breaker status indicator lights

### Testing

PowerWave 2 busway system shall be factory tested before shipment. Testing includes:

Hi-pot test at 2X the unit's rated voltage plus 1000 V per UL 857

Receptacle or connector and breaker configuration

Phase wiring/connectivity test

Ground fault path test

### System weight

250 A busway 6.8 lb/ft

400 A busway 9.6 lb/ft

600 A busway 12.6 lb/ft

800 A busway 19.4 lb/ft

1000 A busway 24.2 lb/ft

## Service and support

With decades of mission-critical power experience and seasoned factory-trained service staff, Eaton can maximize the benefit of your equipment investment. For more information and for 24/7 support, contact the Eaton service team at 1-800-225-4838.

For more information, visit [Eaton.com/powerwave2](https://Eaton.com/powerwave2)