

USING BOTTLE OPENER

Bottle opener may be used to open most metal capped bottles.

1. Angle worklight so that the bottom edge of the bottle opener lifts the bottom edge of the bottle cap (Fig. 1).
2. Lift worklight up to pry bottle cap off.
3. Wipe clean any residue left on worklight with dry or damp clean cloth.

ATTACHING LANYARD

1. Remove lanyard from packaging.
2. Thread short loop behind lanyard pin and insert wrist strap into short loop. Pull until short loop is snug against lanyard pin (Fig. 2).
3. Lightly pull on lanyard to verify attachment.

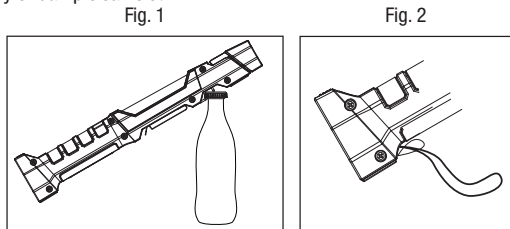

MAINTENANCE

Before performing any maintenance, **ALWAYS** unplug worklight. Remove dirt and grime as soon as it accumulates. Use a soft, damp cloth and a mild soap, if needed. Be sure not to get the electrical lug wet. **NEVER** submerge any part of the worklight in any solution to clean it. **DO NOT USE** solvents such as gasoline, turpentine, etc. to clean unit. Aerosols and other chemicals may fog the clear polycarbonate lens.

ONE YEAR FULL WARRANTY ON WORKLIGHT

If this product fails due to a defect in material or workmanship within one year from the date of purchase, **RETURN IT TO YOUR NEAREST STORE IN THE UNITED STATES**, and it will be replaced free of charge. This warranty applies for only 90 days from the date of purchase if this worklight is used for commercial or rental purposes. This warranty gives you specific legal rights, and you may also have other rights, which vary from state to state.

Printed in China 09/14 825-1020

Eaton's Cooper Lighting Business • 1121 Highway 74 South, Peachtree City, GA 30269 • www.eaton.com © 2014 Eaton

MIGHT  LIGHT

Instruction Manual

IMPORTANT SAFETY INSTRUCTIONS

SAVE THESE INSTRUCTIONS!

DANGER - TO REDUCE THE RISK OF ELECTRIC FIRE OR ELECTRIC SHOCK, CAREFULLY FOLLOW THESE INSTRUCTIONS.

WARNING - When using electrical fixtures, base precautions should always be followed, including the following:

1. Read all instructions before using the fixture.
2. **DO NOT** handle this fixture or try to plug it in when your hands are wet or damp or when you are standing on a wet or damp surface or in water.
3. To reduce the risk of injury, close supervision is necessary when an fixture is used near children.
4. **ONLY USE** attachments recommended or sold by the manufacturer.
5. **DO NOT** use outdoors. This fixture is intended for use as general indoor lighting.
6. **DO NOT** use in potentially dangerous locations, such as flammable or explosive atmospheres.
7. To reduce the risk of electric shock, do not put in water or other liquid. Do not place or store fixture where it can fall or be pulled into a tub or sink.

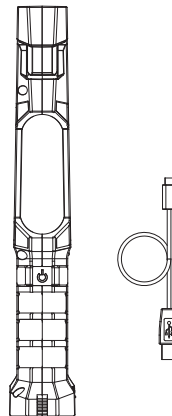

**LED WORK LIGHT
MODEL NO.
LED150 / LED150C**

**Cooper Lighting
by E.T.N**



Questions? 1-800-334-6871 ConsumerProducts@eaton.com

NEVER ATTEMPT TO PICK UP PLUGGED-IN FIXTURES WHEN THEY FALL INTO WATER BECAUSE FATAL ELECTROCUTION COULD RESULT.

8. Make sure cord is located so that it will not be stepped on, tripped over, or otherwise subjected to damage or stress.
9. Do not operate fixture if it has received a sharp blow, been dropped, or otherwise damaged in any way.
10. This fixture **MUST ALWAYS BE USED** in accordance with all electrical and safety codes and ordinances, including the most recent National Electric Code (NEC) and with the Occupational Safety and Health Administration (OSHA) Volume 1 on General Industry Standards and interpretations.
11. **DO NOT** replace batteries.
12. **DO NOT** dispose of this product in fire. Batteries inside this product may explode or leak.
13. Lithium-Ion batteries must be disposed of in accordance with local waste ordinances and regulations.
14. **DO NOT** puncture this battery pack. **DO NOT** work on this battery pack.
15. **DO NOT** disassemble fixture. The fixture does not have any user serviceable parts.
16. This product is not intended to be repaired by service personal in case of failure or component defect (unit can be thrown away).
17. This product must not be disposed of together with domestic waste. This product has to be disposed at an authorized place for recycling of electrical and electronic appliances.
18. **NEVER** operate the light with the clear protective lens removed.
19. **KEEP AWAY** from excessive heat or flame.
20. **DO NOT** look directly into the light.

OPERATION

1. Depress switch in the handle one time to turn on the floodlight LED lights.
2. Depress switch a second time to turn the floodlight off and the spotlight on.
3. Depress the switch a third time to turn both the floodlight and spotlight on.
4. Depress the switch a fourth time to turn both lights off.

RECHARGING UTILITY LIGHT

1. Turn off worklight.
2. Lift up USB cover on the lower side of the worklight handle.
3. Insert the battery charger plug into the jack on the worklight handle.
4. Plug the supplied cable into the worklight and any USB 2.0 or 3.0 Port. Maximum ratings: 5 Vdc, 1.0A.
NOTE: Batteries will reach full charge in 5 to 6 hours. LED indicator light glows red while the batteries are charging. When the light is fully charged, the LED indicator turns to green, and the unit will maintain full charge while plugged in.

HANGING UTILITY LIGHT

1. Retractable hanging hook can rotate 360°.
2. Magnets included for attachment to metal surfaces. Clings to most metal surfaces.
WARNING: Do not use magnet for horizontal overhead mounting.
CAUTION: Do not slide on finished painted surfaces as magnet may scratch finish.

USING BELT CLIP

1. Slide belt clip over various surfaces for temporary hanging worklight.