

Wavelite LED

- Product luminaires comply with EN60598 and are suitable for use in normal interior conditions.
- This luminaire has an ambient temperature range of -5°C to 25°C for the non-emergency version
- For Emergency variants - This luminaire has an ambient temperature range of 5°C to 25°C, to ensure the batteries work correctly
- Luminaire is IP40 rated when fitted flush to flat mounting surface

1

Remove both end plate fixing screws (keep these in a safe place). Pull both end caps back to release diffuser, then squeeze the centre of the diffuser inward to release from housing

2

Remove cover by slackening 4 cover fixing screws and sliding over keyholes

3

Fixing Centres	
4'	1000mm x 110mm
5'	1300mm x 110mm
6'	1300mm x 110mm

For suspension fittings, use suspension kit (FP4439 - ordered separately).

Suspended Fixing Centres	
4'	1082mm
5'	1382mm
6'	1646mm

Secure fitting to mounting surface using 4 x fixing points

4

Feed mains wires through one of the cable entries on the end or rear. Cable entries located on each endcap with drill start (drill Ø21mm), central BESA entry or 2 x BESA entries at 600mm. BESA may be covered on some versions, outer holes remain accessible. **ENSURE MAINS SUPPLY IS SWITCHED OFF.** Wire as shown in instruction 5.

5

Mains

- N - Blue (Neutral)
- ⊕ - Green/Yellow (Earth)
- L - Brown (Switched) Live

Emergency

- N - Blue (Neutral)
- ⊕ - Green/Yellow (Earth)
- L - Brown (Switched) Live
- L1 - (Unswitched) Live

Note:
Product suitable for looping with max conductor size 2x2.5mm²

For Sensor Versions:
Sensor supplied loosely connected for packing. Please secure the sensor to the housing in accordance with the sensor leaflet supplied.

DALI Dimming:
Where applicable a 2 way terminal is provided in the luminaire geartray.

LUMINAIRES MUST BE EARTHED

6

Refit cover over keyholes and tighten 4 screws

Refit diffuser, keep endcaps in place and squeeze the centre of the diffuser to fit into the housing, then push the endcaps back into position over the diffuser. **IT IS IMPORTANT THAT THE DIFFUSER IS FULLY ENGAGED**

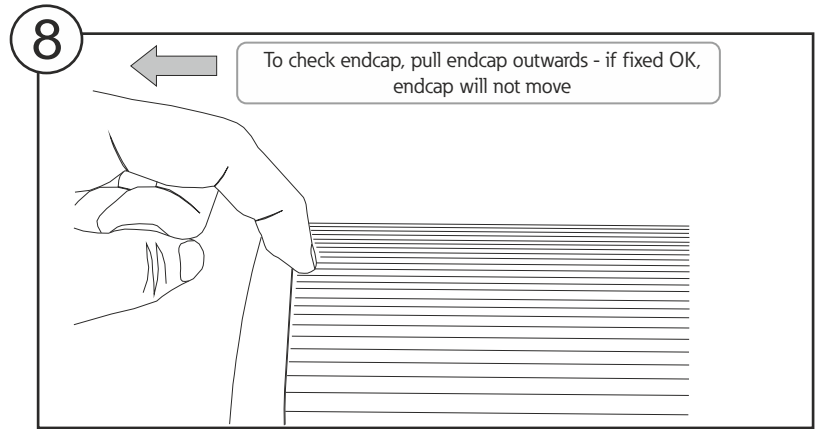
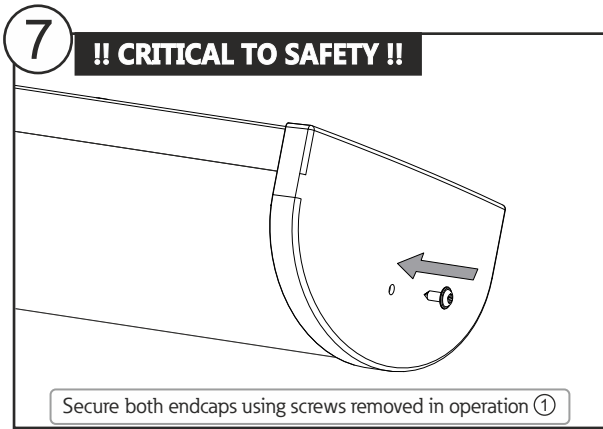

Safe Operation

1. Check the rating label for voltage and frequency before connecting this luminaire to the electrical supply.
2. Ensure that the mains supply is switched off when working on this luminaire, whether installing or carrying out any other servicing.
3. Do not mount luminaire on or close to readily flammable materials.
4. To prevent damage to driver, do not mix with conventional magnetic ballasts on the same electrical circuit.
5. Where use in more onerous situations is required, e.g. In part-completed buildings before "drying-out" is completed, or areas where ambient temperatures are outside the normal temperature range, then consult our Sales Office.
6. The light source contained in this luminaire shall only be replaced by the manufacturer or his service agent or a similar qualified person.
7. **DO NOT** alter dip switch settings

Servicing and Disposal

1. At commissioning and handing over of installation ensure that a copy of these instructions is presented to the authority responsible for the operation and maintenance of the luminaries.
2. Servicing, e.g. cleaning, must only be carried out after the electricity supply has been switched off. It must not be assumed that luminaries with light sources not lit are switched off-always check before servicing.
3. Cleaning should be carried out at regular intervals to ensure that dirt does not accumulate to an extent that will impair the thermal safety or optical performance of the luminaire. Regular cleaning will also ensure that the optical performance of the luminaries is maintained.
4. Avoid touching the LED array surface. To clean - Blow surface with either dry air or nitrogen gas.
5. At the end of life the luminaire is classed as WEEE under directive 2002/96/EC and should be disposed of in accordance with local legislation.

Luminaire Service

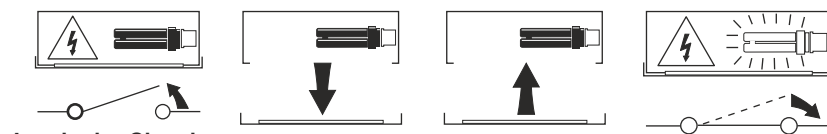

Luminaire Cleaning

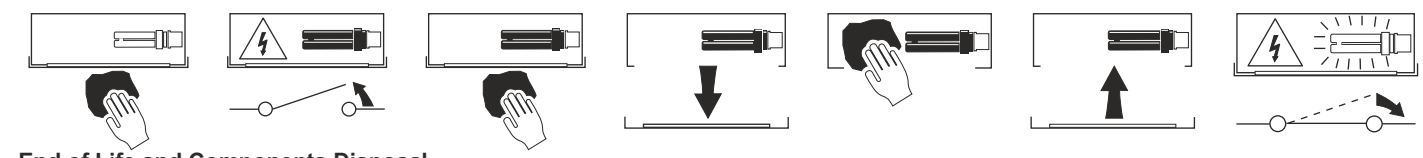

End of Life and Components Disposal

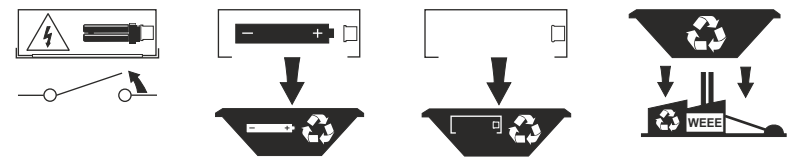

Eaton
 Wheatley Hall Road, Doncaster, South Yorkshire, DN2 4NB

Sales
 T: +44 (0)1302 303303
 F: +44 (0)1302 367155
 E: sales@cooper-ls.com

General
 +44 (0)1302 321541
 +44 (0)1302 303220
 technical@cooper-ls.com

International Sales
 +44 (0)1302 303250
 +44 (0)1302 303251
 export@cooper-ls.com