

Tufflite TFW/TFC

- Product luminaires comply with EN60598 and are suitable for use in normal interior conditions.
- This luminaire has an ambient temperature range of -10°C to +25°C for the non-emergency version
- For Emergency variants - This luminaire has an ambient temperature range of +5°C to +25°C, to ensure the batteries work correctly (2x54W T5 is +5°C to +20°C)

1

Note:
TFW: Diffuser - Prismatic Polycarbonate
 Clips - Polyamide
TFC: Diffuser - Prismatic Acrylic
 Clips - Stainless Steel

Unclip diffuser and remove. Squeeze centre clips to remove geartray assembly

2

Drill suitable cable entry at specified fixture locations only. Use an appropriate gland to maintain IP rating and provide strain relief. Ensure any unused cable entry points are sealed to maintain IP rating

Wattage		L	W	H	C	C2	D	D2
14W/18W	SINGLE	606	101	101	565	-	390	-
14W/18W	TWIN	606	145	101	565	-	390	-
36W/28W/54W	SINGLE	1277	101	101	1050	1170	800	-
36W/28W/54W	TWIN	1277	145	101	1050	1170	800	-
58W/35W/49W	SINGLE	1573	101	101	1340	1460	1100	-
58W/35W/49W	TWIN	1573	145	101	1340	1460	1100	-
70W	SINGLE	1840	101	101	1620	1742	1480	510
70W	TWIN	1840	145	101	1620	1742	1480	510

3

Use fixing brackets supplied to either surface mount or suspend fitting from fixing surface. **WARNING: Direct mounting without using the supplied fixing brackets may damage the luminaire**

Surface Mounted/Suspended Mounted (Suspension wires supplied separately)

Note: 1840mm length fittings have 4 mounting positions, 2 of the 4 are to be used

This luminaire is IP66 rated, this rating only applies when the luminaire is mounted observing the correct orientation and must not be positioned in direct sunlight. In exterior applications luminaires must be protected under a canopy or cover. Housings are not suitable for mounting with the base directly on a vertical surface in the horizontal orientation.

4

Hang geartray from hooks in housing, feed mains cable through cable entry and wire terminal block as per below:

LUMINAIRE MUST BE EARTHED

Mains		Emergency	
L - (Switched) Live		L1 - (Unswitched) Live	
⊕ - Earth		L - (Switched) Live	
N - Neutral		⊕ - Earth	
		N - Neutral	

DSI/DALI Dimming: Where applicable a 2 way terminal is provided in the luminaire geartray. Please see additional leaflet for details.
EasiCheck2 connection: Where applicable, EasiCheck termination is provided in the luminaire gear tray. Please see additional leaflet for details.

For Sensor Versions:
 Sensor supplied loosely connected for packing. Please secure the sensor to the housing in accordance with the sensor leaflet supplied.
NOTE: When a sensor is used, the fitting will be rated IP65.

5

a) Pull lamp holders up through slots in gear tray, ensure they 'click' into place.
 b) Push geartray back into position, ensuring it secures back into housing clips

CLICK!

c) Fit suitable wattage lamp

CLICK!

6

Fit diffuser back to housing, ensuring all clips are fastened

Safe Operation

1. Check the rating label for voltage and frequency before connecting this luminaire to the electrical supply.
2. Ensure that the mains supply is switched off when working on this luminaire, whether installing, re-lamping or carrying out any other servicing.
3. Use the correct lamps as initially supplied or as indicated on the ballast label.
4. This luminaire is suitable for direct mounting on all non-combustible and normally flammable materials, e.g. timber, plasterboard. Do not mount luminaire on or close to readily flammable materials.
5. To prevent damage to H.F. Ballasts do not mix H.F. and Conventional Magnetic Ballasts (Switch, Quick or S.R Start) on the same electrical circuit.

Servicing and Lamp Disposal

1. At commissioning and handing over of installation ensure that a copy of these instructions is presented to the authority responsible for the operation and maintenance of the luminaries.
2. Servicing, e.g. cleaning, lamp replacement, must only be carried out after the electricity supply has been switched off. It must not be assumed that luminaires with lamps not lit are switched off- always check before servicing.
3. Cleaning should be carried out at regular intervals to ensure that dirt does not accumulate to an extent that will impair the thermal safety of the luminaire. Regular cleaning will also ensure that the optical performance of the luminaires is maintained.
4. Failed lamps and starter switches must be replaced as soon as practicable by lamps and starters of the same type. For electronic start circuits allow **one minute** for the thermal cut-out to re-set before switching on the mains supply.
5. At the end of life the lamp and luminaire are classed as WEEE under directive 2002/96/EC and should be disposed of in accordance with local legislation.
6. All other parts of these luminaries, in small quantities, may be disposed of in the normal way. However, if large quantities of plastic are to be incinerated special precautions should be taken against the fumes which may be given off.

Luminaire Service

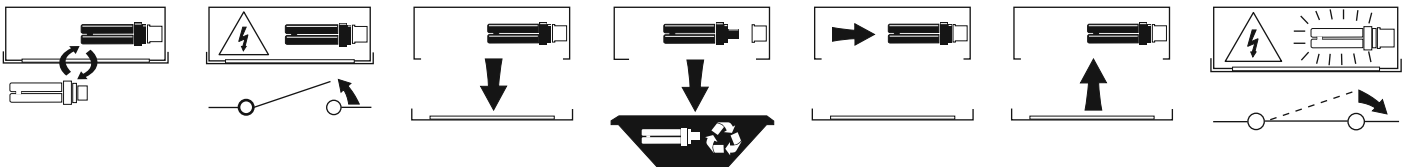

Luminaire Cleaning

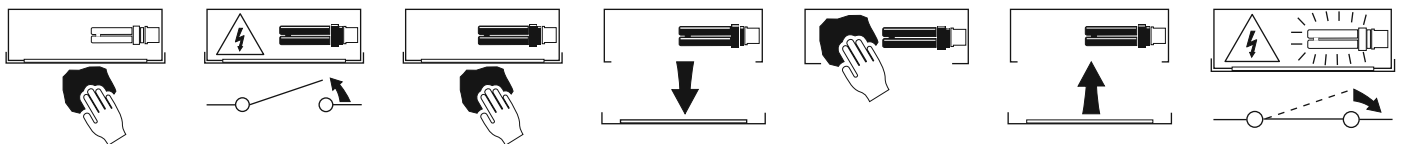

End of Life and Components Disposal

