

# Spera



- Product luminaires comply with EN60598 and are suitable for use in normal exterior conditions.
- This luminaire has an ambient temperature range of -10°C to 50°C for the standard version
- Luminaire and lead are only IP68 once connected, if luminaire socket or lead is not connected the terminals are open, therefore it is not IP68.
- 3rd party tested at 500mm for 30 minutes immersion, however Spera is not to be used in applications where submersion is likely

### 1 Typical System

**Junction Box**  
Mains In  
DMX/DALI In

**DMX System Only** - SPTCABTER fitted in free connection as shown, to terminate each run.

Initial cable from connection box to the first splitter/luminaire will require an entry cable. The remaining are connecting cables. See the below list for part numbers and descriptions.

Start of run	
SPT3CABSRT	SPERA ENT CABLE TERMINATED ONE END 3M
SPT5CABSRT	SPERA ENT CABLE TERMINATED ONE END 5M
SPT10CABSRT	SPERA ENT CABLE TERMINATED ONE END 10M
SPTCABCOB	SPERA LIVE END CONNECTION BOX

Connecting Cable	
SPT2CAB2M	SPERA CONNECTING CABLE 2M
SPT3CAB3M	SPERA CONNECTING CABLE 3M
SPT5CAB5M	SPERA CONNECTING CABLE 5M

Splitter	
SPTSPLIT	SPERA CABLE SPLITTER 1 IN 2 OUT

End of Run	
SPTCABTER	SPERA END OF RUN DMX TERMINATION

Each run is terminated with an end cap (see right).

**!! CRITICAL TO QUALITY !!** DO NOT exceed a maximum of 16 fittings per run, or 32 fittings in two runs (again 16 in each)

### 2 Fixing Bracket

When installing the bracket the hole furthest away from the supply cable will be central to the fitting.

Using suitable fixing screws, fix the bracket to the chosen surface using the slot features. See dimensions below

**Note:** Bracket does not sit central to luminaire.

R3.25mm  
25mm  
194mm  
400mm  
194mm

The bracket can be installed in two orientations and on both sides of the fitting. To adjust bracket remove bolt (as above) move bracket and re-secure bolt

**!! CRITICAL TO QUALITY !!** DO NOT tamper with luminaire during installation.

### 3 Wiring - Connection Box

	Start Cable
Switched Live -	Switched Live (Brown)
Earth -	Earth (Green/Yellow)
Neutral -	Neutral (Blue)
Shield -	N/A
DALI/DMX (+) -	DALI/DMX (Blue) (+)
DALI/DMX (-) -	DALI/DMX (White) (-)

**LUMINAIRES MUST BE EARTHED**

**ENSURE SUPPLY IS TURNED OFF BEFORE WIRING**

### Baffle Install - Sold Separately

a) Hold reflector in channel that runs along front face.

b) At one end of the reflector only, pull the reflector outwards until it clicks into position.

c) Continue the pulling action along the reflector until fully engaged.

**Louvre Install - Sold Separately**

Start by installing a reflector down each side of the fitting. See 'Reflector Install' for details.

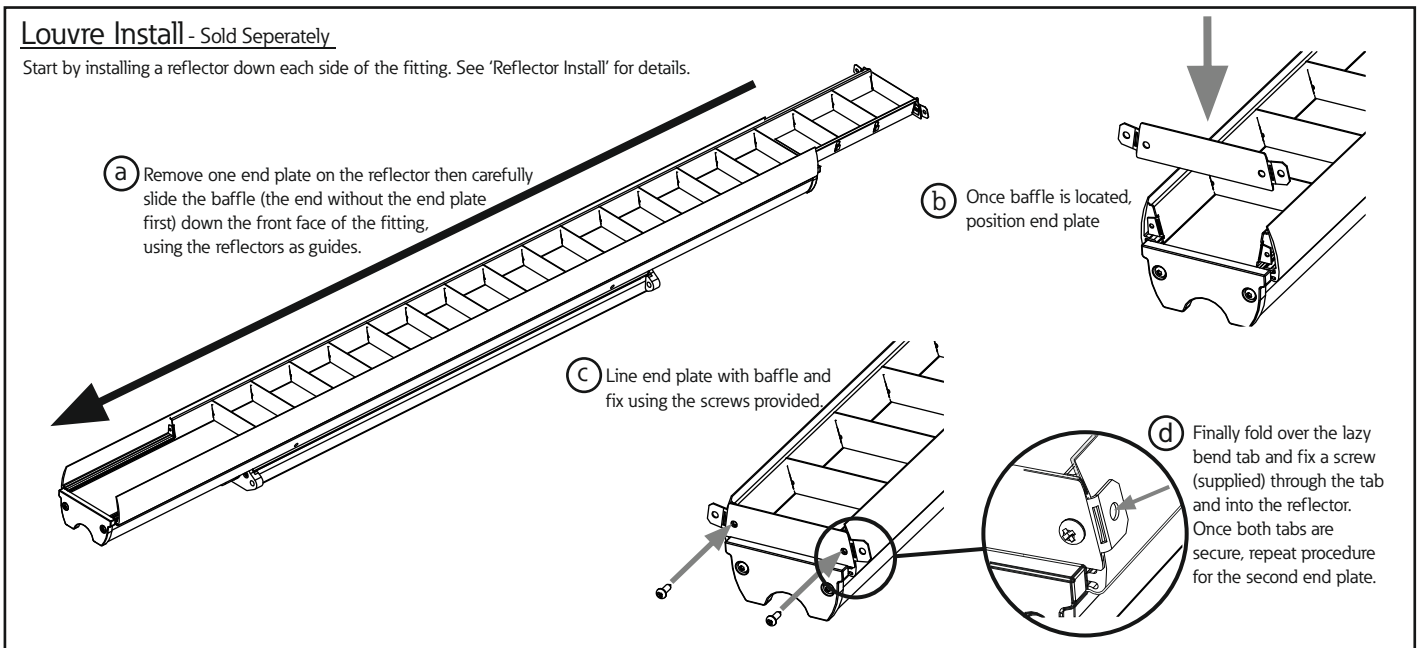

**Safe Operation**

1. Check the rating label for voltage and frequency before connecting this luminaire to the electrical supply.
2. Ensure that the mains supply is switched off when working on this luminaire, whether installing or carrying out any other servicing.
3. Do not mount luminaire on or close to readily flammable materials.
4. To prevent damage to driver, do not mix with conventional magnetic ballasts on the same electrical circuit.
5. Where use in more onerous situations is required, e.g. In part-completed buildings before "drying-out" is completed, or areas where ambient temperatures are outside the normal temperature range, then consult our Sales Office.
6. The light source contained in this luminaire shall only be replaced by the manufacturer or his service agent or a similar qualified person.
7. This product is tested to IP68 at a depth of 0.5 metres for 30 minutes. This product is not suitable for prolonged submersion.
8. If the external flexible cable or cord of this luminaire is damaged, it shall be replaced by a special cord or cord exclusively available from the manufacturer or his service agent.
9. Note the maximum Current rating for the plugs and sockets used in the range is 16 amps, however an individual run of 16 luminaires must not be exceeded.

**Servicing and Disposal**

1. At commissioning and handing over of installation ensure that a copy of these instructions is presented to the authority responsible for the operation and maintenance of the luminaires.
2. Servicing, e.g. cleaning, must only be carried out after the electricity supply has been switched off. It must not be assumed that luminaires with lamps not lit are switched off-always check before servicing.
3. Cleaning should be carried out at regular intervals to ensure that dirt does not accumulate to an extent that will impair the thermal safety or optical performance of the luminaire. Regular cleaning will also ensure that the optical performance of the luminaires is maintained.

**Luminaire Cleaning**

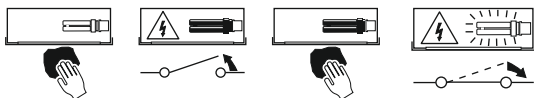

**End of Life and Components Disposal**

