

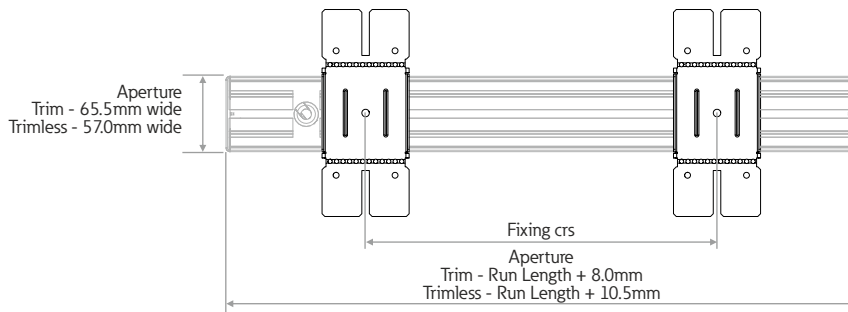

Leat

- Product luminaires comply with EN60598 and are suitable for use in normal interior conditions.
- This luminaire has an ambient temperature range of -10°C to 25°C for the non-emergency version
- For Emergency variants - This luminaire has an ambient temperature range of 5°C to 25°C, to ensure the batteries work correctly

1 Recessed - Bracket Installation



Fixing Centres (per fitting)	
1.0m	700mm
1.5m	1200mm
2.0m	1700mm
3.0m	2700mm + centre fixing

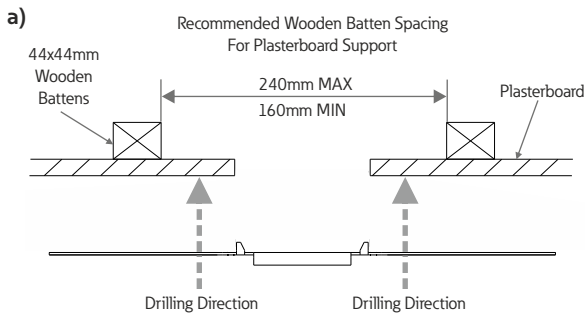

- Cut aperture to required size.
- Using the flat bracket (sold separately) as a drilling template, drill 4 x holes 5mm dia, through pilot holes. See 'Bracket Orientation'.
- Counter sink the drilled holes so c/sk screws (supplied) sit flush with the plasterboard.

Bracket Orientation

When using the flat bracket for the drill hole locations make sure the metalwork is in the correct orientation.

The image on the left shows the orientation for the trimless variant and the image on the right shows the orientation for the trimmed version.

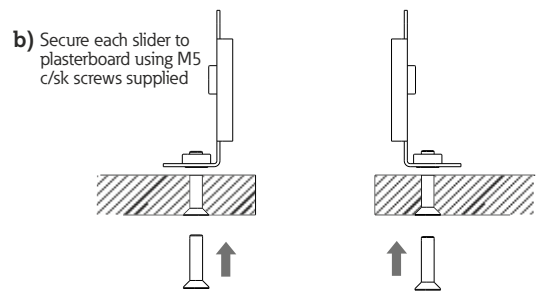

- c)** Fold flat bracket over and fix spring clip. Fit main bracket into slider brackets. Ensure that dimension 'a' from bottom of plasterboard to the inside face of main face is adhered to. Tighten slider bracket screws to hold main bracket in place.

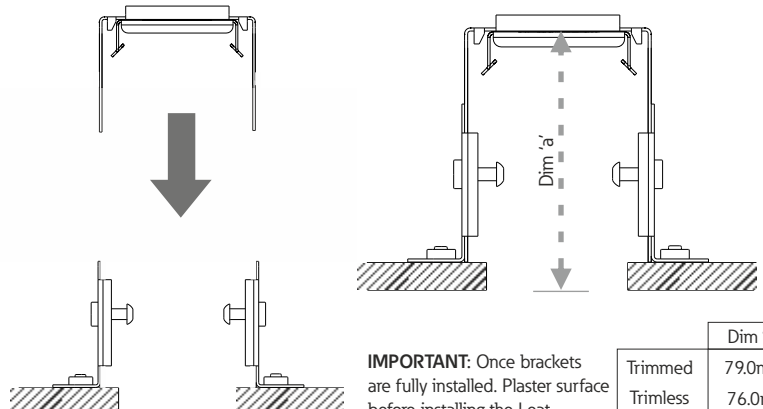
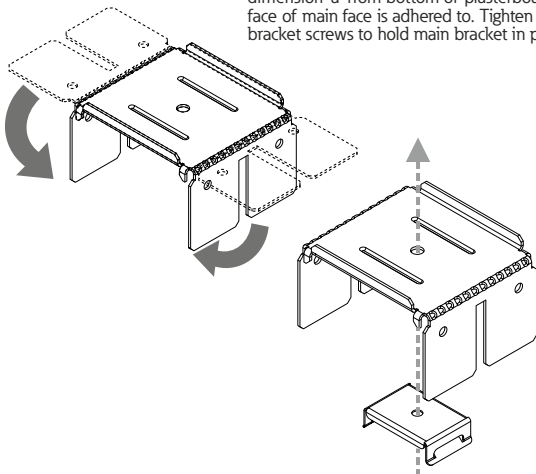

IMPORTANT: Once brackets are fully installed, Plaster surface before installing the Leat.

	Dim 'a'
Trimmed	79.0mm
Trimless	76.0mm

2 Surface Bracket Installation

IMPORTANT DO NOT REMOVE ENDCAPS

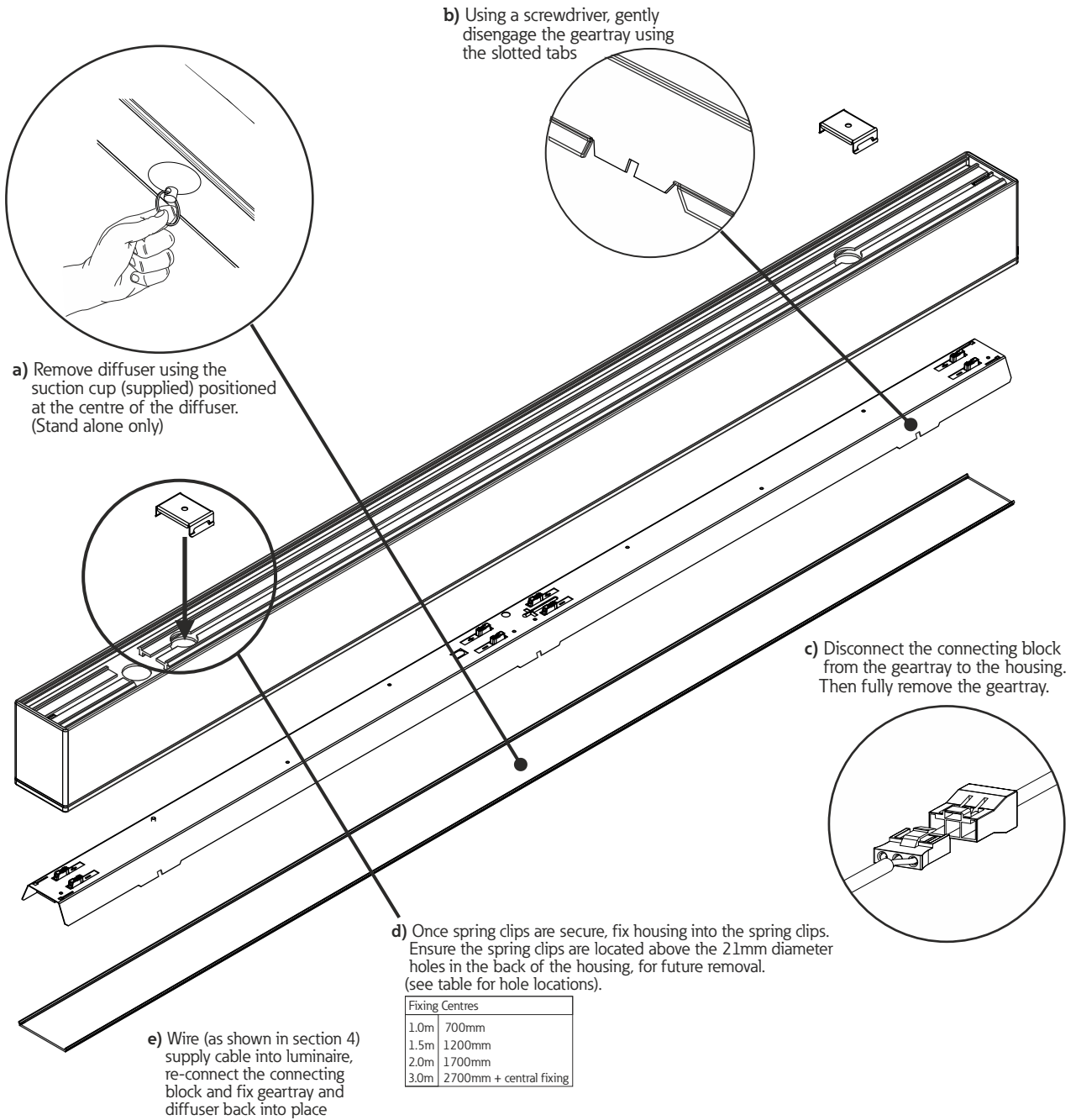

3 Suspension Wire Installation

- Follow procedures 'a' to 'c' as per 'Surface Bracket Installation'.
- Fix suspension wire to surface (see 'Suspension Ceiling Fixing').
- locate the suspension wire thread through the central surface bracket hole, and secure with supplied M4 nut supplied. Offer the Leat up to the surface brackets and fix

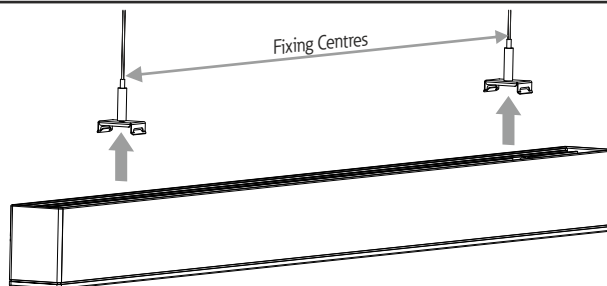

Suspension Ceiling Fixing

- Fix ceiling boss mounting surface using suitable wood screw
- Feed 1-5m long wire into body as shown - screw body into ceiling boss

Leat Corner (500mm) - Sold Separately

- Follow steps 'a, b, c, d' and 'f' under 'Continuous Installation' on page 3.
- After step 'f' cut the diffuser, using the formula on the right to ascertain the diffuser cut length

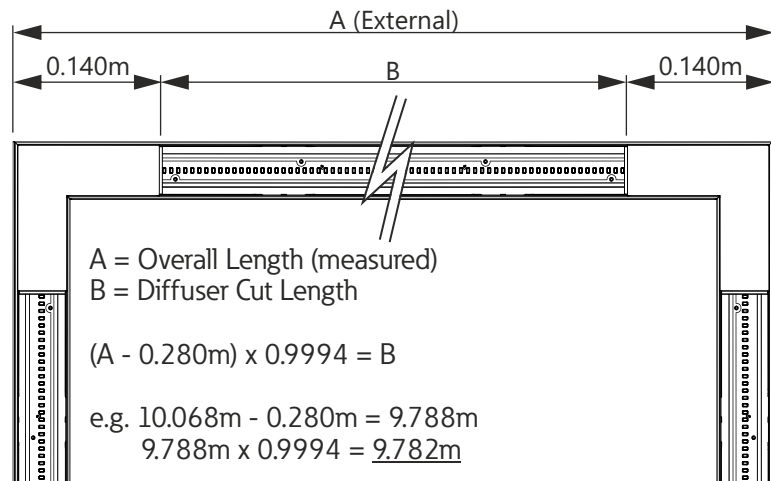

!! CRITICAL TO QUALITY !!
Fit **both** suspensions wires as before, over the 21mm diameter holes.

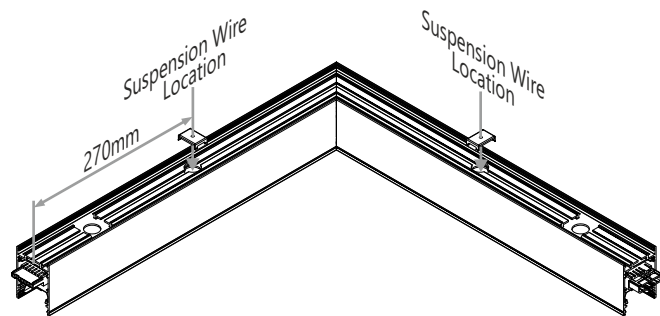

Leat Corner (100mm) - Sold Separately

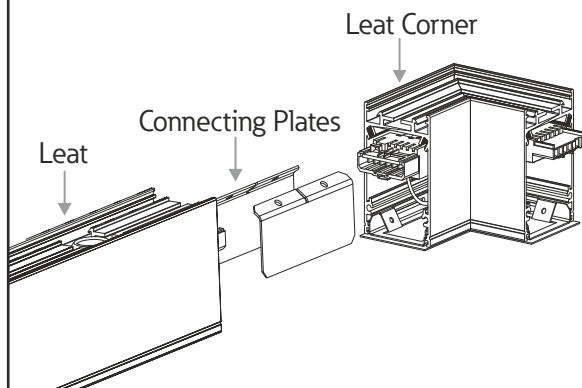

- Remove front cover from corner
- Offer up the Leat Corner up to the continuous Leat with the Connecting Plates in position holding both parts together (See 'Connector Plates' in step 4).
- Screw the plates to both parts, ensuring they are butted up together.
- Connect the plug and socket from both parts. Corner through wiring can be swapped around to switch corner direction.
- Fix front cover back on the Leat Corner

Luminaire Service

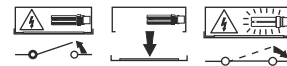

End of Life and Components Disposal



Luminaire Cleaning

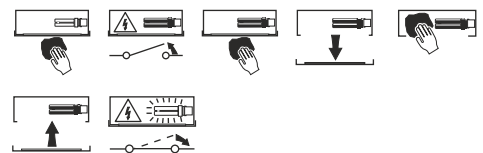

Safe Operation

1. Check the rating label for voltage and frequency before connecting this luminaire to the electrical supply.
2. Ensure that the mains supply is switched off when working on this luminaire, whether installing or carrying out any other servicing.
3. Do not mount luminaire on or close to readily flammable materials.
4. To prevent damage to driver, do not mix with conventional magnetic ballasts on the same electrical circuit.
5. Where use in more onerous situations is required, e.g. In part-completed buildings before "drying-out" is completed, or areas where ambient temperatures are outside the normal temperature range, then consult our Sales Office.
6. The light source contained in this luminaire shall only be replaced by the manufacturer or his service agent or a similar qualified person.
7. When used as intended this product complies with the EMC Directive 2014/30/EU and Low Voltage Directive 2014/35/EU.

Servicing and Disposal

1. At commissioning and handing over of installation ensure that a copy of these instructions is presented to the authority responsible for the operation and maintenance of the luminaries.
2. Servicing, e.g. cleaning, must only be carried out after the electricity supply has been switched off. It must not be assumed that luminaries with LEDs not lit are switched off, always check before servicing.
3. Cleaning should be carried out at regular intervals to ensure that dirt does not accumulate to an extent that will impair the thermal safety or optical performance of the luminaries. Regular cleaning will also ensure that the optical performance of the luminaries is maintained.
4. Avoid touching the LED array surface. To clean - Blow surface with either dry air or nitrogen gas.
5. At the end of life the luminaire is classed as WEEE under directive 2012/19/EU and should be disposed of in accordance with local legislation.