

## Solstar downlights comply with EN60598 class 1 (IP20)

Where use in onerous situations is required, e.g. in part completed buildings before 'drying out' is complete, or areas where ambient temperatures are outside the normal temperature range, then consult our Doncaster Sales office.

These downlights are suitable for installation in defined 'normally flammable' surfaces because of their **F** mark classification.

1. Before installation ensure that the ceiling support system is adequate to carry total luminaire weight.

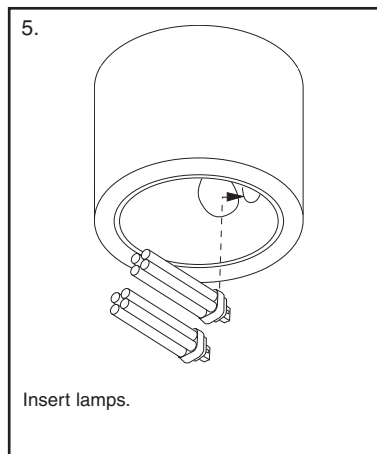
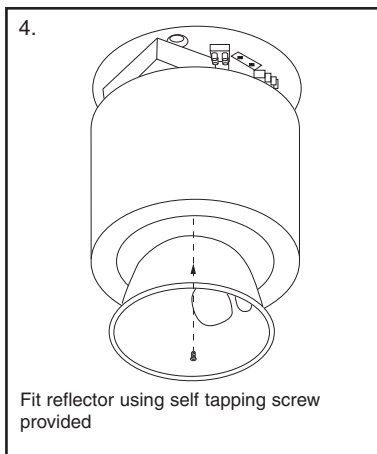
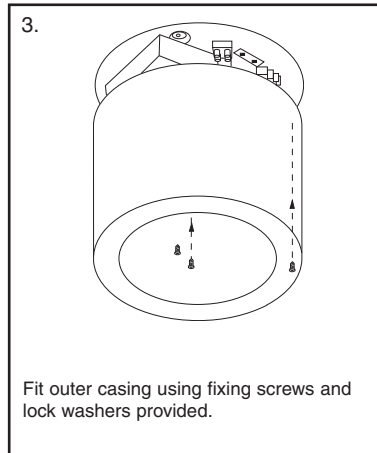
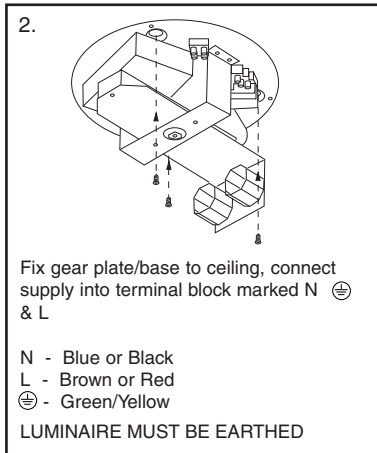

## Special instructions for Emergency Variants

1. Install as a standard mains fitting only connect extra live supply into the inline fuse terminal marked L2.
2. Fit the LED into the LED bracket provided and slide over the lampholder cut-out in the reflector.

## Safe Operation

1. Check the rating label for voltage and frequency before connecting this luminaire to the electrical supply.
2. Ensure that the mains supply is switched off when working on this luminaire, whether installing, re-lamping or carrying out any other servicing.
3. Use the correct lamps as initially supplied or as indicated on the ballast label.
4. This luminaire is suitable for mounting in direct contact with non-combustible materials, e.g. metal, concrete, plaster. It is also suitable for mounting adjacent to flammable materials, e.g. timber, chipboard, providing the top surface is spaced not less than 25mm from such materials.
5. To prevent damage to H.F. Ballasts do not mix H.F. and conventional Magnetic Ballasts (Switch, Quick or S.R. Start) on the same circuit.

## Servicing and Disposal

1. At commissioning and handing over of installation ensure that a copy of these instructions are presented to the authority responsible for the operation and maintenance of the luminaire.
2. Servicing, e.g. cleaning, Lamp replacement, must only be carried out after the electricity supply has been switched off. It must not be assumed that luminaires with lamps not lit are switched off - always check before servicing.
3. Cleaning should be carried out at regular intervals to ensure that dirt does not accumulate to an extent that will impair the thermal safety of the luminaire. Regular cleaning will also ensure that the optical performance of the luminaire is maintained.
4. Failed Lamps must be replaced as soon as practicable by lamps of the same type.
5. At end of life the lamp and luminaire are classed as WEEE under directive 2002/96/EC and should be disposed of in accordance with local legislation.

### Head Office

Cooper Lighting and Security Ltd, Wheatley Hall Road, Doncaster, South Yorkshire, DN2 4NB

Sales	General	Major Projects London	Export
T: +44 (0)1302 303303	+44 (0)1302 321541	+44 (0)1992 787999	+44 (0)1302 303250
F: +44 (0)1302 367155	+44 (0)1302 303220	+44 (0)1992 787222	+44 (0)1302 303251
E: sales@cooper-ls.com	technical@cooper-ls.com	london@cooper-ls.com	export@cooper-ls.com