

# Linergy+ Square - Emergency/Sensor Pod



- Product luminaires comply with EN60598 and are suitable for use in normal interior conditions.
- This luminaire has an ambient temperature range of -10°C to 25°C for the non-emergency version
- For Emergency variants - This luminaire has an ambient temperature range of 5°C to 25°C, to ensure the batteries work correctly

**1 Fixing**

Offer pod up to front face of the Linergy+ Square

To fully engage, hook the back of pod to the back of the Linergy+ Square.

Secure pod to Linergy+ Square by using the two screws and lockwashers provided. Locations shown above

**2 Wiring**

To gain access to the terminations, remove all four screws, in cover and save in a safe place. Snap off the cable entry knockout where required.

<p><b>LNP*SQ*Z</b></p> <p>FROM ELLNPSQ</p> <p>MAINS IN</p> <p>BLUE GREEN/YELLOW BROWN BLACK</p> <p>N - BLUE (NEUTRAL) ⊕ - GREEN/YELLOW (EARTH) L - BROWN (SWITCHED) LIVE L1 - (UNSWITCHED) LIVE</p>	<p><b>LNP*SQ*DD</b></p> <p>FROM PIRLNPQQDD</p> <p>MAINS IN</p> <p>WHITE BLUE GREEN/YELLOW BROWN WHITE</p> <p>N - BLUE (NEUTRAL) ⊕ - GREEN/YELLOW (EARTH) L - BROWN (SWITCHED) LIVE</p>
<p><b>LNP*SQ*DD</b></p> <p>FROM ELLNPSQ</p> <p>MAINS IN</p> <p>BLUE GREEN/YELLOW BROWN BLACK</p> <p>DALI N - BLUE (NEUTRAL) ⊕ - GREEN/YELLOW (EARTH) L - BROWN (SWITCHED) LIVE DALI</p> <p>BLACK - SUPPLIED CONNECTOR - L1 - (UNSWITCHED) LIVE</p>	<p><b>LNP*SQ*DD</b></p> <p>FROM ELPIRLNPQQDD</p> <p>MAINS IN</p> <p>WHITE BLUE GREEN/YELLOW BROWN WHITE</p> <p>DALI N - BLUE (NEUTRAL) ⊕ - GREEN/YELLOW (EARTH) L - BROWN (SWITCHED) LIVE DALI</p> <p>BLACK - SUPPLIED CONNECTOR - L1 - (UNSWITCHED) LIVE</p>
<p><b>LNP*SQ*Z</b></p> <p>FROM PIRLNPQZ</p> <p>MAINS IN</p> <p>BROWN BLUE GREEN/YELLOW GREY</p> <p>L - BROWN (SWITCHED) LIVE N - BLUE (NEUTRAL) ⊕ - GREEN/YELLOW (EARTH)</p>	<p><b>LNP*SQ*Z</b></p> <p>FROM ELPIRLNPQZ</p> <p>MAINS IN</p> <p>BROWN BLUE GREEN/YELLOW GREY BLACK</p> <p>L - BROWN (SWITCHED) LIVE N - BLUE (NEUTRAL) ⊕ - GREEN/YELLOW (EARTH) L1 - (UNSWITCHED) LIVE</p>

**3**

To earth the shroud, fix earth wire to earth tab

A) Slide the shroud (earth tag face first) into the opening on the pod where the wires are coming from. B) Place the shroud down ensuring no wires are trapped.

Line up the holes on the shroud with the screw holes as shown. Close and secure lid with the four screws previously removed

**IMPORTANT NOTE:**

- **Luminaire battery MUST NOT** be connected until building has a permanent un-switched live supply.
- Repeated full discharges caused by fully removing power to luminaires with connected batteries (i.e. a nightly building power down prior to hand over) will permanently damage the battery and invalidate any warranty.

**Safe Operation**

1. Check the rating label for voltage and frequency before connecting this luminaire to the electrical supply.
2. Ensure that the mains supply is switched off when working on this luminaire, whether installing or carrying out any other servicing.
3. Do not mount luminaire on or close to readily flammable materials.
4. To prevent damage to driver, do not mix with conventional magnetic ballasts on the same electrical circuit.
5. Where use in more onerous situations is required, e.g. In part-completed buildings before "drying-out" is completed, or areas where ambient temperatures are outside the normal temperature range, then consult our Sales Office.
6. The light output of the product may cause injuries to human eyes in circumstances where the product is viewed directly with unshielded eyes for more than a few seconds.

**Servicing and Disposal**

1. At commissioning and handing over of installation ensure that a copy of these instructions is presented to the authority responsible for the operation and maintenance of the luminaries.
2. Servicing, e.g. cleaning, must only be carried out after the electricity supply has been switched off. It must not be assumed that luminaries with lamps not lit are switched off-always check before servicing.
3. Cleaning should be carried out at regular intervals to ensure that dirt does not accumulate to an extent that will impair the thermal safety or optical performance of the luminaire. Regular cleaning will also ensure that the optical performance of the luminaries is maintained.
4. Avoid touching the LED array surface. To clean - Blow surface with either dry air or nitrogen gas.
5. At the end of life the luminaire is classed as WEEE under directive 2012/19/EU and should be disposed of in accordance with local legislation.

Luminaire Service

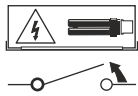

Luminaire Cleaning

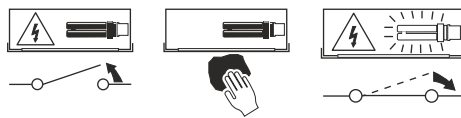

End of Life and Components Disposal

