

Installation Instructions for: Galaxy Minor

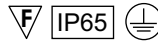

Suitable for Cat. Nos. GA70S, GA142Z, GA100MBI plus PEC and PC versions.

Specifications

- Supply : 240v 50Hz
 Protection : Class 1 earthed metalwork.
 Standards Compliance : IP65 dust tight and jet proof.
 : BS4533:2.5.
 : EN60 598

Operating position of floodlight : Universal

NOTE:
 This Floodlight should not be operated in ambient temperatures which are above the temperature printed on the product label located in the reflector

Preparation for Installation

1. a) Unscrew front cover screws and hinge away (Fig. 1)
- b) Remove lamp complete with packaging.
- c) Unscrew reflector retaining screw, remove reflector and disconnect earth lead.

Keep safe for re-assembly later

Fig. 1

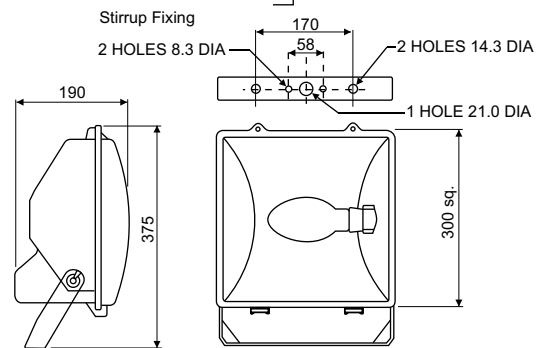
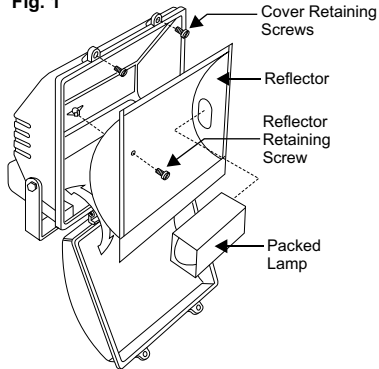

2. To attach floodlight to mounting stirrup (see Fig.2 right)
 - a) Slacken bolts.
 - b) Locate mounting stirrup.
 - c) Tighten bolts.

Wiring Procedures

3. a) Fit sealing washer onto cable gland thread.
 - b) Fit cable gland into 21mm diameter hole from outside of housing.
 - c) Retain cable gland in place using locknut inside housing.
 - d) Feed a flexible 3 core cable (O/D 8mm - 13mm) through the gland.
 - e) Ensure only 200mm of cable extends into body.
 - f) Tighten gland for cable anchorage and to maintain jet proof seal. (see Fig. 3 for all above details.)
5. Connect incoming supply conductors to 3-way terminal blockmarked, L, N.
- Blue = N**
Brown = L LUMINAIRE MUST BE EARTHED
Green/Yellow = ⊕
6. Re-assembly is a reversal of the procedure detailed in Section 1 - remove lamp from packaging. The floodlight can now be tested and final alignment achieved.

Fig. 2

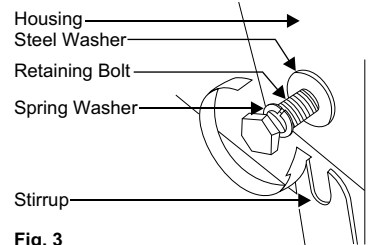
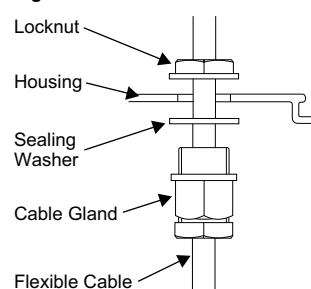
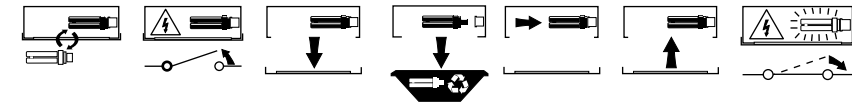

Fig. 3



Luminaire Service



Luminaire Cleaning

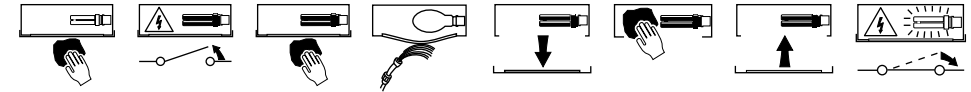

End of Life and Components Disposal

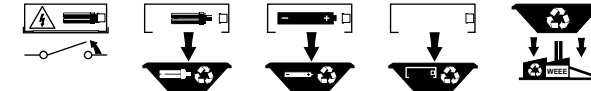

Safe Operation

1. Check the rating label for voltage and frequency before connecting this luminaire to the electrical supply.
2. Ensure that the mains supply is switched off when working on this luminaire, whether installing, re-lamping or carrying out any other servicing.
3. Use the correct lamps as initially supplied or as indicated on the ballast label.
4. This luminaire is suitable for direct mounting on all non-combustible and normally flammable materials, e.g. timber, plasterboard. Do not mount luminaire on or close to readily flammable materials.
5. To prevent damage to H.F. Ballasts do not mix H.F. and Conventional Magnetic Ballasts (Switch, Quick or S.R Start) on the same electrical circuit.

Servicing and Lamp Disposal

1. At commissioning and handing over of installation ensure that a copy of these instructions is presented to the authority responsible for the operation and maintenance of the luminaires.
2. Servicing, e.g. cleaning, lamp replacement, must only be carried out after the electricity supply has been switched off. It must not be assumed that luminaires with lamps not lit are switched off- always check before servicing.
3. Cleaning should be carried out at regular intervals to ensure that dirt does not accumulate to an extent that will impair the thermal safety of the luminaire. Regular cleaning will also ensure that the optical performance of the luminaires is maintained.
4. Failed lamps and starter switches must be replaced as soon as practicable by lamps and starters of the same type. For electronic start circuits allow **one minute** for the thermal cut-out to re-set before switching on the mains supply.
5. At the end of life the lamp and luminaire are classed as WEEE under directive 2002/96/EC and should be disposed of in accordance with local legislation.
6. All other parts of these luminaires, in small quantities, may be disposed of in the normal way. However, if large quantities of plastic are to be incinerated special precautions should be taken against the fumes which may be given off.

Cooper Lighting and Safety Ltd

Wheatley Hall Road, Doncaster, South Yorkshire, DN2 4NB

Sales	General	Major Projects London	International Sales
T: +44 (0)1302 303303	+44 (0)1302 321541	+44 (0)1992 787999	+44 (0)1302 303250
F: +44 (0)1302 367155	+44 (0)1302 303220	+44(0)1992 787222	+44 (0)1302 303251
E: sales@cooper-ls.com	technical@cooper-ls.com	london@cooper-ls.com	export@cooper-ls.com