

Installation Instructions for: LED Flood

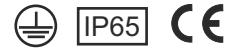

- Product luminaires comply with EN60598 and are suitable for use in normal interior conditions.
- This luminaire has an ambient temperature range of -25°C to 25°C

1

Mark out the fixing points using the stirrup handle and drill 2 holes according to your chosen fixing method (fixings not included, fixings to be chosen suitable for weight, windage and surface material)
See diagram to the right for fixing details

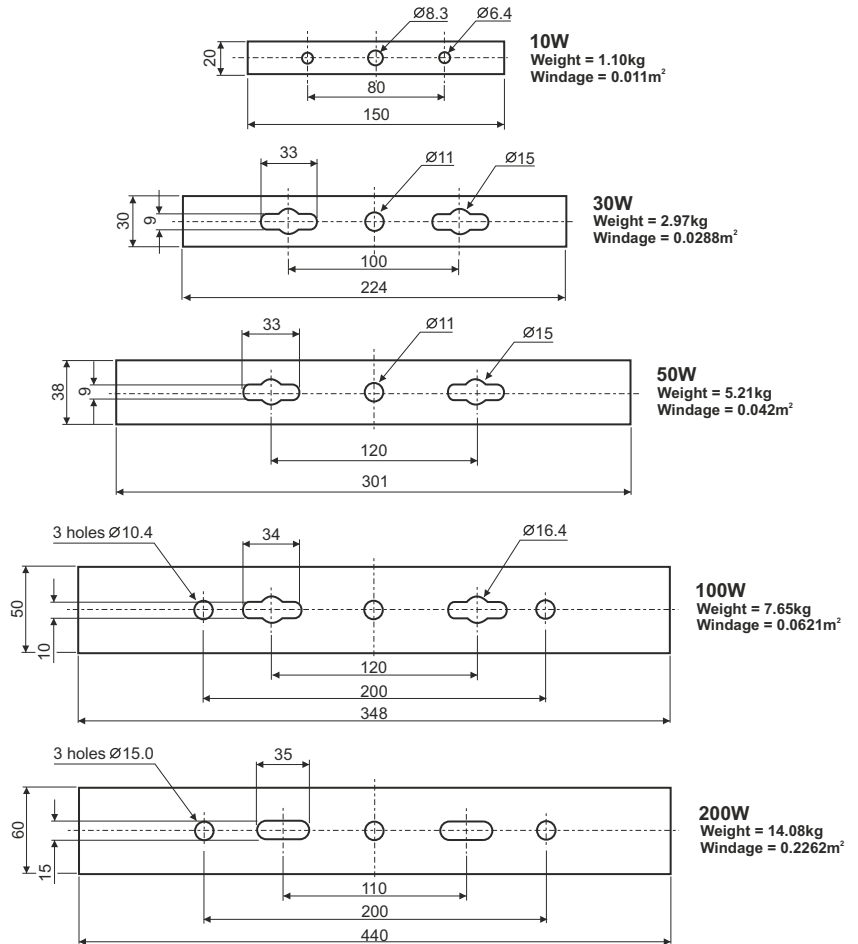
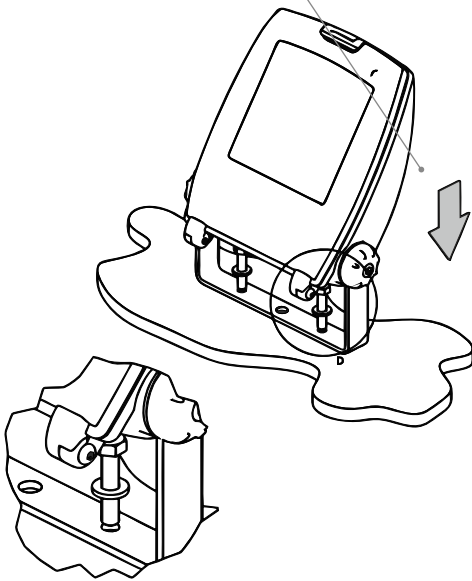

2

ENSURE MAINS SUPPLY IS SWITCHED OFF

LUMINAIRE MUST BE EARTHED

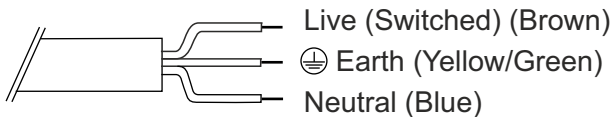

Connect mains cable to flying lead from LED Flood head.
Please Note: Connector is not supplied.
Use a WAGOBOX junction box and Wago Series 222 connectors, or suitable alternative.

Ensure mains supply is turned OFF

Brown - Live
Blue - Neutral
Yellow/Green - Earth

3

Adjust the LED Flood head towards the area to be illuminated and lock off using the two clamping bolts

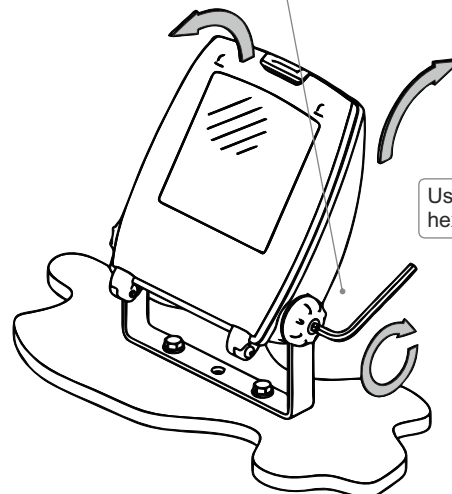

Use a 5.0mm hexagon head key

PIR Module (Selctive models only)– Set Up

This product is an energy saving device and can be set to suit application. It is recommended that the installing engineer makes the adjustments during initial installation. This luminaire incorporates a discrete mini PIR on the front of the floodlight. The operation and sensitivity of this occupancy detector can be adjusted and set as follows:

- With all connections made safely in accordance to current wiring regulation and with the rear enclosure cover removed turn on the floodlight. The luminaire should blink 1 to 3 times. This is perfectly normal as the detector is acclimatising to it's environment.
- Inside the rear adaptable enclosure there is a module with a series of dip-switches. These can be set to operate and change the sensitivity of the PIR device.
- Lux, time-delay and detection distance can all be set.

Functions / Sensor

The word SENSOR is situated to the left hand side of the module and working towards the right, the following selectors are explained.

- 1) Lux** (This detects day or night - dip-switch down)
(Only works at below 30 lux - dip-switch up) caution avoid shaded areas
- 2) Distance** – 4 metre (dip-switch down) or 8 metre (dip-switch up)
- 3) 8 seconds** – Time on after PIR detection
- 4) 1 Minute** – Time on after PIR detection
- 5) 3 Minutes** – Time on after PIR detection
- 6) 5 Minutes** – Time on after PIR detection

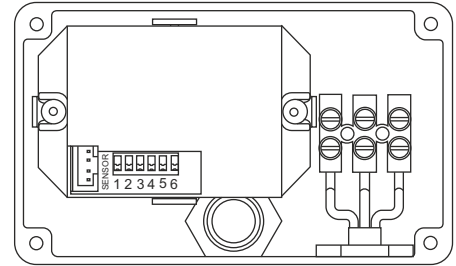

PIR Sensor Housing with cover removed

PLEASE NOTE:

Time dip-switches in the up position denote function selected.
When switches (3, 4, 5 & 6) are switched off the luminaire stays illuminated (Sensor disabled).

IMPORTANT

After installation, test all functions. Walk test you can test during the day provided you switch off selector dip-switch No. 1
Replace waterproof cover carefully after final setup.

Do's and Don'ts

Do not install near timed light sources or in shaded areas as the PIR / light sensor could be inadvertently triggered
Avoid installing near to air streams or air conditioning outlets
Do not cover the device

Safe Operation

1. To prevent damage to driver, do not mix with conventional magnetic ballasts on the same electrical circuit.
2. Check the rating label for voltage and frequency before connecting this luminaire to the electrical supply.
3. Ensure that the mains supply is switched off when working on this luminaire, whether installing or carrying out any other servicing.
4. Do not mount luminaire on or close to readily flammable materials.
5. Where use in more onerous situations is required, e.g. In part-completed buildings before "drying-out" is completed, or areas where ambient temperatures are outside the normal temperature range, then consult our Sales Office.
6. The light output of the product may cause injuries to human eyes in circumstances where the product is viewed directly with unshielded eyes for more than a few seconds.

Servicing and Disposal

1. At commissioning and handing over of installation, ensure that a copy of these instructions is presented to the authority responsible for the operation and maintenance of the luminaries.
2. Servicing, e.g. cleaning, must only be carried out after the electricity supply has been switched off. It must not be assumed that luminaries with lamps not lit are switched off-always check before servicing.
3. Cleaning should be carried out at regular intervals to ensure that dirt does not accumulate to an extent that will impair the thermal safety or optical performance of the luminaire. Regular cleaning will also ensure that the optical performance of the luminaries is maintained.
4. Avoid touching the LED array surface. To clean - Blow surface with either dry air or nitrogen gas.
5. At the end of life the luminaire is classed as WEEE under directive 2002/96/EC and should be disposed of in accordance with local legislation.

Luminaire Cleaning

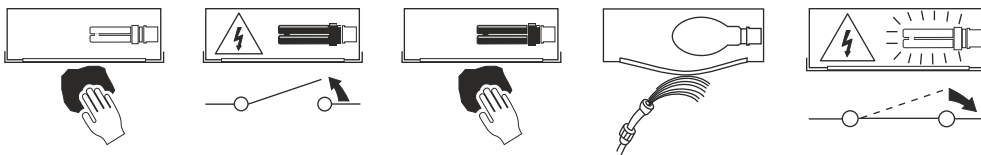

End of Life and Components Disposal

