

# VersaPanel 625

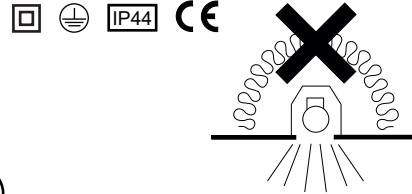

- Product luminaires comply with BSEN60598 Class1/Class 2.
- This luminaire has an ambient temperature range of 5C to 25C

**1**

Typical 625x625mm Suspended Ceiling Grid

Ceiling Tile

Remove the ceiling tile from the position the LED Panel is to be installed

**2** ENSURE MAINS SUPPLY IS SWITCHED OFF

**Class I Product**

Wire LED Driver to mains supply, connect the Live, Earth and Neutral cables.

**IMPORTANT NOTE:** Termination to be in accordance with local wiring regulations

Live (Brown)  
Earth (Yellow/Green)  
Neutral (Blue)

LUMINAIRE MUST BE EARTHED

**Class II Product**

Wire to Live & Neutral on LED driver

(Brown) L  
(Blue) N

Position Driver on ceiling tile next to LED Panel

**3**

Move LED Panel into aperture in ceiling and position halfway. Take note of the below points:

1. Before installation ensure that the ceiling support system is adequate to carry total LED Panel weight.
2. Ensure prepared ceiling aperture will accommodate the LED Panel dimensions for installation.

**4** ENSURE MAINS SUPPLY IS SWITCHED OFF

Connect the driver to the LED Panel. Most variants will use the connector in image 'A'. Whilst others will use the connector in image 'B'.

1. Position LED Panel fully in aperture.  
2. Ensure LED Panel rests fully on ceiling grid.

## Safe Operation

1. Check the rating label for voltage and frequency before connecting this luminaire to the electrical supply.
2. Ensure that the mains supply is switched off when working on this luminaire, whether installing or carrying out any other servicing.
3. To prevent damage to driver, do not mix with conventional magnetic ballasts on the same electrical circuit.
4. Where use in more onerous situations is required, e.g. In part-completed buildings before "drying-out" is completed, or areas where ambient temperatures are outside the normal temperature range, then consult our Sales Office.

## Servicing and Disposal

1. At commissioning and handing over of installation ensure that a copy of these instructions is presented to the authority responsible for the operation and maintenance of the luminaires.
2. Servicing, e.g. cleaning, must only be carried out after the electricity supply has been switched off. It must not be assumed that luminaires with lamps not lit are switched off-always check before servicing.
3. Cleaning should be carried out at regular intervals to ensure that dirt does not accumulate to an extent that will impair the thermal safety or optical performance of the luminaire. Regular cleaning will also ensure that the optical performance of the luminaires is maintained.
4. Avoid touching the LED array surface. To clean - Blow surface with either dry air or nitrogen gas.
5. At the end of life the luminaire is classed as WEEE under directive 2012/19/EU and should be disposed of in accordance with local legislation.

**Note:** The LED's are non-replaceable but the batteries can be replaced by a competent person

## Luminaire Cleaning

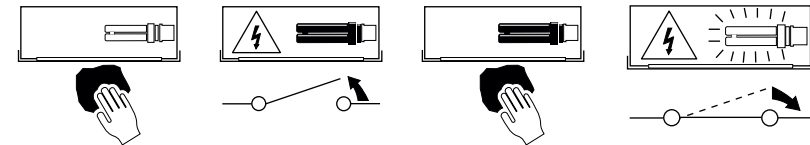

## End of Life and Components Disposal

