



## Pauluhn™ WashPro

Linear fluorescent luminaire for food & beverage/industrial locations

The Pauluhn WashPro is a low bay linear fluorescent fixture engineered for food and beverage processing and industrial applications. The versatile WashPro comes in lengths of 2-8 feet, and is designed for hose down applications.

### Applications:

- Locations requiring continuous and consistent light levels
- Food and beverage processing and storage
- Power generation facilities
- Water/wastewater treatment facilities

### Key features & benefits:

- High lumen output: up to 30,000 lumens
- Available in T8, T12 and T5HO fluorescent models
- NSF rated
- Operating ambient: -20°C to +55°C
- High pressure hose down rated to 1,500 psi



### Certifications:

- UL1598 Luminaires (CSA-US)
- UL924 Emergency Lighting Equipment (CSA-US)
- CSA 22.2 No. 250-4
- Canadian Processed Products Regulations C.R.C., c.291
- NSF/ANSI 2-2010 Food Contact (WPS only)
- NSF/ANSI 2-2010 Splash Zone

### Materials:

#### Housing:

- End caps non-metallic or stainless steel; polycarbonate center stud (optional)

#### Lens:

- Acrylic

#### Gasket:

- Neoprene

#### External Hardware:

- Stainless steel



Powering Business Worldwide

# Ordering information

Part number example

## WP82870EM2

WP (non-metallic), 8 foot, 2 lamps, F96 (T12HO RDC), 120-277V 50/60 Hz, standard end cap with one strain relief connector, emergency battery back-up ballast

WP
8
2
8
7
0
EM2

**Model**

<b>WP</b>	Standard (non-metallic)
<b>WPS</b>	Stainless steel end caps

**Length (nominal)**

<b>2</b>	2 foot
<b>4</b>	4 foot
<b>8</b>	8 foot

**Number of lamps**

<b>2</b>	2 lamps
<b>3</b>	3 lamps (lamp types 1, 5, 6)
<b>4†</b>	4 lamps
<b>6‡</b>	6 lamps

†4 ft. fixture: lamp types 5, 6 only;  
8 ft. fixture with four 4 ft. lamps:  
lamp types 1, 5, 6, 8)  
‡8 ft. fixture with six 4 ft. lamps:  
lamp types 1, 5, 6

**Lamp types**

<b>1</b>	2 ft. F17, 4 ft. F32 (T8 bi-pin) or 8 ft. F96 (single pin)
<b>3</b>	8 ft. F96 (T12 single pin)
<b>5</b>	2 ft. F24 or 4 ft. F54 (T5HO mini bi-pin)
<b>6</b>	2 ft. F14 or 4 ft. F28 (T5 mini bi-pin)
<b>7</b>	4 ft. F48 or 8 ft. F96 (T8HO RDC)
<b>8</b>	2 ft. F24, 4 ft. F48 or 8 ft. F96 (T12HO RDC)

**Voltage/frequency**

<b>6</b>	347V 60 Hz
<b>7</b>	120-277V 50/60 Hz
<b>9</b>	480V 60 Hz

**Options**

<b>EM2*</b>	Emergency battery back-up ballast, 1 lamp, 277V max.
<b>EM3*</b>	Emergency battery back-up ballast, high lumen, 1 lamp, 277V max.
<b>EMT2*</b>	Emergency battery back-up ballast, 1 lamp, 277V max., test switch
<b>EMT3*</b>	Emergency battery back-up ballast, high lumen, 1 lamp, 277V max., test switch
<b>L</b>	Lamps
<b>S</b>	Switch, on/off
<b>W3</b>	3 ft. 16/3 cord; change suffix 3 for longer cord (WP163SR-3)
<b>Q</b>	Quick disconnect receptacle (WP003MR) (order connecting cords separately)

\*For T5 and T5HO, EM ballast is fixed voltage, 120 or 277V, 50/60 Hz.

### Mounting style

<b>0</b>	Standard end cap with (1) strain relief connector	<b>4</b>	Same as #2, with wall mount brackets
<b>1</b>	Standard end cap, feed through with (2) strain relief connectors	<b>5</b>	Same as #3, with wall mount brackets
<b>2</b>	Center stud end cap with (1) strain relief connector and hanger brackets	<b>6</b>	Same as #2, with WP1050MTK straps
<b>3</b>	Center stud end cap, feed through with (2) strain relief connectors and hanger brackets	<b>7</b>	Same as #3, with WP1050MTK straps
		<b>8</b>	Same as #0, with WP1050MTK straps
		<b>9</b>	Same as #1, with WP1050MTK straps

## Dimensions

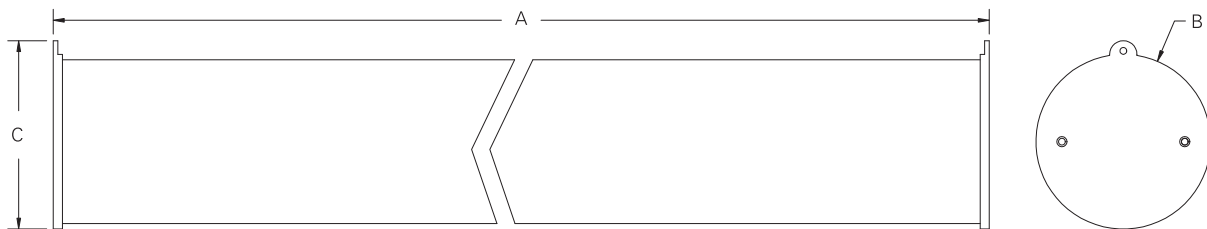

Nominal length	Dimensions in inches/centimeters			Carton W x D x L (inches)	Nominal weight	
	A	B	C		lbs.	kg.
2 foot	25.00 (63.50)	6.40 (16.30)	7.03 (17.86)	8-3/4 x 6-1/4 x 31-7/8	12.40	5.60
4 foot	49.00 (124.50)	6.40 (16.30)	7.03 (17.86)	8 x 8 x 51-1/4	20.30	9.20
8 foot	97.00 (246.40)	6.40 (16.30)	7.03 (17.86)	8 x 8 x 99-1/4	36.10	16.40

## Mounting options

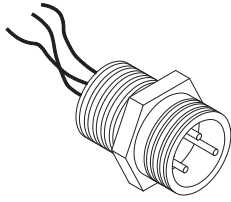

### WP003MR

**Quick disconnect receptacle**  
Required when WP163-6 cord assembly is used.

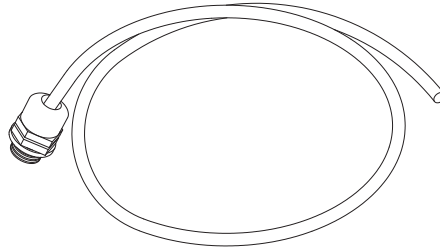

### WP163SR-6

**Cord assembly**  
Strain relief connector and 6 feet of #16/3 cable. If longer cable is required, change "6" suffix to length needed.

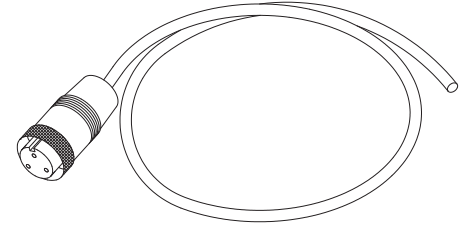

### WP163FP

**Cord assembly**  
Molded plug and 6 feet of #16/3 cable. If longer cable is required, change "6" suffix to length needed.

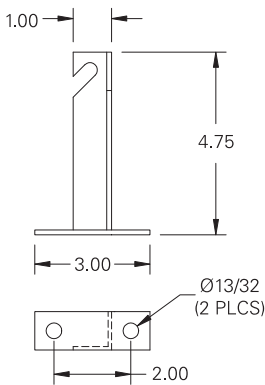

### FX7090

**Wall mount bracket**  
For center stud end caps.

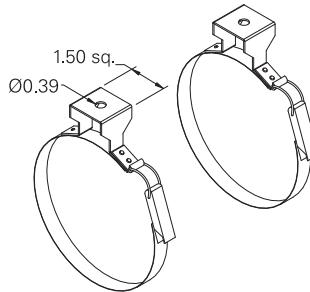

### WP1050MTK

**Quick release stainless steel straps**  
(2) included with mountings 6, 7, 8, 9.

## Mounting

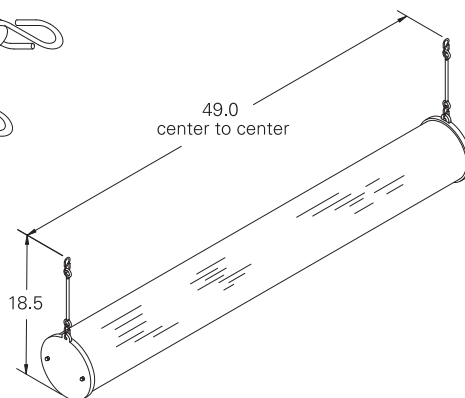
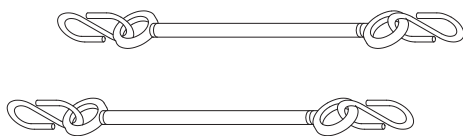

### WP1012MTK

**Suspended cable kit**  
(2) 12 inch nylon coated stainless steel cables with crimped-on loops; (2) "S" hooks.

*(if longer cable required, change "12" in the part number to required length)*

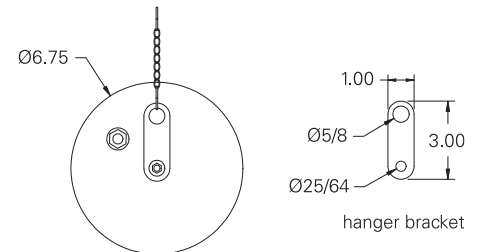

### Center stud end cap

Includes hanger bracket and stainless steel chain mount. *(mountings 2 & 3)*

**U.S. (global headquarters):  
Eaton's Crouse-Hinds Division**

1201 Wolf Street  
Syracuse, NY 13208

(866) 764-5454  
FAX: (315) 477-5179  
FAX Orders Only:  
(866) 653-0640

[crousecustomerctr@eaton.com](mailto:crousecustomerctr@eaton.com)

**For more information:**

If further assistance is required, please contact an authorized Eaton Distributor, Sales Office, or Customer Service Department.

**Canada**

Toll Free: 800-265-0502  
FAX: (800) 263-9504  
FAX Orders only: (866) 653-0645

**Mexico/Latin America/Caribbean**

52-555-804-4000  
FAX: 52-555-804-4020  
[ventascentromex@eaton.com](mailto:ventascentromex@eaton.com)

**Europe (Germany)**

49 (0) 6271 806-500  
49 (0) 6271 806-476  
[sales.CCH.de@cooperindustries.com](mailto:sales.CCH.de@cooperindustries.com)

**Middle East**

9714-8066100  
FAX: 9714-8894813  
[chmesales@eaton.com](mailto:chmesales@eaton.com)

**Singapore**

65-6645-9888  
FAX: 65-6297-4819  
[chsi-sales@cooperindustries.com](mailto:chsi-sales@cooperindustries.com)

**China**

86-21-2899-3600  
FAX: 86-21-2899-4055  
[cchsales@cooperindustries.com](mailto:cchsales@cooperindustries.com)

**Korea**

82-2-3484-6783  
82-2-3484-6778  
[CCHK-sales@cooperindustries.com](mailto:CCHK-sales@cooperindustries.com)

**Australia**

61-2-8787-2777  
FAX: 61-2-9609-2342  
[CEASales@cooperindustries.com](mailto:CEASales@cooperindustries.com)

**India**

91-124-4683888  
FAX: 91-124-4683899  
[cchindia@eaton.com](mailto:cchindia@eaton.com)

**Eaton's Crouse-Hinds**  
1201 Wolf Street  
Syracuse, NY 13208  
[Crouse-Hinds.com](http://Crouse-Hinds.com)

**Eaton**  
1000 Eaton Boulevard  
Cleveland, OH 44122  
United States  
[Eaton.com](http://Eaton.com)

© 2016 Eaton  
All Rights Reserved  
Printed in USA  
Publication No. 5291-0416  
April 2016

Eaton is a registered trademark.  
All other trademarks are property of their respective owners.