

Pauluhn™ LED Luminaires

LBN Berth Light

Installation & Maintenance Information

SAVE THESE INSTRUCTIONS FOR FUTURE REFERENCE

IMPORTANT

1. Read carefully before installing and wiring luminaire and retain for future reference.
2. Check the label rating to ensure the luminaire is suitable for the environment and supply.
3. The luminaire should be installed in accordance with the National Electrical Code (NEC) and any codes having jurisdiction over the installation area.
4. These luminaires are not suitable for hazardous locations.
5. All luminaires must be properly grounded.
6. These luminaires are supplied with one 1/2" NPT and one 3/4" NPT knockouts.
7. Disconnect the luminaire from the supply circuit before opening.
8. Do not attempt to install this luminaire unless you are familiar with warnings, cautions and procedures outlined in this information sheet.

When using electrical equipment, basic safety precautions should always be followed, including the following:

WARNING

To avoid personal injury, fire, shock and/or equipment failure,

Risk of electrical shock hazard, only qualified personnel should conduct this procedure! Do not make electrical connections with the power ON. Use cu or cu clad wire only, rated minimum 75°C. Convenience outlet is rated for 125 VAC, maximum 15 Amps. Maximum operating temperature 35°C.

INSTALLATION AND ELECTRICAL WIRING

1. Do not attempt to touch the LEDs.
2. Make (2) mounting holes for minimum #10 screws (not provided) per mounting dimensions below.

NOTE: This luminaire is for wall mount only.

3. Loosen thumb screws (9A) (4x) and remove cover (0A).
4. Loosen screws (2B) (4x) and takeout reflector (3A).
5. Remove receptacle screws (4B) (2x) and receptacle (4A).
6. Remove knockout on back of housing and install fitting (not provided) to housing (0B). If the knockouts on the end of the luminaire must be used, caution must be taken to carefully cut clearance slots on the housing cover (0A), so as to clear the electrical fittings when the cover is replaced. This can be done using the proper size hole saw and a jig saw.
7. Route supply cable (not provided) through fitting and tighten securely.
8. Secure luminaire to wall with (2) minimum #10 screws (not provided).
9. Strip the supply cable(s) jacket back approximately 2". Strip the insulation of ground and supply wires approximately 3/8".

WARNING

See product label for voltage input and amperage load per luminaire.

10. Push all wires and connections inside housing area (0B).
11. Install receptacle (4A) such that the flange of receptacle (4A) is in contact with the inside wall of the housing (0B) and the screws (4B)(2x) are fastened from outside with torque of 10 in-lbs.
12. Place reflector (3A) and tighten screws (2B) (4x).
13. Replace cover (0A) and tighten thumb screws (9A) (4x).
14. Apply power and inspect for proper operation.

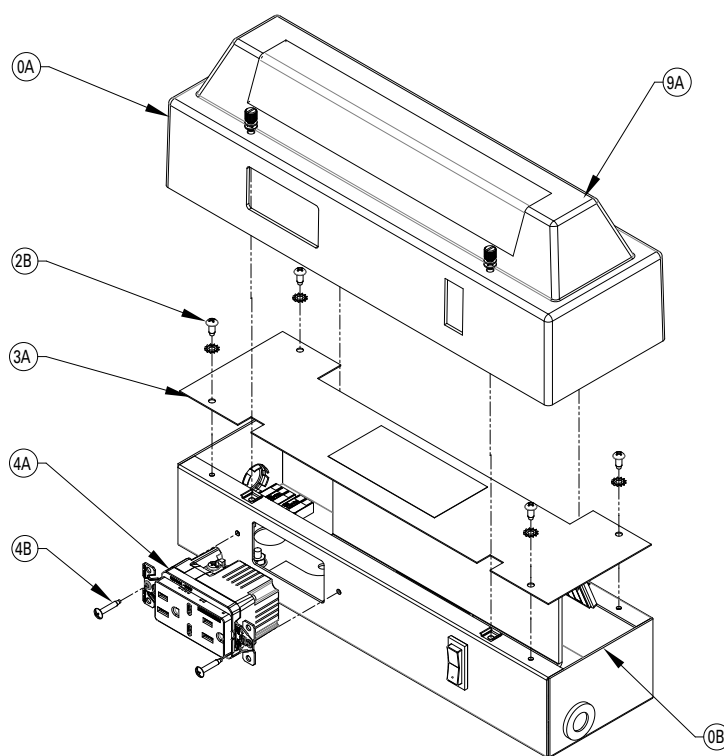

Figure 1. Overall dimensions

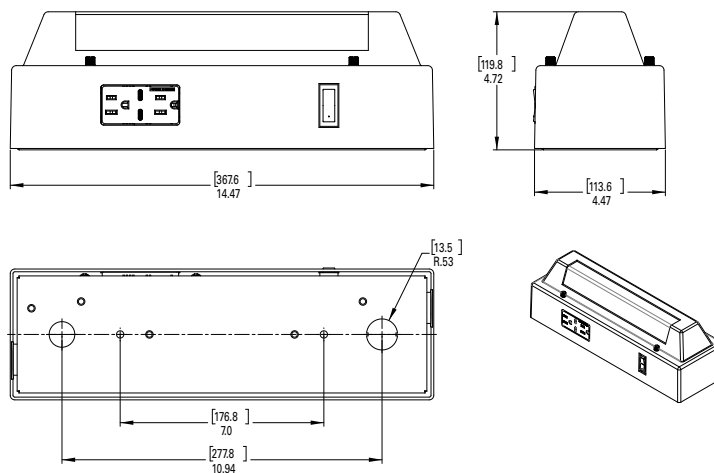
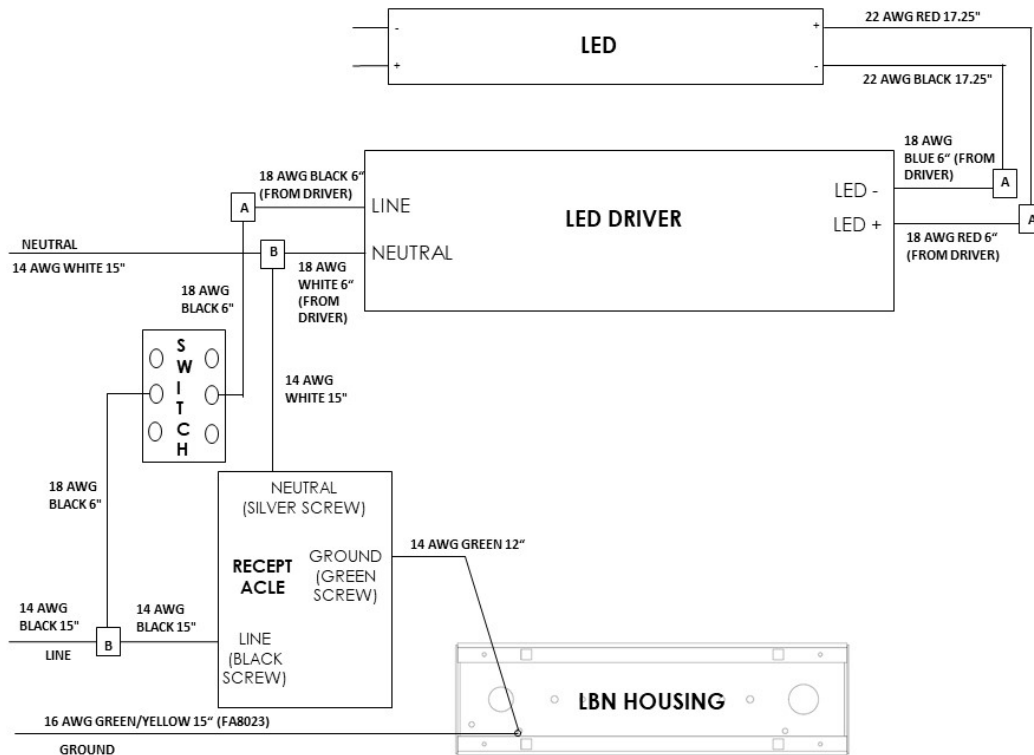

Figure 1. Overall dimensions

IMPORTANT INSTRUCTIONS FOR USB PORT:

1. **The USB ports are for charging purposes only and not data transfer.**
2. The 5.0A DC Rating is a combined rating for both USB ports. The maximum that an individual USB port will supply is 3.0A.
3. Compliant with the USB Type C standard, the device will intelligently communicate the appropriate charging level based on the device's charging requirements.
4. In the event that both ports are in use, priority will be given to the first device plugged in, and the second device plugged in may be limited to less than 3.0A.
5. A compliant USB Type C cable rated at least 3.0A is also required to get maximum charging capacity.
6. The charging indicator on the electronic device will illuminate when it is plugged into the USB port on the receptacle and is receiving a charge.
7. If the charging indicator on the electronic device does not illuminate, please verify that the charging cable being used is compatible with the USB Type C charging standard.

WIRING DIAGRAM:



MAINTENANCE GENERAL

1. Perform visual, electrical and mechanical inspections on a regular basis. The environment and frequency of use should determine this. However, it is recommended that checks be made at least once a year. We recommend an Electrical Preventive Maintenance Program as described in the National Fire Protection Association Bulletin NFPA No. 70B: Recommended Practice For Electrical Equipment Maintenance (www.nfpa.org).
2. The lens should be cleaned periodically to ensure continued lighting performance. To clean, wipe the lens with a clean, damp cloth. If this is not sufficient, use a mild soap or a liquid cleaner such as Collinite NCF or Duco #7. Do not use an abrasive, strong alkaline, or acid cleaner. Damage may result.
3. Visually check for undue heating evidenced by discoloration of wires or other components, damaged parts or leakage evidenced by water or corrosion in the interior. Replace all worn, damaged or malfunctioning components, and clean gasket seals before putting the luminaire back into service.

4. Electrically check to make sure that all connections are clean and tight. Mechanically check that all parts are properly assembled.
5. Check and re-torque all mounting hardware.
6. To prevent heat build-up, remove dust from the LED housing using a soft brush or air pressure.

REPLACEMENT PARTS

Eaton's Crouse-Hinds series linear LED luminaires are designed to provide years of reliable lighting performance. However, should the need for replacement parts arise, they are available through your authorized Eaton's Crouse-Hinds distributor. Assistance may also be obtained through your local Eaton's Crouse-Hinds representative or the Eaton's Crouse-Hinds Sales Service Department, 1201 Wolf Street, Syracuse, New York 13208, Phone 866-764-5454.

All statements, technical information and recommendations contained herein are based on information and tests we believe to be reliable. The accuracy or completeness thereof are not guaranteed. In accordance with Eaton's Crouse-Hinds Division's "Terms and Conditions of Sale," and since conditions of use are outside our control, the purchaser should determine the suitability of the product for his intended use and assumes all risk and liability whatsoever in connection therewith.