

Applications:

- Mid and low bay
- Wet environments
- Food and beverage processing facilities
- Wastewater treatment plants
- Storage areas

Features:

- Fluorescent system provides energy savings up to 50% when compared to HID
- Third party certified for operation in high ambient temperatures, up to 65°C (149°F)
- Multi-voltage electronic ballast resistant to brownouts or voltage and frequency fluctuations
- Continuous form-in-place closed cell gasket and field replaceable lens
- Through feed design or optional pendant hub design
- USDA compliant materials
- Meets Canadian Processed Products Regulations C.R.C. c291
- Full steel interior channel assembly reinforces hub entry and provides continuous ground
- Optional self-contained emergency battery back-up ballasts

Certifications and compliances:

- UL1598 – Luminaires
- UL924 – Emergency Lighting Equipment
- CSA C22.2 250 04
- CSA C22.2 141
- Canadian Processed Products Regulations C.R.C. c291
- NSF/ANSI 2-2007 Splash Zone
- Enclosed and gasketed
- Type 3R
- NSF

Standard materials and finishes:

- Housing – fiberglass-reinforced polyester
- Lens – matte acrylic (standard); matte polycarbonate (optional)
- Reflector – steel with white gloss finish
- Gasket – permanently mounted closed cell neoprene
- Latches – non-metallic (standard); stainless steel (optional)
- Locking sockets – industrial grade high temperature PBT (RS models only)

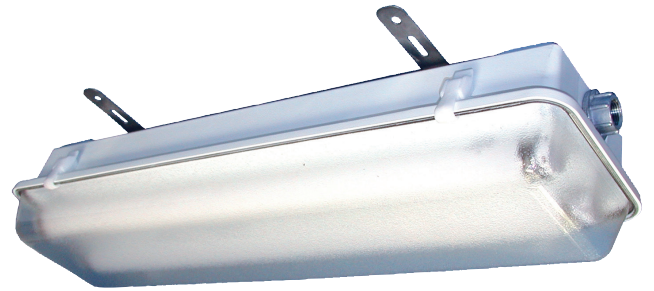

Technical specifications:

- Entries – through feed clearance holes with two 1/2" NPT hubs, one on each end
- Lamp holder – spring loaded (HO models only)
- Ballast – 120-277V, 50/60 Hz electronic

Watts	Ballast / socket type	ANSI lamp code	Starting temperature	Max. ambient °C	Supply wire °C
17	T8 bi-pin G13	F17-T8	0°F (-18°C)	55	90
32	T8 bi-pin G13	F32-T8	-20°F (-29°C)	55	90
40	4-pin 2G11	FT40-CF	0°F (-18°C)	40	90
24/54	T5HO mini bi-pin G5	F24/F54-T5HO	-20°F (-29°C)	55	90
14/28	T5 mini bi-pin G5	F14/F28-T5	0°F (-18°C)	55	90
44/86	T8HO RDC R17d	F48/F96-T8HO	-20°F (-29°C)	40	90
35/60/110	T12HO RDC R17d	F24/F48/F96-T12HO	-20°F (-29°C)	40	90

- Emergency battery back-up ballast – optional, self-contained 90 minute minimum for all lamp types; 120 minute minimum for F32T8 one lamp; starting temperature 32°F (0°C)

Photometrics:

- Complete photometrics can be found at www.crouse-hinds.com/photometrics

^AContact factory for optional higher ambient models.

Ordering information:

Part number example
VP42570**

VP
Model
VP

4
Length (nominal)
2 2 foot
4 4 foot
8 8 foot

2
Number of lamps
2 2 lamps
4 4 lamps (4 ft. with four F17 or 8 ft. with four F32, F54 or F48 lamp types)

5
Lamp type
1 2 ft. F17 or 4 ft. F32 (T8 bi-pin)
2 2 ft. FT40 (CF 2G11)
5 2 ft. F24 or 4 ft. F54 (T5HO mini bi-pin)
6 2 ft. F14 or 4 ft. F28 (T5 mini bi-pin)
7 4 ft. F48 or 8 ft. F96 (T8HO)
8 2 ft. F24, 4 ft. F48 or 8 ft. F96 (T12HO)

7
Voltage / frequency
7 120-277V, 50/60 Hz
6 347V, 60 Hz (contact factory)
9 480V, 60 Hz (contact factory)

0
Mounting style
0 Through feed with (2) ½" NPT hubs
1 Through feed with (2) ¾" NPT hubs
2 Pendant mount with (2) ½" NPT hubs
3 Pendant mount with (2) ¾" NPT hubs
4 Through feed with (2) ½" knockouts

Options
EM2[ⓑ] Emergency battery back-up ballast, one lamp, 277V max.
EMT2[ⓑ] Emergency battery back-up ballast, one lamp, 277V max., test switch
EM3[ⓑ] Emergency battery back-up ballast, high lumen, one lamp, 277V max.
EMT3[ⓑ] Emergency battery back-up ballast, high lumen, one lamp, 277V max., test switch
L[Ⓒ] Lamps
P Matte polycarbonate lens
S Switch, on/off
SSC Stainless steel latches
TSSC Tamper-proof stainless steel latches

[ⓑ]For T5 and T5HO, EM ballast is fixed voltage, 120 or 277V, 50/60 Hz.

[Ⓒ]Lamps are not included unless option 'L' is specified.

Pauluhn VersaPro industrial linear fluorescent luminaires

Type 3R

5L

Dimensions:

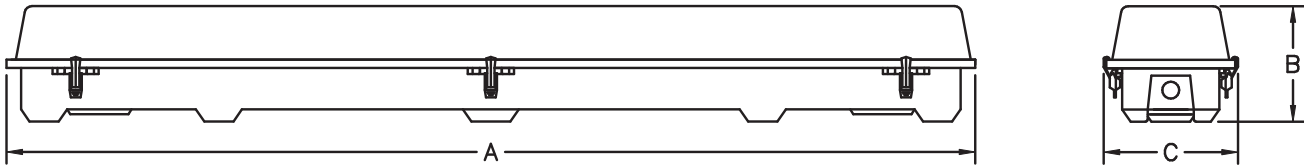

BOTTOM VIEW (TWO FOOT MODELS)

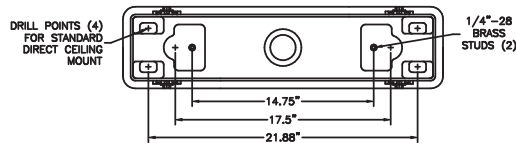

BOTTOM VIEW (FOUR FOOT MODELS)

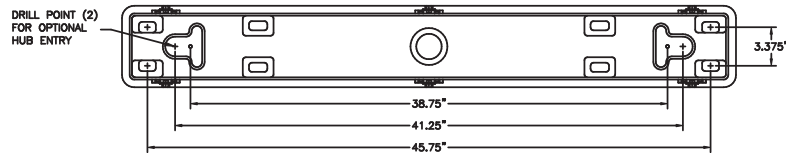

BOTTOM VIEW (EIGHT FOOT MODELS)

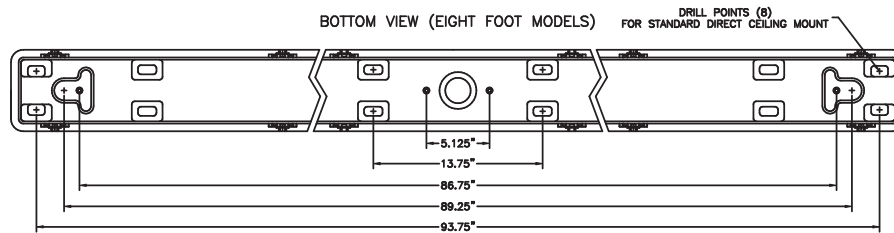

Dimensions in inches / centimeters

Nominal length	A	B	C	Carton L x W x D (in.)	Nominal weight lbs. (kg.)
2 foot	25.80 (65.60)	5.00 (12.70)	7.00 (17.78)	8 ³ / ₄ x 6 ¹ / ₄ x 31 ⁷ / ₈	8.50 (3.90)
4 foot, T5 and T8 models	49.81 (126.50)	5.00 (12.70)	7.00 (17.78)	8 ¹ / ₂ x 6 x 56 ¹ / ₁₆	12.00 (5.40)
4 foot, HO models	49.81 (126.50)	5.40 (13.72)	7.00 (17.78)	8 ¹ / ₂ x 6 x 56 ¹ / ₁₆	16.00 (7.30)
8 foot	97.81 (248.40)	5.40 (13.72)	7.00 (17.78)	8 x 8 x 99 ¹ / ₄	32.00 (14.50)

Mounting options:

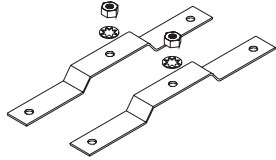

VP1091MTK

Fixed ceiling/wall mounting kit. (2) stainless steel brackets and hardware to mount brackets to fixture.

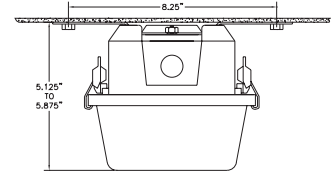
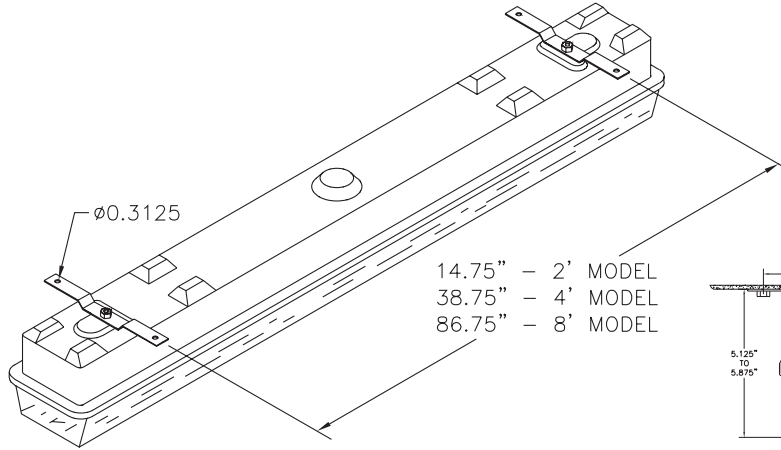

5L

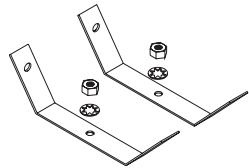

VP1093MTK

Fixed corner mounting kit. (2) stainless steel brackets and hardware to mount brackets to fixture.

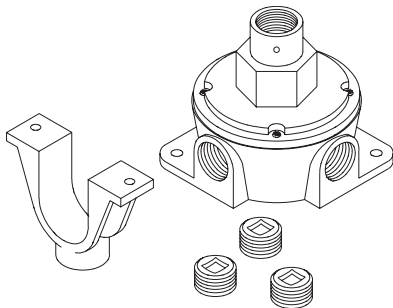
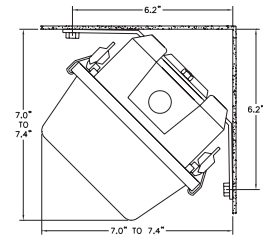
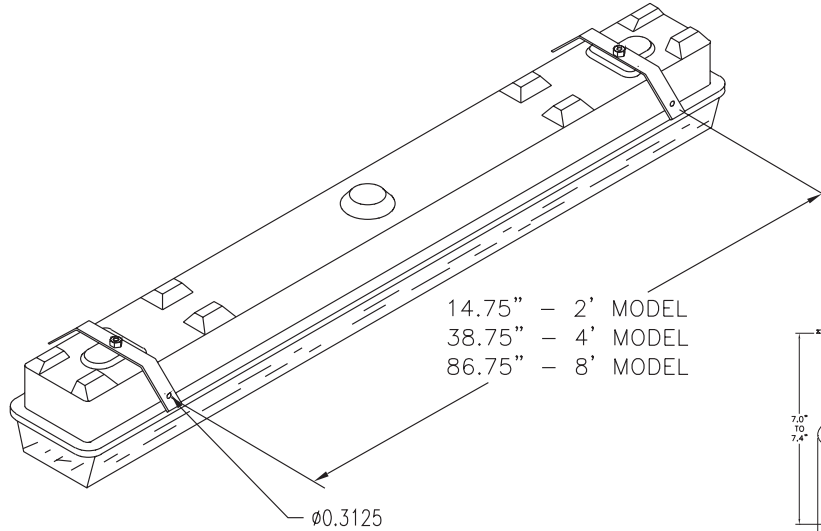

HP1095MTK

Pendant mounting kit. (1) saddle strap and (1) universal junction box and pendant cover (3/4" NPT).

