

Champ Voyager nR stainless steel floodlights

Cl. I, Div. 2, Groups A, B, C, D
Cl. I, Zone 2, AEx nR II, Group IIC
IEC Zone 2, Ex nR II ATEX

Marine & Wet Locations
NEMA Type 4X, IP66

6L

The Champ® Voyager nR™ stainless steel floodlight offers the industry's coolest temperature ratings – so it can operate below the ignition temperature of vapors and gases in your classified area.

Standard terminal blocks and a removable ballast component tray bring you the best combination of easy wiring and simple maintenance in one rugged package.

Applications:

- Oil and gas refineries, drilling rigs, petrochemical facilities, food and beverage facilities, platforms, loading docks, tunnels, outdoor wall and stanchion mounted general area lighting, and where flammable vapors, gases, ignitable dusts, fibers or flyings are present
- Classified and hazardous locations or where extremely corrosive, wet, dusty, hot and/or cold conditions exist

Features:

- AEx nR, Ex nR restricted breathing rating is standard – a hazardous location luminaire with excellent T3 and T4 ratings without additional accessories or options
- NEMA 7x6 butterfly beam floodlight pattern – wide, uniform and far-reaching to reduce the number of luminaires you need, providing excellent luminaire efficiency – more light where you need it
- Easy wiring – standard terminal block with marked terminals saves time and eliminates wiring errors
- Removable ballast component tray – for capacitor, igniter and terminal block to simplify maintenance and save money
- Housing, hinges, door frame and mounting yoke are all 316 stainless steel for marine and wet locations – robust construction suitable for salt water and corrosive applications

Certifications and compliances:

NEC/CEC (NEC ballast gear and socket):

- Class I, Division 2, Groups A, B, C, D
- Class I, Zone 2, AEx nR II, Group IIC
- NEMA Type 4X, IP66

IEC/NEC/CEC (IEC ballast gear and socket):

- IEC Zone 2, Ex nR II ATEX

UL standards:

- UL844 – Hazardous (Divisions Classified) Locations
- UL1598 – Luminaires
- UL1598A – Supplemental Requirements for Luminaires for Installation on Marine Vessels

Standard materials:

- Enclosure (housing and lens frame) – 316 stainless steel
- Lens – heat- and impact-resistant tempered glass
- Gaskets – silicone rubber
- Yoke and yoke bracket – 316 stainless steel
- Reflector – formed specular (dimpled glossy surface) aluminum
- Cable gland cord grip and locknut – polyamide 6, neoprene bushing

Standard finish:

- 316 stainless steel – natural

Photometrics:

- Complete photometrics can be found at www.crouse-hinds.com/photometrics



Available with IEC gear and certified to the IECEx/ATEX directive

The only mogul base Class I, Division 2 and Zone 2 stainless steel floodlight with restricted breathing (vaportight design) as standard construction

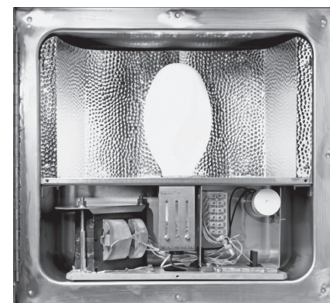

Easy to install and maintain:

- Removable ballast tray
- Pre-wired to terminal blocks
- Substantial room for wiring

Electrical ratings:

Sources/wattages (mogul base lamps):

- High pressure sodium (HPS) – 150, 250, 400W
- Metal halide (MH) – 175, 250, 400W

Voltages:

Standard voltage ballasts

- Multi-tap (120, 208, 240, 277V, 60 Hz)
- 480V, 60 Hz
- Tri-tap (120, 277, 347V, 60 Hz)

Optional voltage ballasts

- 220V or 240V, 50 Hz

Hub size:

- Standard – 3/4" NPT with a 3/4" gland sealing connector

Champ Voyager nR stainless steel floodlights

Cl. I, Div. 2, Groups A, B, C, D
Cl. I, Zone 2, AEx nR II, Group IIC
IEC Zone 2, Ex nR II ATEX

Marine & Wet Locations
NEMA Type 4X, IP66

6L

Ordering information:

Part number example

SSFMSVSY150/MT M25

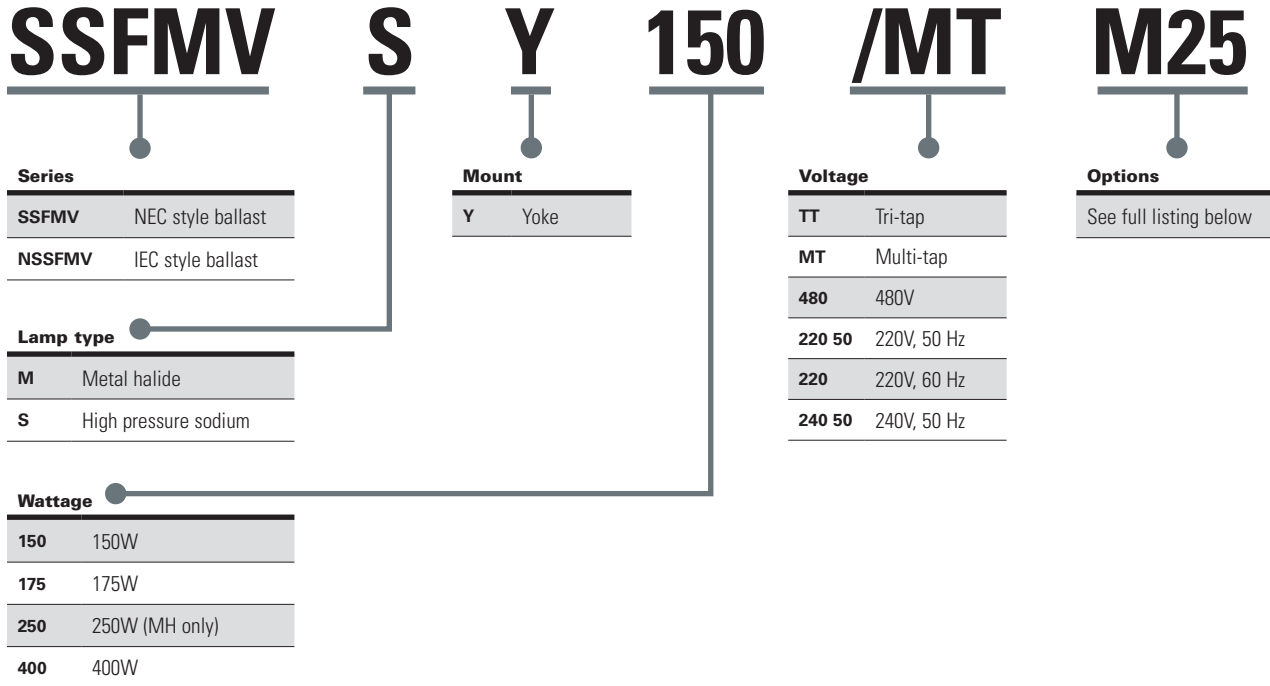

Options:

Description	Suffix
<ul style="list-style-type: none"> Instant restrike and Ballast-Gard TIR <i>Instant restrike – enables a hot HPS lamp to immediately restrike after a momentary loss of arc due to voltage fluctuation or power outage</i> <i>Ballast-Gard starter cut-out switch – prevents starter pulsing when lamp is cycling or inoperative; prolongs ballast and ignitor life</i> <i>150W LX HPS only</i> Factory assembled with HID lamp installed FA Fused S658 <i>Not suitable for marine applications</i> 20mm metric thread for conduit opening M20 25mm metric thread for conduit opening M25 Furnished with lamps (not installed)..... S714 Pulse start metal halide S828 Enclosure machined with two conduit/cable entries S886 	

Accessories (ordered separately):

Description	Cat. #
<ul style="list-style-type: none"> Stainless steel slipfitter adapter SFA6 SS Stainless steel wall bracket SWB6 SS Standard slipfitter adapter (cast aluminum with epoxy coat) ... SFA6 Standard wall bracket (cast aluminum with epoxy coat) SWB6 <p>Photocells in DS cover for use with FS/FD box:</p> <ul style="list-style-type: none"> 120V, 50/60 Hz D2S20 208-277V, 50/60 Hz D2S208 277 	

Champ Voyager nR stainless steel floodlights

Cl. I, Div. 2, Groups A, B, C, D
Cl. I, Zone 2, AEx nR II, Group IIC
IEC Zone 2, Ex nR II ATEX

Marine & Wet Locations
NEMA Type 4X, IP66

6L

Dimensions:

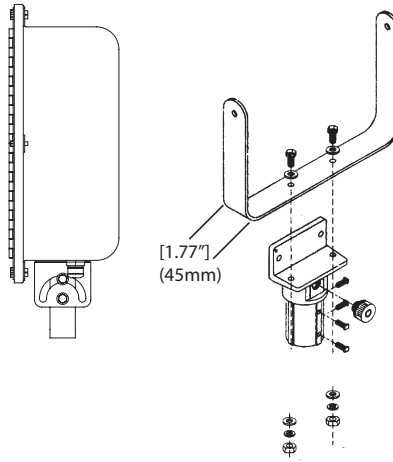
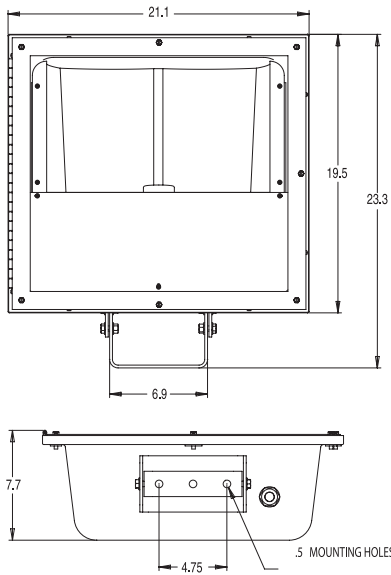

Weights:

Lamp watts	Weight (lbs.)	
	SSFVMS	SSFVMM
150	39.00	39.00
175	39.00	39.00
250	43.00	41.00
400	45.00	43.00

Temperature performance data:

Series	Lamp type	Lamp watts	40°C ambient			55°C ambient			Fixture aiming	
			Temperature code			Temperature code			Range	Figure
			Class I, Zone 2	Class I, Div. 2	Supply wire °C	Class I, Zone 2	Class I, Div. 2	Supply wire °C		
SSFVMS	High pressure sodium	150 ^A	T4	T2B	90	T4	T2B	105	120°	2
		250 ^A	T4	350	90	T3	350	105	90°	1
		400	T3	T1	90	—	—	—	90°	1
SSFVMM	Metal halide	175 ^A	T3	T2	90	T3	T2	105	120°	2
		250 ^A	T3	325	90	T3	325	105	90°	1
		400	T3	325	105	—	—	—	90°	1

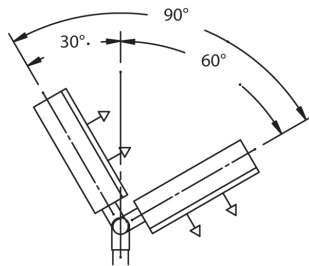

Figure 1

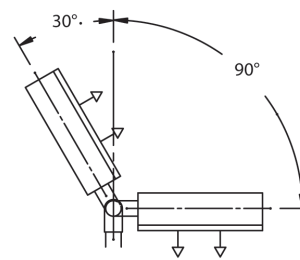

Figure 2

^A Suitable for use in +55°C ambient without optional fuses.