

Champ Pro PLL LED luminaires

UL Listed
CSA Certified
Wet Locations
Type 4X; IP66

2L

The Champ® Pro PLL linear LED is specifically designed to replace fluorescent T12, T8 and T5HO lighting in heavy and harsh industrial applications. The rugged and durable design features the industry's most versatile and flexible mounting options. The PLL is the ideal solution for high vibration, impact and hose down applications.

| Model | Typical lumens | Watts | Lumens per watt | Equivalent HID luminaire | Typical energy savings / lifetime |
|-------|----------------|-------|-----------------|--------------------------|-----------------------------------|
| PLL2 | 3,958 | 32 | 124 | T12HO | Up to 63% |
| | | | | T8HO | Up to 59% |
| | | | | T5HO | Up to 47% |
| | | | | T12 | Up to 36% |
| | | | | T8 | Up to 25% |
| PLL4 | 7,900 | 63 | 130 | T5 | Up to 9% |
| | | | | T12HO | Up to 58% |
| | | | | T8HO | Up to 54% |
| | | | | T5HO | Up to 43% |
| | | | | T12 | Up to 37% |
| | | | | T8 | Up to 22% |
| | | | | T5 | Up to 10% |

Applications:

- Ideal for a variety of non-hazardous applications, such as mining, food processing, marine, wastewater treatment, heavy manufacturing and general wash down areas

Features:

- High efficacy: up to 120 LPW
- -40°C to +65°C ambient operating temperature (standard model)
- Low profile (<3" height)
- Versatile ceiling/swivel, wall, flush, pole and pendant mounting options
- Wide and narrow optics for uniform illumination
- Four points of secondary retention
- 2,000 PSI high pressure hose rated
- High vibration resistance
- Emergency battery back-up (90 minutes) and surge protection options (up to 10 kV)^A
- DesignLights Consortium® Qualified (some models are not DLC qualified)^B
- 5 year fixture warranty (unless otherwise noted)

Certifications and compliances:

NEC/CEC:

- Type 4X, IP66
- Wet locations

UL standards:

- UL1598 – Luminaire
- UL1598A – Luminaire for Installation on Marine Vessels
- UL924 – Emergency Luminaires

CSA standard:

- C22.2 No. 250

Additional certifications:

- ABS design assessed



Standard materials:

- Housing – copper-free aluminum; Corro-free epoxy powder coat (optional)
- Lens – clear polycarbonate; diffused polycarbonate

Photometrics:

- Complete photometrics can be found at www.crouse-hinds.com/photometrics

Mounting (ordered separately):

Versatile mounting options:

- Flush back mount
- Swivel/ceiling back mount
- Offset ceiling mount
- Offset wall mount
- Pole mount
- Pendant mount

Electrical ratings:

| | PLL2 | PLL4 |
|--------------|---------------------------------------|----------|
| Lumen output | 3,958 | 7,900 |
| Frequency | 50/60 Hz | 50/60 Hz |
| Voltage | 100-277 VAC, 108-250 VDC; 347-480 VAC | |

| Model | Voltage | Current (A) | Watts | Power factor | THD |
|------------|---------|-------------|-------|--------------|------|
| PLL2/UNV1 | 100 | 0.33 | 32.5 | 0.92 | <20% |
| PLL2/UNV1 | 277 | 0.13 | 34.3 | 0.92 | <20% |
| PLL2/UNV34 | 347 | 0.10 | 32.2 | 0.92 | <20% |
| PLL2/UNV34 | 480 | 0.07 | 34.5 | 0.92 | <20% |
| PLL4/UNV1 | 100 | 0.63 | 63.4 | 0.92 | <20% |
| PLL4/UNV1 | 277 | 0.23 | 62.5 | 0.92 | <20% |
| PLL4/UNV34 | 347 | 0.18 | 61.4 | 0.92 | <20% |
| PLL4/UNV34 | 480 | 0.13 | 63.9 | 0.92 | <20% |

Weights:

| Model | Lbs. | Kg. |
|-------|-------|-------|
| PLL2 | 12.50 | 5.70 |
| PLL4 | 22.50 | 10.20 |

^AOne year warranty.

^BRefer to www.designlights.org Qualified Products List under Family Models for full listing details. Not all models are approved for all application categories.

Champ Pro PLL LED Luminaires

UL Listed
CSA Certified
Wet Locations
Type 4X; IP66

2L

2L

Designed to last. Champ Pro PLL linear LED luminaires are engineered to handle demanding conditions. The PLL stands up to high vibration, hose down, shock and impact, while delivering long life and high lumen performance for up to 20 years.

Custom optics:

- Standard wide (120°) beam spread for control room and indoor application maximizes illumination on wall panels
- Narrow (80°) beam spread option for targeted illumination; avoids spillage and light loss

Quick & easy installation:

- Easy access to drivers and wiring
- No custom brackets or hardware needed
- Seven mounting options available
- Plug 'n play LynxPOWER™ cordset and receptacle for daisy chaining multiple fixtures and ease of install (optional)



Slim profile:

- 2.7" fixture height (excluding mounting brackets)
- Perfect for mounting in confined or low height areas

Built to last:

- Vibration-, impact- and shock-resistant – passed 5G, 3-axis vibration test
- 60,000 hour lifetime at 55°C ambient
- Ingress protection from dust and water



High efficacy:

- Up to 123 lumens per watt

Champ Pro PLL LED luminaires

UL Listed
CSA Certified
Wet Locations
Type 4X; IP66

2L

Ordering information:

Part number example

PLL4N/UNV1 S903 TF P EM1

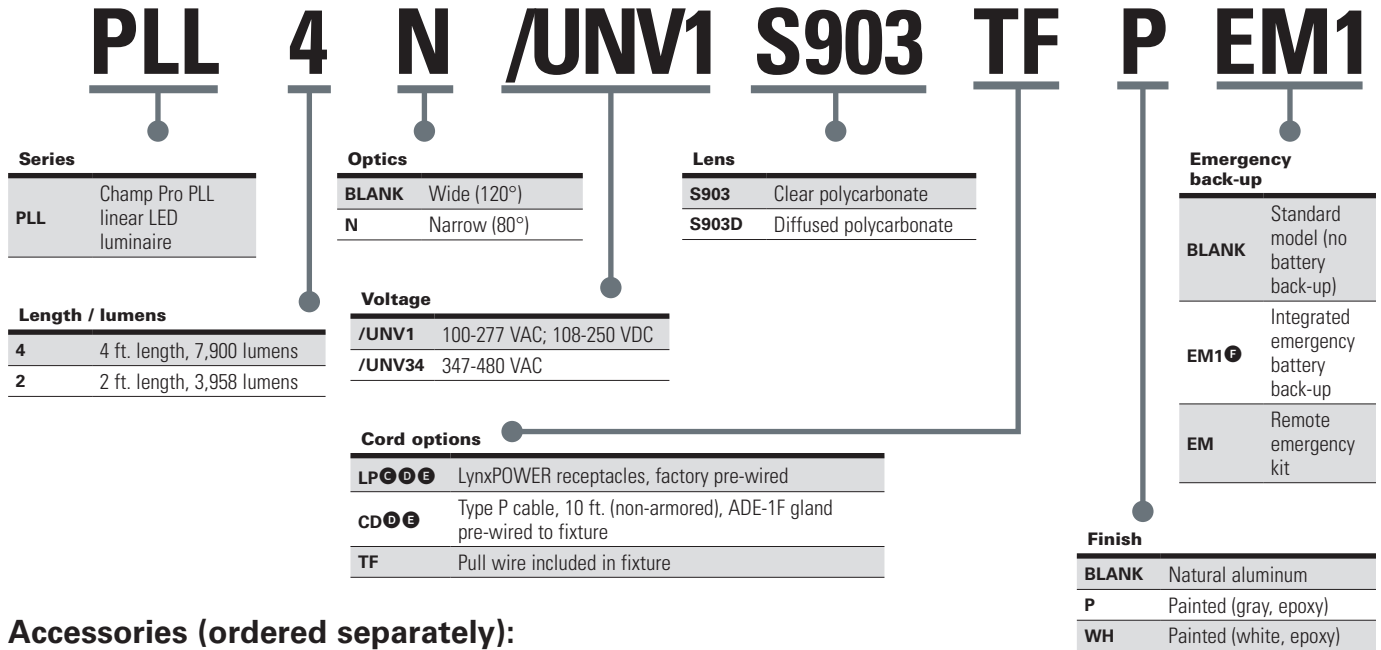

Accessories (ordered separately):

| Description | Cat. # | Description | Cat. # |
|--|----------------------|---|--------------------------------|
| • Flush/back mount back plate..... | DP1057MTK | • 1 amp driver replacement kit, 90-277 VAC for 4 ft. linear..... | VMVL/UNV1 80W 1A KIT |
| • Ceiling/swivel mount..... | DP1050MTK | • 1 amp driver replacement kit, 347-480 VAC for 4 ft. linear..... | VMVL/UNV34 80W 1A KIT |
| • Ceiling/wall mount offset..... | DP1053MTK | • 0.5 amp driver replacement kit, 90-277 VAC for 2 ft. linear..... | VMVL/UNV1 80W 0.5A KIT |
| • Ceiling mount bracket and adapter kit..... | MP1054MTK KIT | • 0.5 amp driver replacement kit, 347-480 VAC for 2 ft. linear..... | VMVL/UNV34 80W 0.5A KIT |
| • Offset wall mount..... | DP1052MTK | • 6 ft. Mini-Line LynxPOWER cordset..... | ML3A4WC060F |
| • Pole mount kit, 1.25" conduit..... | PM KIT 1.25 | • 12 ft. Mini-Line LynxPOWER cordset..... | ML3A4WC120F |
| • Pole mount kit, 1.50" conduit..... | PM KIT 1.5 | | |
| • Pole mount kit, 2.00" conduit..... | PM KIT 2.0 | | |
| • Pendant mount kit..... | PEND ORD KIT | | |
| • Safety chain kit..... | SS KIT | | |

Dimensions and mounting options:

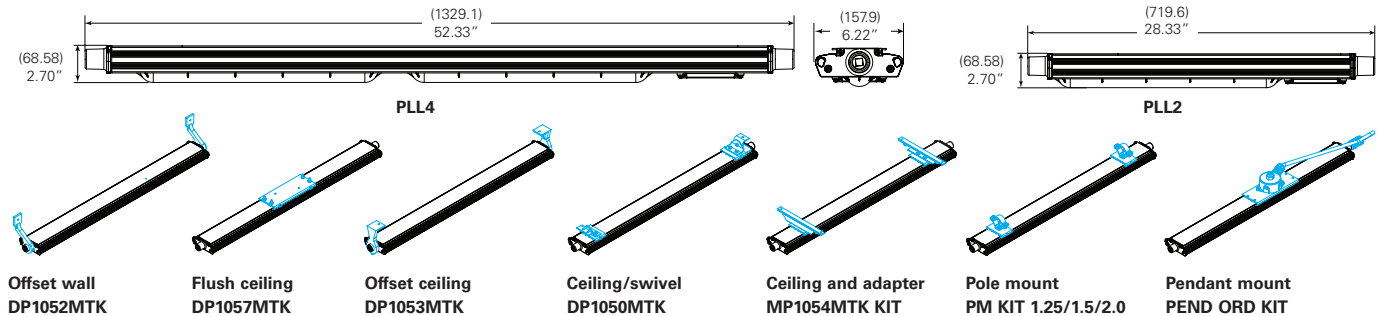

- Ⓒ All ML3C4WC Mini-Line LynxPOWER cordsets can be utilized. Refer to Accessories section for catalog number.
- Ⓓ Cannot be combined with 'TF' suffix.
- Ⓔ Standard model only (no battery back-up).
- Ⓕ One year warranty. Remote EM kit also available, 120-277 VAC only. Available with 4 ft. model only.
- Ⓖ Additional lengths available. Contact Customer Service for additional options.

2L

Mounting options:

Ceiling/swivel mount DP1050MTK

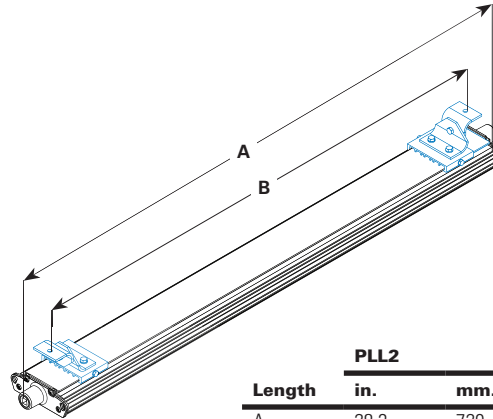
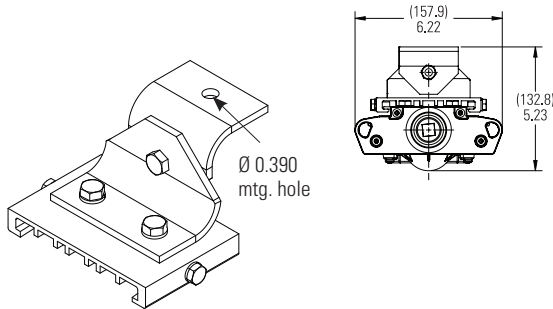

| Length | PLL2 | | PLL4 | |
|--------|------|---------|------|----------|
| | in. | mm. | in. | mm. |
| A | 28.3 | 720 | 52.3 | 1329 |
| B | 9-27 | 222-681 | 9-51 | 222-1289 |

Pole mount PM KIT 1.25/1.5/2.0

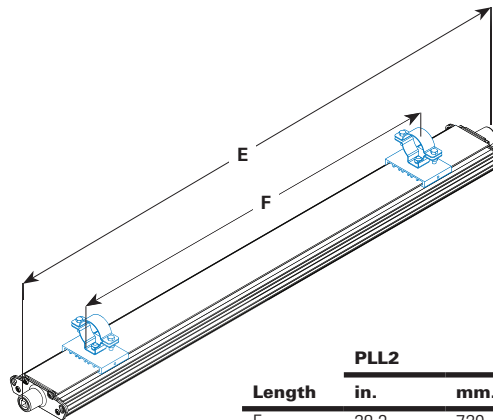
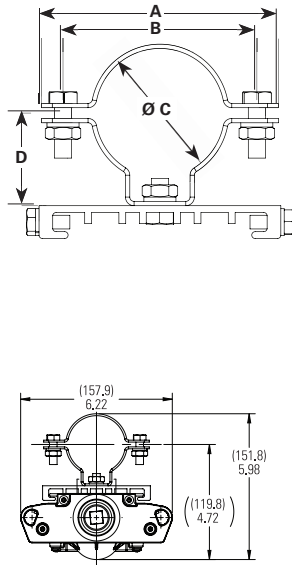
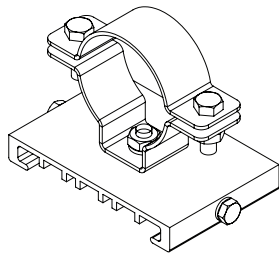

ALL MEASUREMENTS IN INCHES

| Configuration | A | B | C | D |
|---------------|-------|-------|-------|-------|
| PM KIT 1.25 | 4.331 | 3.543 | 1.680 | 1.693 |
| PM KIT 1.5 | 3.740 | 2.953 | 2.000 | 1.535 |
| PM KIT 2.0 | 3.386 | 2.598 | 2.360 | 1.378 |

| Length | PLL2 | | PLL4 | |
|--------|-------|---------|-------|----------|
| | in. | mm. | in. | mm. |
| E | 28.3 | 720 | 52.3 | 1329 |
| F | 12-21 | 305-533 | 24-45 | 610-1143 |

MagnaPro mount MP1054MTK KIT

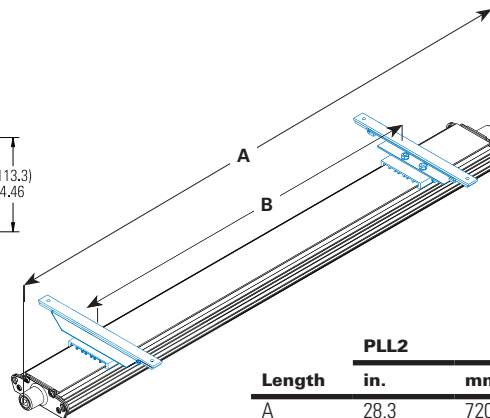
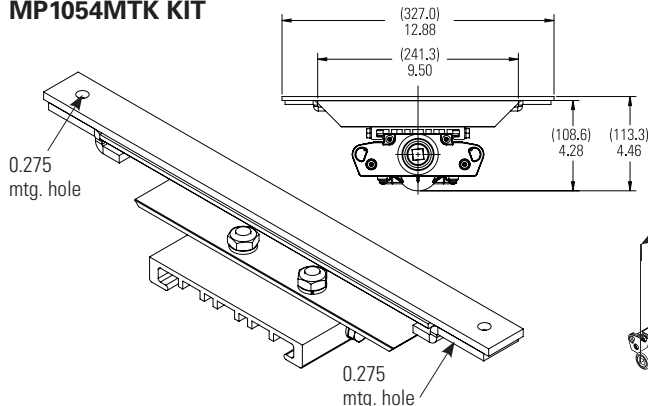

| Length | PLL2 | | PLL4 | |
|--------|-------|---------|-------|----------|
| | in. | mm. | in. | mm. |
| A | 28.3 | 720 | 52.3 | 1329 |
| B | 12-22 | 305-559 | 24-46 | 610-1168 |

Champ Pro PLL LED Luminaires

UL Listed
CSA Certified
Wet Locations
Type 4X; IP66

2L

2L

Mounting options (continued):

Offset wall DP1052MTK

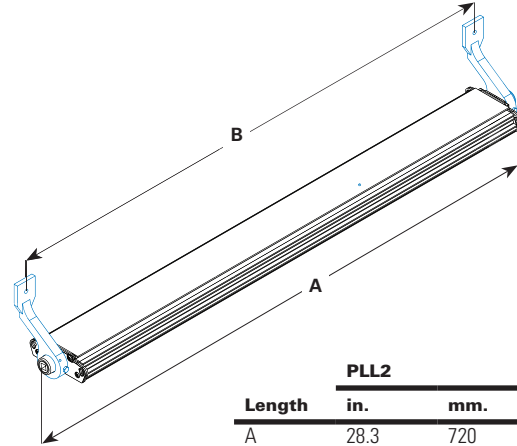
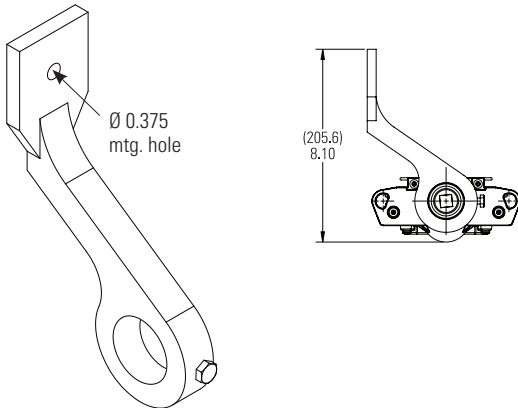

| Length | PLL2 | | PLL4 | |
|--------|------|-----|------|------|
| | in. | mm. | in. | mm. |
| A | 28.3 | 720 | 52.3 | 1329 |
| B | 26.3 | 669 | 50.3 | 1278 |

Offset ceiling/wall mount DP1053MTK

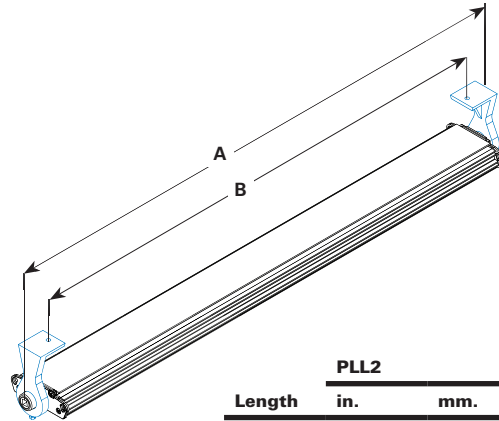
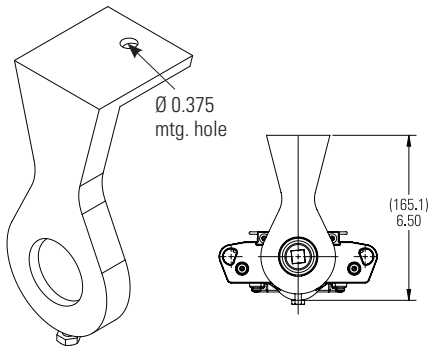

| Length | PLL2 | | PLL4 | |
|--------|------|-----|------|------|
| | in. | mm. | in. | mm. |
| A | 28.3 | 720 | 52.3 | 1329 |
| B | 26.3 | 584 | 47.0 | 1194 |

Flush ceiling DP1057MTK

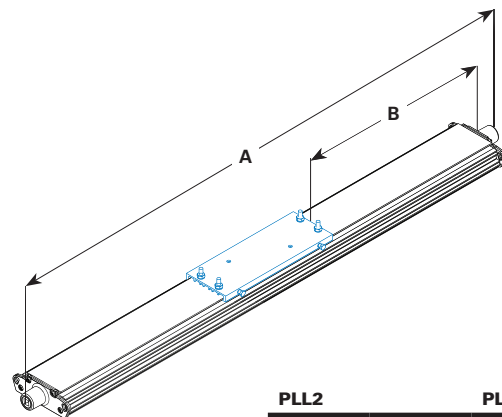
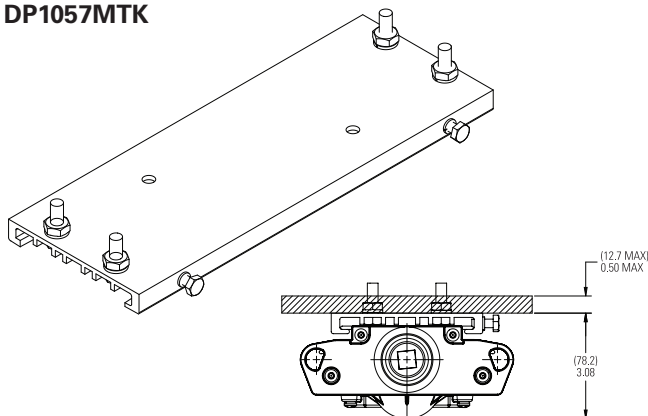

| Length | PLL2 | | PLL4 | |
|--------|------|-------|------|------|
| | in. | mm. | in. | mm. |
| A | 28.3 | 720 | 52.3 | 1329 |
| B | 6.2 | 157.5 | 18.2 | 462 |

Champ Pro PLL LED luminaires

UL Listed
CSA Certified
Wet Locations
Type 4X; IP66

2L

2L Mounting options (continued):

Pendant mount
PEND ORD KIT

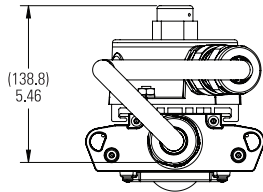
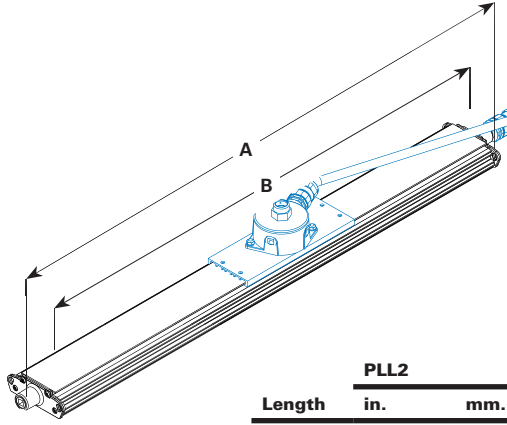
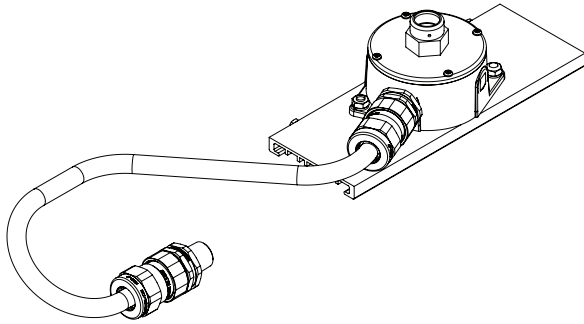

| Length | PLL2 | | PLL4 | |
|--------|------|-----|------|------|
| | in. | mm. | in. | mm. |
| A | 31.7 | 805 | 55.8 | 1418 |
| B | 28.3 | 720 | 52.3 | 1329 |
| C | 4.2 | 108 | 16.0 | 406 |
| D | 12.2 | 310 | 24.0 | 610 |
| E | 34.9 | 886 | 58.9 | 1495 |

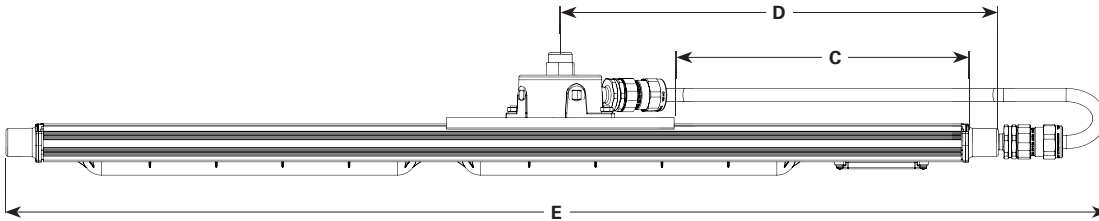

Champ Pro PLL LED Luminaires

Integral battery back-up

UL Listed
Wet Locations
Type 4X; IP66

2L

Champ Pro PLL linear LED luminaires are available with an integral battery back-up module. Virtually the same size as the standard 4 foot model and up to 90 minutes of emergency lighting to keep your facility and personnel safe.

| Model | EM output | Normal output |
|---------------|----------------------------|----------------------------|
| PLL4/UNV1 EM1 | 1,400 lumens (100-277V) | 6,720 lumens (100-277V) |

Applications:

- Egress and emergency lighting for areas requiring uninterrupted lighting during power failure
- Non-hazardous indoor and outdoor emergency lighting in manufacturing plants, heavy industrial, chemical and petrochemical facilities, platforms, loading docks and parking areas

Features:

- Operating ambient: 0°C to +40°C
- 90-minute run time in emergency mode
- 6,720 lumen output for normal operation; 1,400 lumen output in emergency mode
- 50,000 hours rated life at 40°C
- IP66 rated enclosure
- LED indicator to check battery operation
- Nickel cadmium battery
- Gray epoxy powder coat standard
- 1 year warranty

Certifications and compliances:

NEC/CEC:

- Wet locations, Type 4X, IP66

UL standards:

- UL1598 – Luminaires
- UL1598A – Marine
- UL924 – Emergency Lighting

Dimensions:

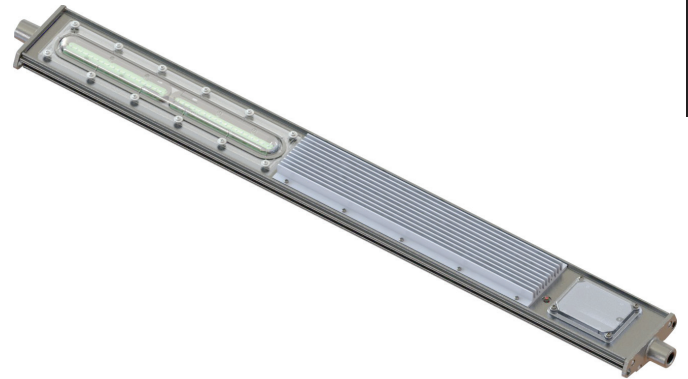
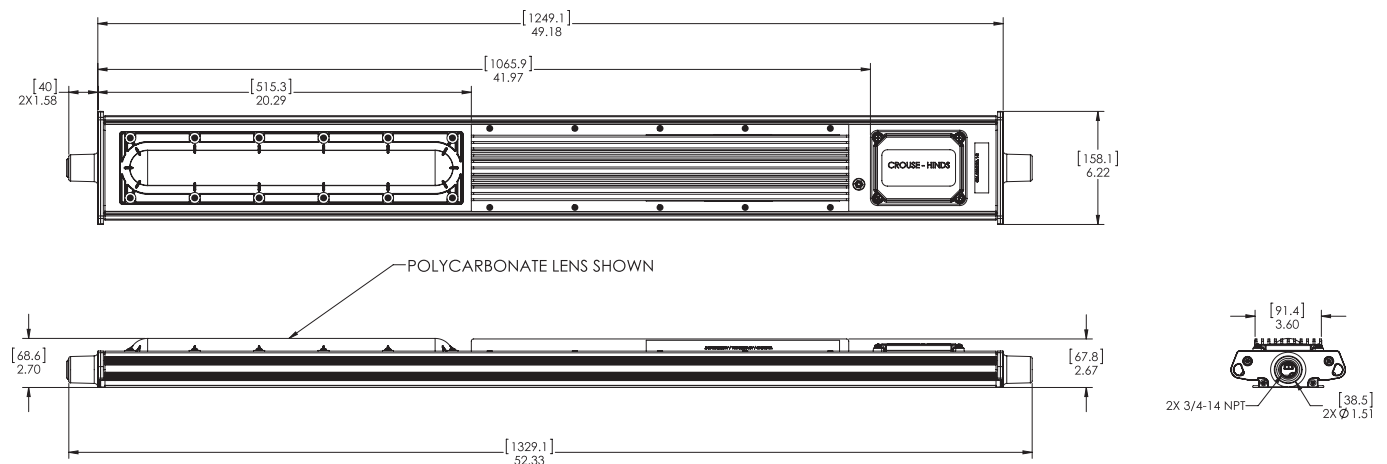

Electrical ratings:

| | EM output | Normal output |
|-------------------------|-----------|---------------|
| Voltage | 120 | 277 |
| Amperage at 120 VAC | 0.480 | 0.212 |
| Wattage at 120 VAC | 57.8 | 57.7 |
| Lumen output | 1,400 | 6,720 |
| Frequency | 50/60 Hz | 50/60 Hz |
| Power factor at 100 VAC | >0.90 | >0.90 |
| THD | 6.58 | 11.70 |

Photometrics:

- Complete photometrics can be found at www.crouse-hinds.com/photometrics