

4.8

Ex-Floodlight for high-pressure discharge lamps dTLS 85

4 (Zone 1, 2)

Ex-floodlight for high-pressure discharge lamps

The robust dTLS 85 floodlight and the GHG 664 emergency pack for use in hazardous areas in Zones 1 and 2 are suitable for illuminating large areas and objects. Due to the high degree of protection IP66, they are best suited for harsh environments, such as offshore oil and gas production plants or industrial, chemical and petrochemical plants, oil and gas production plants, pipelines, refineries and loading ramps. High-pressure discharge lamps from 70 W to 250 W provide a high illuminance level.

dTLS 85 - versatile

The dTLS 85 floodlight has a robust Ex-d enclosure made of powder copper-free aluminium with a powder-coating. The pressed-in, threaded ring for the flameproof joints made of brass. This facilitates the replacement of lamps, even after a longer operating period. The protective glass is made of scratchproof borosilicate glass; it protects the lighting technology against harmful environmental influences. The floodlight has been designed for outdoor use. The vaporized reflectors are designed for various angles of light diffusion.



The easy-to-maintain electrical connection is made via an Ex-e terminal compartment. The floodlight features an adjustable mounting bracket that allows an optimum focussing of the light.

the powerful explosion-protected dTLS 85070 P floodlight, escape routes and evacuation equipment (life boats, life rafts, abseiling equipment or rescue cushions, etc.) can be safely illuminated, even from larger distances. The GHG 664 emergency pack has a flameproof enclosure for electronics components and a flanged-on, increased safety enclosure for the battery and the terminals. The dTLS 85070 floodlight, which is to be mounted separately, features a powerful lighting technology, with which, for example, at a mounting height of 9 m, an area of 15 x 15 m can be illuminated with 1 lux.

GHG 664 emergency pack

This robust and extremely reliable emergency supply unit was developed specifically for use on offshore installations and ships. In the event of a power failure, the GHG 664 emergency pack allows the battery-back-up operation of the dTLS 85070 P floodlight with a 70 W high pressure sodium lamp for a period of 1.5 hours. When used in combination with

Features

- For the efficient illumination of large objects
- Robust housing made of light alloy with powder coating
- Easy lamp replacement, even after a long period of use
- High-gloss reflectors for different diffusion angles
- Large Ex-e connection box for easy installation
- CU-Certificate for Eurasian Economic Community available
- GHG664 emergency pack: safe light for evacuation equipment in hazardous areas with an emergency light duration of 1.5 hrs during power failure; maintained and non-maintained with switch-off device (only 220- 240 V)
- Suitable for use on offshore platforms and ships



Ordering details

Type	Content	Lamp / illuminant	Reflector	Rated luminous flux ¹⁾	Weight	Cable gland/ thread	Screw plug	Order No.
dTLS 85								
dTLS 85250 S	with diffuser lens, inductive	HIT-DE / HST-DE 250 W	wide beam reflector	20000 lm /28000 lm	25 kg	1 x M25 for Ø 8-17 mm, plastic	1 x M25	CGS 123 8588 P0001
dTLS 85250 S -40 °C up to +40 °C	with diffuser lens, inductive	HIT-DE / HST-DE 250 W	wide beam reflector	20000 lm /28000 lm	25 kg	1 x M25 for Ø 8-17 mm, plastic	1 x M25	CGS 123 8588 P0004
dTLS 85250 S	with diffuser lens, compensated circuit	HIT-DE / HST-DE 250 W	wide beam reflector	20000 lm /28000 lm	32 kg	1 x M25 for Ø 8-17 mm, plastic	1 x M25	CGS 123 8588 P1001
dTLS 85250 P	with parabolic reflector, inductive	HIT-DE / HST-DE 250 W	narrow beam	20000 lm /28000 lm	25 kg	1 x M25 for Ø 8-17 mm, plastic	1 x M25	CGS 123 8588 P0002
dTLS 85250 P	with parabolic reflector, comp.	HIT-DE / HST-DE 250 W	narrow beam	20000 lm /28000 lm	32 kg	1 x M25 for Ø 8-17 mm, plastic	1 x M25	CGS 123 8588 P1002
dTLS 85070 P	with parabolic reflector, comp.	HST-DE 70 W	narrow beam	6800 lm	22 kg	1 x M25 for Ø 8-17 mm, plastic	1 x M25	CGS 123 8588 P0003



Emergency power supply unit GHG 664

Power supply unit 230 - 240 V AC	incl. battery with dTLS 85070 P	HST-DE 70 W	narrow beam	6800 lm	48 kg	2 x M20, metal	1 x M20 screw plug (metal)	GHG 660 1915 R0001
Power supply unit 120 V AC	incl. battery with dTLS 85070 P	HST-DE 70 W	narrow beam	6800 lm	48 kg	2 x M20, metal	1 x M20 screw plug (metal)	GHG 660 1915 R0002
Power supply unit 230 -240 V AC	incl. battery, without light fitting				48 kg	2 x M20, metal	1 x M20 screw plug (metal)	GHG 664 5001 R0001



Accessories dTLS 85250 and dTLS 85070

Type	Content	dTLS 85250	dTLS 85070	OU	Order No.
RS	Eye bolt M10 (10 pcs.) galvanised	x	x	1	GHG 690 1921 R0003
L 218	Mounting bracket for inductive version	x	x	1	GHG 690 1913 R0001
L 430	Mounting bracket for compensated version	x		1	GHG 690 1913 R0002
HST-DE 250 W	High pressure sodium lamp 250 W-DE Fc2	x		1	CGS 323 8500 P1009
HIT-DE 250 W	Metal halide lamp 250 W-DE Fc2	x		1	CGS 323 7990 P1009
HST-DE 70 W	High pressure sodium lamp 70 W-DE Rx 7s		x	1	GHG 690 9216 P0001



Scope of delivery without lamp and fixing accessories, if not stated otherwise.
Metal cable glands see catalogue part 2: 2.3.12 ff

4.8

Dimension drawing / Polar curve

dTLS 85

Polar curve with reflector narrow beam dTLS 85250

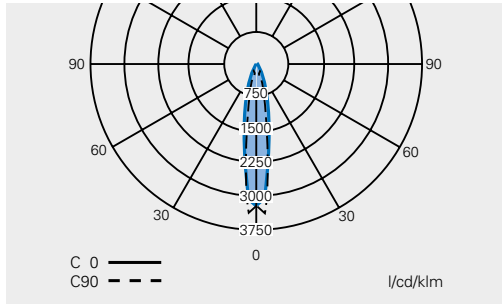

Polar curve with reflector wide beam reflector dTLS 85250

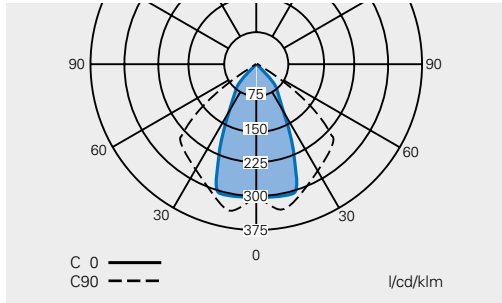

Polar curve with reflector dTLS 85070

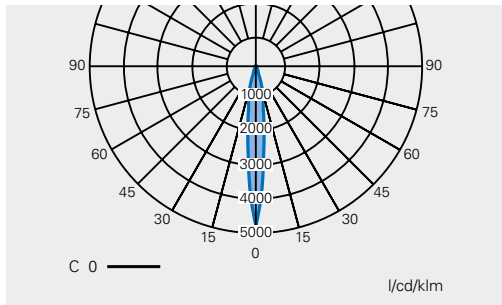

dTLS 85250 ind. dTLS 85070 comp.

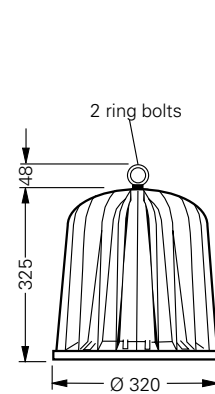

dTLS 85250 comp.

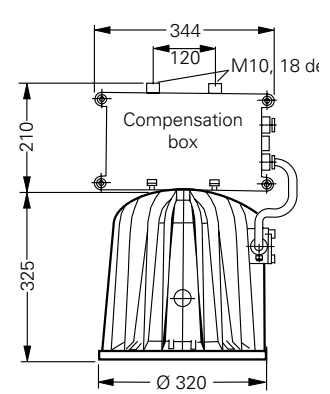

L 218

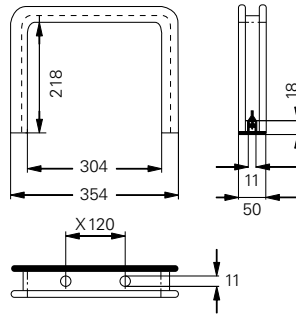

L 430

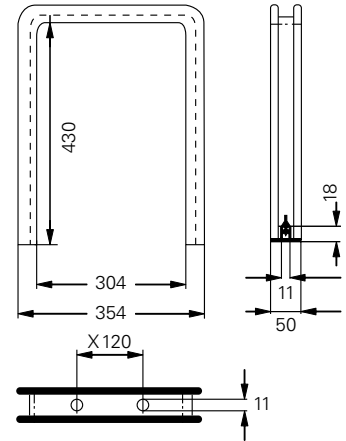

GHG 664

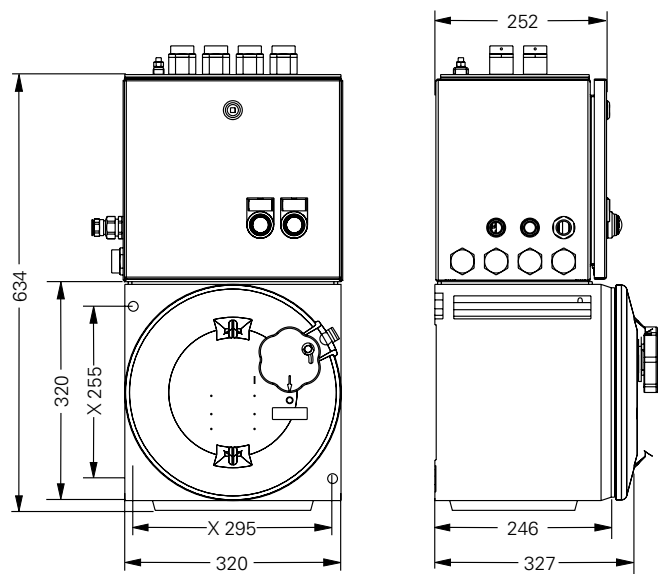

Dimensions in mm



Technical data

4

	dTLS 85 250 / dTLS 85070	Emergency power supply unit GHG 664
EC-Type Examination Certificate	DMT 03 ATEX E 039	PTB 07 ATEX 2002 X
IECEX Certificate of Conformity	IECEX BVS 11.0066	
Marking accord. to 2014/34/EU	Ⓢ II 2 G Ex de IIC T3 Gb (dTLS 85250) Ⓢ II 2 G Ex de IIC T4 Gb (dTLS 85070)	Ⓢ II 2 G Ex de IIC T6
Marking accord. to IECEx	Ex de IIC T3 Gb / ---	
Permissible ambient temperature	-50 °C up to +55 °C dTLS 85250 ind. -20 °C up to +55 °C dTLS 85250 comp. -20 °C up to +55 °C dTLS 85070	-20 °C up to +40 °C -5 °C up to +40 °C (specified data)
Output voltage		230 -240 V AC/ 120 V AC
Battery		2 x 12 V, 12 Ah Pb (sealed lead acid accumulator)
Rated voltage	230 V AC	230 V / 120 V
Rated current	3 A (ind.), 1.5 A (comp.) dTLS 85250 0.38 A (comp.) dTLS 85070	max. 0.6 A (charging + floodlight)
Power factor cos φ	0.4 (ind.), ≥ 0.9 (comp.) / ≥ 0,9 (dTLS 85070)	≥ 0.9
Frequency	50 Hz	50 - 60 Hz
Charging duration		≤ 24 h
Power consumption		≤ 50 VA (charging)
Max. output power		80 VA
Circuit	Inductive circuit, compensated circuit (..250)/ electronic driver (..070)	Electronic driver
Protection class	I	I
Lamp / Illuminant	HIT-DE 250 W/HST-DE 250 W (dTLS 85250) HST-DE 70 W (dTLS 85070)	
Rated luminous flux ¹⁾	HIT-DE 250 W: 19000 lm / HST-DE 250 W: 25000 lm HST-DE 70 W: 6800 lm	¹⁾
Lamp cap	Fc2 / RX7s accord. IEC 60061	
Light output ratio	72 % 46 % with diffuser lens	
Rated emergency lighting duration		1.5 h
Dimensions (L x W x H)	Ø 320 x 325 mm	320 x 327 x 634 mm
Connecting terminals	L, N, PE max. 2 x 2.5 mm ²	L, L1, N, PE max. 2 x 6 mm ² mains supply 3 x 2.5 mm ² connection to light fitting
Enclosure colour	grey	grey
Enclosure material	light alloy with powder coating,	light alloy with sea water resistant powder coating
Weight	25 kg / 32 kg (with compensation box)	48 kg
Cable glands / gland plates / enclosure drilling	1 x M25 x 1.5 for cables from Ø 8 - 17 mm 1 x M25 x 1.5 with blanking plug	2 x M20 x 1.5 for cables from Ø 7 - 12 mm (mains supply) 1 x M25 x 1.5 for cables from Ø 11.5- 18 mm (connection to light fitting)
Type of mounting	Ceiling-/wall mounting	Floor/wall mounting
Degree of protection accord. to EN 60529	IP66	IP66
Protective cover / protective bowl	Borosilicate glass	
Reflector	Polished aluminium reflector	

¹⁾ depends on used lamps