

# Pauluhn Apex linear fluorescent luminaires

## High bay luminaires for industrial locations

Type 4, 4X; IP66

5L

### Applications:

- Locations requiring continuous and consistent light levels
- Food and beverage processing and storage
- Power generation facilities
- Water/wastewater treatment facilities
- Pharmaceutical facilities

### Features:

- High lumen output: up to 30,000 lumens
- Complete portfolio of T5, T8 and T5HO fluorescent models
- Versatile mounting options
- NSF rated
- Operating ambient: -25°C to +55°C
- Optimized debris shedding design
- USDA compliant
- High pressure hose down rated

### Certifications and compliances:

- Type 4 (AAB only); Type 4X (ASB only)
- IP66
- UL924 – Emergency Lighting Equipment (CSA-US)
- UL1598 – Luminaires (CSA-US)
- CSA Class 3428 03
- CSA Class 3428 83
- NSF/ANSI 2-2010 Splash Zone

### Standard materials:

- Housing – Type 5052 aluminum (AAB only); Type 304 stainless steel (ASB only)
- Lens – clear acrylic (standard); polycarbonate or glass (optional)

### Photometrics:

- Complete photometrics can be found at [www.crouse-hinds.com/photometrics](http://www.crouse-hinds.com/photometrics)



### Ordering information:

Part number example  
**AAB46574EM2**

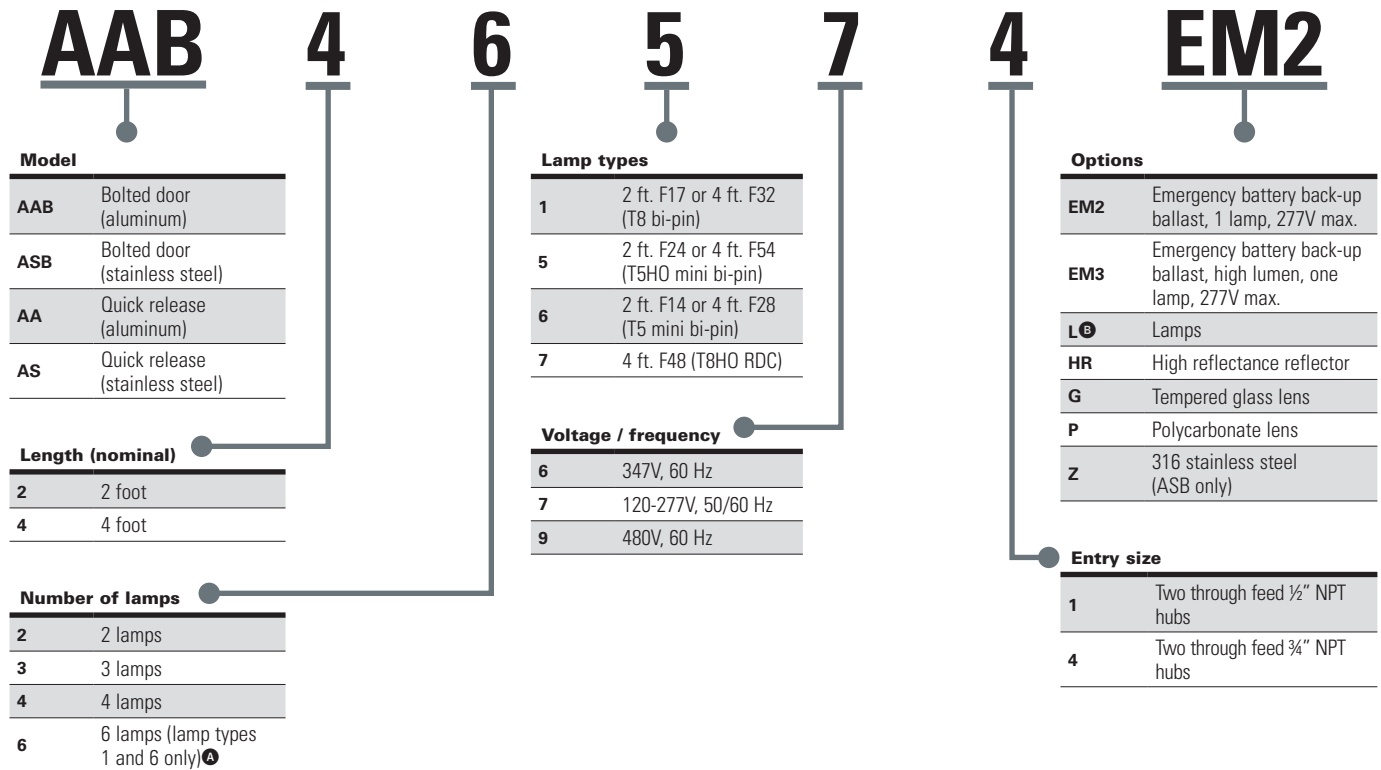

<sup>A</sup>For ASB and AS only.

<sup>B</sup>Lamps not included unless 'L' option is specified.

# Pauluhn Apex linear fluorescent luminaires

High bay luminaires for industrial locations

Type 4, 4X; IP66

5L

## Accessories:

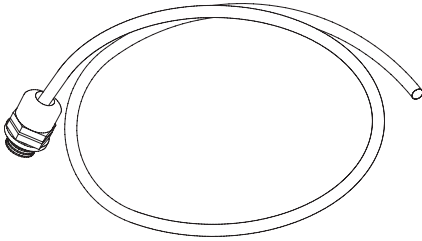

### WP163SR-6

Cord assembly  
Strain relief connector and 6 feet of #16/3 cable. If longer cable is required, change '6' suffix to length needed.

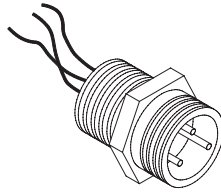

### WP003MR

Quick disconnect receptacle  
Required when WP163-6 cord assembly is used.

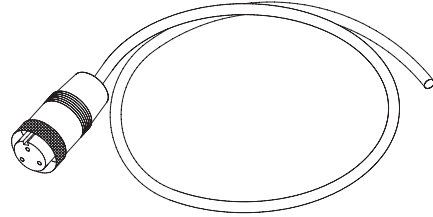

### WP163FP

Cord assembly  
Molded plug and 6 feet of #16/3 cable. If longer cable is required, change '6' suffix to length needed.

## Mounting options:

### FX7091

Ceiling mount brackets  
Attach to the suspension ears of the fixture, with the nuts and washers provided.

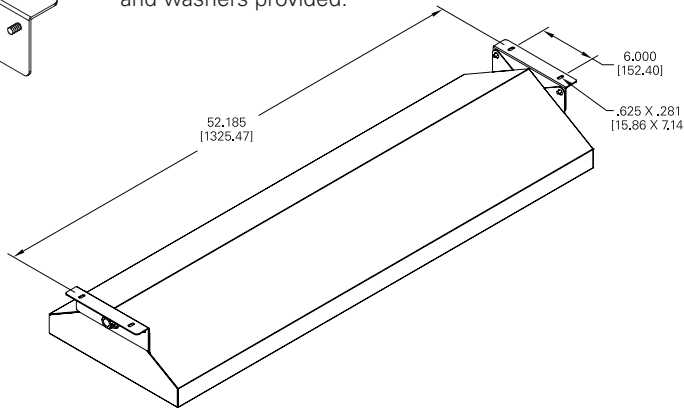
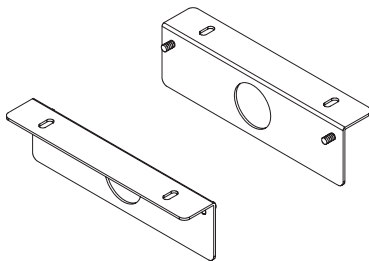

## Dimensions:

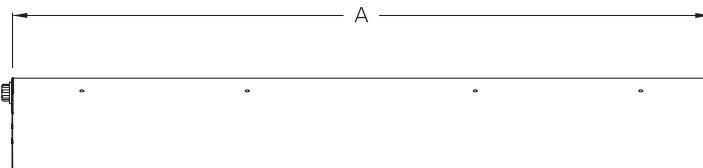
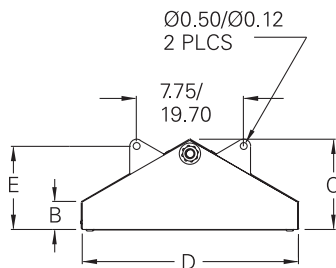

Nominal length	Dimensions in inches / centimeters					Carton L x W x D (in.)	Nominal weight <sup>Ⓒ</sup>	
	A	B	C	D	E		AAB series lbs. (kg.)	ASB series lbs. (kg.)
2 foot	26.59 (67.50)	2.00 (5.10)	6.53 (16.60)	15.72 (39.93)	6.00 (15.20)	28 <sup>3</sup> / <sub>4</sub> x 16 <sup>3</sup> / <sub>8</sub> x 7 <sup>1</sup> / <sub>8</sub>	19.0 (8.6)	26.0 (11.8)
4 foot	50.59 (128.50)	2.00 (5.10)	6.53 (16.60)	15.72 (39.93)	6.00 (15.20)	53 x 16 <sup>3</sup> / <sub>8</sub> x 7 <sup>1</sup> / <sub>8</sub>	32.0 (14.5)	46.0 (20.8)

<sup>Ⓒ</sup>Add 1.00 lb. for 3 or 4 lamps. Add 2.00 lbs. for 6 lamps.