

4.3

Ex-Pendant light fittings AB 50 / SPG 1N / AB 51 / EVI 200 / EVI 500 / EV35 LED

(Zone 1, 2, 21, 22)

The pendant light fitting series for a wide variety of applications

The explosion-protected pendant light fittings for incandescent and energy-saving lamps, high intensity discharge and induction lamps can be used with their different housing solutions in different areas. The robust flameproof luminaires have been in use in many industrial plants for many years and have stood the test of time.

AB 50 / SPG 1N and AB 51

This larger series of pendant light fittings is suitable for incandescent and mixed-light lamps. The robust light alloy enclosure allows a wide range of applications. The protective glass dome is made of borosilicate glass and is extremely impact and heat resistant. The reflector and all external screws are made of stainless steel. Easy replacement of lamps is made possible by opening the PTFE-coated connection ring. Both devices (the protective glass dome and connection ring) are provided with hinges to allow easy access. Thanks to their robust design, these light

fittings are suitable for use in the chemical industry and are certified for ambient temperatures from -55 °C to +55 °C.

EVI the powerful pendant light fitting series

This larger series of pendant light fittings is suitable for incandescent and mixed-light lamps. The robust light alloy enclosure allows a wide range of applications. The protective glass dome is made of borosilicate glass and is extremely impact and heat resistant. The reflector and all external screws are made of stainless steel. Easy replacement of lamps is

made possible by opening the PTFE-coated connection ring. Both devices (the protective glass dome and connection ring) are provided with hinges to allow easy access. Thanks to their robust design, these light fittings are suitable for use in the chemical industry and are certified for ambient temperatures from -55 °C to +55 °C.



Features

- Different housing solutions with different light sources for nearly every application
- Robust design for harsh environments
- With large Ex-d or Ex-e terminal compartment
- Wide ambient temperature range depending on the version from -50 °C up to +55 °C
- CU-Certificate for Eurasian Economic Community available
- High degree of protection IP 66
- Meets the highest corrosion protection and mechanical strength requirements



EV 35 - the efficient solution for your illumination concept for hazardous areas

The robust Ex-pendant light fitting EV 35 LED with energy saving LED-module combines state-of-the-art lighting engineering with the requirements of harsh and hazardous environments. With an efficient LED technology and with no harmful UV radiation, this series of light fittings provides a perfect illumination. Together with an internal reflector, this light fitting can also be used as a downlight.

And, last but not least, the long life and the low power consumption of the LED module helps to keep down running costs. Thanks to the extremely solid construction of the housing, this series of pendant light fittings is resistant to impact, vibrations and shocks. As a result, they provide an ideal lighting concept for applications in harsh and hazardous environments.

Even extreme ambient temperatures from -50°C up to +55 °C are no problem for the robust LED technology of the light fittings.

Ordering details

Type	Lamp / Illuminant	Rated luminous flux ³⁾	Weight	Metal thread	Threaded plug	Dust cap	Order No.
AB 50 ... (IU = direct entry, IXM = indirect entry)							
AB 50 IU	IGA 60 W, 100 W, 75 W halogen	710 lm / 1360 lm	1.6 kg	2 x 3/4" NPT	1 x 3/4" Ex-d	x	NOR 000 115 110 289
AB 50 IXM	IGA 60 W, 100 W, 75 W halogen	710 lm / 1360 lm	2.2 kg	2 x M25	1 x M25 Ex-e	x	NOR 000 115 110 320
AB 50 IU, -50 °C up to +55 °C	60 W, 100 W, 75 W halogen	710 lm / 1360 lm	1.6 kg	2 x 3/4" NPT	1 x 3/4" Ex-d	x	NOR 000 115 110 389
AB 50 IXM, -50 °C up to +55 °C	60 W, 100 W, 75 W halogen	710 lm / 1360 lm	2.2 kg	2 x M25	1 x M25 Ex-e	x	NOR 000 115 110 420
SPG 1N	60 W, 100 W, 75 W halogen	710 lm / 1360 lm	2.2 kg	2 x M25	1 x M25 Ex-e	x	NOR 000 005 110 745
AB 51 ... (IU = direct entry, IX = indirect entry)							
AB 51 IU	²⁾		3.6 kg	2 x 3/4" NPT	1 x 3/4" Ex-d	x	NOR 000 115 110 396
AB 51 IU, -50 °C up to +55 °C	²⁾		3.6 kg	2 x M25	1 x M25 Ex-d	x	NOR 000 115 110 497
AB 51 IU	²⁾		3.6 kg	2 x M25	1 x M25 Ex-d	x	NOR 000 115 110 496
AB 51 IU, -50 °C up to +55 °C	²⁾		3.6 kg	2 x 3/4" NPT	1 x 3/4" Ex-d	x	NOR 000 115 110 397
AB 51 IX (indirect entry)	²⁾		4.5 kg	2 x M25	1 x M25 Ex-e	x	NOR 000 115 110 437
AB 51 IX (indirect entry) -50 °C up to +55 °C	²⁾		4.5 kg	2 x M25	1 x M25 Ex-e	x	NOR 000 115 110 438
AB 51 ... (direct entry)							
AB 51 M 80 V	HME 80 W	3800 lm	7.5 kg	2 x 3/4" NPT	1 x 3/4" Ex-d	x	NOR 000 115 110 893
AB 51 M 80 V, -45 °C up to +55 °C	HME 80 W	3800 lm	7.5 kg	2 x 3/4" NPT	1 x 3/4" Ex-d	x	NOR 000 115 110 863
AB 51 M 80 V, -45 °C up to +55 °C	HME 80 W	3800 lm	7.5 kg	2 x M25	1 x M25 Ex-d	x	NOR 000 115 110 864
AB 51 M 125 V	HME 125W	6300 lm	7.5 kg	2 x 3/4" NPT	1 x 3/4" Ex-d	x	NOR 000 115 110 890
AB 51 M 125 V, -45 °C up to +55 °C	HME 125W	6300 lm	7.5 kg	2 x 3/4" NPT	1 x 3/4" Ex-d	x	NOR 000 115 110 891
AB 51 S 70 V2 NI	HSE/HIE 70 W	5600 lm	7.5 kg	2 x 3/4" NPT	1 x 3/4" Ex-d	x	NOR 000 115 110 905
AB 51 S 70 V2 MI	HSE/HIE 70 W	5600 lm	7.5 kg	2 x M25	1 x M25 Ex-d	x	NOR 000 115 110 904
AB 51 S 70 V2 NLTI, -45 °C up to +55 °C	HSE/HIE 70 W	5600 lm	7.5 kg	2 x 3/4" NPT	1 x 3/4" Ex-d	x	NOR 000 115 110 907
AB 51 S 70 V2 MLTI, -45 °C up to +55 °C	HSE/HIE 70 W	5600 lm	7.5 kg	2 x M25	1 x M25 Ex-d	x	NOR 000 115 110 906
AB 51 M 125 V	HME 125W	6300 lm	7.5 kg	2 x M25	1 x M25 Ex-d	x	NOR 000 115 110 990
AB 51 M 125 V, -45 °C up to +55 °C	HME 125W	6300 lm	7.5 kg	2 x M25	1 x M25 Ex-d	x	NOR 000 115 110 991
EVI 200 ... (UD = direct entry, XM = indirect entry)							
EVI 200 UD	¹⁾	¹⁾	8.2 kg	2 x 3/4" NPT	1 x 3/4" Ex-d	x	NOR 000 005 110 753
EVI 200 XM,	¹⁾	¹⁾	9 kg	2 x M25	1 x M25 Ex-e	x	NOR 000 115 110 941
EVI 200 UD, -50 °C up to +55 °C	¹⁾	¹⁾	8.2 kg	2 x 3/4" NPT	1 x 3/4" Ex-d	x	NOR 000 115 110 753
EVI 200 XM, -50 °C up to +55 °C	¹⁾	¹⁾	9 kg	2 x 3/4" NPT	1 x 3/4" Ex-e	x	NOR 000 115 110 943
EVI 500 ... (UD = direct entry, XM = indirect entry)							
EVI 500 UD	¹⁾	¹⁾	12.8 kg	2 x 3/4" NPT	1 x 3/4" Ex-d	x	NOR 000 005 110 761
EVI 500 UD, -50 °C up to +55 °C	¹⁾	¹⁾	12.8 kg	2 x 3/4" NPT	1 x 3/4" Ex-d	x	NOR 000 005 110 763
EVI 500 XM	¹⁾	¹⁾	13.6 kg	2 x M25	1 x M25 Ex-e	x	NOR 000 115 110 942
EVI 500 XM, -50 °C up to +55 °C	¹⁾	¹⁾	13.6 kg	2 x 3/4" NPT	1 x 3/4" Ex-e	x	NOR 000 115 110 944

¹⁾ see table luminaire data S. 1.4.20 - 1.4.21²⁾ see table luminaire data page 1.4.20 (w/o HID lamps)³⁾ depends on used lamps

Ordering details



Type	Lamp / Illuminant	Weight	Metal thread	Threaded plug	Dust cap	Order No.
EV 35 ... including LED-module (UD = direct entry, XM = indirect entry)						
EV 35 UD LED	LED module 22 W	9.1 kg	2 x M25	1 x M25 Ex-d	x	NOR 000 115 110 600
EV 35 XM LED	LED module 22 W	10.05 kg	2 x M25	1 x M25 Ex-e	x	NOR 000 115 110 605
EV 35 UD LED R0	LED module 22 W with internal reflector	9.1 kg	2 x M25	1 x M25 Ex-d	x	NOR 000 115 110 610
EV 35 XM LED R0	LED module 22 W with internal reflector	10.05 kg	2 x M25	1 x M25 Ex-e	x	NOR 000 115 110 630

¹⁾ see table luminaire data S. 1.4.21

Accessories

Type	Content	Application	OU	Order No.
ER	External reflector painted steel	AB 50	1	NOR 000 115 110 718
PC. EV 200	External reflector	AB 51/EVI 200	1	NOR 000 005 110 894
PC. EV 500	External reflector	EVI 500	1	NOR 000 005 110 901
BC. EV	Pole mounting bracket for Ø 44 - 64 mm	EV ...	1	NOR 000 005 110 836
AS.EV/AB	Ceiling mounting bracket	EV ...	1	NOR 000 005 110 828
SP. EV 200	Wall mounting bracket	AB 51/EVI 200	1	NOR 000 005 110 935
SP. EV 500	Wall mounting bracket	EVI 500	1	NOR 000 005 110 943
AS.AB51	Ceiling bracket AISI 316	AB 51	1	NOR 003 165 110 000
SPU.EV/AB	Wall mounting bracket, adjustable	EV ...	1	NOR 000 005 110 951
G. EV 200	Wire guard	AB 51/EVI 200	1	NOR 000 005 110 860
G. EV 500	Wire guard	EVI 500	1	NOR 000 005 110 878
KEY, EV	Luminaire key	EV ...	1	NOR 000 005 110 886
CEV/AB	Eye bolt	AB 50/ EV ...	1	NOR 000 005 110 852
C.AB51	Eye bolt AISI 316	AB 51	1	NOR 003 165 110 001
WG	Wire guard, galvanized	AB 50	1	NOR 000 115 110 875
HSE 70 W	High pressure sodium lamp 70 W E27	AB 51 S 70	1	3 2475 900 012
HIE 70 W	High pressure metal halide lamp 70 W E27	AB 51 S 70...	1	3 2475 900 010

Scope of delivery without lamp and fixing accessories, if not stated otherwise.
Metal cable glands see catalogue part 2: 2.3.12 ff

4.3

Polar curve Pendant light fittings

Polar curve AB 50 IU

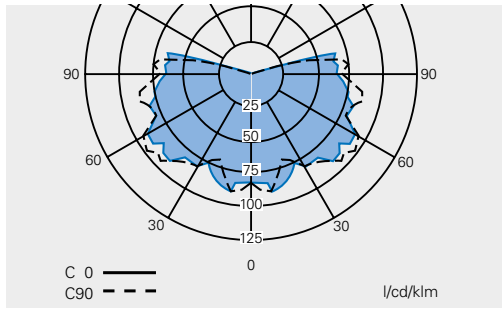

Polar curve EVI 200/500 without external reflector

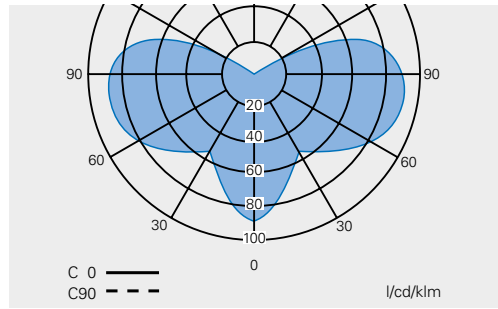

Polar curve AB 51 IU

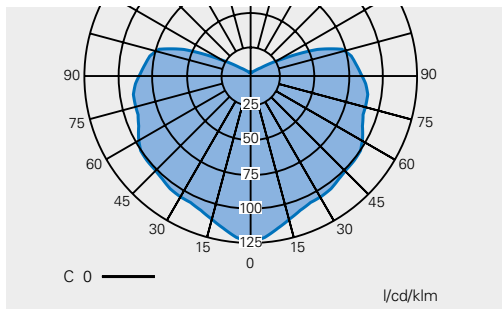

Polar curve EVI 200/500 with external reflector

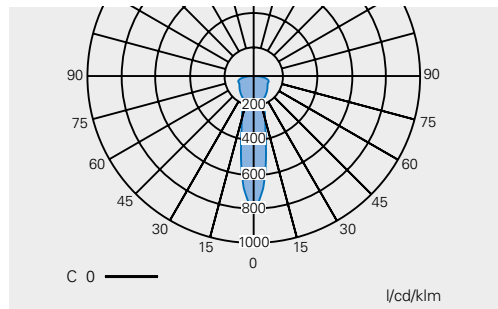

Polar curve EV 35 LED without internal reflector

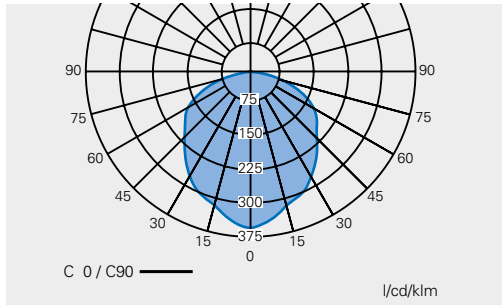

Polar curve EV 35 LED with internal reflector

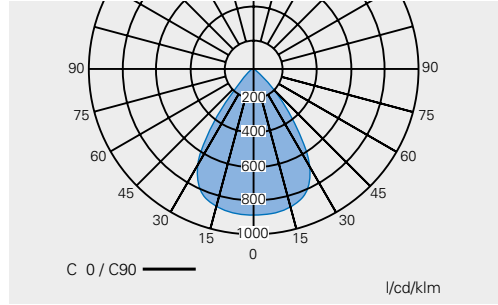

AB 50 IU

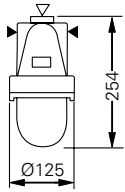

AB 50 IXM

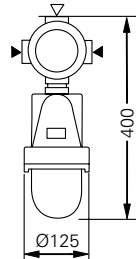

SPG 1N

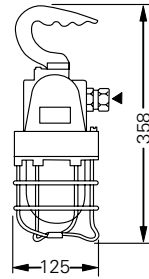

AB 51 IU

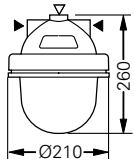

AB 51 IX

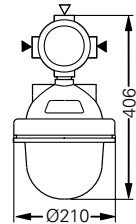

AB 51 ..V

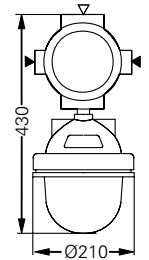

EVI 200 UD

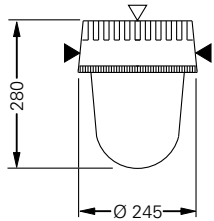

EVI 200 XM

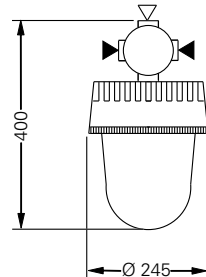

EVI 500 UD

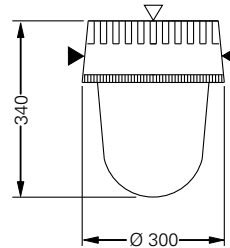

EVI 500 XM

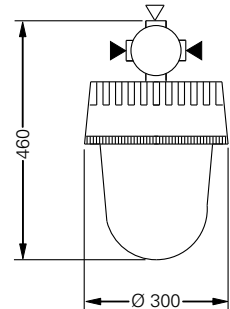

SPU EV/AB

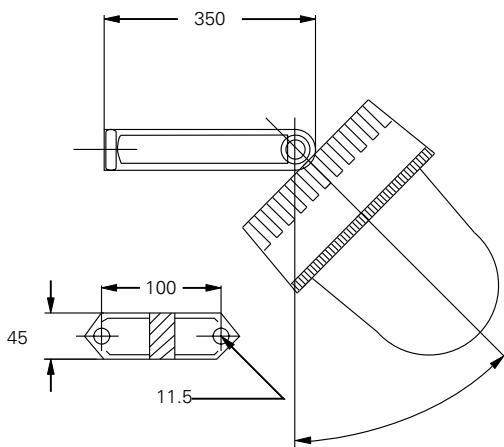

SPEV 200/500

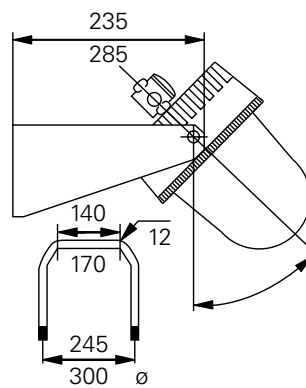

▶ entry
▽ optional entry, on request

KEY.EV

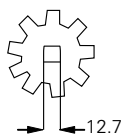

CEV/AB

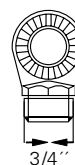

AS.EV/AB

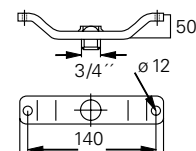

BC. EV

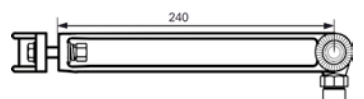

Dimensions in mm



4 Technical data

	AB 50 / SPG 1N	AB 51
EC-Type Examination Certificate	LOM 02 ATEX 2018 X	LOM 02 ATEX 2020 X
IECEX Certificate of Conformity	IECEX BK1 07.0032X	IECEX BK1 07.0028X
Marking accord. to 2014/34/EU	⊕ II 2 D Ex d/de IIC T3 / T6 ⊕ II 2 D Ex tD A21 IP66 T...°C	⊕ II 2 G Ex d IIC T ¹⁾ Gb ⊕ II 2 G Ex de IIC T ¹⁾ Gb (Indirect entry) ⊕ II 2 D Ex t IIC T ¹⁾ Db
Marking accord. to IECEx	Ex d IIC T3...T6 or Ex de IIC T3...T6 (indirect entry) Ex tD A21 IP66 T145°...T85°C	Ex de IIC T3...T6 Ex tD A21 IP67 T152°C...T86°C
Permissible ambient temperature	-20 °C up to +55 °C -50 °C up to +55 °C (option: AB 50)	-20 °C up to +55 °C / -50 °C up to +55 °C option: IGA / -45 °C up to +55 °C option: HS./HI.
Rated voltage	max. 250 V	max. 250 V (AB 51..); 230 V AC (AB 51 M/S)
Frequency	50 Hz	50 Hz
Power consumption	max. 100 VA	max. 200 VA
Protection class	I	I
Lamp / Illuminant	60 W, 100 W, 75 W halogen	¹⁾
Rated luminous flux	¹⁾	¹⁾
Lamp cap	E27 accord. IEC 60238	E27 accord. IEC 60238
Light output ratio	68 %	75 %
Connecting terminals	L, N, PE: 1 x 2.5 mm ² or 2 x 1.5 mm ² , PE ext. 2 x 6 mm ²	L, N, PE: 1 x 2.5 mm ² or 2 x 1.5 mm ² (IU), 2 x 2.5 mm ² (IX and M/S), PE ext. 2 x 6 mm ²
Enclosure colour	epoxy paint, body RAL 7032	epoxy paint, body RAL 7032
Enclosure material	light alloy	light alloy
Weight	1.6 kg	3.6 kg
Cable glands / gland plates / enclosure drilling	2 x 3/4" or M25 thread (Ex-d), 1 x plugged (UI and M/S) / 2 x M25 x 1.5, 1 x plugged (IX)	2 x 3/4" or M25 thread (Ex-d), 1 x plugged (UI and M/S) / 2 x M25 x 1.5, 1 x plugged (IX)
Type of mounting	ceiling-/wall mounting (AB 50), portable light fixture (SPG 1N)	ceiling-/wall mounting
Degree of protection accord. to EN 60529	IP66	IP66
Protective cover / protective bowl	borosilicate glass	borosilicate glass

¹⁾ see table luminaire data

Additional luminaire data AB 51

Lamp	Power	Luminous flux ²⁾	Temperature class II 2 G		max. surface temp. II 2 D	
			T ₀ ≤ 40 °C	T ₀ ≤ 55 °C	T ₀ ≤ 40 °C	T ₀ ≤ 55 °C
Incandescent lamp IGA 65	150 W	2200 lm	T3	T3	T 132 °C	T 147 °C
Incandescent lamp IGA 80	200 W	3100 lm	T3	T3	T 137 °C	T 152 °C
Halogen lamp IQT	75 W	1100 lm	T5	T4	T 88 °C	T 103 °C
Halogen lamp IQT	150 W	2500 lm	T4	T3	T 123 °C	T 138 °C
Compact fluorescent lamp	max 32 W ³⁾		T6	–	T 85 °C	–
High pressure sodium lamp HSE	50 W	3400 lm	T5	T4	T 86 °C	T 101 °C
High pressure sodium lamp HSE	70 W	5600 lm	T4	T4	T 97 °C	T 112 °C
Metal halide lamp HIE	70 W	5900 lm	T4	T4	T 110 °C	T 125 °C

²⁾ depends on used lamps / ³⁾ T₀ ≤ 30 °C



Technical data

	EVI 200	EVI 500	EV 35 LED
EC-Type Examination Certificate	LOM 02 ATEX 2012 X	LOM 02 ATEX 2012 X	LOM 10 ATEX 2075
IECEX Certificate of Conformity	IECEX BKI 07.0031X	IECEX BKI 07.0031X	
Marking accd. to 2014/34/EU	⊕ II 2 G Ex de IIC T ¹ Gb (XM = indirect entry) ⊕ II 2 G Ex d IIC T ¹ Gb (UD = direct entry) ⊕ II 2 D Ex tD A21 IP67 T ¹ °C Db	⊕ II 2 G Ex de IIC T ¹ Gb (XM = indirect entry) ⊕ II 2 G Ex d IIC T ¹ Gb (UD = direct entry) ⊕ II 2 D Ex tD A21 IP67 T ¹ °C Db	⊕ II 2 G Ex de IIC T ¹ Gb (XM = indirect entry) ⊕ II 2 G Ex d IIC T ¹ Gb (UD = direct entry) ⊕ II 2 D Ex tD A21 IP67 T ¹ °C Db
Marking accd. to IECEx	Ex de IIC T ¹ Ex tD A21 IP67 T ¹ °C	Ex d / de IIC T ¹ Ex tD A21 IP67 T ¹	
Permissible ambient temperature	-20 °C up to +55 °C -50 °C up to +55 °C (option)	-20 °C up to +55 °C -50 °C up to +55 °C (option)	-50 °C up to +55 °C
Rated voltage	max. 250 V	max. 250 V	220 - 240 V AC
Frequency	50 - 60 Hz	50 - 60 Hz	50 - 60 Hz
Power consumption	max. 200 VA	max. 500 VA	approx. 23 W
Protection class	I	I	I
Lamp / Illuminant	¹⁾	¹⁾	LED module with electronic driver
Rated luminous flux	¹⁾	¹⁾	
Rated luminous flux of the luminaire (typical, ± 10 %)			2113 lm (w/o reflector)/ 1798 lm (with reflector)
Lamp cap	E27 accord. IEC 60238	E40 accord. IEC 60238	
Light output ratio	75 %	75 %	100 %
Dimensions (L x W x H)	280 mm x Ø 245 mm (200 UD), 400 x Ø 225 mm (200 XM)	340 x Ø 300 mm (500 UD), 460 x Ø 300 mm (500 XM)	280 mm x Ø 245 mm
Connecting terminals	L, N, PE: 1 x 2.5 mm ² or 2 x 1.5 mm ² (UD), 2 x L, N, PE: 1 x 2.5 mm ² or 2 x 1.5 mm ² (UD), 2 x 2.5 mm ² (XM); PE ext. 2 x 6 mm ²	2 x L, N, PE: 1 x 2.5 mm ² or 2 x 1.5 mm ² (UD), 2 x L, N, PE: 1 x 2.5 mm ² or 2 x 1.5 mm ² (UD), 2 x 2.5 mm ² (XM); PE ext. 2 x 6 mm ²	2 x L, N, PE: 1 x 2.5 mm ² or 2 x 1.5 mm ² (UD), 2 x 2.5 mm ² (XM); PE ext. 2 x 6 mm ²
Enclosure colour	epoxy paint, body RAL 7032 / ring RAL 6005	epoxy paint, body RAL 7032 / cover RAL 7016 / ring RAL 6005	epoxy paint, body RAL 7032 / ring RAL 6005
Enclosure material	light alloy	light alloy	light alloy
Weight	8.2 kg (UD/ 9 kg (XM)	12.8 kg (UD)/ 13.6 kg (XM)	9.1 kg
Cable glands / gland plates / enclosure drilling	2 x 3/4" or M25 thread (Ex-d), 1 x plugged (UD), 2 x M25 thread Ex-e, 1 x plugged (XM)	2 x 3/4" or M25 thread (Ex-d), 1 x plugged (UD), 2 x M25 thread Ex-e, 1 x plugged (XM)	M25 thread (Ex-d), 1 x plugged (UD) 2 x M25 thread (Ex-e), 1 x plugged (XM)
Type of mounting	ceiling-/wall mounting	ceiling-/wall mounting	ceiling-/wall mounting
Degree of protection accd. to EN 60529	IP66	IP66	IP66
Protective cover / protective bowl	borosilicate glass	borosilicate glass	borosilicate glass, clear

¹⁾ see table luminaire data

Additional luminaire data EVI

Lamp	Power	Luminous flux ²⁾	Type	Temperature class II 2 G		max. surface temp. II 2 D	
				T _u ≤ 40 °C	T _u ≤ 55 °C	T _u ≤ 40 °C	T _u ≤ 55 °C
Incandescent lamp IGA 65	150 W	2200 lm	EVI 200	T4	T4	T 105 °C	T 120 °C
Incandescent lamp IGA 80	200 W	3100 lm	EVI 200	T4	T4	T 115 °C	T 130 °C
Incandescent lamp IGA 90	300 W	5000 lm	EVI 500	T4	T4	T 115 °C	T 130 °C
Incandescent lamp IGA 110	500 W	8400 lm	EVI 500	T3	T3	T 155 °C	T 170 °C

²⁾ depends on used lamps