

B 10-6327

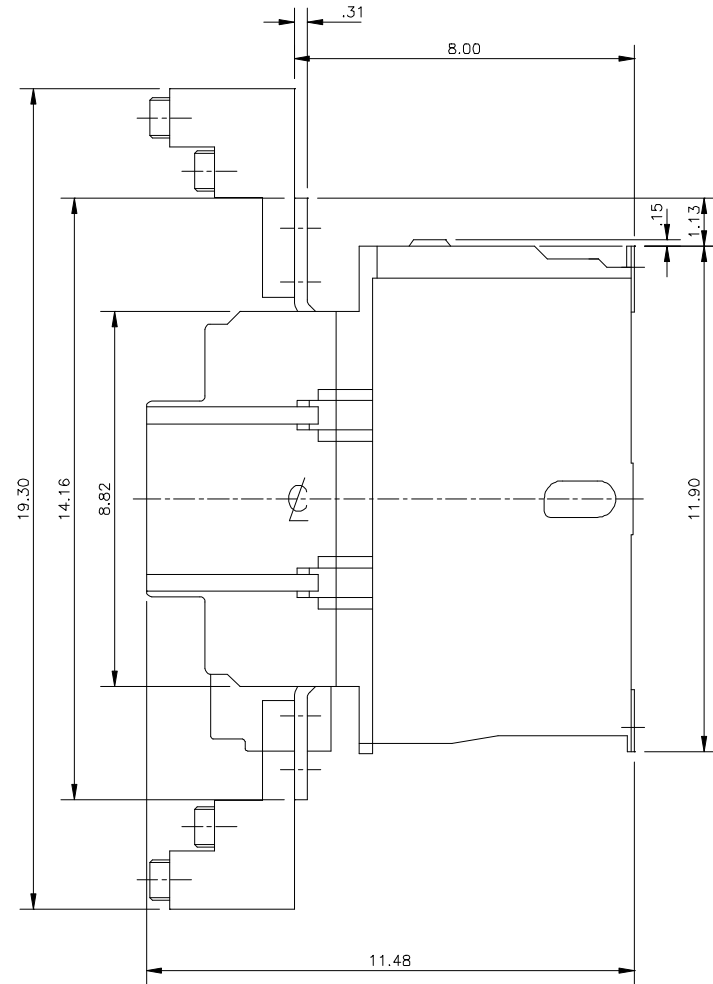
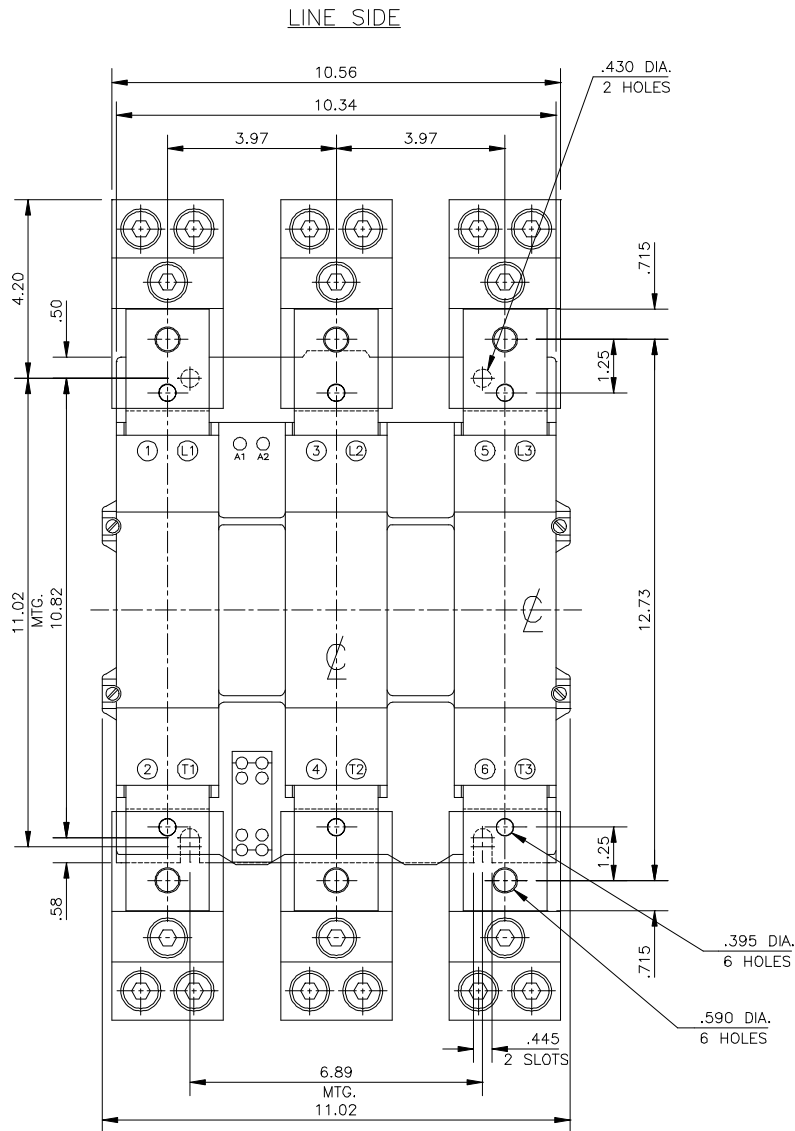

NOTE:
LUG CAPABILITIES PER PHASE - WILL
ACCEPT THREE ALUMINUM OR COPPER
CONDUCTORS 3/0 TO 750MCM RANGE.

TITLE		DIMENSIONS FOR SIZE '7' SER. 'C' CONTACTOR (OPEN)						
A1	JJS	JJS			DR. R. WILSON	10-08	APP. G. H. FREISLEBEN	04-02
B1					CHK. A. J. ZAUNER	-86		-90
C1						03-09	FIRST ASSY. WHERE LISTED	
D1						-90	C10-6321	
E1								

SCALE
1/3 SIZE
THIRD ANGLE PROJECTION

THE INFORMATION ON THIS DRAWING IS THE PROPERTY OF EATON CORPORATION. IS DISCLOSED IN CONFIDENCE AND IS NOT TO BE REPRODUCED, USED OR DISCLOSED EXCEPT FOR THE PURPOSE FOR WHICH FURNISHED.