

Carrel Organizer

Tools Required

- Phillips head screwdriver
- $\frac{5}{32}$ " Allen wrench (provided)
- Electric drill
- $\frac{1}{8}$ " Drill bit
- Drill template (provided)

IMPORTANT: It is recommended that the assembly of this product be done on the floor. Assistance may be required

Assembling the Organizer

1. Phillips 1. Carefully slide the **Uprights** over the ends of the **Back Panel**. Be sure that the holes for Mounting Brackets are at the bottom of the Uprights. See figure 1.
2. Install the $\frac{1}{4}$ "-20 x $2\frac{1}{2}$ " Button head cap screw through the Uprights and through the Back Panel. Thread the screws in until their heads touch the Uprights (snug fit). **DO NOT TIGHTEN.** See figure 1.
3. Make sure that the bottom of the Back Panel and Uprights are flush. Starting at the bottom, tighten each screw $\frac{1}{4}$ turn from the snug position. **DO NOT OVERTIGHTEN.**

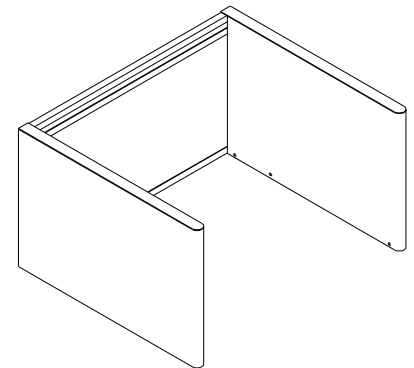

Carrel Organizer

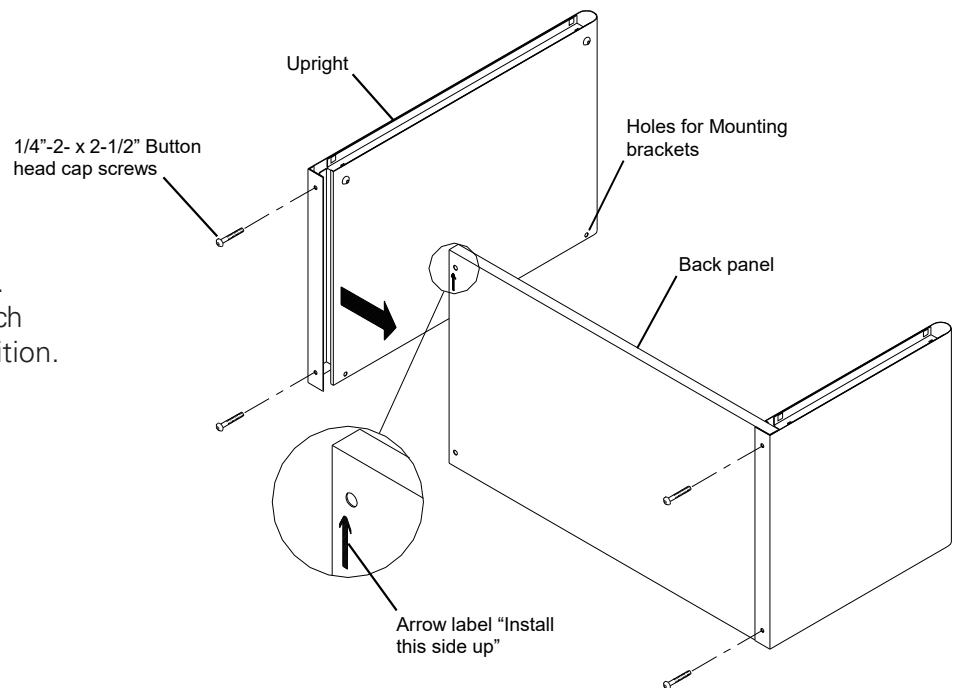

Figure 1



Powering Business Worldwide

Effective May 2018

Fastening the organizer to a LINX worksurface

1. Using the cardboard Drill Template provided, drill two $\frac{1}{8}$ " diameter holes approximately $\frac{1}{2}$ " deep into the two corners of the Linx Corner Workstation as shown in figure 2.

Carefully fold the template along perforations and place the template on the corner of the worksurface as shown in figure 2.

Fold the tab on the opposite end of the template for the other corner of the worksurface.

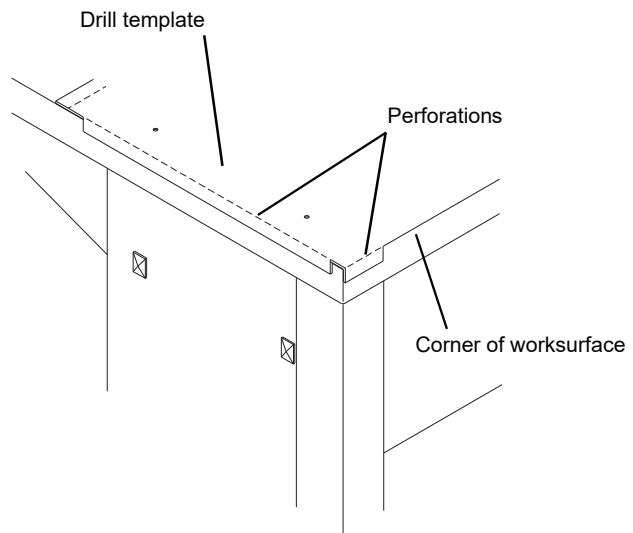

Figure 2

2. Position a **Mounting Bracket** at each corner of the worksurface, carefully noting the location of the weldnuts. Install four #10 x $\frac{3}{4}$ " Phillips pan head screws provided into the previously drilled holes. See figure 3.

3. Using the Mounting Brackets as templates, drill four more $\frac{1}{8}$ " diameter holes approximately $\frac{1}{2}$ " deep into the worksurface and install the remaining screws.

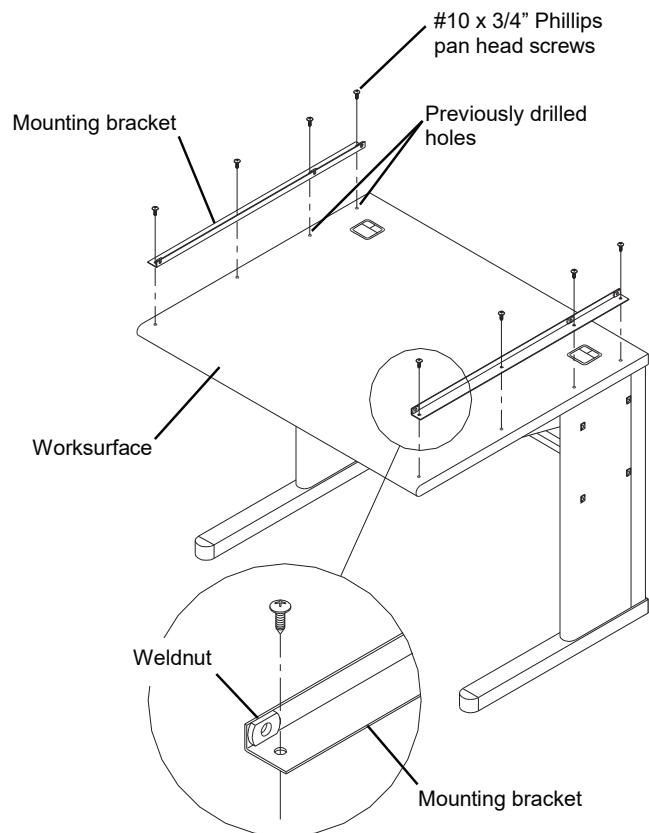

Figure 3

Fastening the organizer to a LINX worksurface (continued)

4. With two people, carefully lift and place the Organizer on the worksurface with the bottom of the Uprights fitting down over the Mounting Brackets.

Secure the Uprights to the Mounting Brackets with the six $\frac{1}{4}$ "-20 x $\frac{1}{2}$ " Button head cap screws provided. Tighten the screws with the $\frac{5}{32}$ " Allen wrench. See figure 4.

5. Install the two **Top Caps** as shown in figure 4. First install three **Plasti-grommets** into the square holes in the top of each upright. Next, install the Top Caps using the six $\frac{1}{4}$ "-20 x 1.00" flat head screws.

IMPORTANT! The Linx Organizer must be fastened to the worksurface.

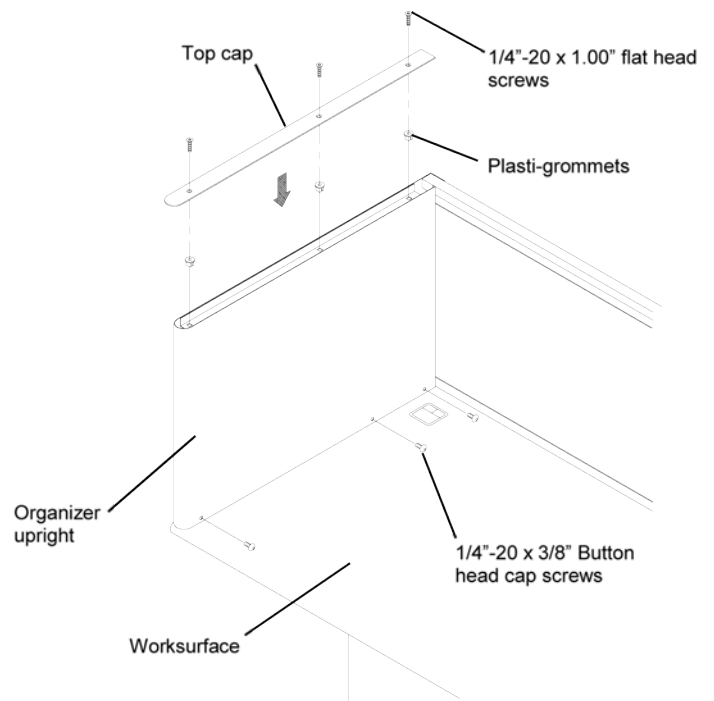

Figure 4

IL211005EN

Effective May 2018

Parts List

#	Part Number	Description	Qty.
1	11377X	20" H Full Depth Upright, L.H.	1
2	11376X	20" H Full Depth Upright, R.H.	1
3	11380X	Cap	2
4	82668	Screw, 1/4"-20 x 1.00" FLTHD	6
5	22738	Plasti-Grommet	6
6	69361	Screw, 1/4"-20 x 2-1/2" BHD Cap	4
7	11402X	Back Panel	1
8	11379X	Bracket	2
9	59103	Screw, #10 x 3/4" Phillips Pan HD	8
10	68681	Screw, 1/4"-20 x 3/8" BHD Cap	6

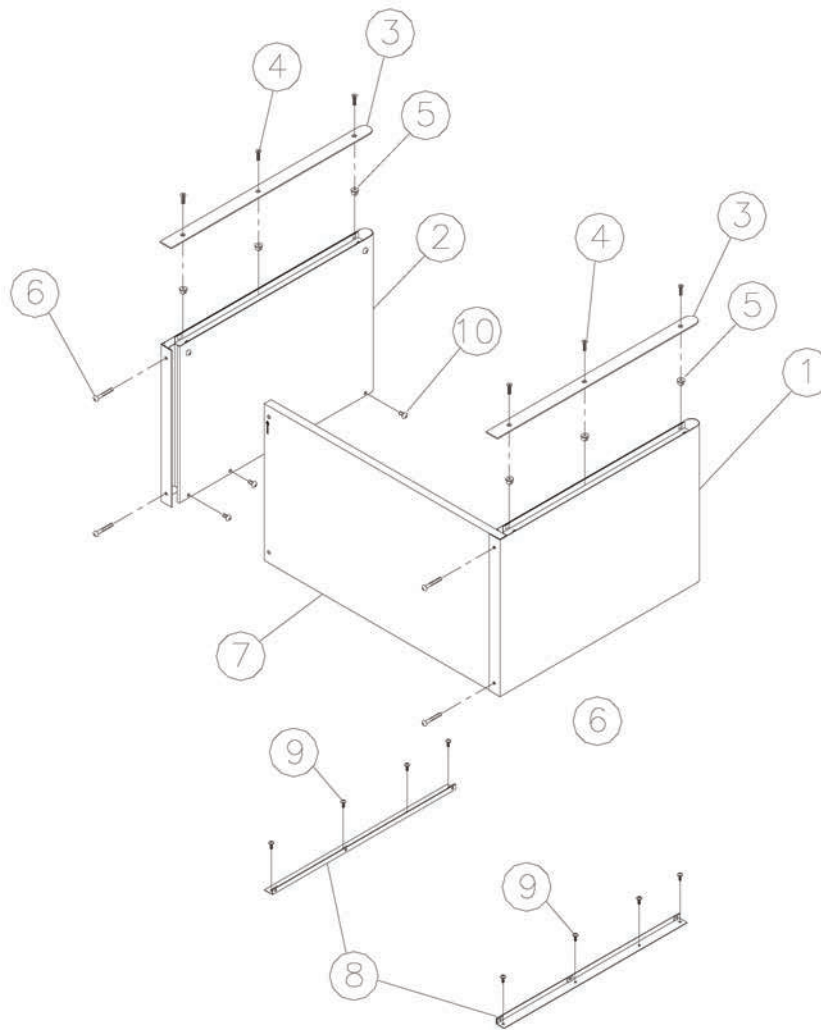

Eaton
 1000 Eaton Boulevard
 Cleveland, OH 44122
 United States
 Eaton.com

© 2018 Eaton
 All Rights Reserved
 Printed in USA
 Publication No. IL211005EN 89072
 May 2018

Eaton is a registered trademark.

All other trademarks are property of their respective owners.