

Service pullout

Item numbers

ALLEPSD2430
ALLEPSD3030
ALPEPSD2430
ALPEPSD3030

Item numbers

(1) 7/16" Socket wrench (not supplied)
(1) 3/8" Socket wrench (not supplied)
(1) 5/32" Allen wrench (supplied)
(1) Level (not supplied)
(1) Rubber mallet

IMPORTANT! The LMS Full Frame must be level before installing the Service Pullout.

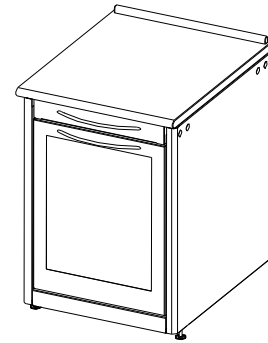

Service pullout

Positioning the service pullout

The Service Pullout can be installed at four different heights at one inch increments. The minimum height is 34"; the maximum height is 43". See figure 1.

1. Determine the desired height of the Service Pullout and then insert the hooks* on the back of the unit into the slotted standards and push down. See figure 2a. To ensure that the hooks are seated, tap the top rear corners with a rubber mallet.

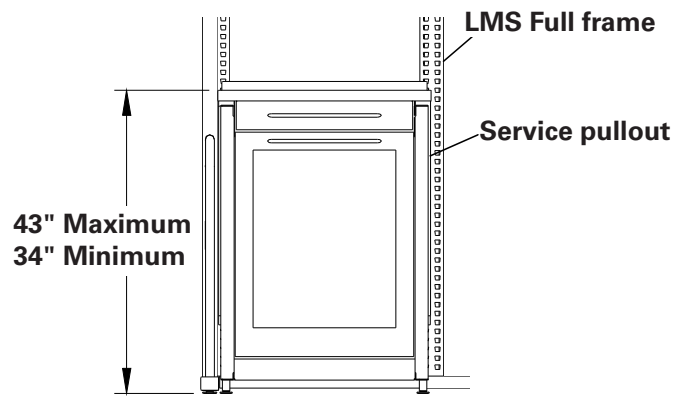

Figure 1

***NOTE:** It is suggested that the hooks be bent out slightly to ease insertion into the slotted standards. See figure 2b.

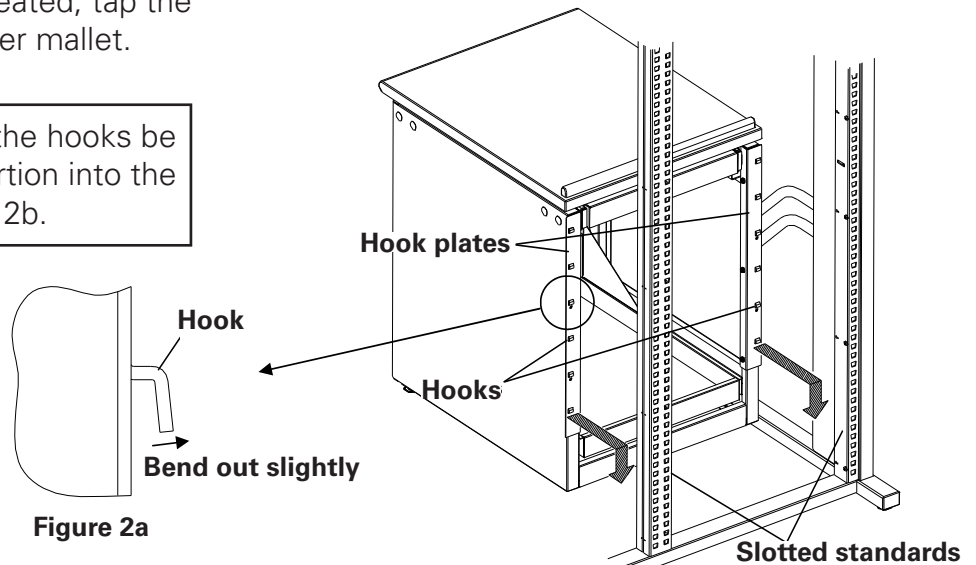

Figure 2a

Figure 2a



Powering Business Worldwide

Securing the unit to the frame

1. Pull the top surface of the unit out to gain access to the inside of the unit. Locate the two holes at the rear corners of the Service Pullout and using a $\frac{3}{8}$ " socket wrench, thread a $\frac{1}{4}$ " - 20 x $\frac{1}{2}$ " hex washer head screw into each hole. Tighten each screw securely. See figure 3.

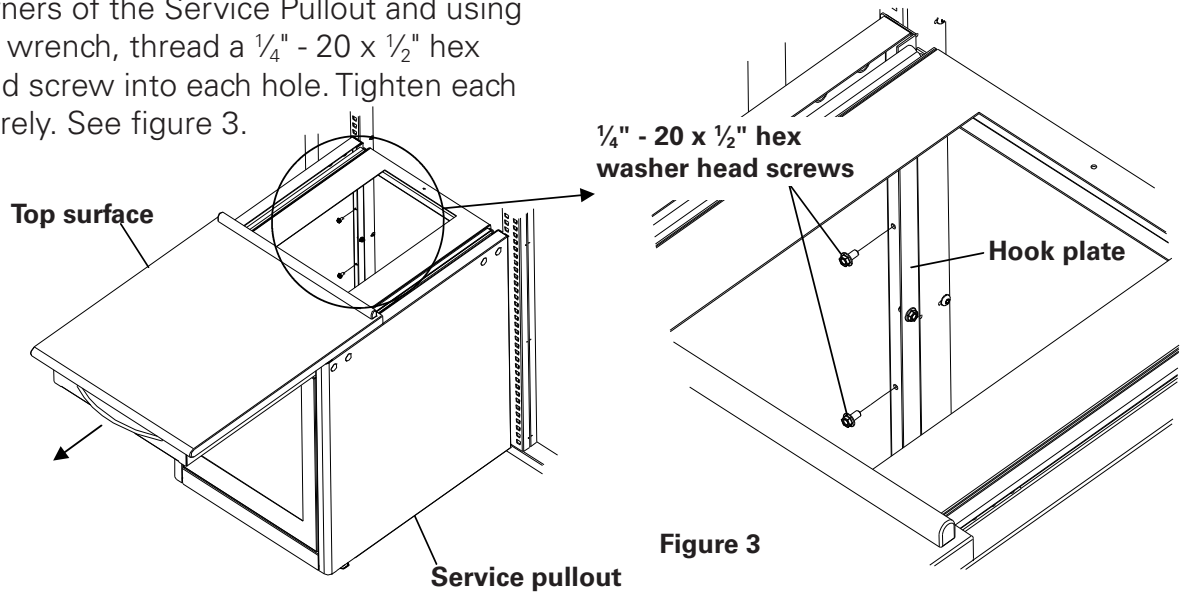

Leveling the service pullout

NOTE: The Service Pullout is shipped with the Front Legs in their uppermost position.

1. Pull the Drawer out. See figure 4.
2. Remove the three $\frac{1}{4}$ " - 20 x $\frac{1}{2}$ " button head cap screws that secure each Front Leg. Do not discard.
3. Drop the Front Legs down until the levelers touch the floor. Move each leg up until the threaded holes in the legs align with the nearest holes in the Front Channels. Re-install the $\frac{1}{4}$ " - 20 x $\frac{1}{2}$ " button head cap screws and tighten securely.
4. Turn the levelers counter clockwise until they touch the floor. Adjust the levelers to level the unit.

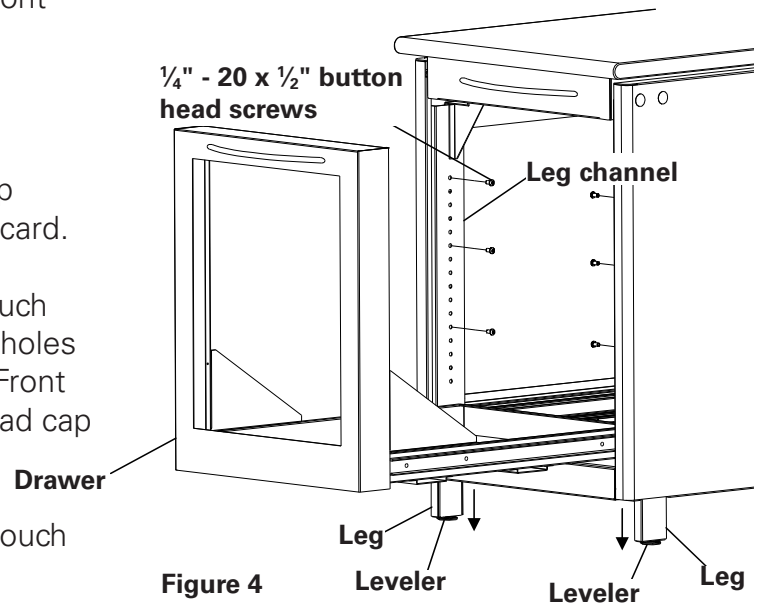

EATON

Powering Business Worldwide

Glass installation

1. Carefully unpack the Glass Panel (located under the drawer) and position it on the flange at the bottom of the opening in the Drawer front. See figure 5.

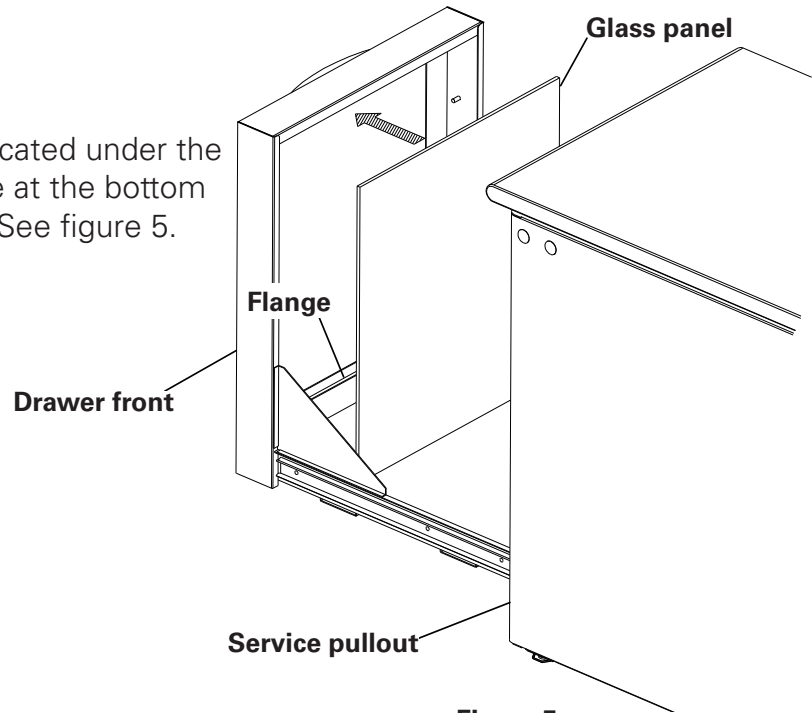

Figure 5

2. Hold the Glass Panel in place and install the two Glass Retainers onto the threaded studs located on both sides of the Drawer front. See figure 6. Slide the retainers against the Glass Panel and secure them using the four 1/4"-20 Keep nuts provided.

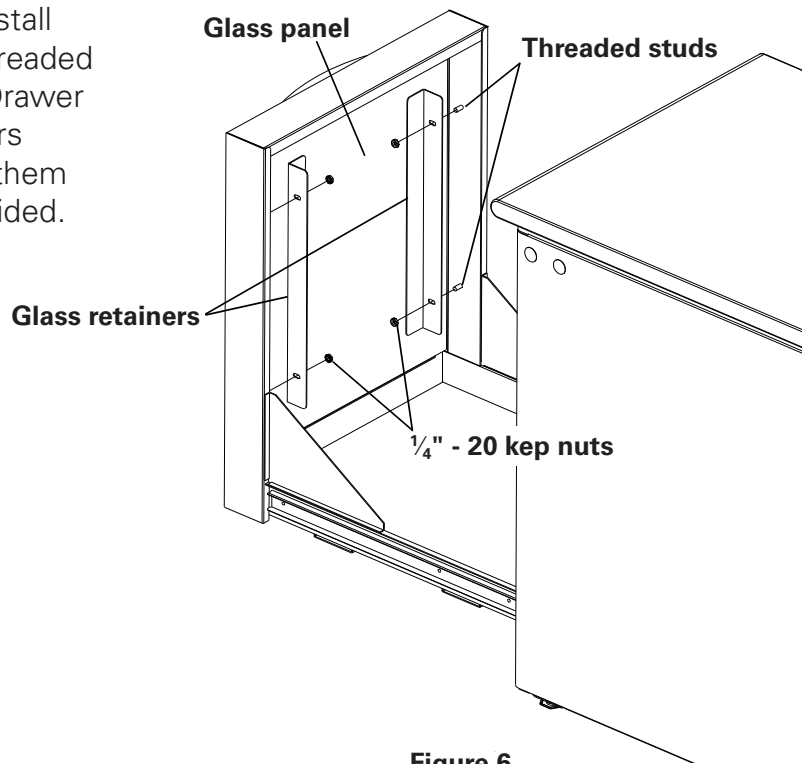

Figure 6

Eaton
1000 Eaton Boulevard
Cleveland, OH 44122
United States
Eaton.com

© 2018 Eaton
All Rights Reserved
Printed in USA
Publication No. IL210024EN
May 2018