

ELECTRONICAL CLOGGING INDICATOR

Series VS5 (block execution)

Sheet No.
1641 C

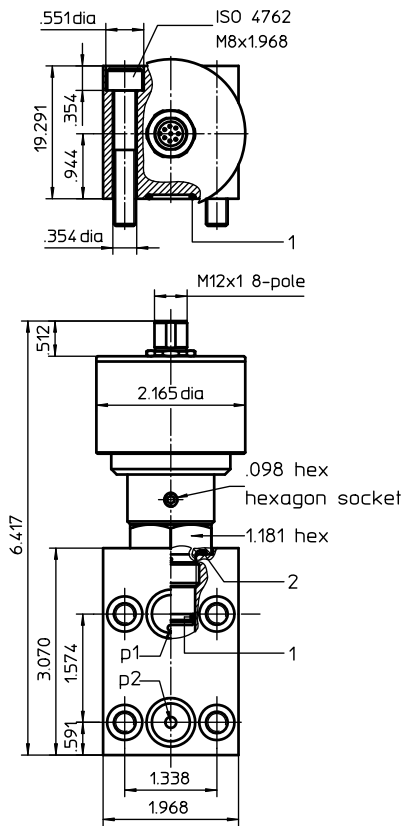

Configuration of M12 connector at VS5

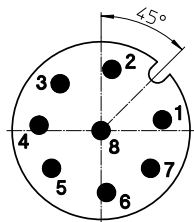

Connection configuration

- 1 GND/OV
- 2 24VDC current supply
- 3 24V PNP at Δp 75%
- 4 24V PNP at Δp 100%
- 5 6...20 mA
- 6 \oplus PE
- 7 reserve not connected
- 8 reserve not connected

3. Spare parts:

item	qty.	designation	dimension	article-no.	
1	3	O-ring	14 x 2	304342 (NBR)	304722 (FPM)
2	1	O-ring	22 x 2	304708 (NBR)	304721 (FPM)

1. Type index: (ordering example)

VS5. 1,5. V. -. NO. CS. B. -

1	2	3	4	5	6	7	8
---	---	---	---	---	---	---	---

1 series:

VS5 = electronic clogging indicator with analog output 6...20mA and 2x PNP-switching contacts (75% and 100%)

2 indicator-pressure difference: Δp -nominal

1,5 = 22 PSI 5,0 = 73 PSI
2,5 = 36 PSI 6,0 = 87 PSI

3 sealing material:

P = Nitrile (NBR)
V = Viton (FPM)

4 material:(block)

- = standard (aluminium)
VA = stainless steel

5 contact:

NO = normally opened,
NC = normally closed

6 cold start:

CS = with cold start suppression up to 77°F
- = without cold start suppression

7 execution:

B = block execution

8 connection:

- = without
GS5 = M12, 8-pole female connector
SS5 = M12, 8-pol. female connector with 197 inch cable and 3 installed LED's red/yellow/green (only in combination with contact "NO = normally opened")

2. Technical data:

max. operating pressure: 6000 PSI (stainless steel)
3200 PSI (aluminium)

max. pressure difference: 2320 PSI

operating temperature: -40°F...176°F

temperature range of fluid: -13°F...212°F (NBR)
14°F...212°F (FPM)

sealing material: other temperature ranges on request

power voltage: NBR / FPM, further seals on request

current consumption: +24VDC \pm 20%

output signal: approx.. 25mA + current signal output (measured with 24VDC)

error of measurement: Δp : 6...20mA, max load: 400 Ω
5mA by cold start suppression

75% and 100% from $\Delta p_{nominal}$ as 24VDC \pm 5% v. $\Delta p_{nominal}$

operating ability: < 400mA at closed state

< 1mA at opened state

protection: IP65 (IP67 on request)

fatigue strength: max. 1 Mio load cycles for aluminium

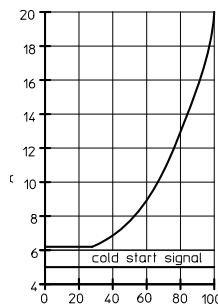

Δp -nominal in %

Changes of measures and design are subject to alteration!

EDV 05/17

EATON
Powering Business Worldwide

Friedensstrasse 41, 68804 Altussheim, Germany

phone +49 (0)6205 2094-0
fax +49 (0)6205 2094-40

e-mail filtration@eaton.com
url www.eaton.com/filtration

4. Functions:

- continuous pressure difference measuring
- cold start indication up to approx. + 77°F
- suppression of pressure peaks
- dust-proof and splash-proof aluminium or stainless steel housing
- interference-free signal transmission over longer distances
- optimal utilization of the filter elements based on a high definition of the measure value within the final measure range
- interchangeable with clogging indicator type AE

5. Connection:

GS5 = M12, 8-pole female connector (article-no. 345742)
 temperature range: -40°F ... +176°F

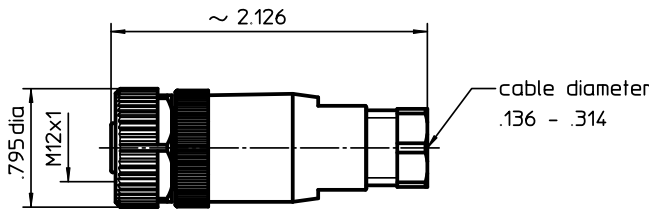

SS5 = M12, 8-pole female connector with 197 inch cable and 3 installed LED's red/yellow/green (article-no. 347370)
 temperature range: -13°F ... +176°C

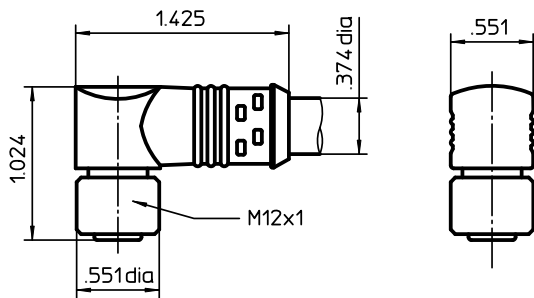

Connection configuration

WH	1	GND/0V
BN	2	24VDC current supply
GN	3	24V PNP at Δp 75%
YE	4	24V PNP at Δp 100%
GY	5	6...20 mA
PK	6	⊕PE
BU	7	reserve not connected
RD	8	reserve not connected

6. Accessories for replacing VS1/VS2 by VS5: (To use the previous connector)

The following adapters are available:

- Article No.: 347425, description: GSA1: for replacing VS1 of executions according to data sheet: 44522 / 60551 / 1617
- Article No.: 350639, description: GSA1-X: for replacing VS1 of executions according to data sheet: 49211 / 44368 / 43477
- Article No.: 347428, description: GSA2: for replacing VS2

