

NOZZLE SCHEDULE			
ITEM	QTY.	NAME	DESCRIPTION
N1	1	INLET	2 1/2"-150# RFSO ASME B16.5
N2	1	OUTLET	2 1/2"-150# RFSO ASME B16.5
N3	1	DRAIN	1" NPT 3000# COUPLING
N4	1	VENT	1/2" NPT 3000# COUPLING
N5	2	W.G. CONNECTIONS	1/2" NPT 3000# COUPLING

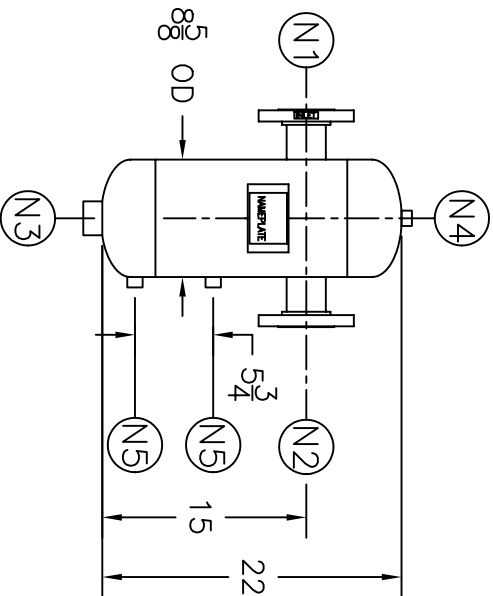
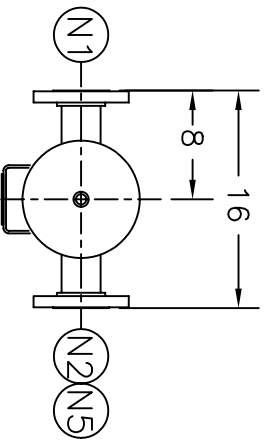

REV	DATE	CHANGE	ECR	BY	APP
A	09/27/00	NEW ISSUE	8913	FG	FJM
B	11/1/05	REVISED TITLE BLOCK	D507	FM	LH

NOTES:

- UNITS ARE TO BE DESIGNED, FABRICATED, AND CODE STAMPED (IF REQUIRED) IN ACCORDANCE WITH ASME B & PV CODE, SECTION VIII, DIVISION 1 IN COMPLIANCE TO CURRENT PUBLISHED ADDENDA.
- ALL DIMENSIONS ARE IN INCHES.
- ALL BOLT HOLES ARE TO STRADDLE NATURAL CENTERLINES.
- SHIPPING WEIGHT: 65 POUNDS.
- DESIGN DATA:
 - DESIGN PRESSURE- 150 PSIG
 - DESIGN TEMPERATURE- 450° F
 - MIN. DESIGN METAL TEMP.- -20° F @ 150 PSIG
 - HYDROTEST PRESSURE- 214 PSIG
 - CORROSION ALLOWANCE- 0 INCHES
- MATERIAL: 304/304L STAINLESS STEEL.
- COMMERCIAL BLAST CLEANING PER SSPC-SP 6.

CUSTOMER:
 REG. NO.:
 P.O. NO.:
 TAG NO.:
 PART NO.: 2.5T150S
 2.5T150SM
 2.5T150SU

EATON FILTRATION, LLC
 900 FAIRMOUNT AVENUE, ELIZABETH, NEW JERSEY 07207
 NAME: 2.5" TYPE "T" GAS/LIQUID
 SEPARATOR 150# FLG 304/304L



ELECTRONIC FILE NAME:
 SD25T15S.DWG

TOLERANCES UNLESS OTHERWISE SPECIFIED
 PER ENGINEERING STANDARD ES- --

UNAUTHORIZED USE, MANUFACTURE OR
 REPRODUCTION IN WHOLE OR IN PART IS
 PROHIBITED. DRAWING, DESIGN AND
 OTHER DISCLOSURES PROPERTY OF
 EATON FILTRATION, LLC

SIZE	DWG NO	REV
A		B

DRAWN	FG	DATE	CHECKED	FJM	DATE
APP	LH	9/26/00	SCALE	NTS	ECR 8913

DATE	DATE
9/26/00	9/26/00