

NOZZLE SCHEDULE		
ITEM	QTY.	NAME DESCRIPTION
N1	1	8"-150# RFSO ASME B16.5 INLET
N2	1	8"-150# RFSO ASME B16.5 OUTLET
N3	1	2" NPT 3000# COUPLING DRAIN
N4	1	1/2" NPT 3000# COUPLING VENT

REV	DATE	CHANGE	EOR	BY	APP
A	06/19/06	NEW ISSUE	E021	GO	LH

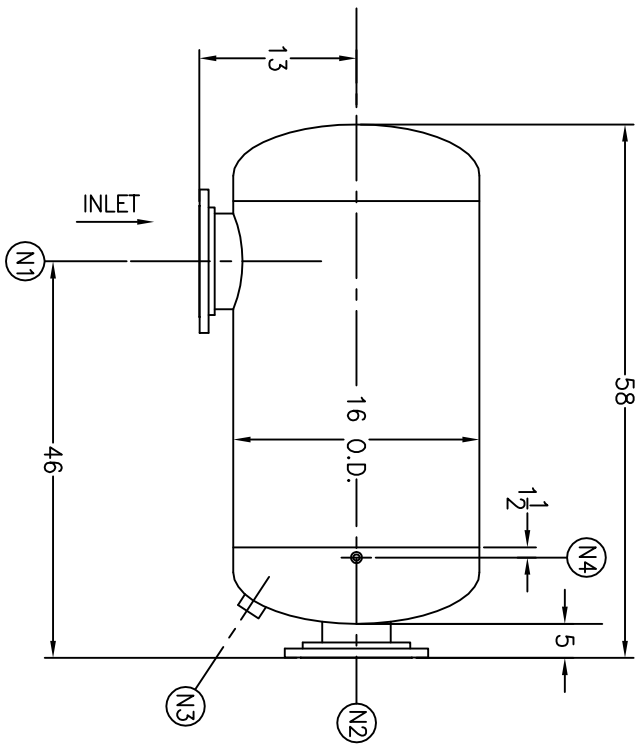

NOTES:

- UNITS ARE TO BE DESIGNED, FABRICATED, AND "U" STAMPED (IF REQ'D) IN ACCORDANCE WITH ASME B & PV CODE, SECTION VIII, DIVISION 1 IN COMPLIANCE TO CURRENT PUBLISHED ADDENDA.
- ALL DIMENSIONS ARE IN INCHES.
- ALL BOLT HOLES ARE TO STRADDLE NATURAL CENTERLINES.
- SHIPPING WEIGHT: 500 POUNDS
- DESIGN DATA:
 - DESIGN PRESSURE- 150 PSIG
 - DESIGN TEMPERATURE- 450° F
 - MIN. DESIGN METAL TEMP.- -20° F @ 150 PSIG
 - HYDROTEST PRESSURE- 195 PSIG
 - CORROSION ALLOWANCE- 0 INCHES
- RADIOGRAPHY REQUIREMENTS: NONE
- PAINT REQUIREMENTS: SEE B.O.M
- MATERIAL: CARBON STEEL

STANDARD

CUSTOMER:
 REG. NO.:
 P.O. NO.:
 TAG NO.:
 PART NO.: 836L150C, 836L150CU

EATON

EATON FILTRATION, LLC
 900 FAIRMOUNT AVENUE, ELIZABETH, NEW JERSEY 07207

NAME
8" TYPE "36-L" GAS/LIQUID SEPARATOR 150# FLG CSTL

ELECTRONIC FILE NAME:
 SD836L150C.DWG

TOLERANCES UNLESS OTHERWISE SPECIFIED
 PER ENGINEERING STANDARD ES-----

UNAUTHORIZED USE, MANUFACTURE OR
 REPRODUCTION IN WHOLE OR IN PART IS
 PROHIBITED. DRAWING, DESIGN AND
 OTHER DISCLOSURES PROPERTY OF
 EATON FILTRATION, LLC

DRAWN	GO	DATE	06/19/06	CHECKED	FM	DATE	06/19/06	
APP	LH	DATE	06/19/06	SCALE	NTS	EOR	E021	
SIZE	DWG	NO						
SD836L150C							REV	A